

MILLED RUMBLE STRIPS (CENTERLINE)
STA. W 200+50 - W 212+00

TEMPORARY 4 INCH WHITE LINE, PAINT
DURABLE 4 INCH WHITE LINE, (SEE OPTION ITEMS)
(ALL LINES WILL INCLUDE EDGE LINE BREAKS
AND RADII FOR SIDE ROADS)
STA. W 200+50 - W 219+50 (SOLID LT & RT)

TEMPORARY 4 INCH YELLOW LINE, PAINT
DURABLE 4 INCH YELLOW LINE, (SEE OPTION ITEMS)
(ALL LINES WILL INCLUDE CENTER LINE BREAKS
FOR SIDE ROADS)
STA. W 200+50 - W 219+50 (SOLID LT & RT)

TEMPORARY 24 INCH STOP BAR, PAINT
DURABLE 24 INCH STOP BAR, (SEE OPTION ITEMS)
STA. W 215+60 LT

TEMPORARY LETTER OR SYMBOL, PAINT
DURABLE LETTER OR SYMBOL, (SEE OPTION ITEMS)
STA. W 215+60 LT "STOP" (4 EA)

REMOVING SIGNS
AS SHOWN - 7

ERECTING SALVAGED SIGNS
AS SHOWN - 1

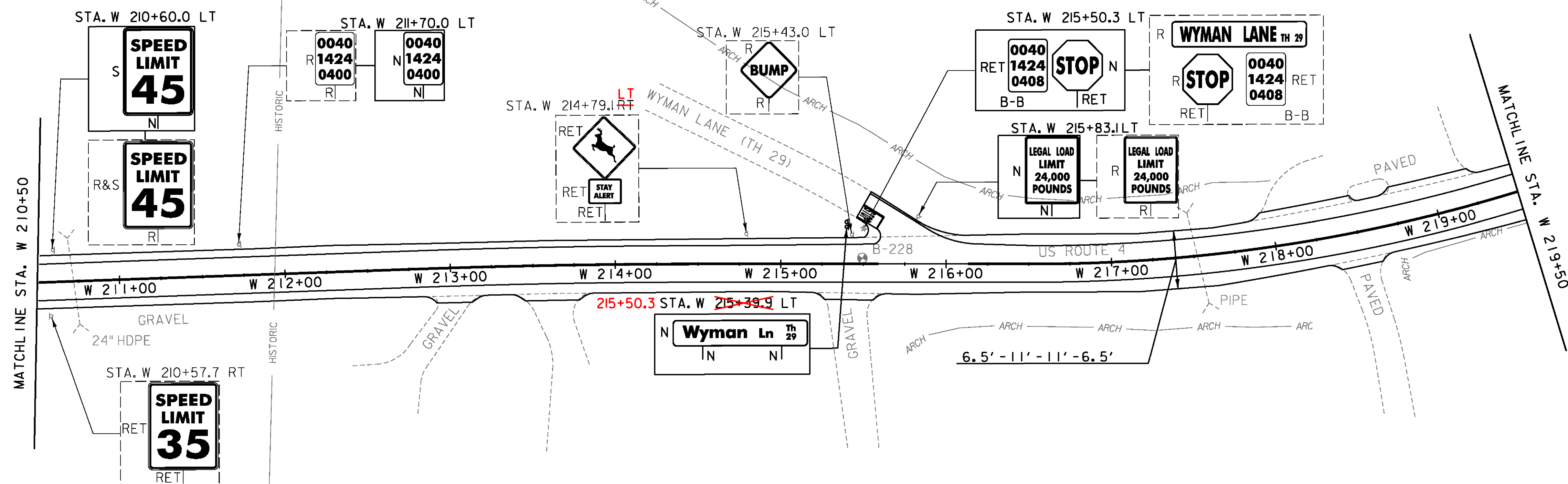
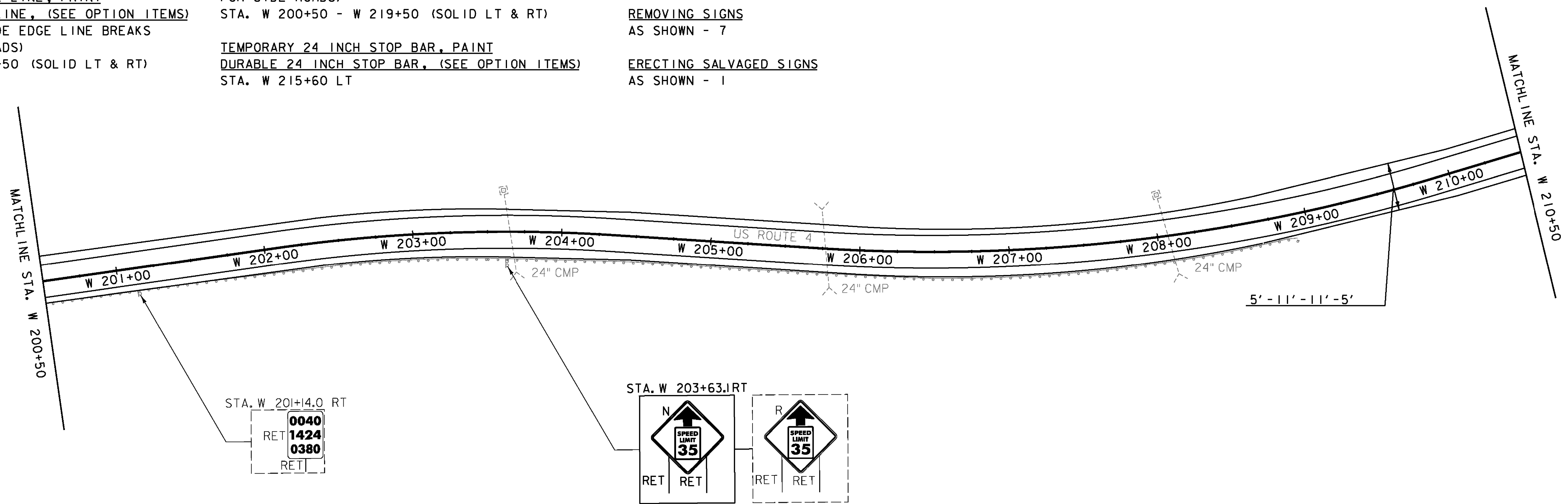

SIGN LEGEND

- R = REMOVE
- R&S = REMOVE AND SALVAGE
- RET = RETAIN
- S = SALVAGED
- N = NEW
- B-B = BACK TO BACK
- = EXISTING
- = NEW

PROJECT NAME: KILLINGTON-WOODSTOCK
PROJECT NUMBER: ER NH 020-2(38)

FILE NAME: z13b192bdr.dgn
PROJECT LEADER: E. ATKINS
DESIGNED BY: T. BIGELOW/S. MUSTO
PLOT DATE: 3/7/2016
DRAWN BY: I. KHALID
CHECKED BY: ATKINS/SOBEL
SHEET 69 OF 146

NOT TO SCALE