

MILLED RUMBLE STRIPS (CENTERLINE)
 STA. B 7+00 - B 10+50

TEMPORARY 4 INCH WHITE LINE, PAINT
 DURABLE 4 INCH WHITE LINE, (SEE OPTION ITEMS)
 (ALL LINES WILL INCLUDE EDGE LINE BREAKS
 AND RADII FOR SIDE ROADS)
 STA. B 1+50 - B 2+60 (SOLID LT & RT)
 STA. B 6+65 - B 10+50 (SOLID LT & RT)

TEMPORARY 4 INCH YELLOW LINE, PAINT
 DURABLE 4 INCH YELLOW LINE, (SEE OPTION ITEMS)
 (ALL LINES WILL INCLUDE EDGE LINE BREAKS
 AND RADII FOR SIDE ROADS)
 STA. B 1+50 - B 2+60 (SOLID LT & RT)
 STA. B 6+65 - B 10+50 (SOLID LT & RT)

REMOVING SIGNS
 AS SHOWN - 24

ERECTING SALVAGED SIGNS
 AS SHOWN - 1

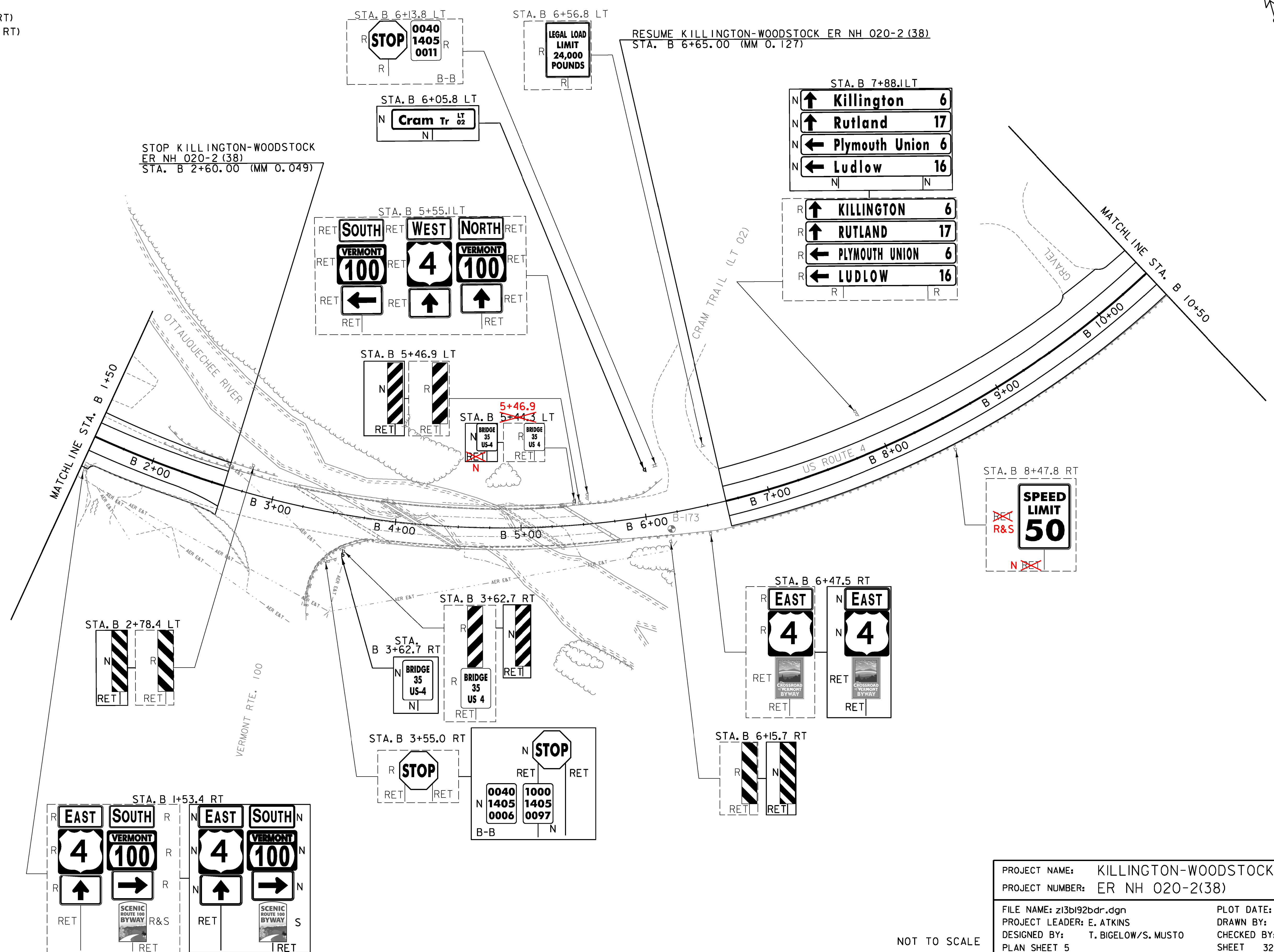
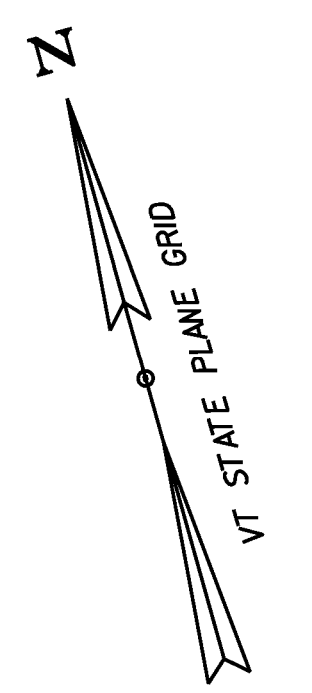

SIGN LEGEND

R = REMOVE
 R&S = REMOVE AND SALVAGE
 RET = RETAIN
 S = SALVAGED
 N = NEW
 B-B = BACK TO BACK
 --- = EXISTING
 — = NEW

PROJECT NAME: KILLINGTON-WOODSTOCK
 PROJECT NUMBER: ER NH 020-2(38)

FILE NAME: z13bi92bdr.dgn
 PROJECT LEADER: E. ATKINS
 DESIGNED BY: T. BIGELOW/S. MUSTO
 PLAN SHEET 5

PLOT DATE: 3/7/2016
 DRAWN BY: I. KHALID
 CHECKED BY: ATKINS/SOBEL
 SHEET 32 OF 146

NOT TO SCALE