

NOTE:
 * CONTRACTOR SHALL DESIGN AND PROVIDE TEMPORARY SUPPORT OF EXCAVATION UNLESS OTHERWISE DIRECTED BY THE ENGINEER. COST ASSOCIATED WITH TEMPORARY SUPPORT WILL BE CONSIDERED INCIDENTAL TO ITEM 203.17 UNCLASSIFIED EXCAVATION.

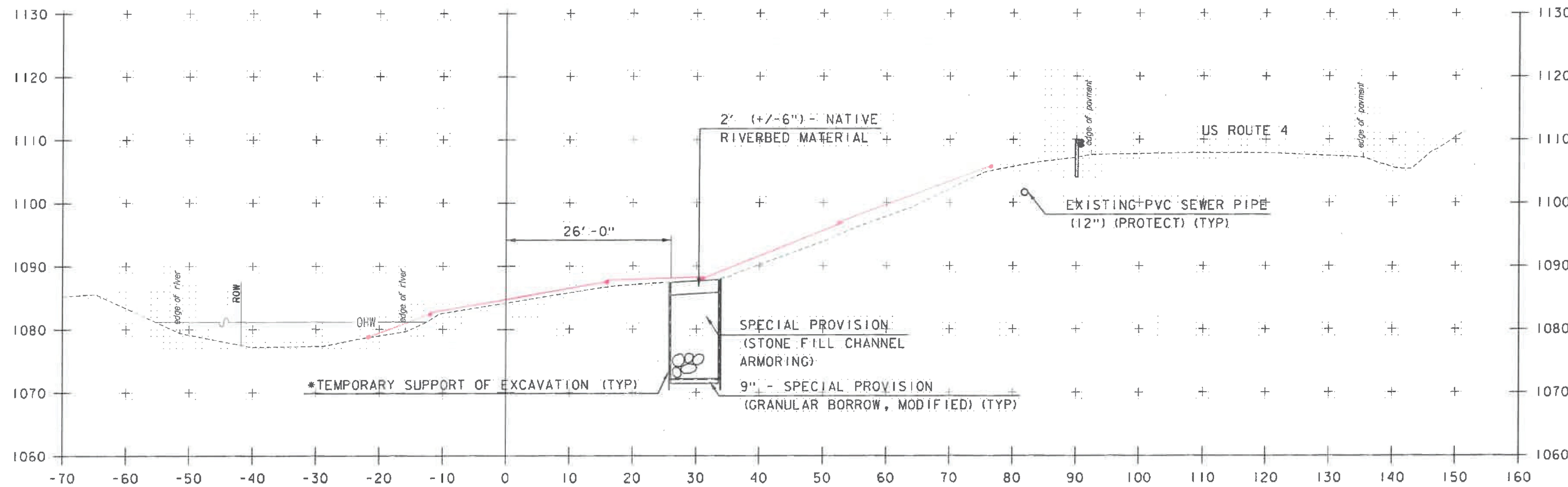

10+50.00

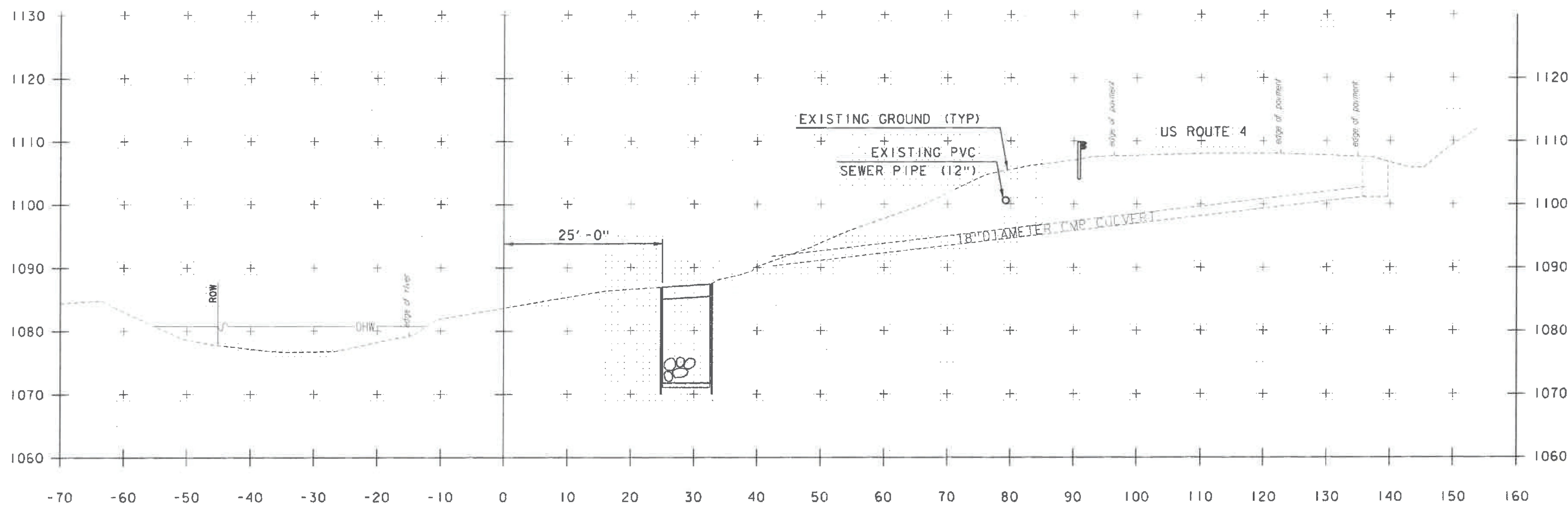

10+35.68, 18" DIA. 18" CMP CULVERT

SKINNED AT 81' 49' 14.88"

RECEIVED
 JUL 26 2015

BY:

STA. 10+35.68 TO STA. 10+50

PROJECT NAME:	MENDON	FILE NAME:	z13b188xsl.dgn	PLOT DATE:	11/24/2015
PROJECT NUMBER:	ER 020-2(39)	PROJECT LEADER:	E. ATKINS	DRAWN BY:	S. SOLLA
		DESIGNED BY:	M. BRADLEY	CHECKED BY:	E. ATKINS
		CROSS SECTION SHEET 7		SHEET	59A OF 72

NOTE: STATIONS AND ELEVATIONS ARE IN FEET

GREEN INTERNATIONAL AFFILIATES, INC.
 CIVIL AND STRUCTURAL ENGINEERS