

CLEARING AND GRUBBING, INCLUDING INDIVIDUAL TREES AND SHRUBS
 3+00.0 LT-RT - 6+50.0 LT-RT
 50+00.0 LT-RT - 51+93.0 LT-RT
 206+50.0 LT-RT - 207+50.0 LT-RT

COLD PLANING, BITUMINOUS CONCRETE
~~22+58.6 - 23+33.6~~ ~~22+95.0 - 24+63.0~~
~~24+69.1 - 25+44.1~~

AGGREGATE SHOULDERS, IN PLACE
 22+68.7 RT - 25+51.5 RT

STONE FILL, TYPE I
 50+00.0 LT-RT - 51+93.0 LT-RT

STONE FILL, TYPE II
~~3+00.0 LT-RT - 6+50.0 LT-RT~~
~~2+89.0~~

STEEL BEAM GUARDRAIL, GALVANIZED/NESTED
~~23+44.7 LT - 24+44.7 LT~~
~~23+07.2 LT - 23+44.7 LT (MANUFACTURED TERMINAL END SECTION)~~
~~24+44.7 LT - 26+61.6 LT~~

REMOVAL AND DISPOSAL OF GUARDRAIL
~~23+44.7 LT - 24+44.7 LT~~
~~23+07.0 LT - 29+57.0 LT~~

TEMPORARY TRAFFIC BARRIER
 23+00.0 LT - 26+61.1 LT
 - TO FACILITATE EMBANKMENT WORK

4 INCH WHITE LINE
~~22+58.0 LT - 25+44.1 LT (EDGE LINE)~~ ~~22+40.0 - 24+80.0~~
~~22+58.0 RT - 25+44.1 RT (EDGE LINE)~~ ~~22+37.0-24+80.0~~

4 INCH YELLOW LINE
~~22+58.0 - 25+44.1 (DOUBLE CENTER LINE)~~
~~22+96.0 - 24+82.0 CL~~

GRUBBING MATERIAL
 3+00.0 RT - 6+50.0 RT

SPECIAL PROVISION
 (STONE FILL, SLOPE ARMORING)
 206+50.0 LT-RT - 207+50.0 LT-RT

SPECIAL PROVISION
 (STONE FILL, CHANNEL ARMORING)
 206+50.0 LT-RT - 207+50.0 LT-RT
~~3+00.0 LT-RT - 6+50.0 LT-RT~~
~~2+89.0~~

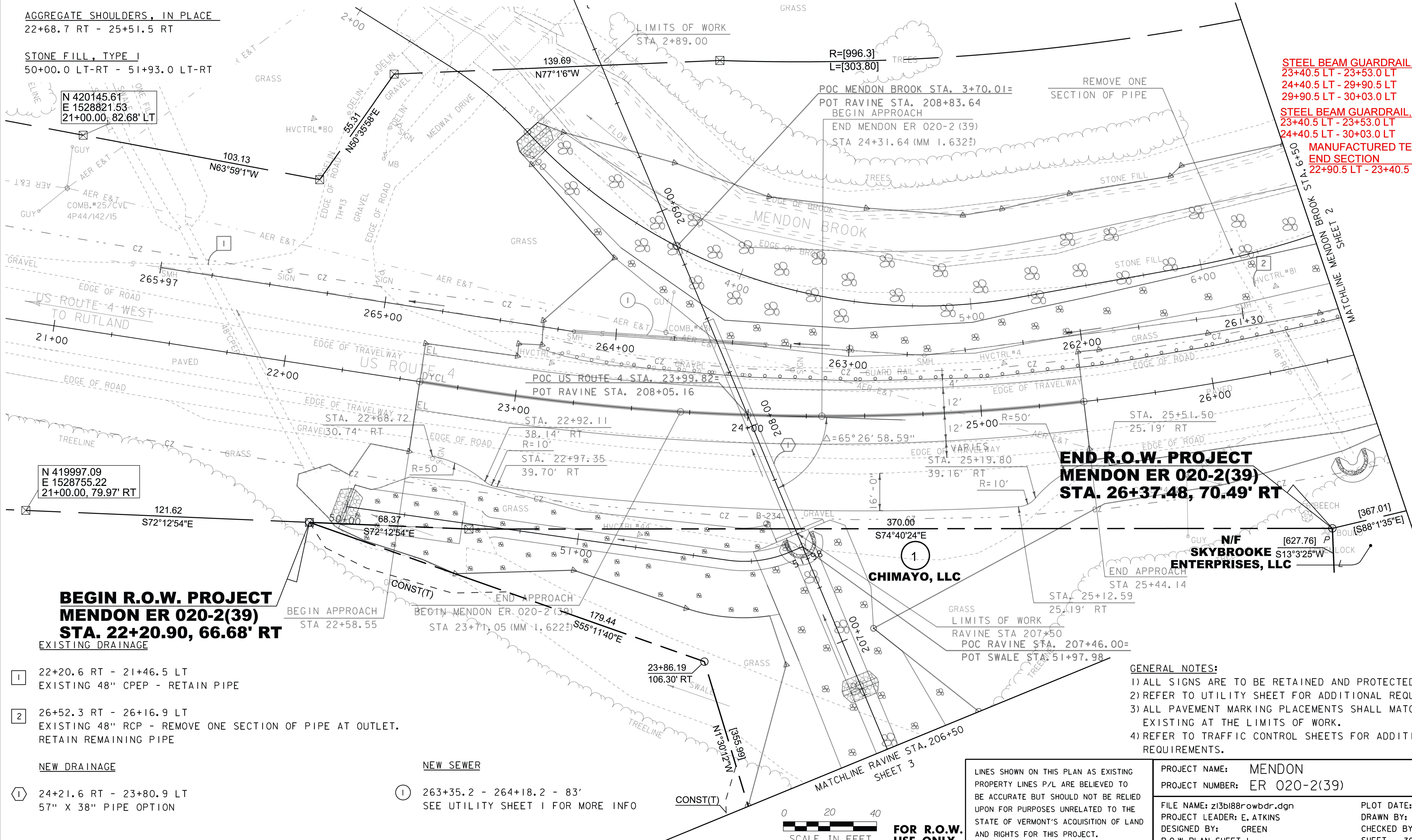
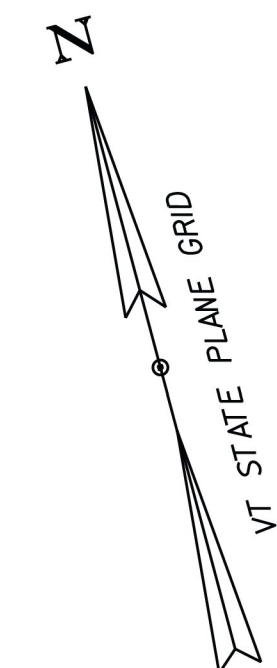

STEEL BEAM GUARDRAIL, GALV./NESTED
 23+40.5 LT - 23+53.0 LT
 24+40.5 LT - 29+90.5 LT
 29+90.5 LT - 30+03.0 LT

STEEL BEAM GUARDRAIL, GALV.
 23+40.5 LT - 23+53.0 LT
 24+40.5 LT - 30+03.0 LT

MANUFACTURED TERMINAL END SECTION
 22+90.5 LT - 23+40.5 LT

N 420145.61
 E 1528821.53
 21+00.00, 82.68' LT

N 419997.09
 E 1528755.22
 21+00.00, 79.97' RT

BEGIN R.O.W. PROJECT
MENDON ER 020-2(39)
STA. 22+20.90, 66.68' RT
 EXISTING DRAINAGE

- 1 22+20.6 RT - 21+46.5 LT
EXISTING 48" CPEP - RETAIN PIPE
- 2 26+52.3 RT - 26+16.9 LT
EXISTING 48" RCP - REMOVE ONE SECTION OF PIPE AT OUTLET.
RETAIN REMAINING PIPE

NEW DRAINAGE
 1 24+21.6 RT - 23+80.9 LT
 57" X 38" PIPE OPTION

NEW SEWER
 1 263+35.2 - 264+18.2 - 83'
 SEE UTILITY SHEET I FOR MORE INFO

END R.O.W. PROJECT
MENDON ER 020-2(39)
STA. 26+37.48, 70.49' RT

- GENERAL NOTES:**
- 1) ALL SIGNS ARE TO BE RETAINED AND PROTECTED IN PLACE
 - 2) REFER TO UTILITY SHEET FOR ADDITIONAL REQUIREMENTS
 - 3) ALL PAVEMENT MARKING PLACEMENTS SHALL MATCH TO EXISTING AT THE LIMITS OF WORK.
 - 4) REFER TO TRAFFIC CONTROL SHEETS FOR ADDITIONAL REQUIREMENTS.

LINES SHOWN ON THIS PLAN AS EXISTING PROPERTY LINES P/L ARE BELIEVED TO BE ACCURATE BUT SHOULD NOT BE RELIED UPON FOR PURPOSES UNRELATED TO THE STATE OF VERMONT'S ACQUISITION OF LAND AND RIGHTS FOR THIS PROJECT.

PROJECT NAME: MENDON	PLOT DATE: 11/13/2015
PROJECT NUMBER: ER 020-2(39)	DRAWN BY: A. EGIZI
FILE NAME: z13bi88rowbdr.dgn	DESIGNED BY: GREEN
PROJECT LEADER: E. ATKINS	CHECKED BY: R. CLOUTIER
R.O.W. PLAN SHEET I	SHEET 30 OF 72

