

**BRIDGE RAILING, GALVANIZED
3 RAIL BOX BEAM**
STA. 287+95 - 288+62, LT
STA. 288+08 - 288+75, RT

REMOVAL AND DISPOSAL OF GUARDRAIL
STA. 287+07 - 287+95, LT
STA. 288+00 - 288+14, RT
STA. 288+51 - 289+00, LT
STA. 288+70 - 289+94, RT

RELOCATE MAILBOX SINGLE SUPPORT
STA. 290+86, RT

BOX BEAM GUARDRAIL
STA. 287+06 - 287+63, LT
STA. 50+42, 14.2' LT - 50+81, LT
STA. 288+94 - 289+51, LT
STA. 289+07 - 289+64, RT

**GUARDRAIL APPROACH SECTION,
3 RAIL BOX BEAM**
STA. 287+63 - 287+95, LT
STA. 50+42, 14.2' LT = 287+90, 29.6' RT - 288+08, RT
STA. 288+62 - 288+94, LT
STA. 288+75 - 289+07, RT

**MANUFACTURED TERMINAL SECTION,
TANGENT**
STA. 286+92 - 287+06, LT
STA. 50+81 - 50+95, RT
STA. 289+51 - 289+65, LT
STA. 289+64 - 289+78, RT

**CONSTRUCT GRAVEL DRIVE WITH
5' PAVED APRON**
STA. 290+82, LT - 50' WIDE
**CONSTRUCT GRAVEL TH 15 WITH
35' PAVED APRON**
STA. 287+70, RT - 88' WIDE

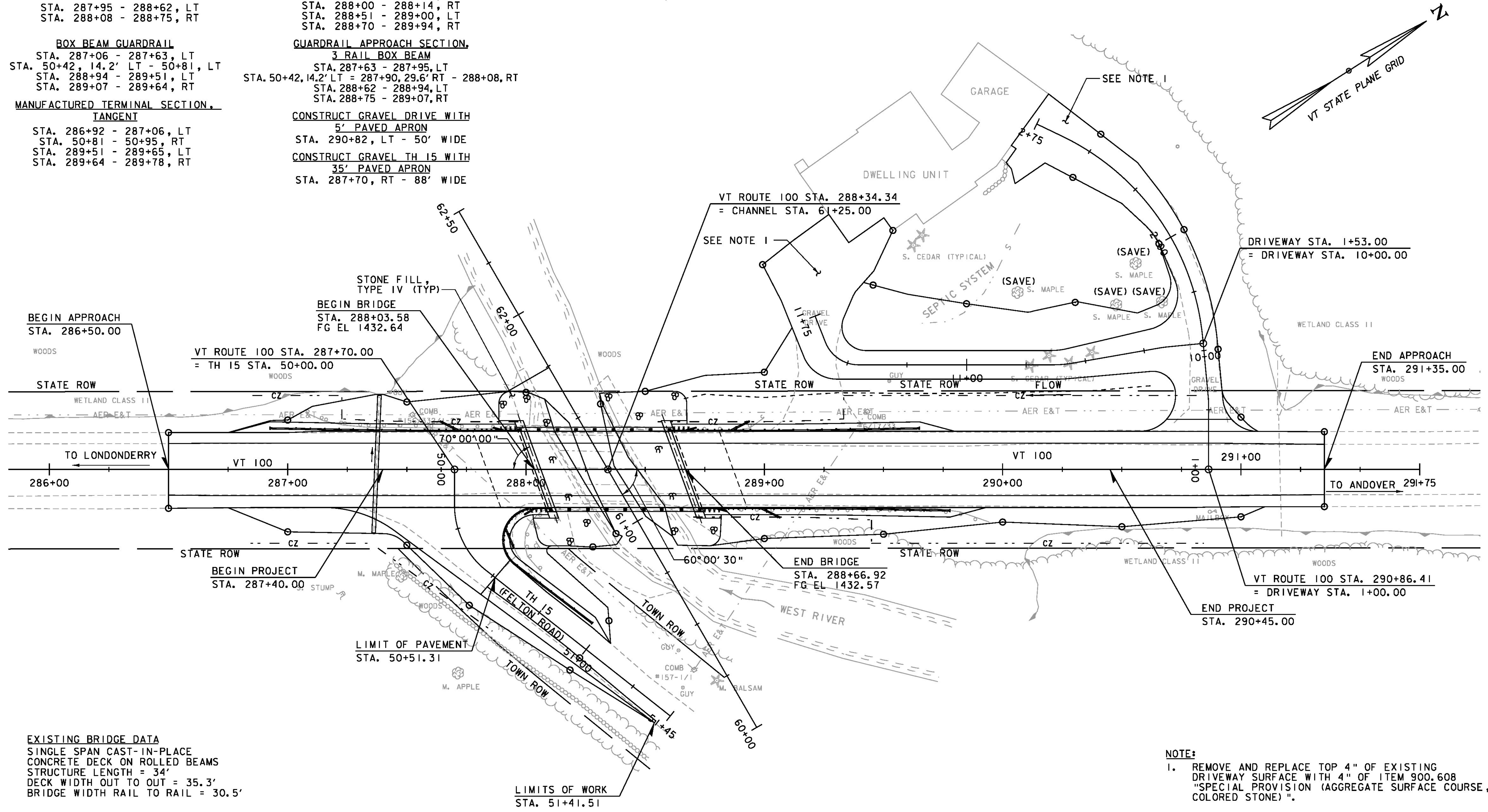

EXISTING BRIDGE DATA
SINGLE SPAN CAST-IN-PLACE
CONCRETE DECK ON ROLLED BEAMS
STRUCTURE LENGTH = 34'
DECK WIDTH OUT TO OUT = 35.3'
BRIDGE WIDTH RAIL TO RAIL = 30.5'

- NOTE:**
- REMOVE AND REPLACE TOP 4" OF EXISTING DRIVEWAY SURFACE WITH 4" OF ITEM 900.608 "SPECIAL PROVISION (AGGREGATE SURFACE COURSE, COLORED STONE)".
 - CONTRACTOR TO COORDINATE ALL CONSTRUCTION ACTIVITIES OUTSIDE OF THE STATE'S AND TOWN'S RIGHT-OF-WAY WITH THE PROPERTY OWNER. SEE SPECIAL PROVISIONS FOR ADDITIONAL INFORMATION.

PROJECT NAME:	WESTON	PLOT DATE:	10/2/2015
PROJECT NUMBER:	BF 013-2(13)	DRAWN BY:	J.J. WESTCOTT
FILE NAME:	z13b076bdr_nul.dgn	CHECKED BY:	S.E. BURBANK
PROJECT LEADER:	S.E. BURBANK	LAYOUT SHEET	SHEET 16 OF 68
DESIGNED BY:	J.J. WESTCOTT		

