

GENERAL NOTES

- ALL WORK AND MATERIALS SHALL CONFORM TO THE STATE OF VERMONT, DEPARTMENT OF HIGHWAYS, STANDARD SPECIFICATIONS FOR HIGHWAY AND BRIDGE CONSTRUCTION DATED APRIL 1964, AND THE A.A.S.H.O. SPECIFICATIONS DATED 1961. DESIGNED FOR HS20-44 LOADING.
- ALL REINFORCING STEEL SHALL BE DETAILED ON THE REINFORCING STEEL SCHEDULE. ALL SPLICES SHALL BE A MINIMUM OF 40 BAR DIAMETERS.

**FAIR HAVEN - WEST RUTLAND
BF MEMB (35)
SHEET 43 OF 44
BRIDGE NO. 15E
FOR REFERENCE ONLY**

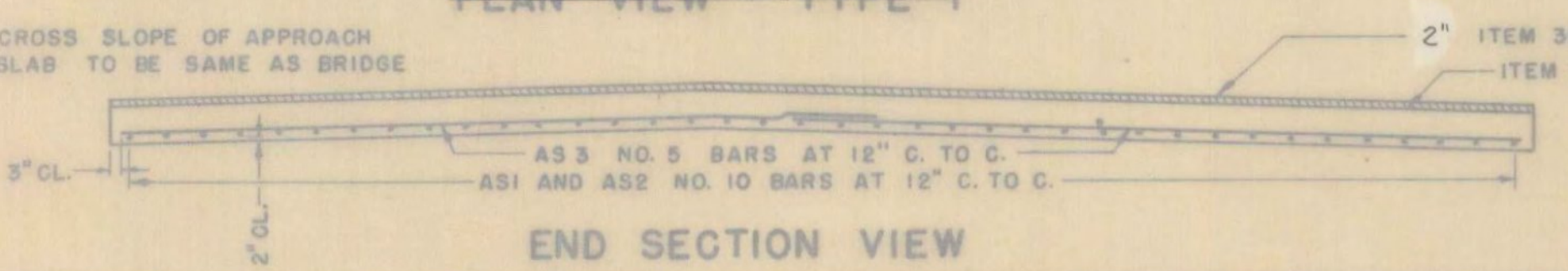

SUMMARY OF QUANTITIES

ITEM NO.	ITEM	UNIT	TOTAL	FINAL
318	TAR EMULSION FOR BRIDGE FLOORS	GAL.		
361	BITUMINOUS CONCRETE PAVEMENT M.O.D.	TONS		
372-A	JOINT SEALER - HOT POURED	L.F.		
372-C	JOINT SEALER - PREFORMED, TYPE A	L.F.		
372-C	JOINT SEALER - PREFORMED, TYPE B	L.F.		
401-B	CONCRETE CLASS B	CY.		
402	REINFORCING STEEL	LB.		

REINFORCING BENDING DETAILS

DETAIL SHOWN IS FOR AS1 BAR
ALL OTHER BARS ARE TO BE STRAIGHT

REINFORCING STEEL				
BAR NO.	LENGTH	WEIGHT PER FT.	WEIGHT IN LBS.	
AS1	SEE REINFORCING SCHEDULE	4.303		
AS2	SEE REINFORCING SCHEDULE	4.303		
AS3	SEE REINFORCING SCHEDULE	1.043		
AS4	SEE REINFORCING SCHEDULE	1.043		
TOTAL WEIGHT =				

REVISIONS AND CORRECTIONS

1. DIMENSIONS OF JOINT FOR SEALER TYPE A REVISED. 4/15/65 W.B.T.

2. DIMENSIONS OF JOINT SEALER TYPE B REVISED AND MODIFICATION OF ITEM 372-C ADDED. 8/23/65 W.B.T.

DRAWN BY: W.B.T. Jan. 1965

TRACED BY: W.B.T. Jan. 1965

CHECKED BY: W.M.S. Feb. 1965

RECOMMENDED FOR APPROVAL: [Signature] 2/4/65
DATE
BRIDGE ENGINEER

RECOMMENDED FOR APPROVAL: [Signature] 2/4/65
DATE
ASSISTANT CHIEF ENGINEER

APPROVED BY: [Signature] 2/4/65
DATE
CHIEF ENGINEER

**DETAILS OF APPROACH SLAB
FOR 38'-0" FOOT BRIDGE**
(WIDTH)

TO BE USED FOR BRIDGE AT STATION 774+50

LOCATION APPROACH SLAB NO. 3 (E.B.)

STATE OF VERMONT
DEPARTMENT OF HIGHWAYS
STANDARD STRUCTURE
SB-AS-65

TOWN OF TRA WEST RUTLAND

ROUTE NO. RELOC. US 4

STA. 774+50 ±

DESIGNED BY J. WOOD CHECKED BY D. SAAL
PROJECT NO. AP 020-1(20)
BR 312 OF 315 SHEET 155 OF 359