

GENERAL NOTES

- ALL WORK AND MATERIALS SHALL CONFORM TO THE STATE OF VERMONT, DEPARTMENT OF HIGHWAYS, STANDARD SPECIFICATIONS FOR HIGHWAY AND BRIDGE CONSTRUCTION DATED APRIL 1964, AND THE A.A.S.H.O. SPECIFICATIONS DATED 1961. DESIGNED FOR HS 20-44 LOADING.
- ALL REINFORCING STEEL SHALL BE DETAILED ON THE REINFORCING STEEL SCHEDULE. ALL SPLICES SHALL BE A MINIMUM OF 40 BAR DIAMETERS.
- BITUMINOUS CONCRETE PAVEMENT VARIES FROM 2" AT BRIDGE END TO 3" AT ROADWAY END.

**FAIR HAVEN - WEST RUTLAND
BF MEMB (35)
SHEET 25 OF 44
BRIDGE NOS. 5E AND 5W
FOR REFERENCE ONLY**

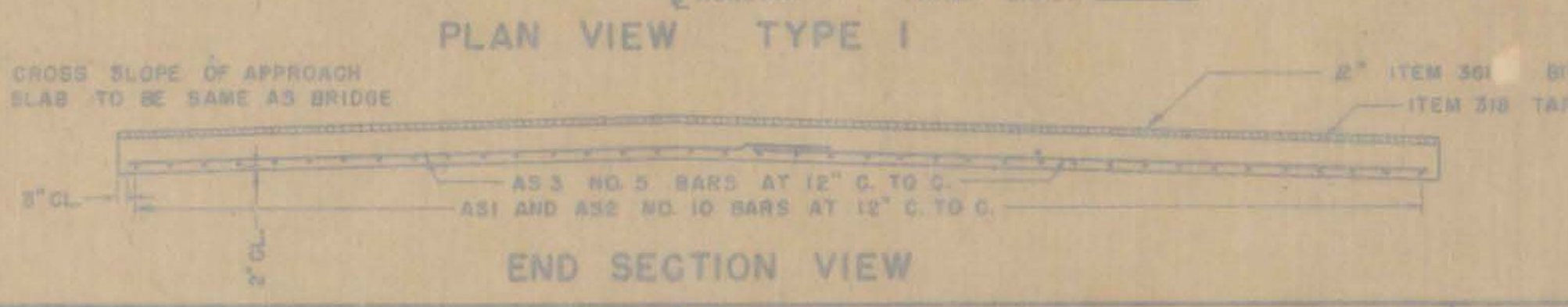
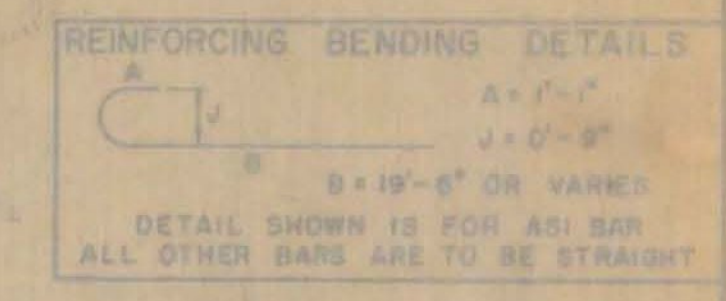

LIST OF QUANTITIES

ITEM NO.	ITEM	UNIT
318	TAR EMULSION FOR BRIDGE FLOORS	GAL.
361	BITUMINOUS CONCRETE PAVEMENT MOD. TYPE IV	TONS
372-A	JOINT SEALER - HOT POURED	L.F.
372-C	JOINT SEALER - PREFORMED, TYPE A	L.F.
401-B	CONCRETE CLASS B	CY.
402	REINFORCING STEEL	LB.

REVISIONS AND CORRECTIONS

- DIMENSIONS OF JOINT FOR SEALER TYPE A REVISED 4/18/65 W.B.T.
- DIMENSIONS OF JOINT SEALER TYPE B REVISED 6/23/65 W.B.T.
- JOINT BETWEEN CURB AND SLAB REVISED, BITUMINOUS CONCRETE REVISED TO 2". QUANTITY TOTALS REMOVED. 12/7/65 W.B.T.

DRAWN BY: W.B.T. Jan 1965
TRACED BY: W.B.T. Jan 1965
CHECKED BY: W.M.S. Feb 1965

RECOMMENDED FOR APPROVAL: [Signature] 2/1/65
RECOMMENDED FOR APPROVAL: [Signature] 2/1/65
APPROVED BY: [Signature] 2/1/65

DETAILS OF APPROACH SLAB FOR 36'-8" FOOT BRIDGE

TO BE USED FOR BRIDGE AT STATION 1077+50 W.B.
 LOCATION U.S. RTE.4 RELOCATION OVER VT.22A RELOC. (APPROACH SLAB NO.2)

**STATE OF VERMONT
DEPARTMENT OF HIGHWAYS
STANDARD STRUCTURE
SB-AS-65**

**PROJECT FAIR HAVEN
TOWN OF FAIR HAVEN
ROUTE NO. U.S. 4
U.S. RTE.4 RELOCATION OVER VT.22A RELOC
APPROACH SLAB NO.2**

NOT TO SCALE
 IN CHARGE H.G.C.
 DESIGNED BY A.M.D. CHECKED BY R.E.C.
 PROJECT NO. FO20-1 (8)
 SHEET 197 OF 186 (255)
 CONTRACT NO. BR 518