

FARMINGTON EXTREMELY ROCKY
LOAM, 20 TO 60 PERCENT SLOPES
HYDRO. SOIL GROUP D
K = 0.32

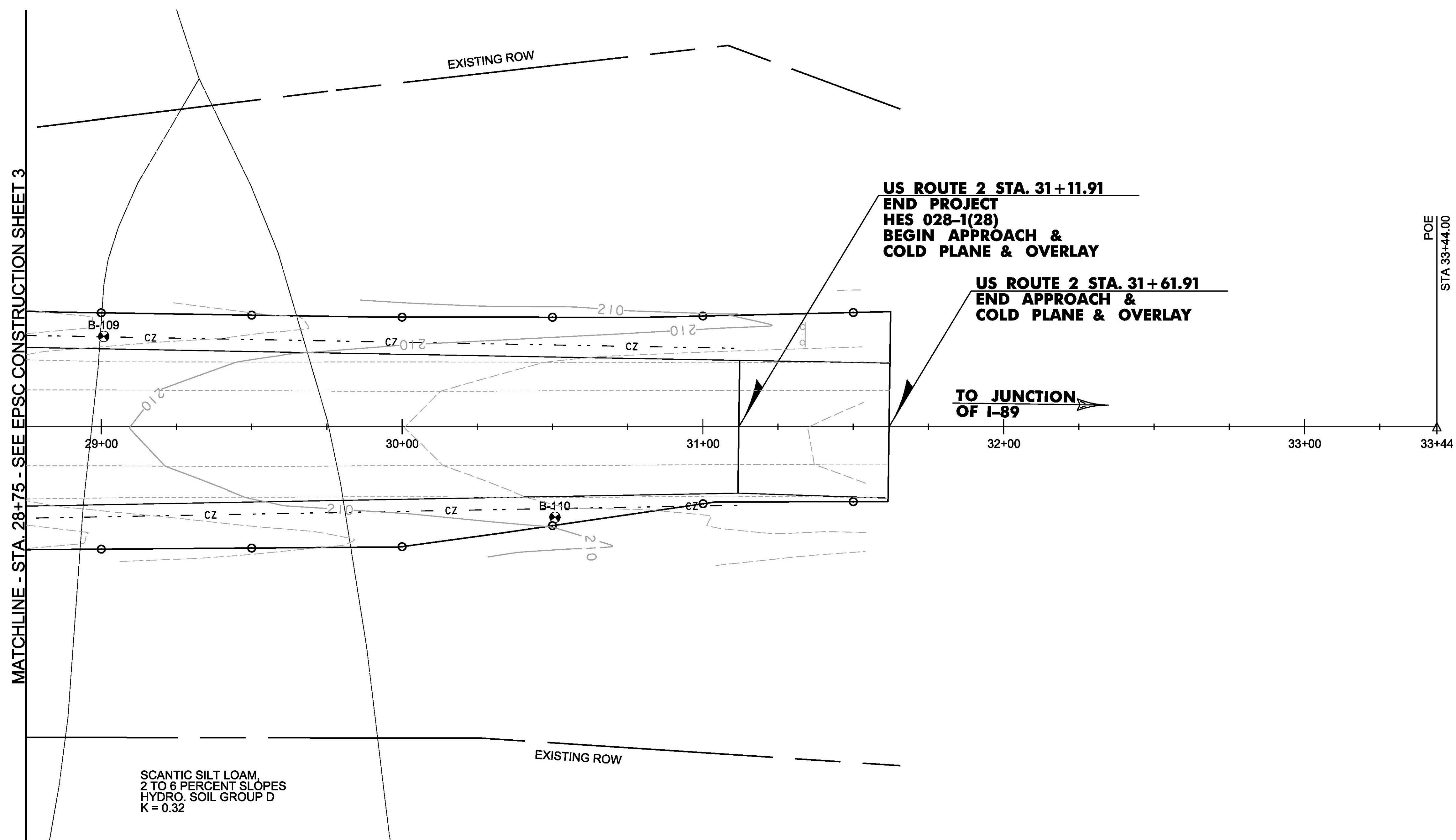

MATCHLINE - STA. 28+75 - SEE EPSC CONSTRUCTION SHEET 3

US ROUTE 2 STA. 31+11.91
END PROJECT
HES 028-1(28)
BEGIN APPROACH &
COLD PLANE & OVERLAY





US ROUTE 2 STA. 31+61.91
END APPROACH &
COLD PLANE & OVERLAY

TO JUNCTION
OF I-89 →

POE
STA 33+44.00

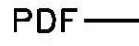
SCANTIC SILT LOAM,
2 TO 6 PERCENT SLOPES
HYDRO. SOIL GROUP D
K = 0.32

LEGEND

-  LIMITS OF CONSTRUCTION
-  PROJECT DEMARCATION FENCE
-  TEMPORARY STONE CHECK DAM, TYPE I
-  TEMPORARY EROSION MATTING
-  INLET PROTECTION, TYPE I

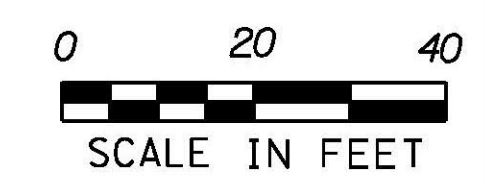

PROJECT NAME: COLCHESTER		PLOT DATE: 11/23/2015	
PROJECT NUMBER: HES 028-1(28)		DRAWN BY: M. BOGACZYK	
FILE NAME: t13b028ero.dgn	DESIGNED BY: M. BOGACZYK	CHECKED BY: M. LACROIX	SHEET 50 OF 91
EPSC CONSTRUCTION SHEET 4			