

# CLAY POINT ROAD

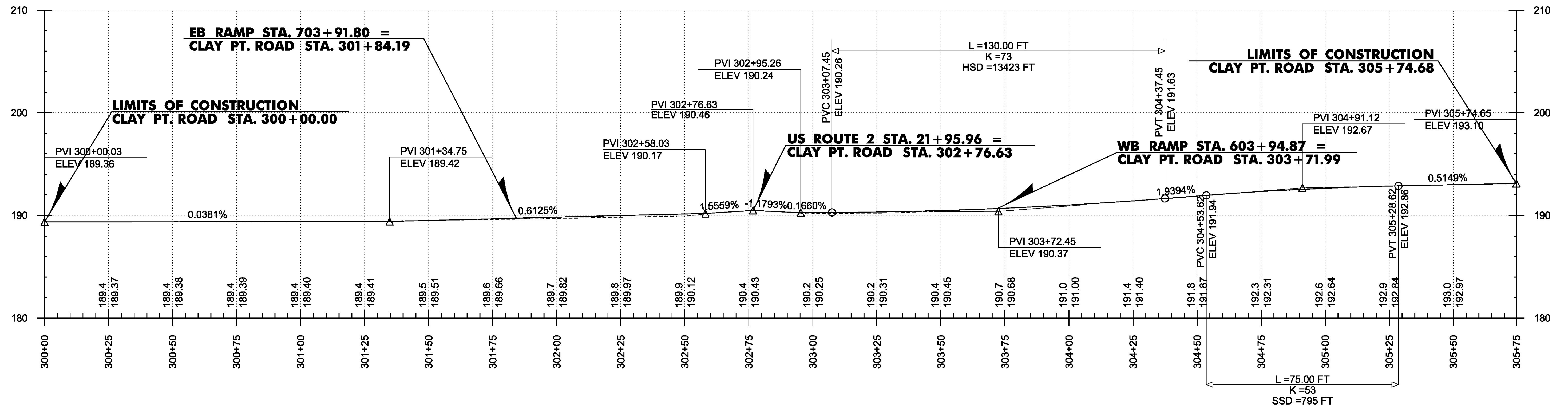

NOTE: ALL STATIONING AND ELEVATIONS IN FEET. GRADES TO ONE TENTH OF A FOOT ARE EXISTING, GRADES TO ONE HUNDRETH OF A FOOT ARE PROPOSED.

PROJECT NAME:	COLCHESTER
PROJECT NUMBER:	HES 028-1(28)
FILE NAME:	t13b028pro.dgn
PROJECT LEADER:	P. COBURN
DESIGNED BY:	M. BOGACZYK
ROADWAY PROFILE & BANKING SHEET 5	
PLOT DATE:	11/23/2015
DRAWN BY:	M. BOGACZYK
CHECKED BY:	M. LACROIX
SHEET	36 OF 91