

US ROUTE 2			
	STATION	NORTHING	EASTING
Element: Linear			
POB	0+00.00	767518.2178	1456906.4377
PC	3+10.95	767216.5782	1456981.9686
TANGENT DIRECTION:	S 14°03'28.37" E		
TANGENT LENGTH:	310.95		
Element: CURVE #1			
PC	3+10.95	767216.5782	1456987.9686
PI	9+85.29	766562.4318	1457145.7677
CC		767690.2371	1458873.5677
PT	16+09.43	766149.2188	1457678.6775
RADIUS:	1950		
DELTA:	38°09'08.91" Left		
DEGREE OF CURVATURE (ARC):	2°56'17.68"		
LENGTH:	1298.48		
TANGENT:	674.34		
CHORD:	1274.62		
MIDDLE ORDINATE:	107.09		
EXTERNAL:	113.31		
TANGENT DIRECTION:	S 14°03'28.37" E		
RADIAL DIRECTION:	S 75°56'31.63" W		
CHORD DIRECTION:	S 33°08'02.82" E		
RADIAL DIRECTION:	S 37°47'22.72" W		
TANGENT DIRECTION:	S 52°12'37.28" E		

DATUM

VERTICAL NAVD 88 ORTHO
 HORIZONTAL NAD 83 (2011)

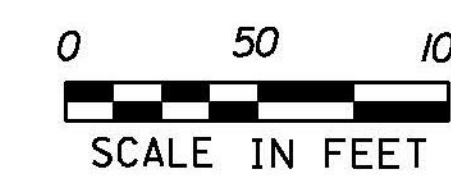
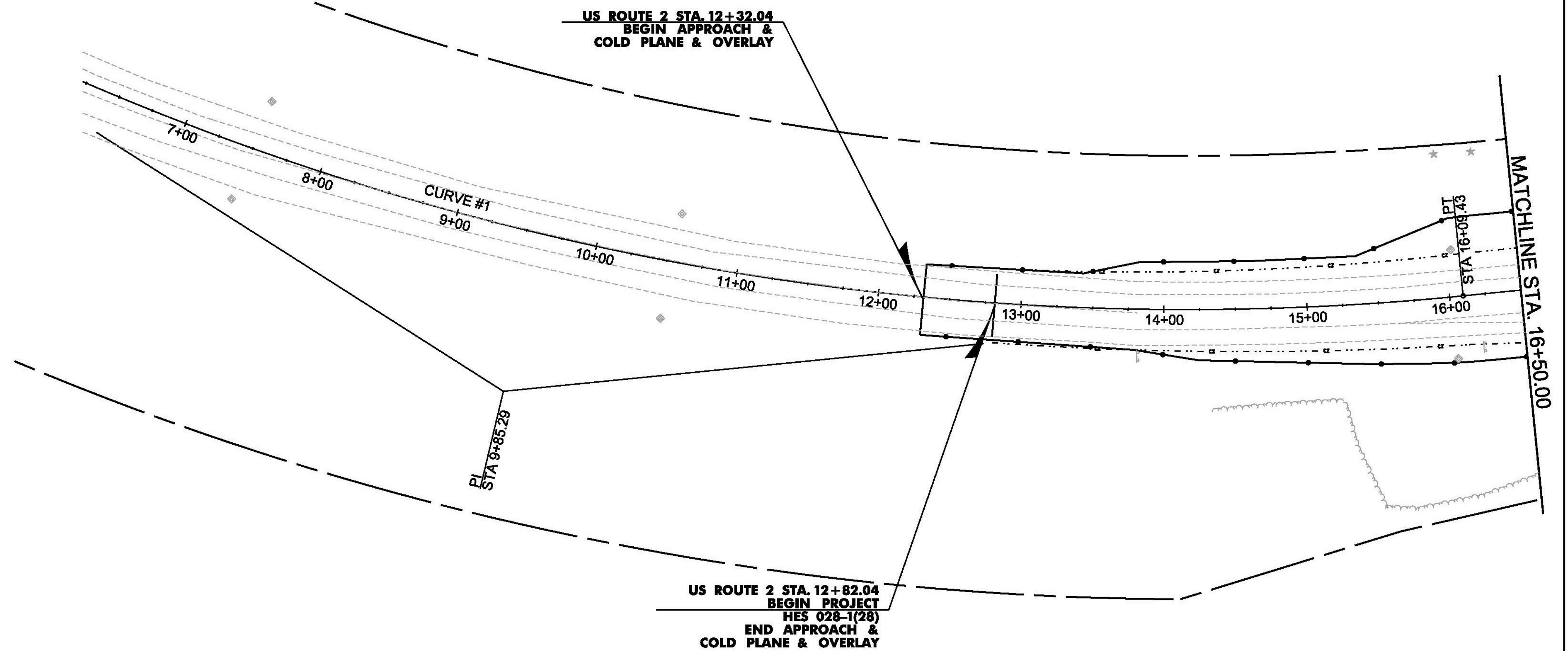

PROJECT NAME:	COLCHESTER	PLOT DATE:	12/7/2015
PROJECT NUMBER:	HES 028-1(28)	DRAWN BY:	M. BOGACZYK
FILE NAME:	+13b028all.dgn	CHECKED BY:	M. LACROIX
PROJECT LEADER:	P. COBURN	ALIGNMENT SHEET	1
DESIGNED BY:	M. BOGACZYK	SHEET	16 OF 91