

STATE OF VERMONT  
 AGENCY OF TRANSPORTATION



PROPOSED IMPROVEMENT  
 TOWN OF MILTON  
 COUNTY OF CHITTENDEN  
 US ROUTE 2 - (MINOR ARTERIAL)

BEGINNING IN THE TOWN OF MILTON ON US ROUTE 2 AT STATION 161+50.00  
 (MM 3.059) AND EXTENDING EASTERLY 0.317 MILES TO STATION 178+25.00  
 (MM 3.376)

WORK TO BE PERFORMED UNDER THIS PROJECT INCLUDES THE  
 INSTALLATION OF NEW TRAFFIC SIGNS.

TOTAL PROJECT LENGTH = 1675 FT = 0.317 MI

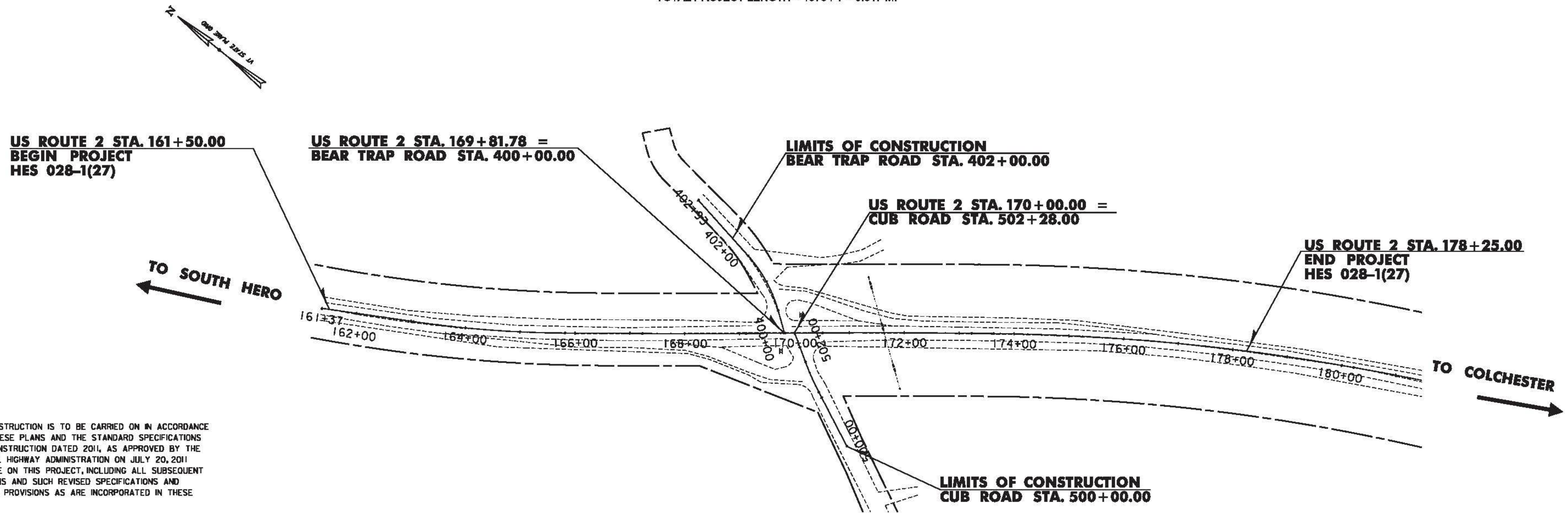
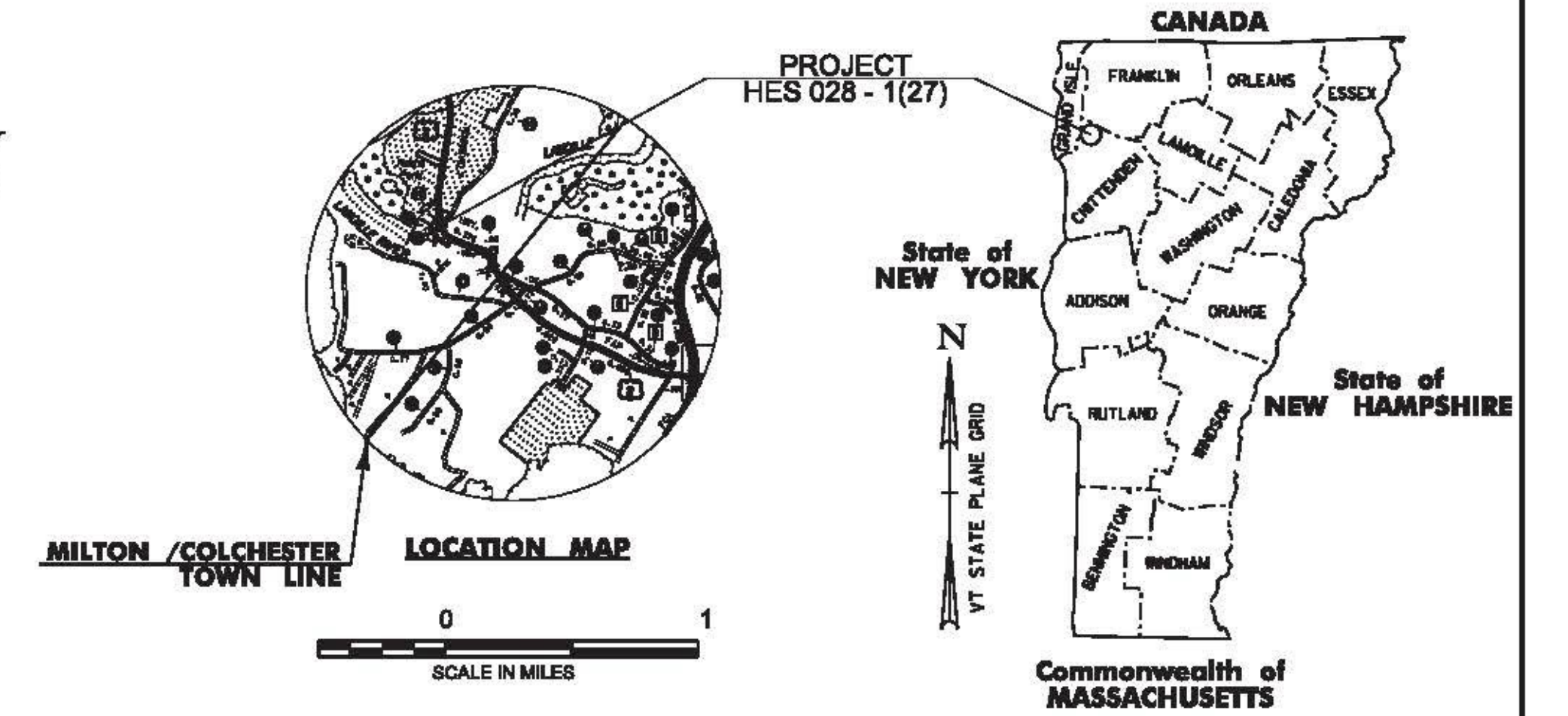

CONSTRUCTION IS TO BE CARRIED ON IN ACCORDANCE  
 WITH THESE PLANS AND THE STANDARD SPECIFICATIONS  
 FOR CONSTRUCTION DATED 2011, AS APPROVED BY THE  
 FEDERAL HIGHWAY ADMINISTRATION ON JULY 20, 2011  
 FOR USE ON THIS PROJECT, INCLUDING ALL SUBSEQUENT  
 REVISIONS AND SUCH REVISED SPECIFICATIONS AND  
 SPECIAL PROVISIONS AS ARE INCORPORATED IN THESE  
 PLANS.

QUALITY ASSURANCE PROGRAM : LEVEL 2

SURVEYED BY : VTRANS, L. ORVIS  
 SURVEYED DATE : MARCH, 2013

DATUM  
 VERTICAL : NAVD 88 ORTHO  
 HORIZONTAL : NAD 83 (2011)

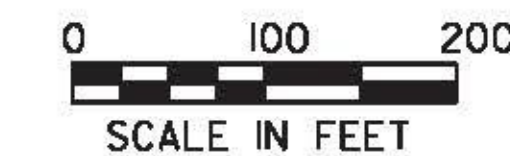

PROJECT MANAGER : PATTI COBURN, P.E.

PROJECT NAME : MILTON  
 PROJECT NUMBER : HES 028-1(27)

SHEET 6 OF 91 SHEETS