

MATCHLINE - STA. 216+50.00 SEE LAYOUT SHEET 2

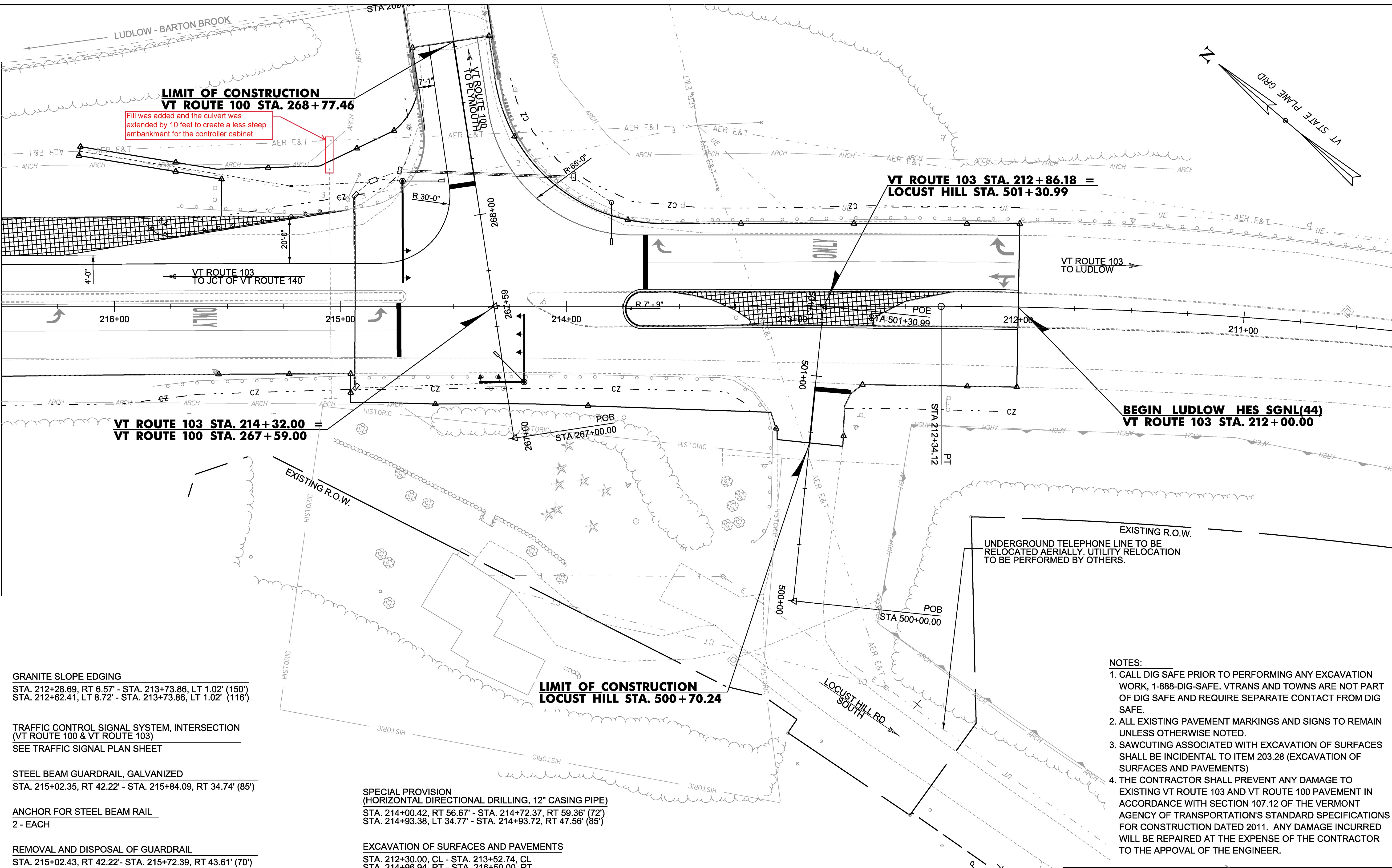

**LIMIT OF CONSTRUCTION
VT ROUTE 100 STA. 268+77.46**

Fill was added and the culvert was extended by 10 feet to create a less steep embankment for the controller cabinet

**VT ROUTE 103 STA. 212+86.18 =
LOCUST HILL STA. 501+30.99**

**VT ROUTE 103 STA. 214+32.00 =
VT ROUTE 100 STA. 267+59.00**

**BEGIN LUDLOW HES SGNL(44)
VT ROUTE 103 STA. 212+00.00**

**LIMIT OF CONSTRUCTION
LOCUST HILL STA. 500+70.24**

EXISTING R.O.W.
UNDERGROUND TELEPHONE LINE TO BE RELOCATED AERIALY. UTILITY RELOCATION TO BE PERFORMED BY OTHERS.

GRANITE SLOPE EDGING
STA. 212+28.69, RT 6.57' - STA. 213+73.86, LT 1.02' (150')
STA. 212+62.41, LT 8.72' - STA. 213+73.86, LT 1.02' (116')

**TRAFFIC CONTROL SIGNAL SYSTEM, INTERSECTION
(VT ROUTE 100 & VT ROUTE 103)**
SEE TRAFFIC SIGNAL PLAN SHEET

STEEL BEAM GUARDRAIL, GALVANIZED
STA. 215+02.35, RT 42.22' - STA. 215+84.09, RT 34.74' (85')

ANCHOR FOR STEEL BEAM RAIL
2 - EACH

REMOVAL AND DISPOSAL OF GUARDRAIL
STA. 215+02.43, RT 42.22' - STA. 215+72.39, RT 43.61' (70')

SPECIAL PROVISION (ELECTRIC DEMOLITION)
STA. 268+15.59, LT 56.92' (SEE TRAFFIC SIGNAL PLAN)
STA. 268+43.51, LT 25.16' (SEE TRAFFIC SIGNAL PLAN)

**SPECIAL PROVISION
(HORIZONTAL DIRECTIONAL DRILLING, 12" CASING PIPE)**
STA. 214+00.42, RT 56.67' - STA. 214+72.37, RT 59.36' (72')
STA. 214+93.38, LT 34.77' - STA. 214+93.72, RT 47.56' (85')

EXCAVATION OF SURFACES AND PAVEMENTS
STA. 212+30.00, CL - STA. 213+52.74, CL
STA. 214+96.94, RT - STA. 216+50.00, RT

REMOVE CURB
STA. 213+65.96, RT 6.58' - STA. 214+17.60, RT 3.40' (53')
STA. 213+66.25, LT 8.92' - STA. 214+17.60, RT 3.40' (55')
SEE TYPICAL SECTIONS

- NOTES:**
1. CALL DIG SAFE PRIOR TO PERFORMING ANY EXCAVATION WORK, 1-888-DIG-SAFE. VTRANS AND TOWNS ARE NOT PART OF DIG SAFE AND REQUIRE SEPARATE CONTACT FROM DIG SAFE.
 2. ALL EXISTING PAVEMENT MARKINGS AND SIGNS TO REMAIN UNLESS OTHERWISE NOTED.
 3. SAWCUTTING ASSOCIATED WITH EXCAVATION OF SURFACES SHALL BE INCIDENTAL TO ITEM 203.28 (EXCAVATION OF SURFACES AND PAVEMENTS)
 4. THE CONTRACTOR SHALL PREVENT ANY DAMAGE TO EXISTING VT ROUTE 103 AND VT ROUTE 100 PAVEMENT IN ACCORDANCE WITH SECTION 107.12 OF THE VERMONT AGENCY OF TRANSPORTATION'S STANDARD SPECIFICATIONS FOR CONSTRUCTION DATED 2011. ANY DAMAGE INCURRED WILL BE REPAIRED AT THE EXPENSE OF THE CONTRACTOR TO THE APPROVAL OF THE ENGINEER.

LEGEND

[Cross-hatched box] = EXCAVATION OF SURFACES AND PAVEMENTS



PROJECT NAME: LUDLOW	PLOT DATE: 4/19/2017
PROJECT NUMBER: HES SGNL(44)	DRAWN BY: M. BOGACZYK
FILE NAME: t13b020_nul.dgn	CHECKED BY: P. COBURN
PROJECT LEADER: P. COBURN	SHEET 14 OF 43
DESIGNED BY: M. BOGACZYK	
PLAN SHEET 3	