

STATE OF VERMONT
AGENCY OF TRANSPORTATION

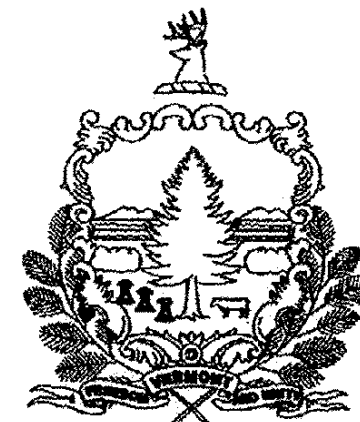

PROPOSED IMPROVEMENT
TOWNS OF HARTFORD, SHARON, ROYALTON, RANDOLPH
COUNTIES OF WINDSOR AND ORANGE
MAJOR COLLECTOR VT ROUTE 14

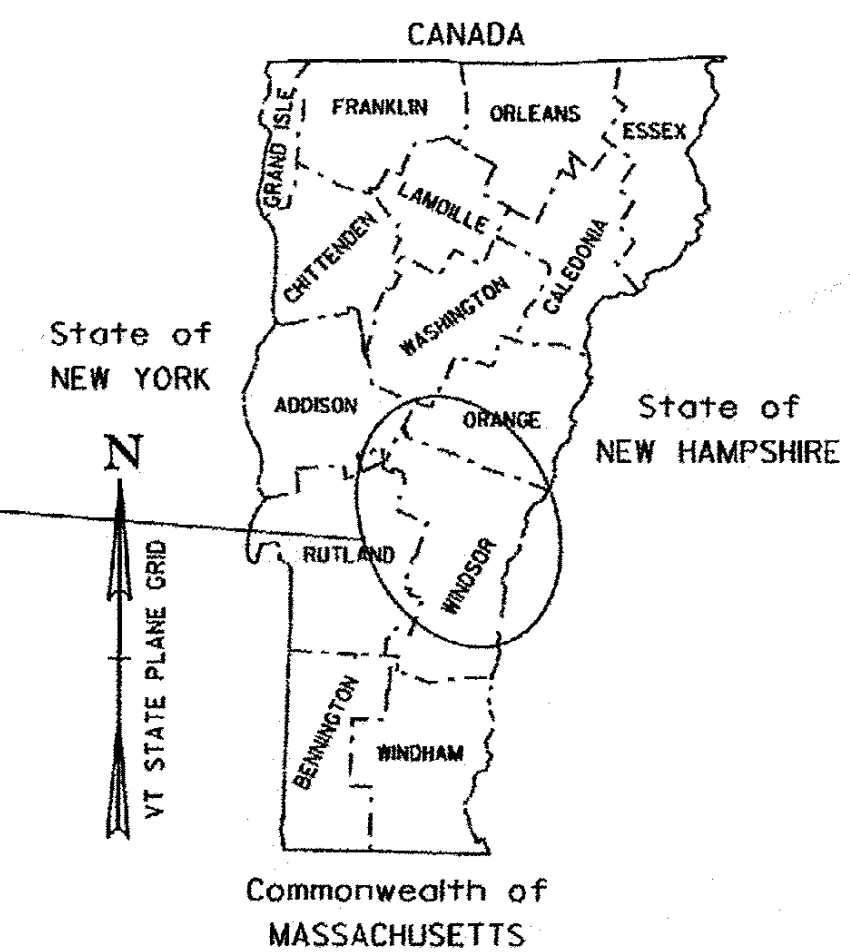

PROJECT LOCATION
HARTFORD-RANDOLPH
ER-0147(21)

RECORD PLANS

CONTRACTOR: WILLEY EARTHMOVING CORP. - WINDSOR, VT

RESIDENT ENGINEER: AL JONES

CONSTRUCTION BEGAN: OCTOBER 1ST, 2013

CONSTRUCTION COMPLETE: MAY 22ND, 2014

RECORD PLANS BY: AL JONES & PERCY BANNERMAN

I HEREBY CERTIFY THAT ALL THE CONSTRUCTION REQUIRED BY THIS SET OF DRAWINGS HAS BEEN ACCOMPLISHED AS INDICATED HEREIN.

BY: *Al Jones* RESIDENT ENGINEER
DATE: 6/22/15

NOTE: Any further information concerning final quantities, amounts or other details relative to this project may be found at Central Files in the electronic archives.

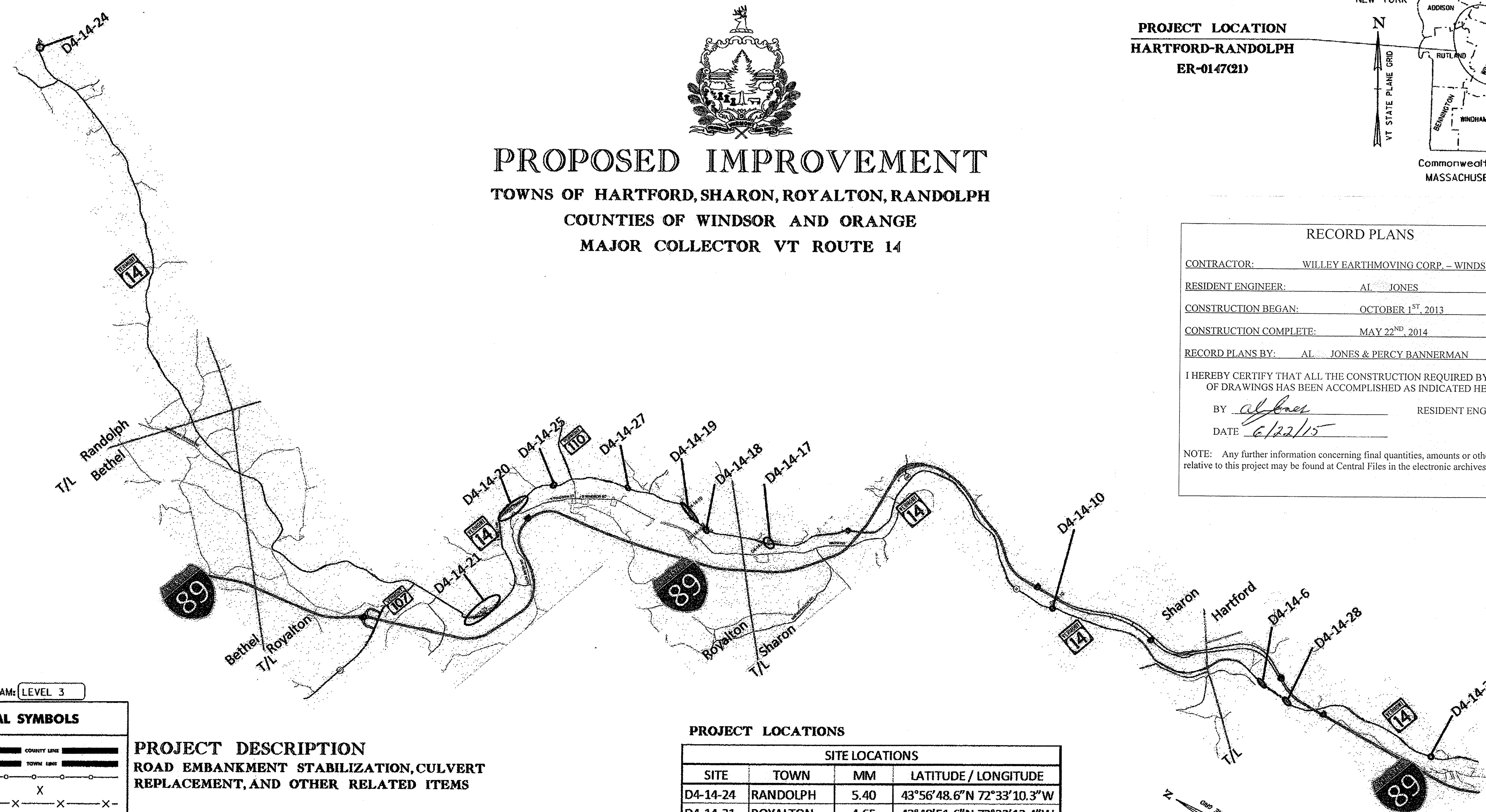

QUALITY ASSURANCE PROGRAM: LEVEL 3

CONVENTIONAL SYMBOLS

COUNTY LINE	
TOWN LINE	
LIMITS OF ACCESS	
POINT OF ACCESS	
FENCE LINE	
STONE WALL	
TRAVELED WAY	
GUARD RAIL	
RAILROAD	
SURVEY LINE	
CULVERT	
POWER POLE	
TELEPHONE POLE	
TREES	
CONTROL OF ACCESS	
PROPERTY LINE	
R.O.W. TAKING LINE	
SLOPE RIGHTS	
TOP OF CUT	
TOE OF SLOPE	

PROJECT DESCRIPTION
ROAD EMBANKMENT STABILIZATION, CULVERT REPLACEMENT, AND OTHER RELATED ITEMS

PROJECT LOCATIONS

SITE LOCATIONS			
SITE	TOWN	MM	LATITUDE / LONGITUDE
D4-14-24	RANDOLPH	5.40	43°56'48.6"N 72°33'10.3"W
D4-14-21	ROYALTON	4.65	43°48'51.6"N 72°33'13.4"W
D4-14-20	ROYALTON	3.30	43°49'36.3"N 72°32'12.8"W
D4-14-25	ROYALTON	2.57	43°49'29.3"N 72°31'23.7"W
D4-14-27	ROYALTON	1.68	43°49'0.4"N 72°30'36.7"W
D4-14-19	ROYALTON	0.6-0.9	43°48'19"N 72°30'4.9"W
D4-14-18	ROYALTON	0.42	43°48'1.9"N 72°30'3.3"W
D4-14-17	SHARON	7.16	43°47'26.4"N 72°29'22.9"W
D4-14-10	SHARON	2.24	43°44'57.8"N 72°26'48.1"W
D4-14-6	HARTFORD	7.06	43°42'52.4"N 72°25'5.1"W
D4-14-28	HARTFORD	6.74	43°42'36.4"N 72°24'59.1"W
D4-14-3	HARTFORD	4.62	43°41'3.2"N 72°23'50.3"W

THESE PLANS ARE SUBJECT TO SUCH ENGINEERING CHANGES AS MAY BE REQUIRED BY THE FEDERAL HIGHWAY ADMINISTRATION OR THE DIRECTOR OF PROGRAM DEVELOPMENT.

CONSTRUCTION IS TO BE CARRIED ON IN ACCORDANCE WITH THESE PLANS AND THE STANDARD SPECIFICATIONS FOR CONSTRUCTION DATED 2011 AS APPROVED BY THE FEDERAL HIGHWAY ADMINISTRATION ON JULY 20, 2011 FOR USE ON THIS PROJECT, INCLUDING ALL SUBSEQUENT REVISIONS AND SUCH REVISED SPECIFICATIONS AND SPECIAL PROVISIONS AS ARE INCORPORATED IN THESE PLANS.

DIRECTOR OF OPERATIONS
APPROVED: *Chris Bump* DATE: 6/25/15

PROJECT MANAGER: CHRIS BUMP

PROJECT NAME: HARTFORD-RANDOLPH
PROJECT NUMBER: ER 0147(21)

SHEET 1 OF 20 SHEETS

INDEX OF SHEETS

INDEX OF SHEETS

1.	TITLE SHEET
2.	INDEX OF SHEETS
3.-5.	TYPICAL SHEETS
6.	GENERAL NOTES
7.	QUANTITY SHEET
8.-20	PLAN SHEETS

VAOT DESIGN STANDARDS

D-1	PRECAST REINFORCED DROP INLET	06/01/94
D-33	REINFORCED CONCRETE STRAIGHT HEADWALL	03/12/07
E-100	CONSTRUCTION APPROACH SIGNS	01/02/04
E-101	CONSTRUCTION SIGN DETAILS	05/30/03
E-102	CONSTRUCTION SIGN DETAILS	06/30/03
E-102A	CONSTRUCTION SIGN DETAILS	08/08/04
E-108	CONSTRUCTION ZONE LONGITUDINAL DROP OFFS	12/08/09
E-108A	CONSTRUCTION ZONE LONGITUDINAL DROP OFFS FOR PAVING	12/08/09
E-110	MAJOR MAINTENANCE OPERATION LANE CLOSURE	08/08/95
E-134	BRIDGE NUMBER PLAQUE	08/08/95
E-160	FLANGED CHANNEL STEEL SIGN POST	05/20/99
E-197	DELINEATOR PLACEMENT TYPICAL	04/01/05
G-1	STEEL BEAM GUARDRAIL WITH STEEL POSTS	01/03/00
G-19	GENERIC PLANS FOR GUARDRAIL END TERMINALS	11/15/02

PROJECT NAME:	HARTFORD-RANDOLPH
PROJECT NUMBER:	ER 014-7(21)
FILE NAME:	PLOT DATE: 11-JUL-2013
PROJECT LEADER: CHRIS BUMP	DRAWN BY: ANDREW BERNIER
DESIGNED BY: ANDREW BERNIER	CHECKED BY: MICHELLE REDMOND
INDEX OF SHEETS	SHEET 2 OF 20

STONE FILL SLOPE PROTECTION

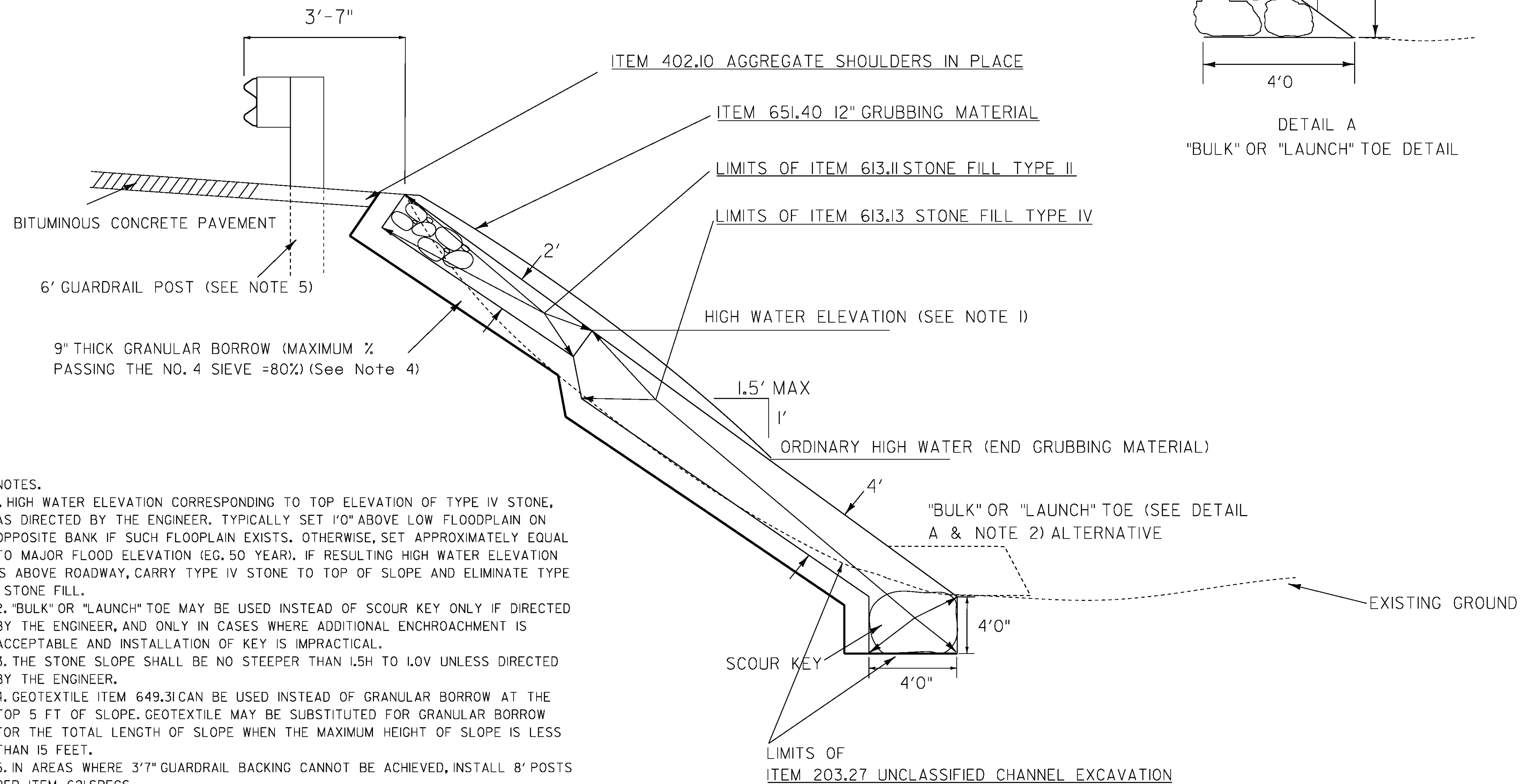

NOTES.

1. HIGH WATER ELEVATION CORRESPONDING TO TOP ELEVATION OF TYPE IV STONE, AS DIRECTED BY THE ENGINEER. TYPICALLY SET 1'0" ABOVE LOW FLOODPLAIN ON OPPOSITE BANK IF SUCH FLOODPLAIN EXISTS. OTHERWISE, SET APPROXIMATELY EQUAL TO MAJOR FLOOD ELEVATION (EG. 50 YEAR). IF RESULTING HIGH WATER ELEVATION IS ABOVE ROADWAY, CARRY TYPE IV STONE TO TOP OF SLOPE AND ELIMINATE TYPE II STONE FILL.
2. "BULK" OR "LAUNCH" TOE MAY BE USED INSTEAD OF SCOUR KEY ONLY IF DIRECTED BY THE ENGINEER, AND ONLY IN CASES WHERE ADDITIONAL ENCHROACHMENT IS ACCEPTABLE AND INSTALLATION OF KEY IS IMPRACTICAL.
3. THE STONE SLOPE SHALL BE NO STEEPER THAN 1.5H TO 1.0V UNLESS DIRECTED BY THE ENGINEER.
4. GEOTEXTILE ITEM 649.31 CAN BE USED INSTEAD OF GRANULAR BORROW AT THE TOP 5 FT OF SLOPE. GEOTEXTILE MAY BE SUBSTITUTED FOR GRANULAR BORROW FOR THE TOTAL LENGTH OF SLOPE WHEN THE MAXIMUM HEIGHT OF SLOPE IS LESS THAN 15 FEET.
5. IN AREAS WHERE 3'7" GUARDRAIL BACKING CANNOT BE ACHIEVED, INSTALL 8' POSTS PER ITEM 621 SPECS

PROJECT NAME:	HARTFORD-RANDOLPH
PROJECT NUMBER:	ER 014-7(21)
FILE NAME:	PLOT DATE: 11-JUL-2013
PROJECT LEADER: CHRIS BUMP	DRAWN BY: ANDREW BERNIER
DESIGNED BY: ANDREW BERNIER	CHECKED BY: MICHELLE REDMOND
TYPICAL SHEETS	SHEET 3 OF 20

STONE FILL SLOPE PROTECTION WITH STONE TOE WALL

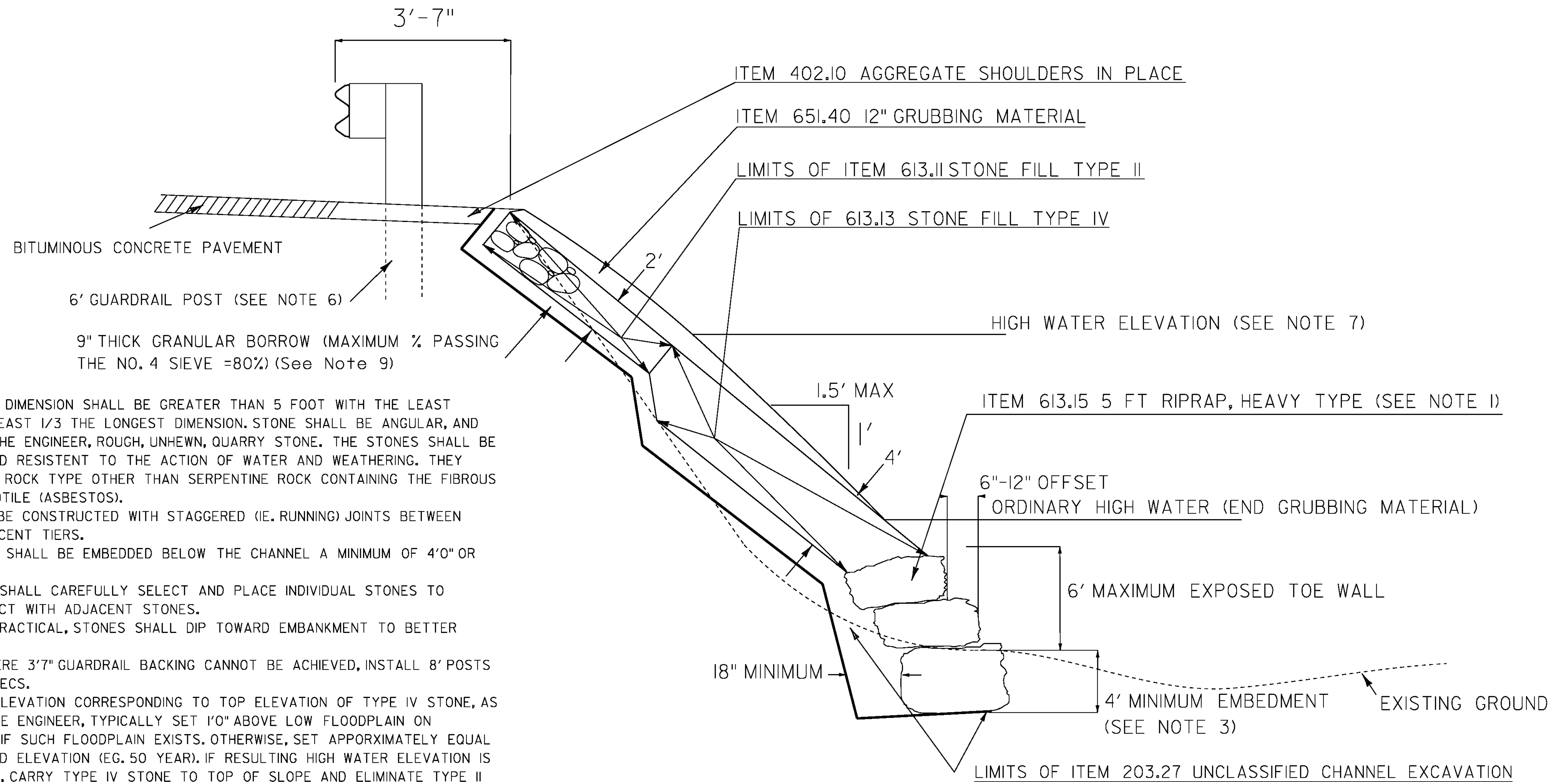

NOTES.

1. THE PRINCIPLE DIMENSION SHALL BE GREATER THAN 5 FOOT WITH THE LEAST DIMENSION AT LEAST 1/3 THE LONGEST DIMENSION. STONE SHALL BE ANGULAR, AND APPROVED BY THE ENGINEER, ROUGH, UNHEWN, QUARRY STONE. THE STONES SHALL BE HARD, SOUND AND RESISTANT TO THE ACTION OF WATER AND WEATHERING. THEY SHALL BE OF A ROCK TYPE OTHER THAN SERPENTINE ROCK CONTAINING THE FIBROUS VARIETY CHRYSOTILE (ASBESTOS).
2. WALL SHALL BE CONSTRUCTED WITH STAGGERED (IE. RUNNING) JOINTS BETWEEN ROCKS ON ADJACENT TIERS.
3. FOOTER ROCK SHALL BE EMBEDDED BELOW THE CHANNEL A MINIMUM OF 4'0" OR ON BEDROCK.
4. CONTRACTOR SHALL CAREFULLY SELECT AND PLACE INDIVIDUAL STONES TO MAXIMIZE CONTACT WITH ADJACENT STONES.
5. TO EXTENT PRACTICAL, STONES SHALL DIP TOWARD EMBANKMENT TO BETTER RESIST SLIDING.
6. IN AREAS WHERE 3'7" GUARDRAIL BACKING CANNOT BE ACHIEVED, INSTALL 8' POSTS PER ITEM 621 SPECS.
7. HIGH WATER ELEVATION CORRESPONDING TO TOP ELEVATION OF TYPE IV STONE, AS DIRECTED BY THE ENGINEER, TYPICALLY SET 1'0" ABOVE LOW FLOODPLAIN ON OPPOSITE BANK IF SUCH FLOODPLAIN EXISTS. OTHERWISE, SET APPROXIMATELY EQUAL TO MAJOR FLOOD ELEVATION (EG. 50 YEAR). IF RESULTING HIGH WATER ELEVATION IS ABOVE ROADWAY, CARRY TYPE IV STONE TO TOP OF SLOPE AND ELIMINATE TYPE II STONE FILL.
8. THE STONE SLOPE SHALL BE NO STEEPER THAN 1.5H TO 1.0V UNLESS DIRECTED BY THE ENGINEER.
9. GEOTEXTILE ITEM 649.31 CAN BE USED INSTEAD OF GRANULAR BORROW AT THE TOP 5 FEET OF SLOPE. GEOTEXTILE MAY BE USED FOR THE TOTAL LENGTH OF SLOPE WHEN THE MAXIMUM HEIGHT OF THE SLOPE IS LESS THAN 15 FEET.

PROJECT NAME: HARTFORD-RANDOLPH	
PROJECT NUMBER: ER 014-7(21)	
FILE NAME:	PLOT DATE: 11-JUL-2013
PROJECT LEADER: CHRIS BUMP	DRAWN BY: ANDREW BERNIER
DESIGNED BY: ANDREW BERNIER	CHECKED BY: MICHELLE REDMOND
TYPICAL SHEETS	SHEET 4 OF 20

CULVERT REPLACEMENT AND ROADWAY

DETAIL AA

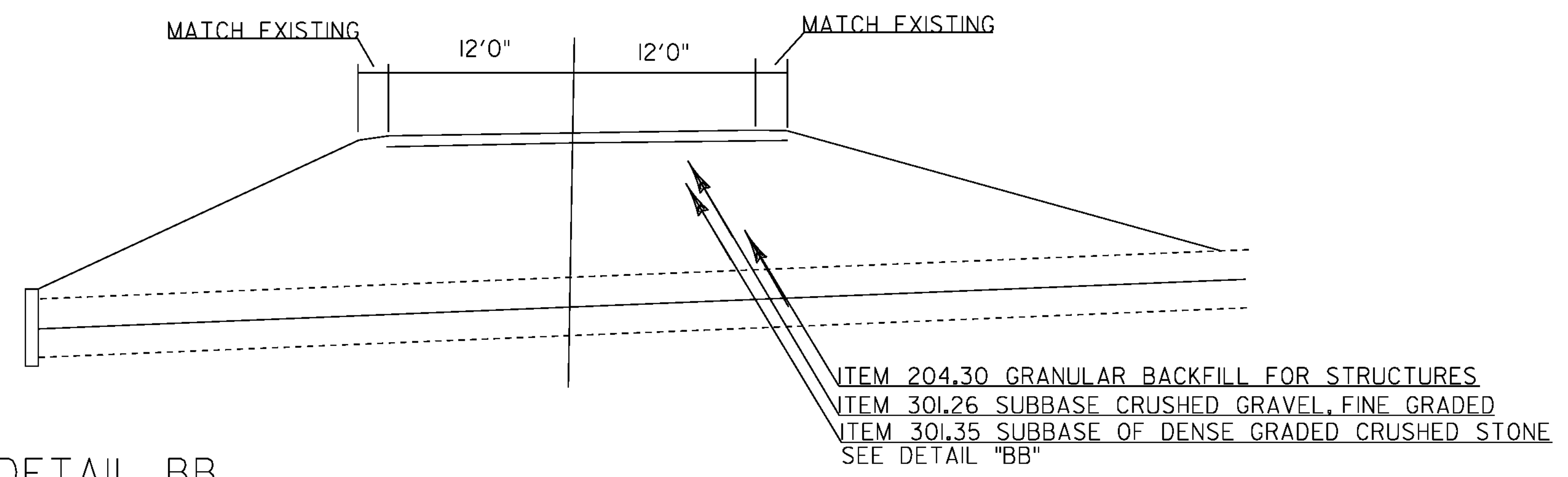

DETAIL BB

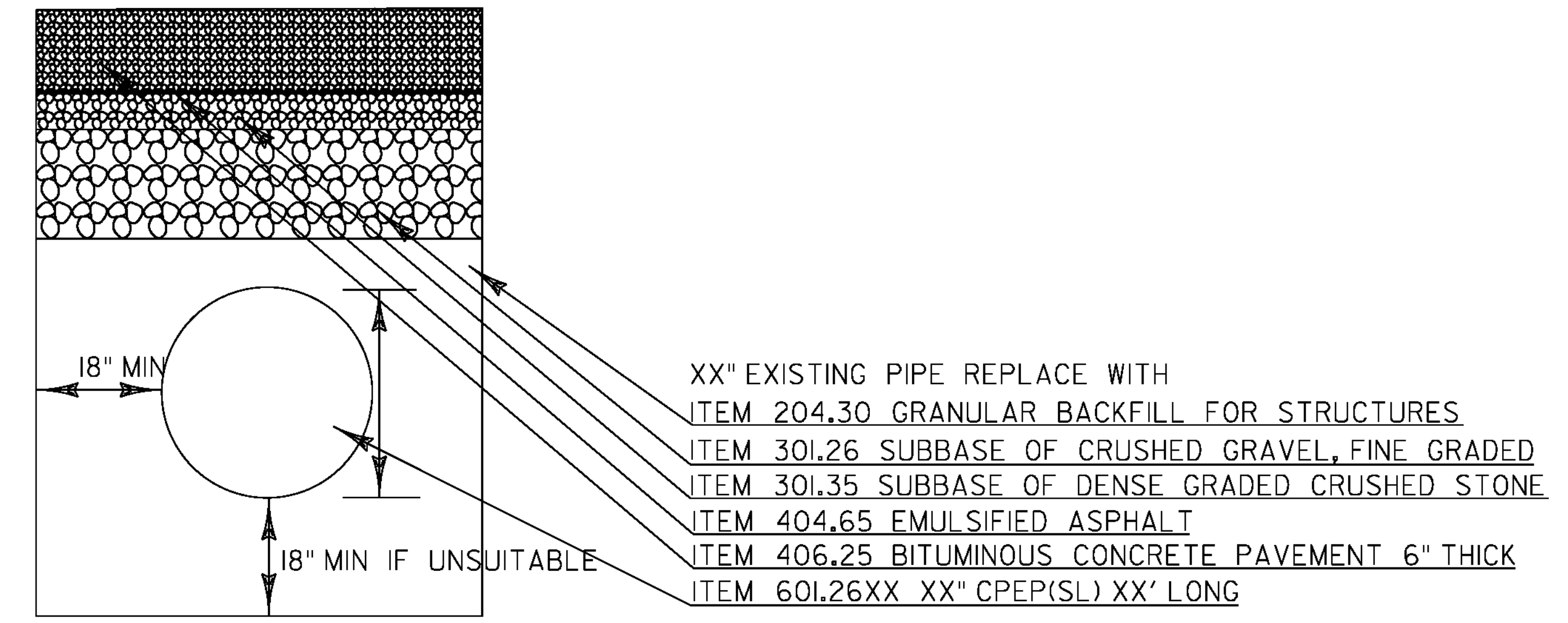

PROJECT NAME:	HARTFORD-RANDOLPH
PROJECT NUMBER:	ER 014-7(21)
FILE NAME:	PLOT DATE: 11-JUL-2013
PROJECT LEADER: CHRIS BUMP	DRAWN BY: ANDREW BERNIER
DESIGNED BY: ANDREW BERNIER	CHECKED BY: MICHELLE REDMOND
TYPICAL SHEETS	SHEET 5 OF 20

GENERAL NOTES

1. ALL MATERIALS AND CONSTRUCTION SHALL BE IN ACCORDANCE WITH THESE PLANS AND THE VAOT STANDARD SPECIFICATIONS FOR CONSTRUCTION DATED 2011, AS APPROVED BY THE FEDERAL HIGHWAY ADMINISTRATION, INCLUDING ALL SUBSEQUENT REVISIONS AND REVISED SPECIFICATIONS AND SPECIAL PROVISIONS INCORPORATED IN THE CONTRACT DOCUMENTS.
2. EXISTING DIMENSIONS SHOWN IN THE PLANS WERE DEVELOPED FROM LIMITED FIELD SURVEY. THE CONTRACTOR SHALL BE RESPONSIBLE FOR FIELD VERIFYING ALL DIMENSIONS AND ASSOCIATED QUANTITIES APPLICABLE TO THIS WORK.
3. THE CONTRACTOR SHALL TAKE ALL NECESSARY PRECAUTIONS TO PROTECT THE EXISTING PAVEMENT, PAVEMENT MARKINGS, GUARDRAIL, FENCING, PIPES, DROP INLETS, CONCRETE SIGN FOUNDATIONS AND HEADWALLS. THE CONTRACTOR SHALL REPAIR ALL EXISTING PAVEMENT, PAVEMENT MARKINGS, GUARDRAIL, FENCING, PIPES, DROP INLETS, CONCRETE SIGN FOUNDATIONS AND HEADWALLS DAMAGED DURING CONSTRUCTION ACTIVITIES TO THE SATISFACTION OF THE ENGINEER AT NO ADDITIONAL COMPENSATION.
4. IF SIGNS NEED TO BE MOVED BECAUSE OF CONSTRUCTION ACTIVITY COSTS FOR REMOVING AND RESETTING SIGNS SHALL BE INCIDENTAL TO ITEM 641.10 TRAFFIC CONTROL
5. CONTRACTOR SHALL CONTACT DIGSAFE PER ACT NO. 86 OF 1987(30 VSA CHAPTER 86) PRIOR TO CONSTRUCTION.
6. INSTALLATION OF INITIAL APPROX. 25' STONE FILL SLOPE PROTECTION SHALL BE CONSIDERED A TEST SECTION; TEST SECTION MUST BE APPROVED BY ENGINEER PRIOR TO INSTALLATION OF ADDITIONAL STONE FILL; COSTS WILL BE CONSIDERED INCIDENTAL TO STONE FILL ITEMS.
7. THE CONTRACTOR IS RESPONSIBLE FOR INSTALLING THE STONE FILL AS A WELL-COMPACTED MASS FULL DEPTH, WITH STONES INTERLOCKED WITH EACH OTHER AND WITH NO LARGE VOIDS TO REDUCE THE POTENTIAL FOR UPLIFT AND MOVEMENT AND TO PREVENT GRUBBING MATERIAL FROM WASHING INTO THE STONE.
8. THE CONTRACTOR SHALL PLACE A 12" (MINIMUM) LAYER OF GRUBBING MATERIAL OVER THE TOP OF THE FINISHED STONE FILL SLOPE DOWN TO NORMAL HIGH WATER ELEVATION. GRUBBING MATERIAL SHALL BE WORKED IN TO THE STONE FILL MASS, AND INTO ANY SMALL REMAINING SURFACE VOIDS AND CREVASSES.
9. ALL EQUIPMENT SHALL BE MOVED OUTSIDE OF THE CLEAR ZONE OR PROTECTED BY APPROVED BARRIERS DURING NON-WORKING HOURS 10' FROM EDGE OF WHITE LINE OR OTHER APPROVED LOCATION BY ENGINEER.
10. THE CONTRACTOR SHALL USE EFFECTIVE METHODS TO MINIMIZE TURBIDITY WHILE WORKING IN THE STREAM TO THE SATISFACTION OF THE ENGINEER; COST WILL BE CONSIDERED INCIDENTAL TO STONE FILL ITEMS.
11. A MINIMUM OF ONE LANE TRAFFIC SHALL BE MAINTAINED AT ALL TIMES.
12. ALL TRAFFIC CONTROL SHALL CONFORM TO THE VAOT STANDARDS LISTED AND THE 2009 MUTCD.
13. ALL WORK SHALL BE COMPLETED WITHIN THE STATE RIGHT OF WAY OR AS DIRECTED BY THE ENGINEER.
14. ALL MATERIALS SHALL BE FROM PRE-APPROVED SOURCE AND PRODUCTS ON THE APPROVED PRODUCTS LIST.
15. THE CONTRACTOR IS ADVISED TO EXERCISE CAUTION WHILE WORKING IN AREAS OF OVERHEAD AND UNDERGROUND UTILITIES. UTILITIES WILL NOT BE RELOCATED OR DE-ENERGIZED IN PREPARATION FOR THIS PROJECT. CONTRACTOR SHALL PLAN THE WORK ACCORDINGLY. CONTRACTOR COORDINATION WITH THE UTILITIES IS ENCOURAGED FOR THE CONTRACTOR CONVENIENCE SEE UTILITY SPECIAL PROVISIONS FOR ADDITIONAL INFORMATION AND REQUIREMENTS.

SEEDING FORMULA
RURAL AREAS

<u>% WT.</u>	<u>LBS./A.</u>	<u>NAME</u>	<u>PUR %</u>	<u>GERM %</u>
37.5	22.5	CREeping RED FESCUE	98	85
37.5	22.5	TALL FESCUE	95	90
5.0	3.0	RED TOP	95	90
15.0	9.0	BIRDFOOT TREFoil	98	85
5.0	3.0	ANNUAL RYEGRASS	95	85
100.0	60.0			
	80.0			

GENERAL NOTES

- SEED MIXTURE: SHALL NOT HAVE A WEED CONTENT EXCEEDING 0.40% BY WEIGHT AND SHALL BE FREE OF ALL NOXIOUS SEED.
- SEED: TO BE APPLIED PER SEEDING FORMULAS OR AS DIRECTED BY THE ENGINEER.
- FERTILIZER: FORMULA 10-20-10, TO BE USED WITH SEED, APPLIED AT THE RATE OF 500 LBS./ACRE. (HYDRO SEEDERS MAY USE 19-19-19 FORMULA).
- AGRICULTURAL LIMESTONE: TO BE APPLIED AT THE RATE OF 2 TONS/ACRE, OR AS DIRECTED BY THE ENGINEER.
- HAY MULCH: TO BE PLACED ON EARTH SLOPES AT THE RATE OF 2 TONS/ACRE, OR AS DIRECTED BY THE ENGINEER.
- TOPSOIL: TO BE USED WITH SEED AS INDICATED ON THE PLANS, OR AS DIRECTED BY THE ENGINEER.

*DIRECTED BY BILL FARLEY

PROJECT NAME: HARTFORD-RANDOLPH	
PROJECT NUMBER: ER 014-7(21)	
FILE NAME:	PLOT DATE: 11-JUL-2013
PROJECT LEADER: CHRIS BUMP	DRAWN BY: ANDREW BERNIER
DESIGNED BY: ANDREW BERNIER	CHECKED BY: MICHELLE REDMOND
GENERAL NOTES	SHEET 6 OF 20

QUANTITY SHEET

SUMMARY OF ESTIMATED QUANTITIES														TOTALS			DESCRIPTIONS			DETAILED SUMMARY OF QUANTITIES			
RANDOLPH IRN0014-180	ROYALTON IRN0014-190						SHARON IRN0014-199		HARTFORD IRN0014-100				ROADWAY	BRIDGE QUANTITY	ROUND	GRAND TOTAL	FINAL	UNIT	ITEMS	ITEM NUMBER	QUANTITIES	UNIT	ITEMS
	D4-14-24	D4-14-21	D4-14-20	D4-14-25	D4-14-27	D4-14-19	D4-14-18	D4-14-17	D4-14-10	D4-14-6	D4-14-28	D4-14-3											
0.01			0.10	0.39	0.18	0.22	0.10	0.02				0.50			1.52		ACRE	CLEARING AND GRUBBING, INCLUDING INDIVIDUAL TREES AND STUMPS	201.11				
			1239			934				28	44				2245		CY	UNCLASSIFIED EXCAVATION	203.17				
80	1625	1141		2178	1208		1081	36				3412			10759		CY	UNCLASSIFIED CHANNEL EXCAVATION	203.27				
	486	560	125	467		225	250					646			2741		CY	GRANULAR BORROW	203.32				
0.25						0.25		0.25				0.25			1		CY	TRENCH EXCAVATION OF EARTH, EXPLORATORY (N.A.B.I.)	204.22				
	24									13	35				72		CY	GRANULAR BACKFILL FOR STRUCTURES	204.30				
	3									4	4				11		CY	SUBBASE OF CRUSHED GRAVEL, FINE GRADED	301.26				
	13									13	15				41		CY	SUBBASE OF DENSE GRADED CRUSHED STONE	301.35				
	14	10	3	6	11	6					0.20	8			58		CY	AGGREGATE SHOULDERS, IN PLACE	402.10				
	4.80		0.42	0.04							0.06				5		CWT	EMULSIFIED ASPHALT	404.65				
	243		21	6						6	9				286		TON	BITUMINOUS CONCRETE PAVEMENT	406.25				
													1		1		LU	PRICE ADJUSTMENT, ASPHALT CEMENT (N.A.B.I.)	406.50				
	516									376	516				1408		LB	REINFORCING STEEL LEVEL I	507.11				
	2.85									2.05	2.85				8		CY	CONCRETE, CLASS B	541.25				
										40					40		LF	18" CPEP(SL)	601.2615				
	35										40				75		LF	24" CPEP(SL)	601.2620				
										1					1		EACH	PRECAST REINFORCED CONCRETE DROP INLET WITH CAST IRON GRATE	604.18				
	567		252	519	181	445	370	21				676			3031		CY	STONE FILL, TYPE II	613.11				
	1020		242												1262		CY	STONE FILL, TYPE II	613.12				
98		1991		1659	1025	489	711	21				2090			8084		CY	STONE FILL, TYPE IV	613.13				
		1141													1141		CY	RIPRAP, HEAVY TYPE	613.15				
										1					1		CY	RIPRAP, LIGHT TYPE	613.16				
			225												225		LF	STEEL BEAM GUARDRAIL, GALVANIZED	621.20				
			100												100		LF	STEEL BEAM GUARDRAIL, GALVANIZED W/8 FEET POSTS	621.205				
			1												1		EACH	MANUFACTURED TERMINAL SECTION, FLARED	621.50				
					1										1		EACH	MANUFACTURED TERMINAL SECTION, TANGENT	621.51				
65			100	388	350	100					25	425			1453		LF	REMOVE AND RESET GUARD RAIL	621.75				
			38												38		LF	REMOVAL AND DISPOSAL OF GUARD RAIL	621.80				
75			100			100						200			475		LF	TEMPORARY TRAFFIC BARRIER	621.90				
60	100	200	80	200	140	80	40	40		40	40	120			1140		HR	FLAGGERS	630.15				
0.01	0.13	0.16	0.05	0.12	0.10	0.06	0.06	0.01		0.01	0.01	0.17			1		LS	MOBILIZATION / DEMOBILIZATION	635.11				
0.01	0.13	0.16	0.05	0.12	0.10	0.06	0.06	0.01		0.01	0.01	0.17			1		LS	TRAFFIC CONTROL	641.10				
	1530		145	50						10	20				1755		LF	4 INCH WHITE LINE	646.20				
	1530		145							10	20				1705		LF	4 INCH YELLOW LINE	646.21				
69	425	312	76	1943	1410	167	112	120		4					4638		SY	GEOTEXTILE UNDER STONE FILL	649.31				
1	24	19	6	22	15	13	10	1			1	27			138		LB	SEED	651.15				
4	194	154	52	109	89	111	80	10			2	224			1029		LB	FERTILIZER	651.18				
0.020	0.780	0.617	0.206	0.723	0.490	0.440	0.320	0.040		0.010	0.900				5		TON	AGRICULTURAL LIMESTONE	651.20				
0.020	0.780	0.617	0.206	0.720	0.490	0.440	0.320	0.040		0.010	0.900				5		TON	HAYMULCH	651.25				
42	1870	1493	499	1750	857	1067	778	93				2167			10616		SY	GRUBBING MATERIAL	651.40				
42	1870	1493	499	1750	857	1067	778	93			8	2167			10624		SY	TEMPORARY EROSION MATTING	653.20				
					10										10		EA	DECIDUOUS TREES (SUGAR MAPLE) (ACER SACCHARUM) (MIN 1.5')	656.30				
8															6		SF	TRAFFIC SIGNS, TYPE A	675.20				
20							1								21		LF	FLANGED CHANNEL SIGN POST	675.301				
			1												1		EACH	DELINEATOR WITH STEEL POST	676.10				
													1		1		LU	PRICE ADJUSTMENT, FUEL (N.A.B.I.)	690.50				

PROJECT NAME: HARTFORD-RANDOLPH
 PROJECT NUMBER: ER 014-7(21)
 FILE NAME: PLOT DATE:
 PROJECT MANAGER: CHRIS BUMP DRAWN BY:
 DESIGNED BY: ANDREW BERNIER CHECKED BY:
 QUANTITY SHEET #1 SHEET 7 OF 20

**D4-14-24
RANDOLPH**



DRIVE WAY

SAND PIT

VT 14 NORTH BOUND

WOODED AREA

STONE FILL ADDED

BRIDGE 37

FLOW

FLOW

STONE FILL SLOPE PROTECTION DETAIL
10'+/- WIDE BY 23'+/- LONG

- ITEM CLEARING AND GRUBBING INCLUDING INDIVIDUAL TREE AND STUMPS
- ITEM UNCLASSIFIED CHANNEL EXCAVATION
- ITEM STONE FILL, TYPE IV
- ITEM GEOTEXTILE UNDER STONE FILL
- ITEM GRUBBING MATERIAL

OUTLET PAD
10'+/- WIDE BY 12'+/- LONG

- ITEM UNCLASSIFIED CHANNEL EXCAVATION
- ITEM STONE FILL, TYPE IV



VT 14 SOUTH BOUND

MM 5.40

NOTE:

EXACT LIMIT OF WORK TO BY DETERMINED BY THE RESIDENT ENGINEER.
UTILITIES ARE SHOWN ON PLANS FOR APPROXIMATE LOCATION AND HAVE NOT BEEN VERIFIED,
CONTRACTOR IS ADVISED TO CONTACT DIGSAFE PER GENERAL NOTE 5 ON SHEET 6 *NTS

PROJECT NAME: HARTFORD-RANDOLPH
PROJECT NUMBER: ER 014-7(21)

FILE NAME:
PROJECT LEADER: CHRIS BUMP
DESIGNED BY: ANDREW BERNIER
PLAN SHEETS

PLOT DATE: 11-JUL-2013
DRAWN BY: ANDREW BERNIER
CHECKED BY: MICHELLE REDMOND
SHEET 8 OF 20

D4-14-21
ROYALTON

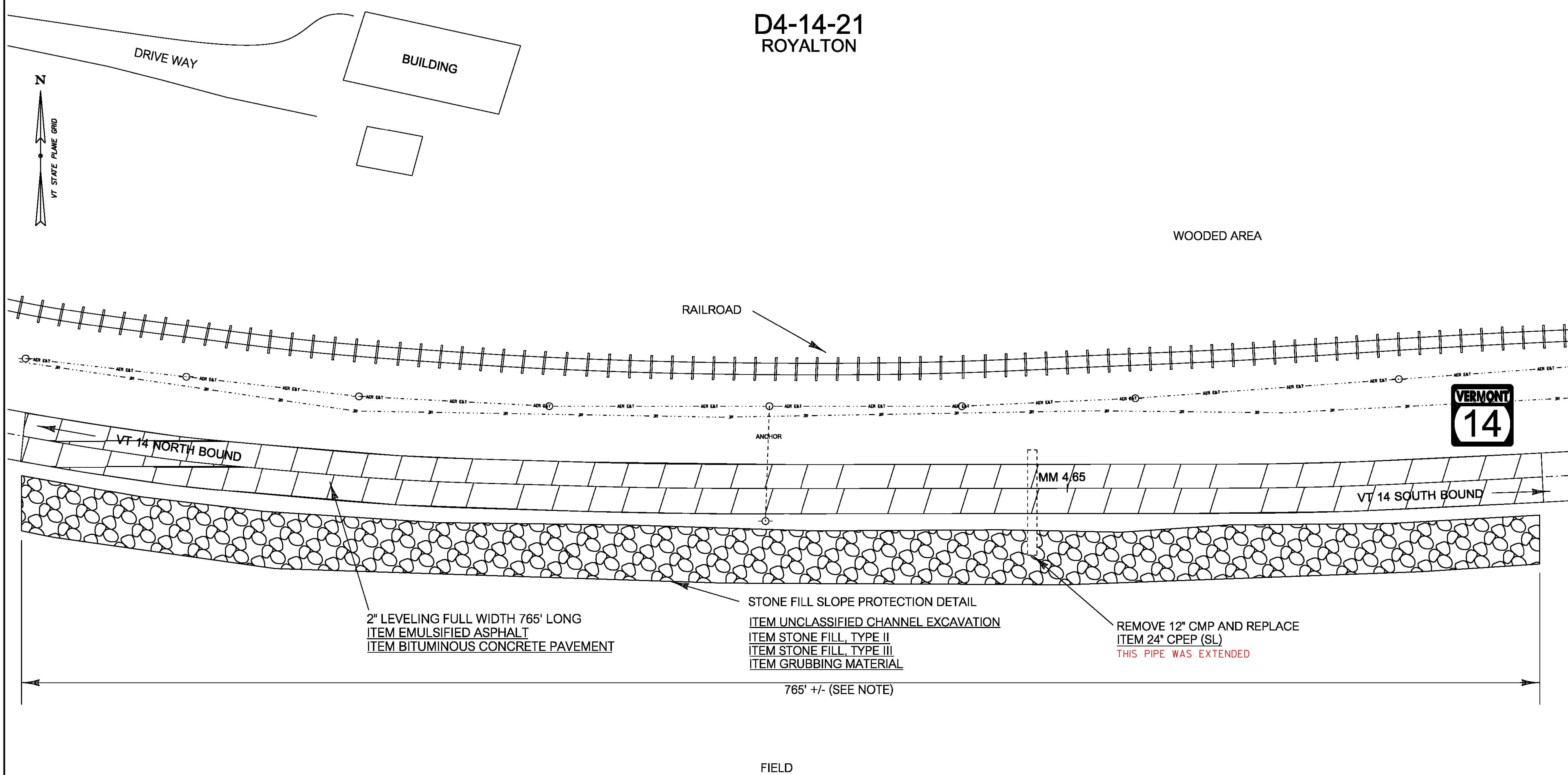

PROPERTY OWNERS:
SUSAN L CAIN
HARVEY & RUBY BALLOU
RIGHT OF ENTRY

NOTE:

EXACT LIMIT OF WORK TO BY DETERMINED BY THE RESIDENT ENGINEER.
UTILITIES ARE SHOWN ON PLANS FOR APPROXIMATE LOCATION AND HAVE NOT BEEN VERIFIED,
CONTRACTOR IS ADVISED TO CONTACT DIGSAFE PER GENERAL NOTE 5 ON SHEET 6

*NTS

PROJECT NAME:	HARTFORD-RANDOLPH
PROJECT NUMBER:	ER 014-7(21)
FILE NAME:	PLOT DATE: 11-JUL-2013
PROJECT LEADER: CHRIS BUMP	DRAWN BY: ANDREW BERNIER
DESIGNED BY: ANDREW BERNIER	CHECKED BY: MICHELLE REDMOND
PLAN SHEETS	SHEET 9 OF 20

D4-14-20
ROYALTON

PROPERTY OWNERS:
MARGRET (PEG) ELMER
RIGHT OF ENTRY/ LIMITED RELEASE

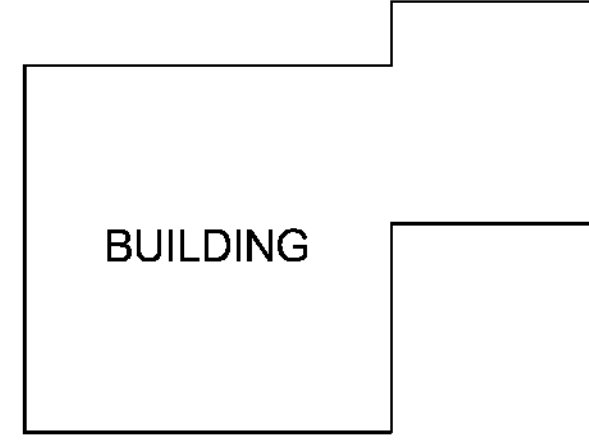

THE EXISTING WALKING PATH SHALL BE RE-ESTABLISHED DURING THE PLACEMENT OF STONE FILL. THE STONE FILL SHALL BE CHINKED ELIMINATE VOIDS AND COVERED WITH A LAYER OF BANK RUN GRAVEL 6 FEET WIDE AND 1 FOOT DEEP. THIS WORK SHALL BE INCIDENTAL TO ITEM STONE FILL TYPE IV.

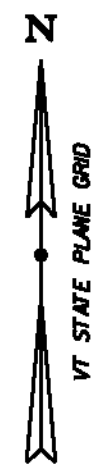

PROPERTY OWNERS:
CHARLES & KATHY WELCH
RIGHT OF ENTRY

WOODED AREA



MM 3.30

VT 14 SOUTH BOUND

VT 14 NORTH BOUND

STONE FILL SLOPE PROTECTION WITH STONE TOE WALL

- ITEM UNCLASSIFIED CHANNEL EXCAVATION
- ITEM STONE FILL, TYPE IV
- ITEM RIP RAP, HEAVY TYPE
- ITEM GRUBBING MATERIAL

LEDGE

560' +/- (SEE NOTE)

WHITE RIVER

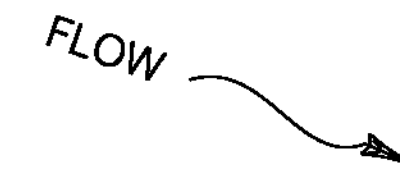

NOTE:

EXACT LIMIT OF WORK TO BY DETERMINED BY THE RESIDENT ENGINEER. UTILITIES ARE SHOWN ON PLANS FOR APPROXIMATE LOCATION AND HAVE NOT BEEN VERIFIED, CONTRACTOR IS ADVISED TO CONTACT DIGSAFE PER GENERAL NOTE 5 ON SHEET 6

*NTS

PROJECT NAME: HARTFORD-RANDOLPH	
PROJECT NUMBER: ER 014-7(21)	
FILE NAME:	PLOT DATE: 11-JUL-2013
PROJECT LEADER: CHRIS BUMP	DRAWN BY: ANDREW BERNIER
DESIGNED BY: ANDREW BERNIER	CHECKED BY: MICHELLE REDMOND
PLAN SHEETS	SHEET 10 OF 20

D4-14-25
ROYALTON

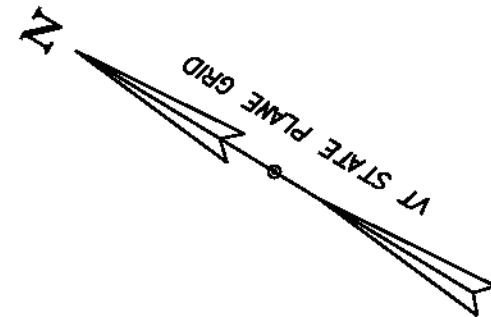

ITEM REMOVAL AND DISPOSAL OF GUARDRAIL
(END SECTION)
ATTACH TO EXISTING GUARDRAIL
ITEM STEEL BEAM GUARDRAIL, GALVANIZED

2" LEVELING SOUTHBOUND LANE
ITEM EMULSIFIED ASPHALT
ITEM BITUMINOUS CONCRETE PAVEMENT

STONE FILL SLOPE PROTECTION DETAIL
ITEM CLEARING AND GRUBBING
ITEM UNCLASSIFIED EXCAVATION
ITEM STONE FILL, TYPE II
ITEM STONE FILL, TYPE III
ITEM GRUBBING MATERIAL

PROPERTY OWNERS:
WARREN E. WILLIAMS
RIGHT OF ENTRY

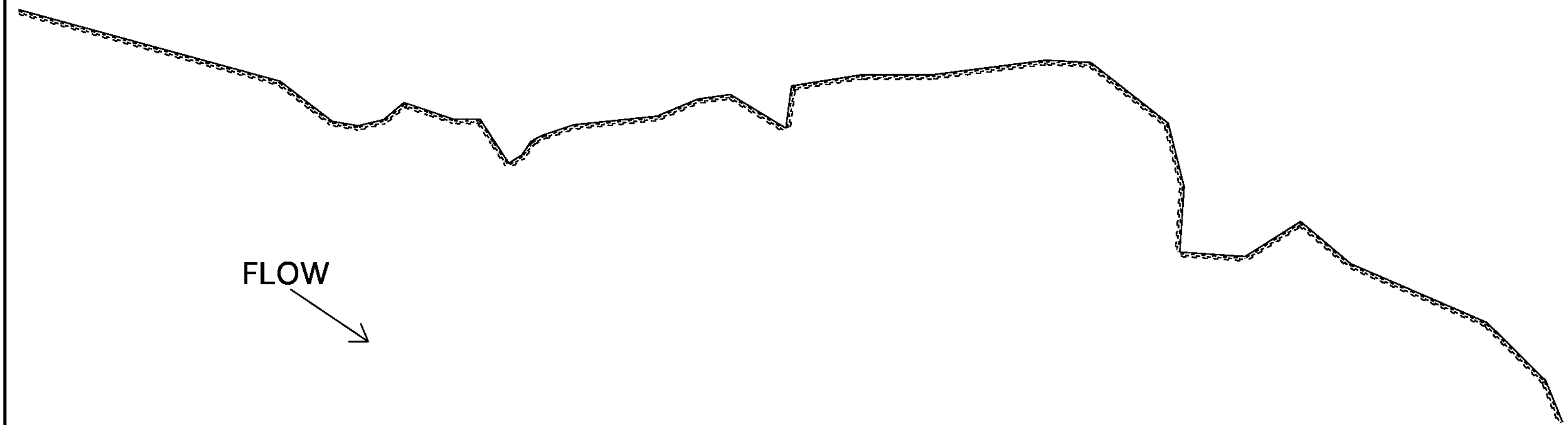

NOTE:

EXACT LIMIT OF WORK TO BY DETERMINED BY THE
RESIDENT ENGINEER.
UTILITIES ARE SHOWN ON PLANS FOR
APPROXIMATE LOCATION AND HAVE NOT BEEN
VERIFIED, CONTRACTOR IS ADVISED TO CONTACT
DIGSAFE PER GENERAL NOTE 5

***NTS**

PROJECT NAME:	HARTFORD-RANDOLPH
PROJECT NUMBER:	ER 014-7(21)
FILE NAME:	
PROJECT LEADER:	CHRIS BUMP
DESIGNED BY:	ANDREW BERNIER
PLAN SHEETS	
PLOT DATE:	11-JUL-2013
DRAWN BY:	ANDREW BERNIER
CHECKED BY:	MICHELLE REDMOND
SHEET	11 OF 20

D4-14-27
ROYALTON

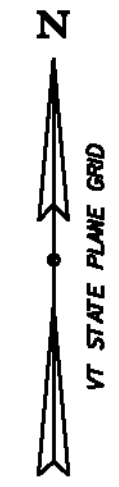

WHITE RIVER

350' +/- (SEE NOTE)
FLOW

MM 1.75

VT 14 NORTH BOUND

STONE FILL SLOPE PROTECTION DETAIL
ITEM UNCLASSIFIED CHANNEL EXCAVATION
ITEM STONE FILL, TYPE II
ITEM STONE FILL, TYPE IV
ITEM GRUBBING MATERIAL

WOODED AREA

REPLACE PAVEMENT ON SHOULDER
50' +/- BY 5' WIDE
ITEM BITUMINOUS CONCRETE PAVEMENT

MM 1.68

VT 14 SOUTH BOUND

NOTE:

EXACT LIMIT OF WORK TO BE DETERMINED BY THE RESIDENT ENGINEER.
UTILITIES ARE SHOWN ON PLANS FOR APPROXIMATE LOCATION AND HAVE NOT BEEN VERIFIED, CONTRACTOR IS ADVISED TO CONTACT DIGSAFE PER GENERAL NOTE 5 ON SHEET 6

***NTS**

PROJECT NAME:	HARTFORD-RANDOLPH
PROJECT NUMBER:	ER 014-7(21)
FILE NAME:	PLOT DATE: 11-JUL-2013
PROJECT LEADER: CHRIS BUMP	DRAWN BY: ANDREW BERNIER
DESIGNED BY: ANDREW BERNIER	CHECKED BY: MICHELLE REDMOND
PLAN SHEETS	SHEET 12 OF 20

D4-14-19 ROYALTON



MATCH

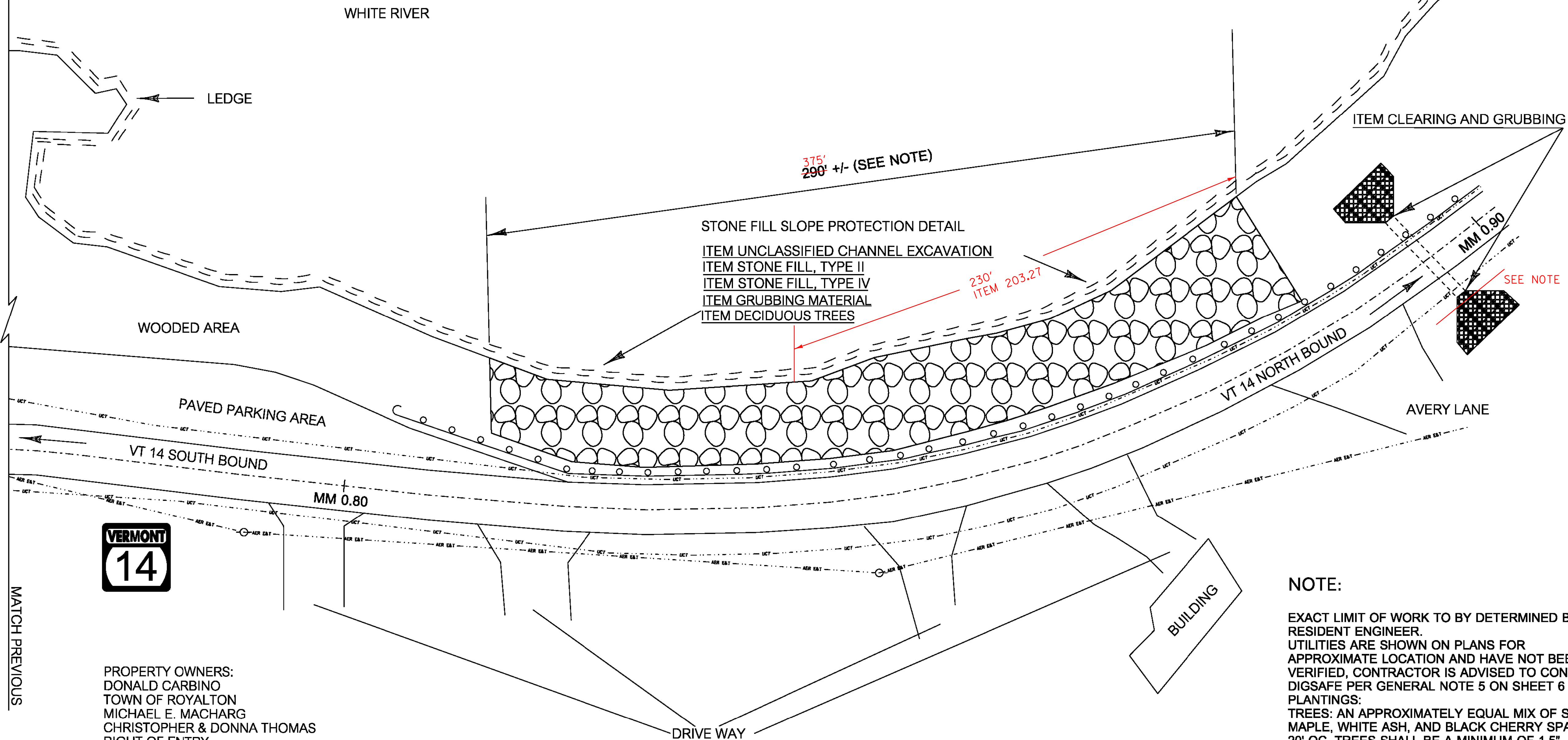

MATCH PREVIOUS



PROPERTY OWNERS:
 DONALD CARBINO
 TOWN OF ROYALTON
 MICHAEL E. MACHARG
 CHRISTOPHER & DONNA THOMAS
 RIGHT OF ENTRY

NOTE:

EXACT LIMIT OF WORK TO BY DETERMINED BY THE RESIDENT ENGINEER.
 UTILITIES ARE SHOWN ON PLANS FOR APPROXIMATE LOCATION AND HAVE NOT BEEN VERIFIED, CONTRACTOR IS ADVISED TO CONTACT DIGSAFE PER GENERAL NOTE 5 ON SHEET 6
 PLANTINGS:
 TREES: AN APPROXIMATELY EQUAL MIX OF SUGAR MAPLE, WHITE ASH, AND BLACK CHERRY SPACED 20' OC. TREES SHALL BE A MINIMUM OF 1.5" CALIPER, AND SHOULD BE PROVIDED WITH RODENT GUARDS.

***NTS**

PROJECT NAME:	HARTFORD-RANDOLPH
PROJECT NUMBER:	ER 014-7(21)
FILE NAME:	PLOT DATE: 11-JUL-2013
PROJECT LEADER: CHRIS BUMP	DRAWN BY: ANDREW BERNIER
DESIGNED BY: ANDREW BERNIER	CHECKED BY: MICHELLE REDMOND
PLAN SHEETS	SHEET 13 OF 20

D4-14-19 ROYALTON

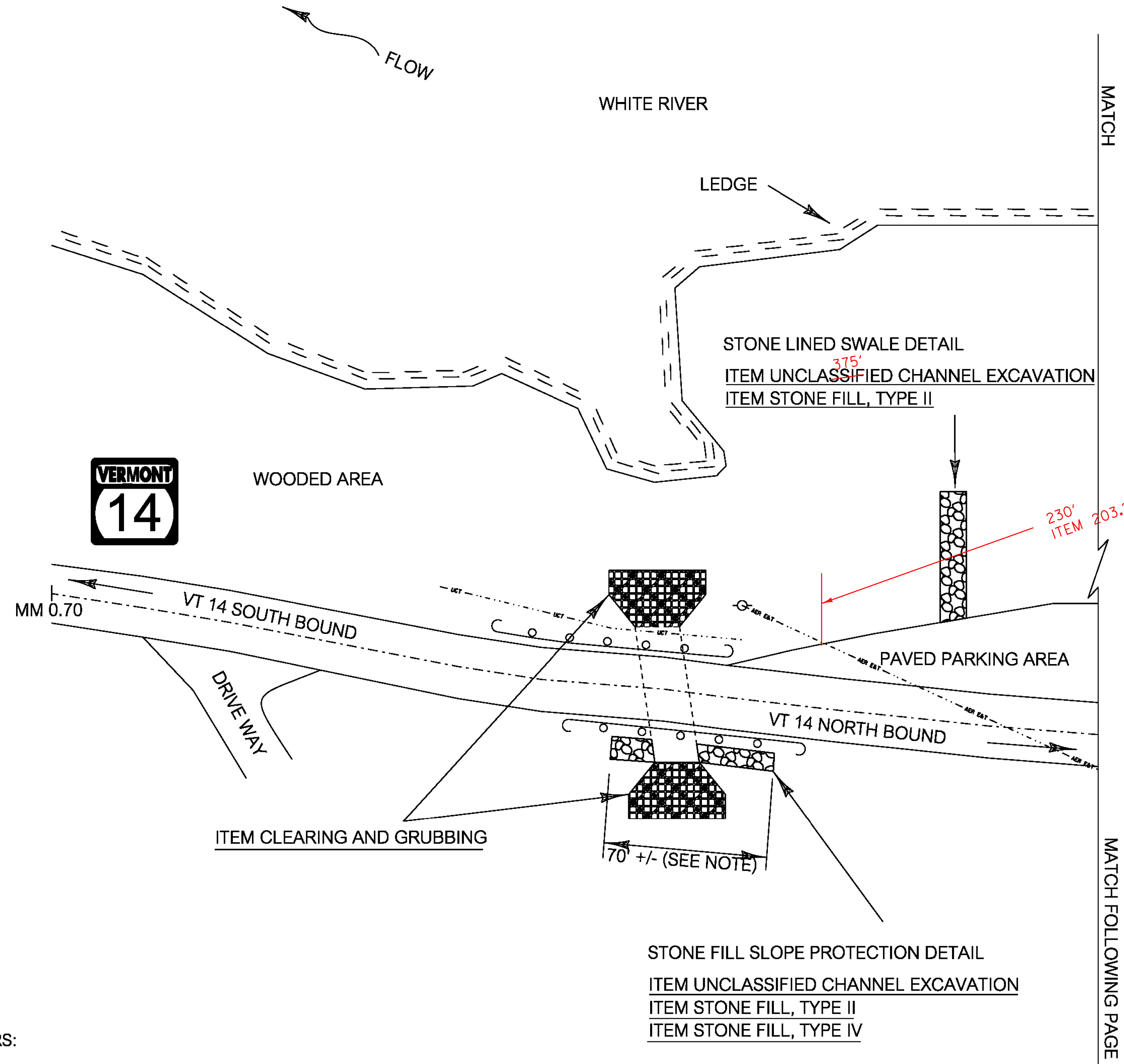

SEE NOTE NEXT PAGE

PROPERTY OWNERS:
DONALD CARBINO
TOWN OF ROYALTON
MICHAEL E. MACHARG
CHRISTOPHER & DONNA THOMAS
RIGHT OF ENTRY

NOTE:

EXACT LIMIT OF WORK TO BY DETERMINED BY THE RESIDENT ENGINEER. UTILITIES ARE SHOWN ON PLANS FOR APPROXIMATE LOCATION AND HAVE NOT BEEN VERIFIED, CONTRACTOR IS ADVISED TO CONTACT DIGSAFE PER GENERAL NOTE 5 ON SHEET 6

***NTS**

PROJECT NAME: HARTFORD-RANDOLPH	
PROJECT NUMBER: ER 014-7(21)	
FILE NAME:	PLOT DATE: 11-JUL-2013
PROJECT LEADER: CHRIS BUMP	DRAWN BY: ANDREW BERNIER
DESIGNED BY: ANDREW BERNIER	CHECKED BY: MICHELLE REDMOND
PLAN SHEETS	SHEET 14 OF 20

**D4-14-18
ROYALTON**

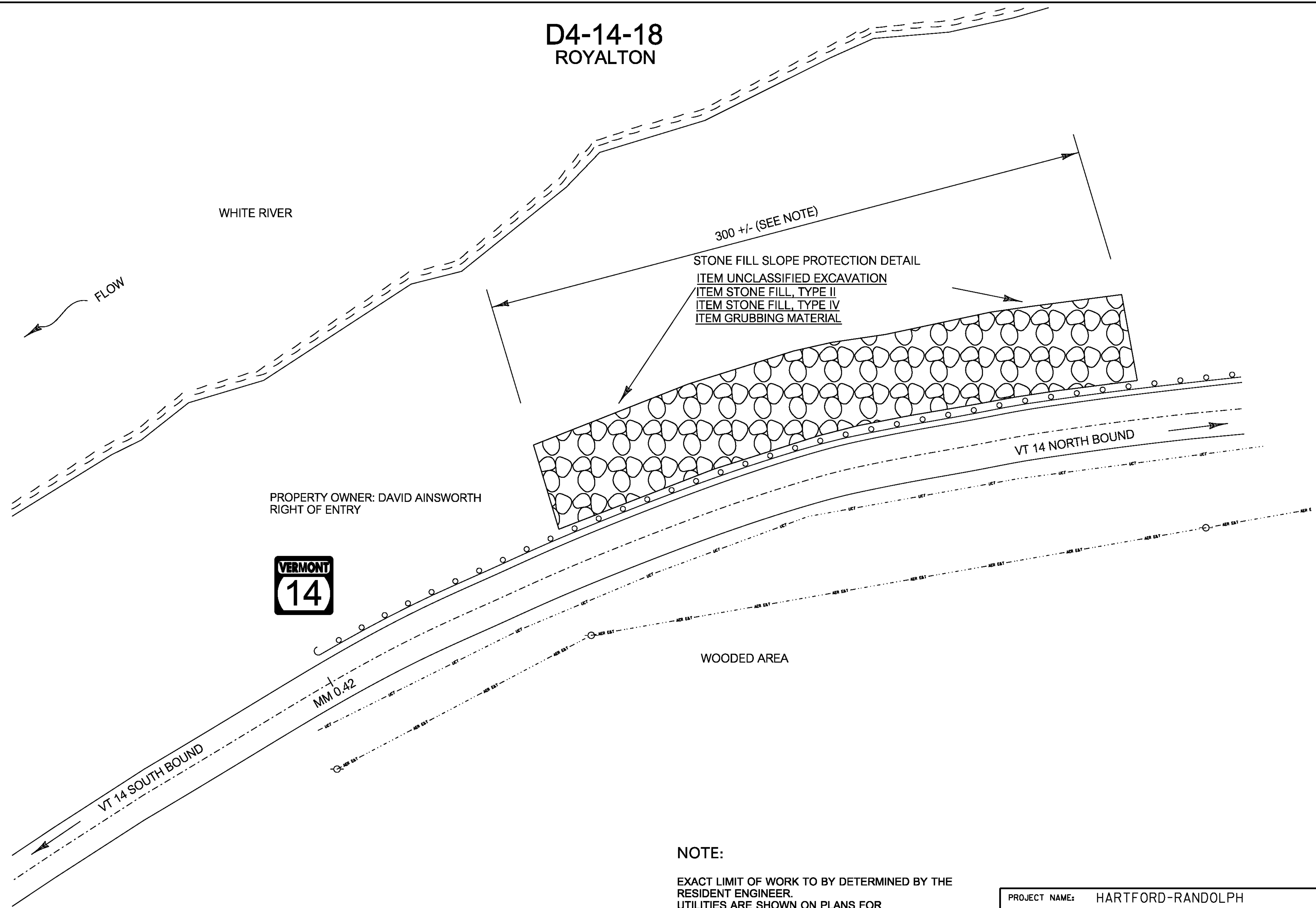

STONE FILL SLOPE PROTECTION DETAIL
 ITEM UNCLASSIFIED EXCAVATION
 ITEM STONE FILL, TYPE II
 ITEM STONE FILL, TYPE IV
 ITEM GRUBBING MATERIAL

300 +/- (SEE NOTE)

PROPERTY OWNER: DAVID AINSWORTH
 RIGHT OF ENTRY



NOTE:

EXACT LIMIT OF WORK TO BY DETERMINED BY THE
 RESIDENT ENGINEER.
 UTILITIES ARE SHOWN ON PLANS FOR
 APPROXIMATE LOCATION AND HAVE NOT BEEN
 VERIFIED, CONTRACTOR IS ADVISED TO CONTACT
 DIGSAFE PER GENERAL NOTE 5 ON SHEET 6

***NTS**

PROJECT NAME: HARTFORD-RANDOLPH	
PROJECT NUMBER: ER 014-7(21)	
FILE NAME:	PLOT DATE: 11-JUL-2013
PROJECT LEADER: CHRIS BUMP	DRAWN BY: ANDREW BERNIER
DESIGNED BY: ANDREW BERNIER	CHECKED BY: MICHELLE REDMOND
PLAN SHEETS	SHEET 15 OF 20



D4-14-17 SHARON

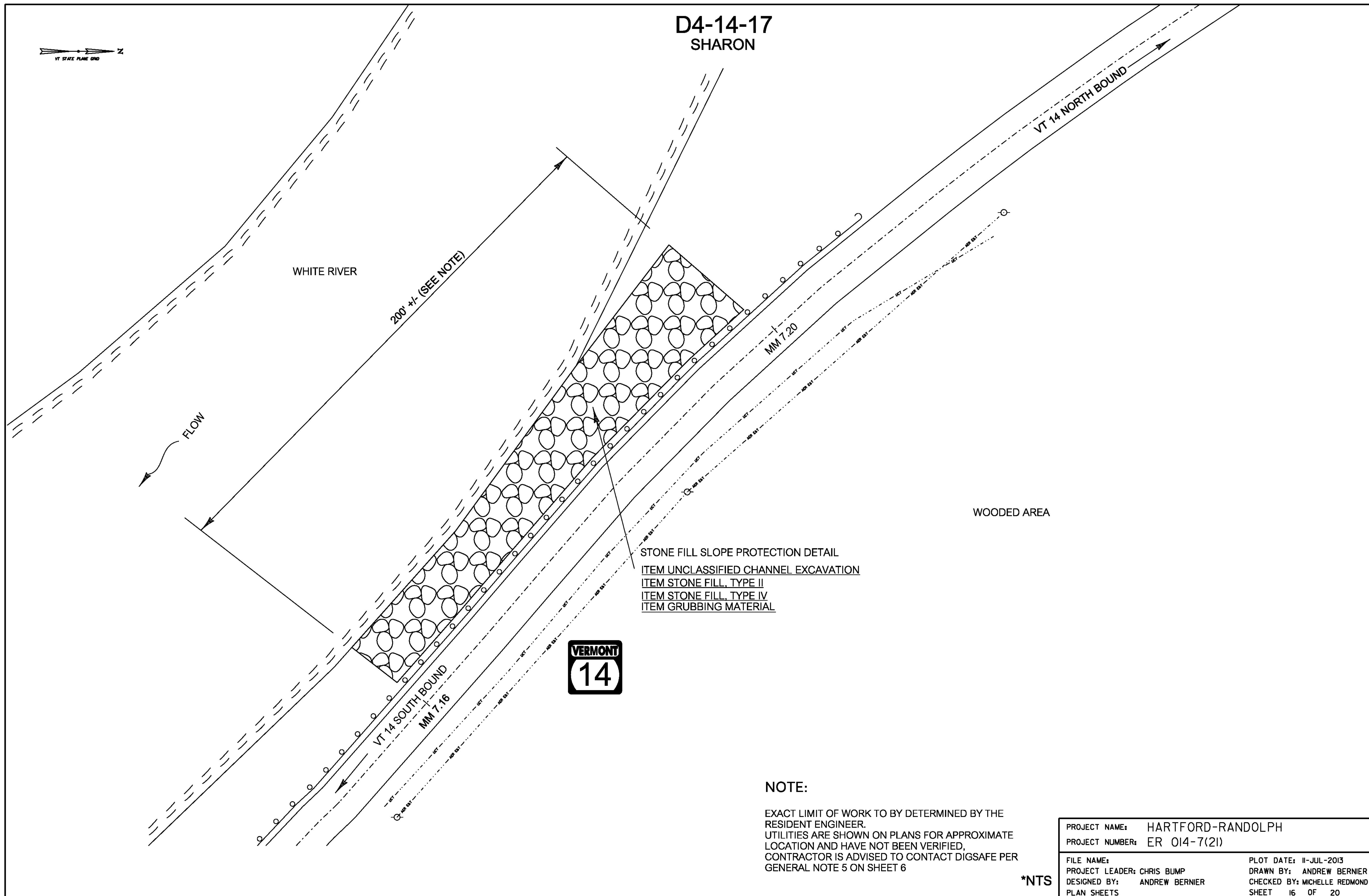

STONE FILL SLOPE PROTECTION DETAIL
ITEM UNCLASSIFIED CHANNEL EXCAVATION
ITEM STONE FILL, TYPE II
ITEM STONE FILL, TYPE IV
ITEM GRUBBING MATERIAL



NOTE:

EXACT LIMIT OF WORK TO BY DETERMINED BY THE RESIDENT ENGINEER.
UTILITIES ARE SHOWN ON PLANS FOR APPROXIMATE LOCATION AND HAVE NOT BEEN VERIFIED,
CONTRACTOR IS ADVISED TO CONTACT DIGSAFE PER GENERAL NOTE 5 ON SHEET 6

*NTS

PROJECT NAME: HARTFORD-RANDOLPH	
PROJECT NUMBER: ER 014-7(21)	
FILE NAME:	PLOT DATE: 11-JUL-2013
PROJECT LEADER: CHRIS BUMP	DRAWN BY: ANDREW BERNIER
DESIGNED BY: ANDREW BERNIER	CHECKED BY: MICHELLE REDMOND
PLAN SHEETS	SHEET 16 OF 20

D4-14-10
SHARON

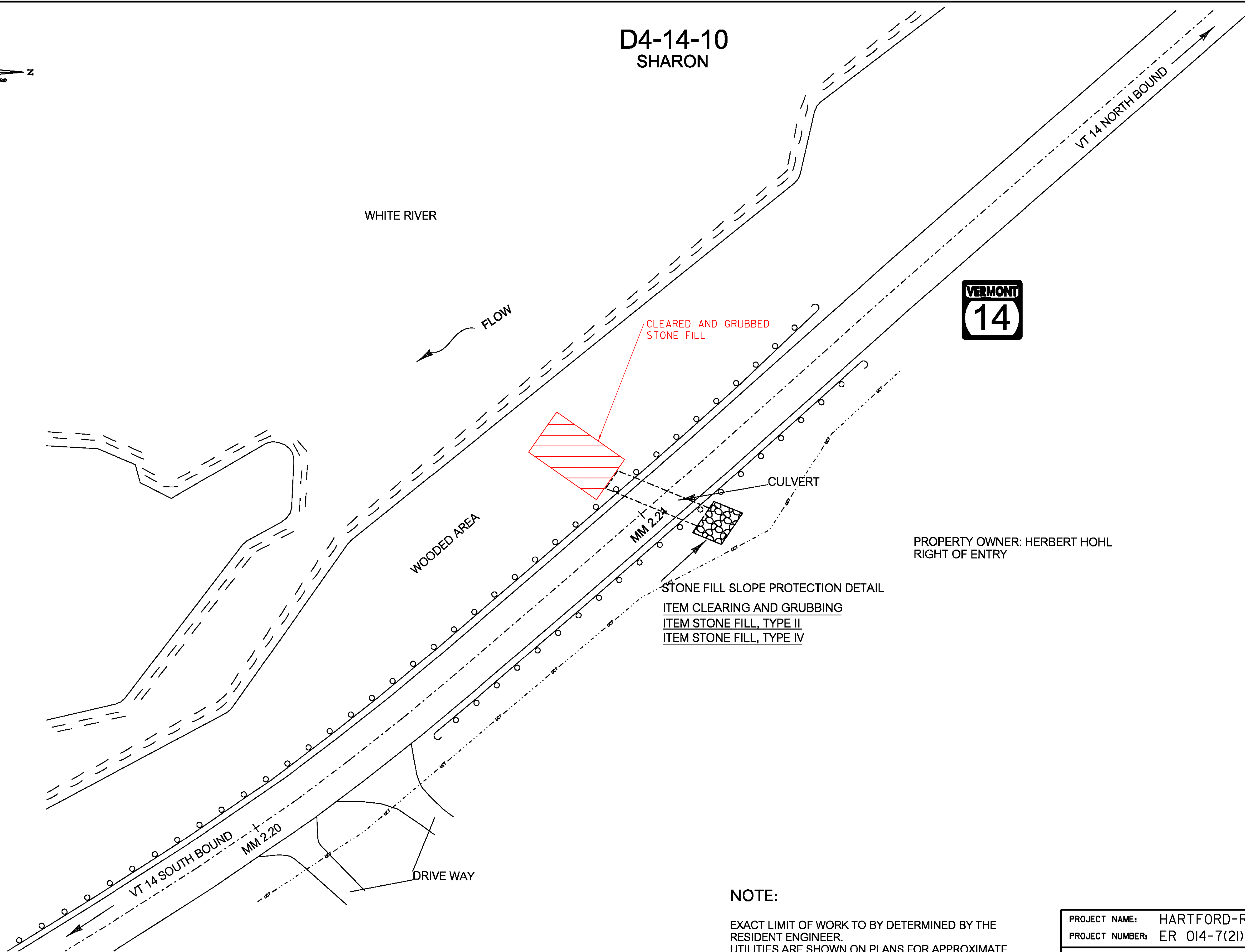

NOTE:

EXACT LIMIT OF WORK TO BY DETERMINED BY THE RESIDENT ENGINEER.
UTILITIES ARE SHOWN ON PLANS FOR APPROXIMATE LOCATION AND HAVE NOT BEEN VERIFIED,
CONTRACTOR IS ADVISED TO CONTACT DIGSAFE PER GENERAL NOTE 5 ON SHEET 6

*NTS

PROJECT NAME: HARTFORD-RANDOLPH	
PROJECT NUMBER: ER 014-7(21)	
FILE NAME:	PLOT DATE: 11-JUL-2013
PROJECT LEADER: CHRIS BUMP	DRAWN BY: ANDREW BERNIER
DESIGNED BY: ANDREW BERNIER	CHECKED BY: MICHELLE REDMOND
PLAN SHEETS	SHEET 17 OF 20

D4-14-6 HARTFORD

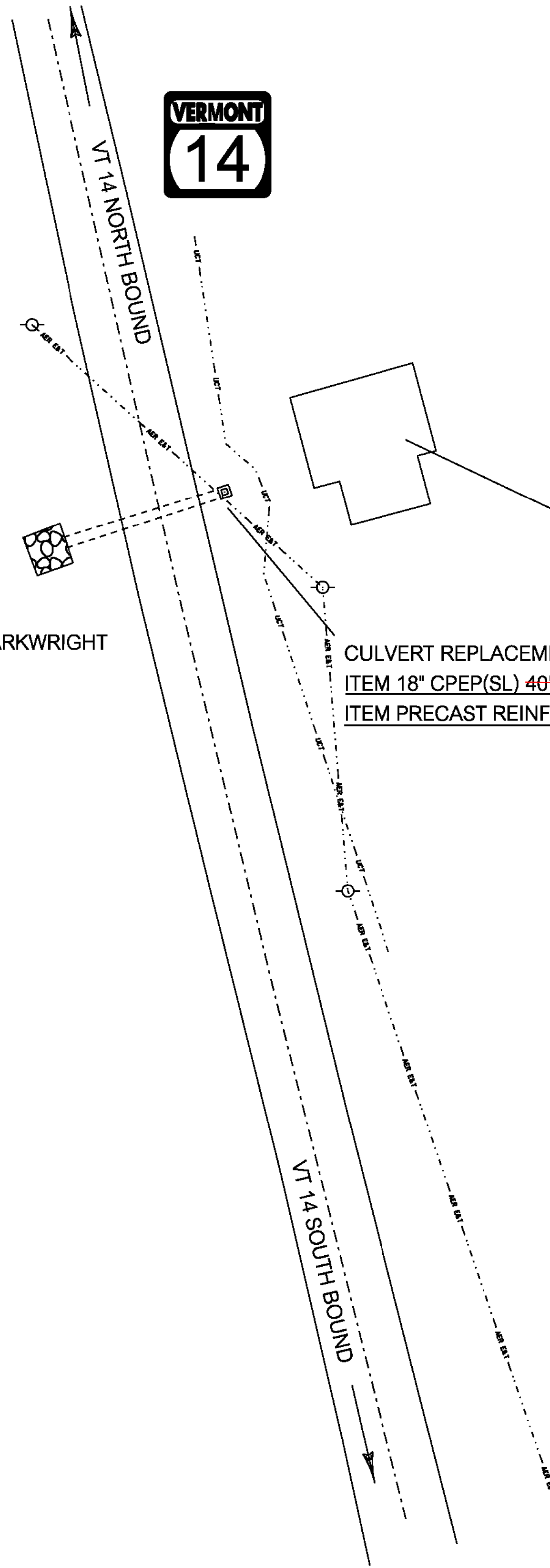
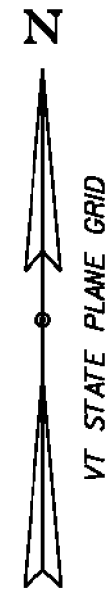

PROPERTY OWNER: CHERYL GILBERT (CHURCH)
RIGHT OF ENTRY
WEST HARTFORD CHURCH

PROPERTY OWNER: STEPHEN ARKWRIGHT
RIGHT OF ENTRY

CULVERT REPLACEMENT @ MM 7.06 EXIST 18" REPLACE WITH
ITEM 18" CPEP(SL) ~~40' LONG~~ 64' LONG DAYLIGHTED TO EDGE OF SLOPE
ITEM PRECAST REINFORCED CONCRETE CATCH BASIN WITH CAST IRON GRATE

NOTE:

EXACT LIMIT OF WORK TO BY DETERMINED BY THE RESIDENT ENGINEER. UTILITIES ARE SHOWN ON PLANS FOR APPROXIMATE LOCATION AND HAVE NOT BEEN VERIFIED. CONTRACTOR IS ADVISED TO CONTACT DIGSAFE PER GENERAL NOTE 5 ON SHEET 6 *NTS

PROJECT NAME: HARTFORD-RANDOLPH	
PROJECT NUMBER: ER 014-7(21)	
FILE NAME:	PLOT DATE: 11-JUL-2013
PROJECT LEADER: CHRIS BUMP	DRAWN BY: ANDREW BERNIER
DESIGNED BY: ANDREW BERNIER	CHECKED BY: MICHELLE REDMOND
PLAN SHEETS	SHEET 18 OF 20

D4-14-28 HARTFORD

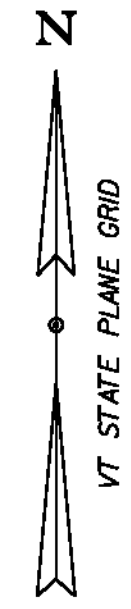

VT 14 NORTH BOUND

CULVERT REPLACEMENT @ MM 6.74 EXIST 18" REPLACE WITH
ITEM 24" CPEP(SL) 40' LONG

PROPERTY OWNER: JULIUS ANDERSON
RIGHT OF ENTRY

PROPERTY OWNER: TOWN OF HARTFORD
RIGHT OF ENTRY

VT 14 SOUTH BOUND

NOTE:

EXACT LIMIT OF WORK TO BY DETERMINED BY THE
RESIDENT ENGINEER.
UTILITIES ARE SHOWN ON PLANS FOR APPROXIMATE
LOCATION AND HAVE NOT BEEN VERIFIED,
CONTRACTOR IS ADVISED TO CONTACT DIGSAFE PER
GENERAL NOTE 5 ON SHEET 6

*NTS

PROJECT NAME: HARTFORD-RANDOLPH	
PROJECT NUMBER: ER 014-7(21)	
FILE NAME:	PLOT DATE: 11-JUL-2013
PROJECT LEADER: CHRIS BUMP	DRAWN BY: ANDREW BERNIER
DESIGNED BY: ANDREW BERNIER	CHECKED BY: MICHELLE REDMOND
PLAN SHEETS	SHEET 19 OF 20

D4-14-3 REV
HARTFORD

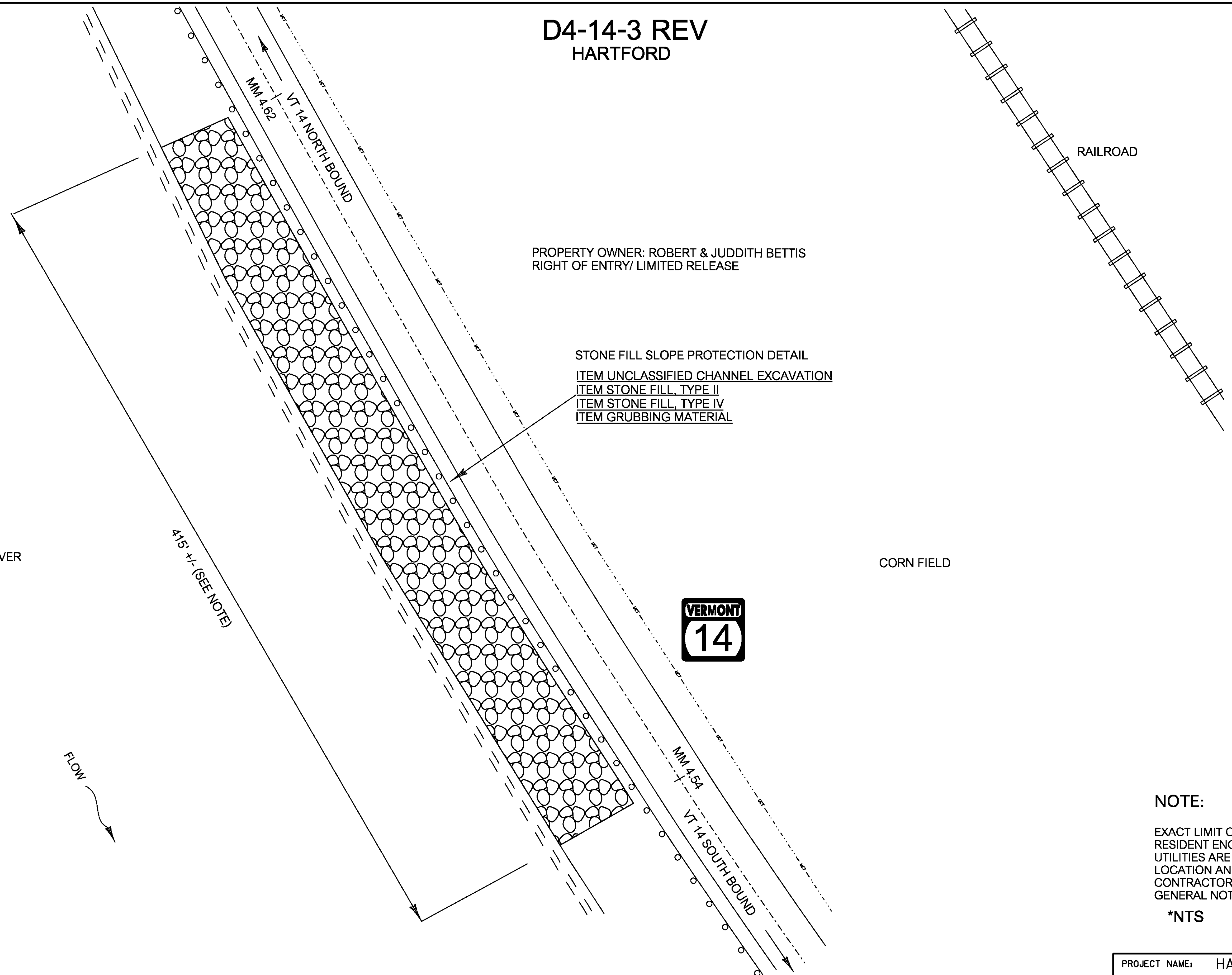
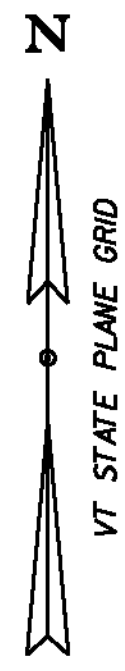

PROPERTY OWNER: ROBERT & JUDDITH BETTIS
 RIGHT OF ENTRY/ LIMITED RELEASE

STONE FILL SLOPE PROTECTION DETAIL
 ITEM UNCLASSIFIED CHANNEL EXCAVATION
 ITEM STONE FILL, TYPE II
 ITEM STONE FILL, TYPE IV
 ITEM GRUBBING MATERIAL

WHITE RIVER

415' +/- (SEE NOTE)

FLOW

CORN FIELD

RAILROAD



NOTE:

EXACT LIMIT OF WORK TO BY DETERMINED BY THE RESIDENT ENGINEER.
 UTILITIES ARE SHOWN ON PLANS FOR APPROXIMATE LOCATION AND HAVE NOT BEEN VERIFIED.
 CONTRACTOR IS ADVISED TO CONTACT DIGSAFE PER GENERAL NOTE 5 ON SHEET 6

***NTS**

PROJECT NAME:	HARTFORD-RANDOLPH
PROJECT NUMBER:	ER 014-7(21)
FILE NAME:	PLOT DATE: 11-JUL-2013
PROJECT LEADER: CHRIS BUMP	DRAWN BY: ANDREW BERNIER
DESIGNED BY: ANDREW BERNIER	CHECKED BY: MICHELLE REDMOND
PLAN SHEETS	SHEET 20 OF 20