

STEEL ASSEMBLY BY OTHERS

T.Y. LIN INTERNATIONAL
 THE STAMPED DOCUMENTS ARE HEREBY:
 APPROVED
 APPROVED AS NOTED
 REVISE AND RESUBMIT
 SEE TRANSMITTAL FOR ADDITIONAL INFORMATION AS APPLICABLE.
 THIS REVIEW IS FOR GENERAL CONFORMANCE WITH DESIGN CONCEPT ONLY. ANY DEVIATION FROM THE PLANS OR SPECIFICATIONS NOT CLEARLY NOTED BY THE CONTRACTOR HAS NOT BEEN REVIEWED. REVIEW BY THE ENGINEER SHALL NOT RELIEVE THE CONTRACTOR OF THE CONTRACTUAL RESPONSIBILITY FOR ANY ERRORS OR DEVIATION FROM THE CONTRACT REQUIREMENTS.
 JOSH OLUND 07/22/2014
 REVIEWER DATE

**FOR APPROVAL
 NOT FOR CONSTRUCTION**

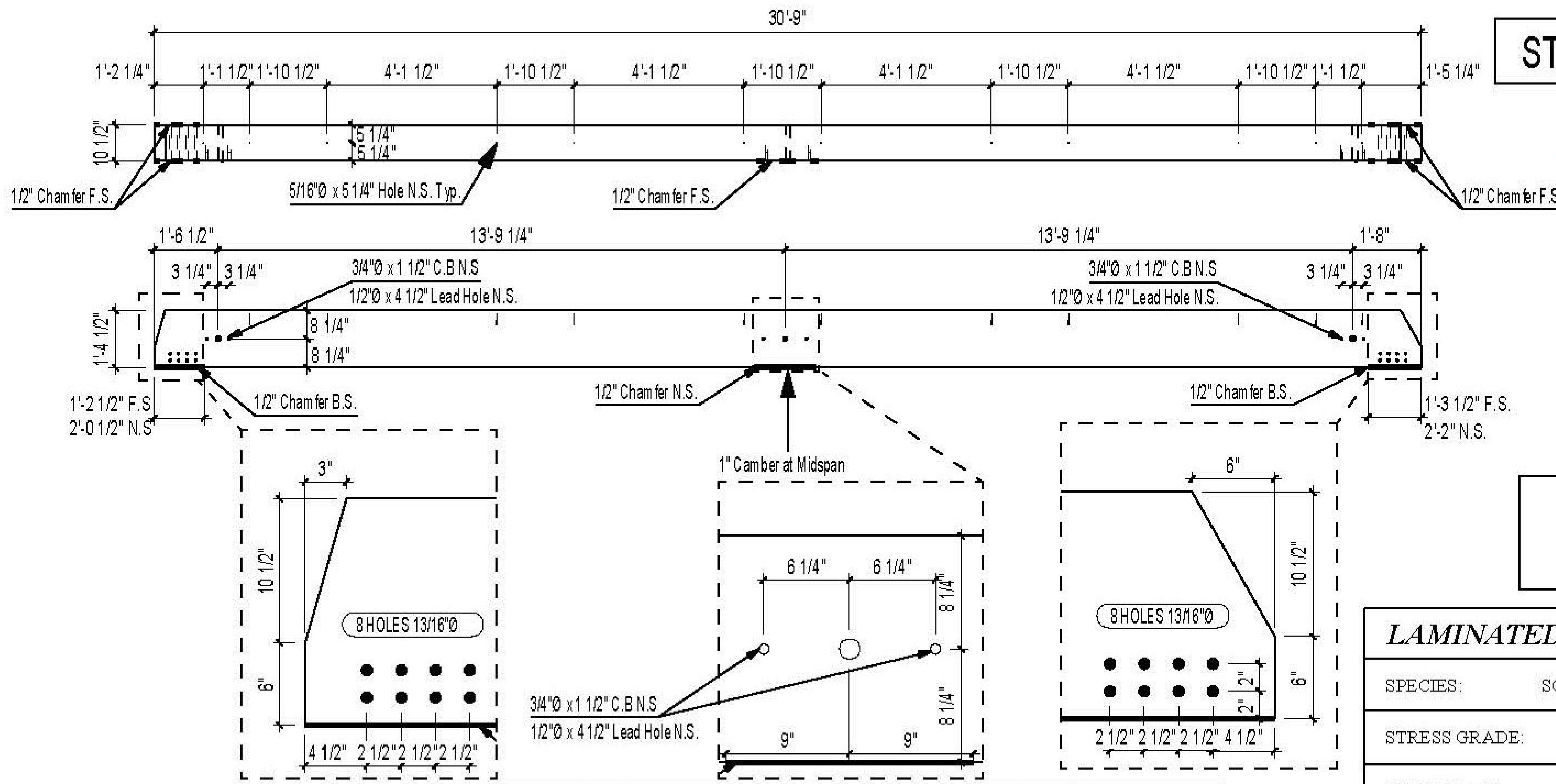

LAMINATED TIMBER SPECIFICATION

SPECIES:	SOUTHERN PINE
STRESS GRADE:	26F-1.9E
CAMBER:	1"
LAMINATIONS:	STANDARD 1-3/8"
AS PER ANSI/AITC A 190.1 IN ACCORDANCE W/ AITC 117 - CERTIFIED APA	
APPEARANCE GRADE:	INDUSTRIAL
MOISTURE CONTENT OF LAMINATIONS:	MAXIMUM 16%
ADHESIVE:	COMPLYING TO AITC A 190.1 WET-USE CONFORMING TO ASTM D 2559
LAMINATION LAYUP:	COMPLYING TO AITC 117 ANNEX B TABLE B 1

Grade	Slope of grain	#of Lams
Top: 302-26	1:16	1
N1D	1:14	2
N1D	1:8	1
N1M	1:8	4
N1D	1:8	1
N1D	1:14	2
Bottom: 302-26	1:16	1

Lam splices are random

Vermont Agency of Transportation
RECEIVED
 ON: July 18, 2014
 and Checked for
CONFORMANCE
 BY: Jennifer Fitch DATE: 07/25/2014

Prod: B2

Glue Laminated Timber Beam 8		PRINTED: 17.07.2014	HOLE TYP. U.N.O. 1 1/2" Ø	Qty: 2	Scale: 1/4" = 1'0"	Date: 05-02-2014	Goodfellow inc. 225, Goodfellow Street DELSON, QUEBEC, J5B 1V5 Tel.: 450-635-6511 Fax: 450-635-8304 www.goodfellowinc.com
Project: Floating Bridge (Brookfield) No.: 1314-150-U // G-28107 Customer: Wright Construction Co. Inc.	FABRICATION / / /	July 17 June 25 DATE:	Approval #3 Added Holes & Notes REVISION	Stress Grade: 26F-1.9E App. Grade: Industrial Treatment: Preservative Type II Penta Type A 0.60# AWPA Use Category UC4B Commodity 6F	X-section: 10 1/2" / 16-1/2" Length: 30'-9" Material: Southern Pine	By: J.R. Checked: M.R.	