

NOTES: VAOT PAY ITEM 900.620 SPECIAL PROVISION (DOCK). PAYMENT SHALL BE FOR THE DOCK IN PLACE AND SHALL INCLUDE DESIGN, CONSTRUCTION, ALL APPURTENANCES AND INCIDENTALS. PAYMENT FOR THE DOCK SHALL INCLUDE THE STEEL PLATE AND OTHER DOCK HARDWARE ASSOCIATED WITH THE CAST IN PLACE CONCRETE DOCK ANCHOR.

2. THE CONTRACTOR SHALL SUBMIT THE DOCK/DOCK SYSTEM DESIGN FOR APPROVAL BY THE VT FISH & WILDLIFE DEPARTMENT.

3. THE DOCK SHALL BE DESIGNED, CONSTRUCTED AND INSTALLED BY A PROFESSIONAL DOCK/WATERFRONT SPECIALIST COMPANY. THE PROFESSIONAL DOCK/ WATERFRONT SPECIALIST COMPANY SHALL HAVE A MINIMUM OF 25 YEARS OF MARINE COMMERCIAL DOCK DESIGN, CONSTRUCTION AND INSTALLATION EXPERIENCE.

4. THE COMMERCIAL HEAVY DUTY DOCK SYSTEM SHALL INCLUDE AS A MINIMUM: REINFORCED DIAMOND TREAD PLATE, STRUCTURAL STEEL FRAMING FOR ALL SECTIONS, REMOVABLE SIDE RAILING ALONG ONE SIDE OF THE GANGWAY SECTION DESIGNED IN COMPLIANCE WITH APPLICABLE FEDERAL ACCESSIBILITY GUIDELINES, ADA CURBING, 8" MOORING CLEATS APPROPRIATELY SPACED AND BOLTED TO THE DOCK FRAMING, RUB RAILS WITH REFLECTIVE TAPE AND CONTINUOUS BUMPER FENDERS, WEATHER AND SPLINTER RESISTANT DECKING, PROPERLY SIZED PUNCTURE AND UV RESISTANT FLOATATION, HINGE DOCK CONNECTIONS WITH DAMPENING SYSTEM, REMOVABLE DOCK WHEEL KITS, SPUD POLES WITH FOOT PADS AND LOCKING MOUNTS TO MINIMIZE APPROACH SECTION SLOPE, A CONCRETE ANCHORING SYSTEM, END RAILING, AND ANY INCIDENTAL WORK NECESSARY TO COMPLETE THE DOCK AS SPECIFIED BY THE VERMONT FISH & WILDLIFE DEPARTMENT.

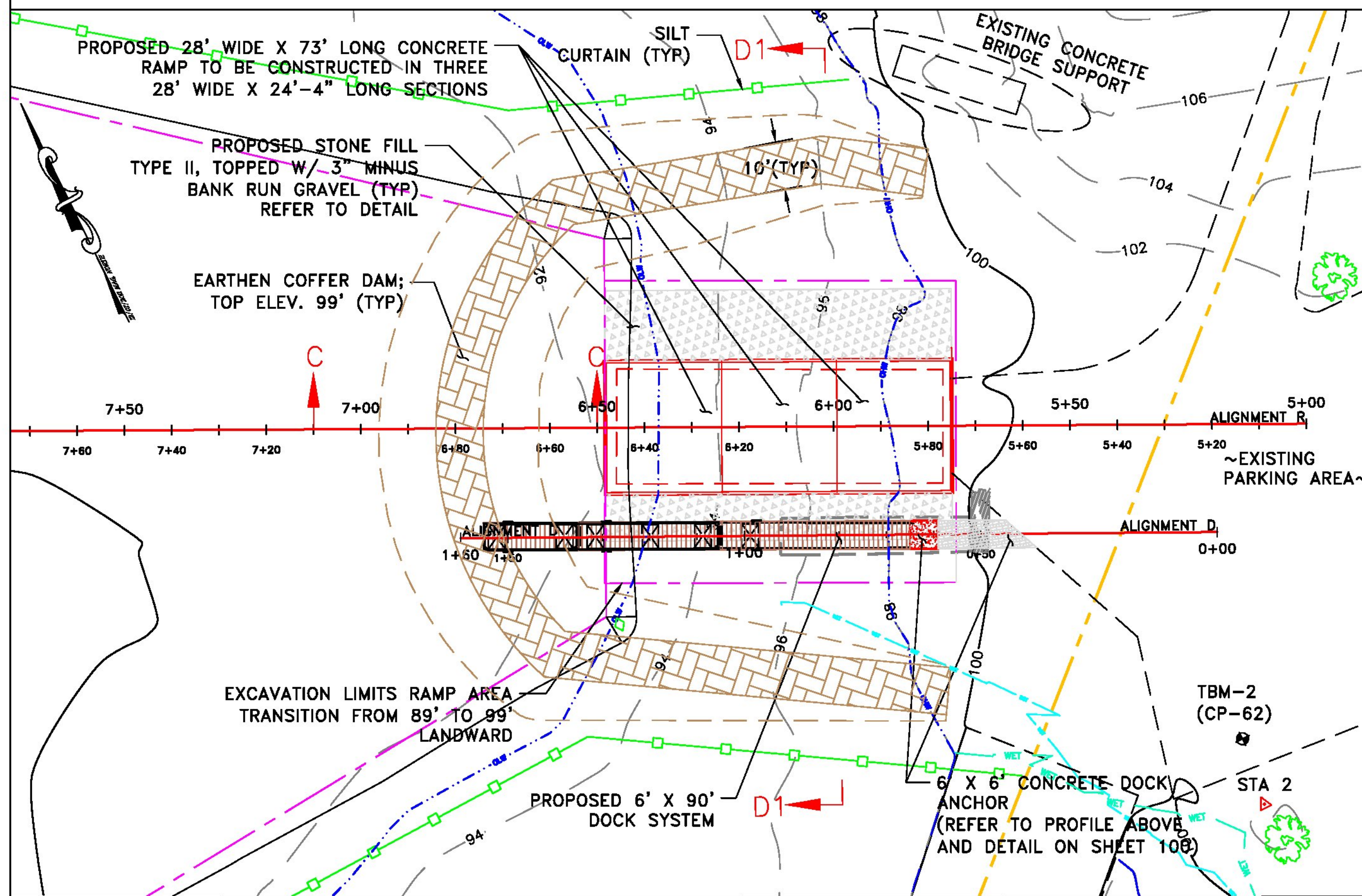
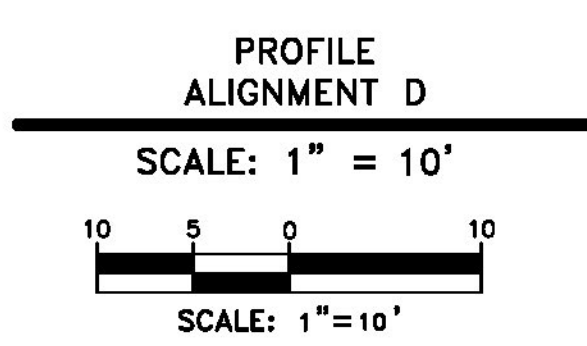

PLAN VIEW COFFERDAM & DOCK PLACEMENT
SCALE: 1" = 20'

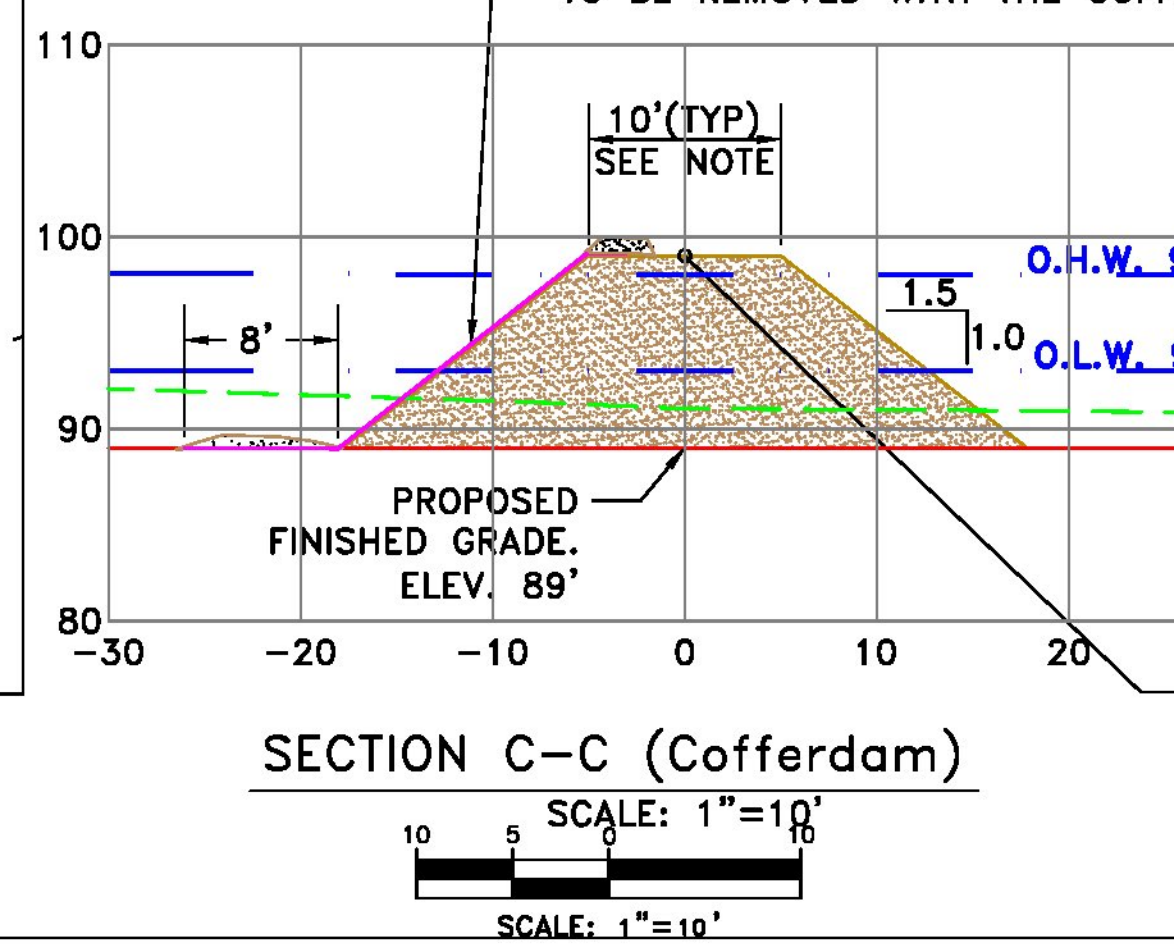
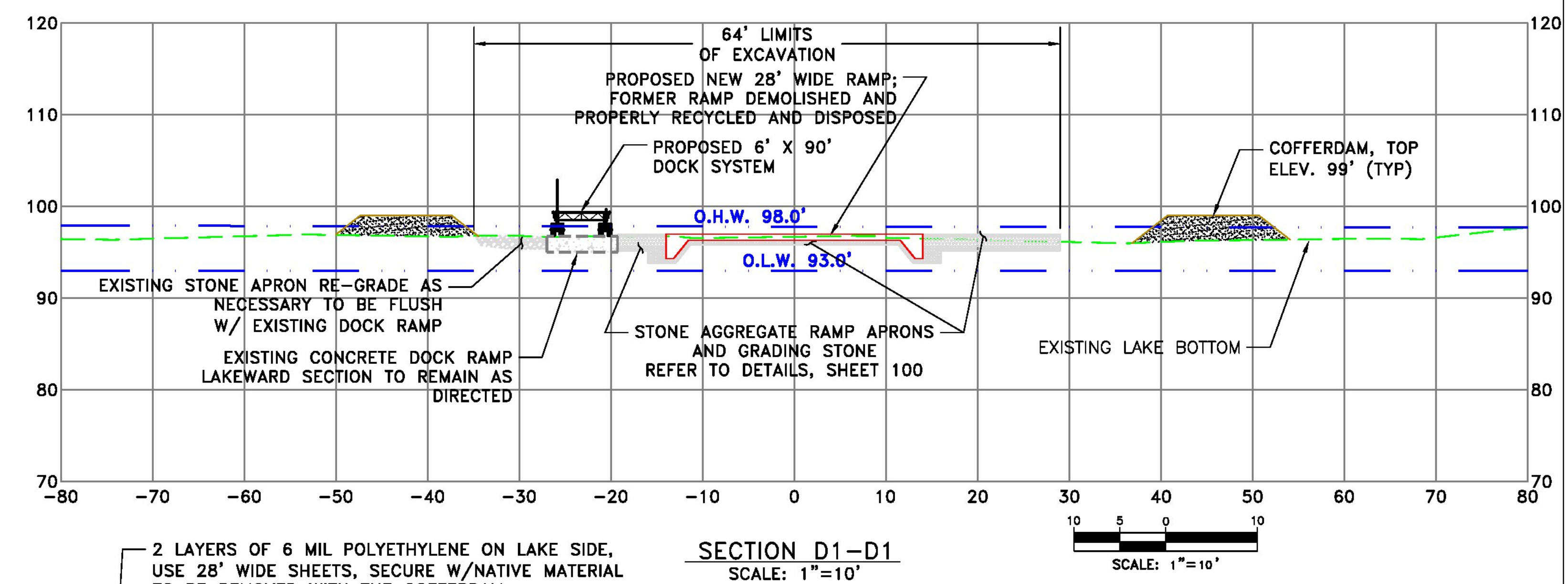

NOTE: THE COFFERDAM PLAN AND CROSS SECTION ON THIS SHEET ARE FOR PERMIT PURPOSES. A STRUCTURAL COFFERDAM SHALL BE ALLOWED, IN ACCORDANCE WITH SECTION 208. ANY STRUCTURAL COFFERDAM PROPOSED BY THE CONTRACTOR SHALL BE APPROVED FOR USE BY THE ENGINEER. THE CONTRACTOR IS RESPONSIBLE FOR THE DESIGN, CONSTRUCTION, MAINTENANCE, INTEGRITY AND SAFETY OF THE COFFERDAM. VAOT PAY ITEM 208.40, COFFERDAM, LUMP SUM: PAYMENT SHALL BE FOR THE COFFERDAM COMPLETE AND IN PLACE AND SHALL INCLUDE DESIGN, DE-WATERING, ALL APPURTENANCES AND INCIDENTALS, REMOVAL AND DISPOSAL. ALL WORK UNDER THIS PAY ITEM SHALL BE IN CONFORMANCE WITH ALL ASSOCIATED VAOT SPECIFICATIONS.

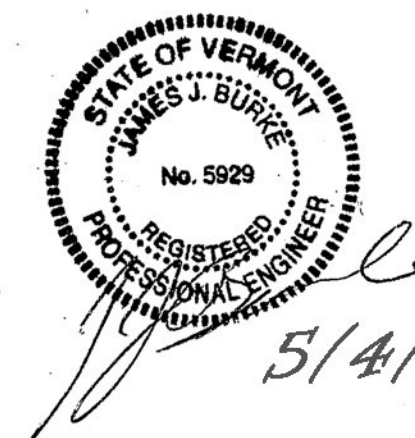

STATE OF VERMONT AGENCY OF NATURAL RESOURCES DEPARTMENT OF ENVIRONMENTAL CONSERVATION FACILITIES ENGINEERING DIVISION WATERBURY, VERMONT 05671-0511		DESIGNED JRB
REVISIONS	DEPARTMENT FISH & WILDLIFE	CHECKED JJB
DATE	PROJECT CHIMNEY POINT ACCESS AREA DOCK PROFILE & SECTION D-D PLAN VIEW & CROSS SECTION COFFERDAM	SHEET 99 of 100
7/15/12	LOCATION ADDISON, VERMONT	DRAWING NO. 12711CP
APPROVED	APPROVED	SCALE AS NOTED