

**CONSTRUCTION APPROACH SIGNING**

NOT TO SCALE

SEE STD E-121 AND T-10 FOR SIGN PLACEMENT

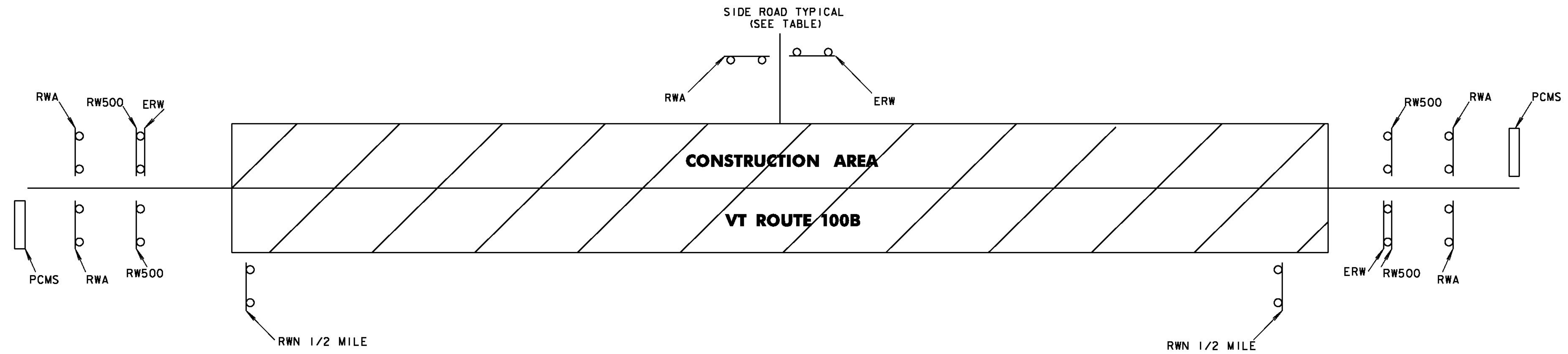

**NOTES:**

1. THE CONTRACTOR SHALL SUBMIT A SITE SPECIFIC TRAFFIC CONTROL PLAN TO THE ENGINEER FOR APPROVAL PRIOR TO THE START OF CONSTRUCTION. THE COST OF PREPARING THIS PLAN (AND MAKING CHANGES IF NECESSARY) WILL NOT BE PAID SEPARATELY BUT WILL BE PAID UNDER ITEM 641.10, "TRAFFIC CONTROL". THE TRAFFIC CONTROL PLAN SHALL BE IN COMPLIANCE WITH VT STATE STANDARDS AND 2009 MUTCD. WHERE CONFLICTS EXIST, THE 2009 MUTCD SHALL GOVERN.
2. THE CONTRACTOR SHALL INCLUDE A CONSTRUCTION SIGN APPROACH PACKAGE FOR EXPECTED LANE CLOSURES AND WORK ZONE SPEED REDUCTIONS IN COMPLIANCE WITH THE TRAFFIC CONTROL NOTES AND PART 6 OF THE 2009 MUTCD. PAYMENT FOR PROVIDING THIS PACKAGE WILL BE PAID UNDER ITEM 641.10, "TRAFFIC CONTROL".
3. THE BID PRICE FOR "TRAFFIC CONTROL", ITEM 641.10, SHALL INCLUDE ALL OF THE FOLLOWING, AS NEEDED: APPROACH AND ON-PROJECT CONSTRUCTION SIGNING, PORTABLE ARROW BOARDS, BARRELS, CONES, BARRICADES, TEMPORARY REGULATORY AND WARNING SIGNS, AND POSTS AS DETAILED IN VAOT STANDARDS. ALL ADJUSTING, RELOCATING, AND REMOVING OF THESE DEVICES AS DIRECTED BY THE ENGINEER SHALL ALSO BE INCLUDED. THE FOLLOWING ITEMS WILL BE PAID FOR SEPARATELY:  
 646.602, 646.612 - TEMPORARY PAVEMENT MARKINGS  
 630.10 - UNIFORMED TRAFFIC OFFICER  
 630.15 - FLAGGERS  
 900.640 - SPECIAL PROVISION (BARRIER FOR TEMPORARY TRAFFIC PROTECTION)
4. THE MUTCD 2009 AND ITS LATEST REVISIONS SHALL BE THE STANDARD FOR ALL TRAFFIC CONTROL DEVICES. EXISTING SIGNS, SIGNALS AND MARKINGS SHALL BE VALID UNTIL SUCH TIME AS THEY ARE REPLACED OR RECONSTRUCTED. WHEN NEW TRAFFIC CONTROL DEVICES ARE ERECTED OR PLACED OR EXISTING TRAFFIC CONTROL DEVICES ARE REPLACED OR REPAIRED THE EQUIPMENT, DESIGN, METHOD OF INSTALLATION, PLACEMENT OR REPAIR SHALL CONFORM WITH SUCH STANDARDS.
5. CONES SHALL BE USED TO CLEARLY DEFINE THE TRAVEL SPACE AND PROVIDE SEPARATION FROM THE WORK SPACE ALONG ITS ENTIRE LENGTH.
6. AT NO TIME SHOULD THE FLAGGER SYMBOL SIGN BE MORE THAN 1000 FT FROM THE FLAGGER STATION. FLAGGER SIGNS SHALL BE COVERED OR TURNED AWAY IF FLAGGING OPERATIONS CEASE FOR MORE THAN 15 MINUTES.
7. NO CONSTRUCTION SIGNS SHALL BE INSTALLED AS TO INTERFERE OR OBSTRUCT THE VIEW OF EXISTING TRAFFIC CONTROL DEVICES, STOPPING SIGHT DISTANCE, AND CORNER SIGHT DISTANCE FROM DRIVES AND TOWN HIGHWAYS.
8. DIAMOND SHAPED SIGNS SHALL BE 4' X 4' WITH BLACK TEXT AND BORDER ON A RETROREFLECTIVE FLOURESCENT ORANGE BACKGROUND.
9. WHERE TEMPORARY SIGNS ARE PLACED BEHIND GUARDRAIL, THEY SHALL BE ADJUSTED SUCH THAT THE BOTTOM OF THE SIGNS ARE ABOVE THE TOP OF GUARDRAIL.
10. THE PORTABLE CHANEABLE MESSAGE SIGN MESSAGE SHOULD CONVEY UP TO DATE CONSTRUCTION INFORMATION WHICH A STATIC SIGN CAN NOT. THE MESSAGE SHALL BE CHECKED AND UPDATED WEEKLY, OR AS DIRECTED BY THE ENGINEER. ALL MESSAGES SHALL BE APPROVED BY THE ENGINEER PRIOR TO CHANGING THE PREVIOUS MESSAGE.

	ROAD WORK AHEAD	END ROAD WORK	ROAD WORK 500 FT	ROAD WORK NEXT 0.5 MILES	PCMS
<b>MORETOWN</b>					
BEGIN PROJECT (VT 100B)	2	1	2	1	1
SUGAR HOUSE WAY	1	1			
END PROJECT (VT 100B)	2	1	2	1	1
TOTALS	5	3	4	2	2

**LEGEND**

- RWA = ROAD WORK AHEAD
- RW500 = ROAD WORK 500 FT
- ERW = END ROAD WORK
- RWN = ROAD WORK NEXT 1/2 MILE
- PCMS = PORTABLE CHANEABLE MESSAGE SIGN

PROJECT NAME: MORETOWN  
 PROJECT NUMBER: ER STP 0167 (15)

FILE NAME: z12c524detail.dgn PLOT DATE: 2/17/2015  
 PROJECT LEADER: J. TUCKER DRAWN BY: B. MACK  
 DESIGNED BY: B. BRESLEND CHECKED BY: A. SANZ  
 CONSTRUCTION APPROACH SIGNING SHEET SHEET 56 OF 57

**DETAILS ARE NOT TO SCALE**