

SOIL INFORMATION:
 TUNBRIDGE-LYMAN COMPLEX
 K-FACTOR = 0.25, 8-15% SLOPES,
 VERY ROCKY
 HYDROLOGIC SOIL GROUP: C/D

SOIL INFORMATION:
 COTTON GRAVELLY LOAMY SAND
 K-FACTOR = 0.17, 25-60% SLOPES,
 HYDROLOGIC SOIL GROUP: A

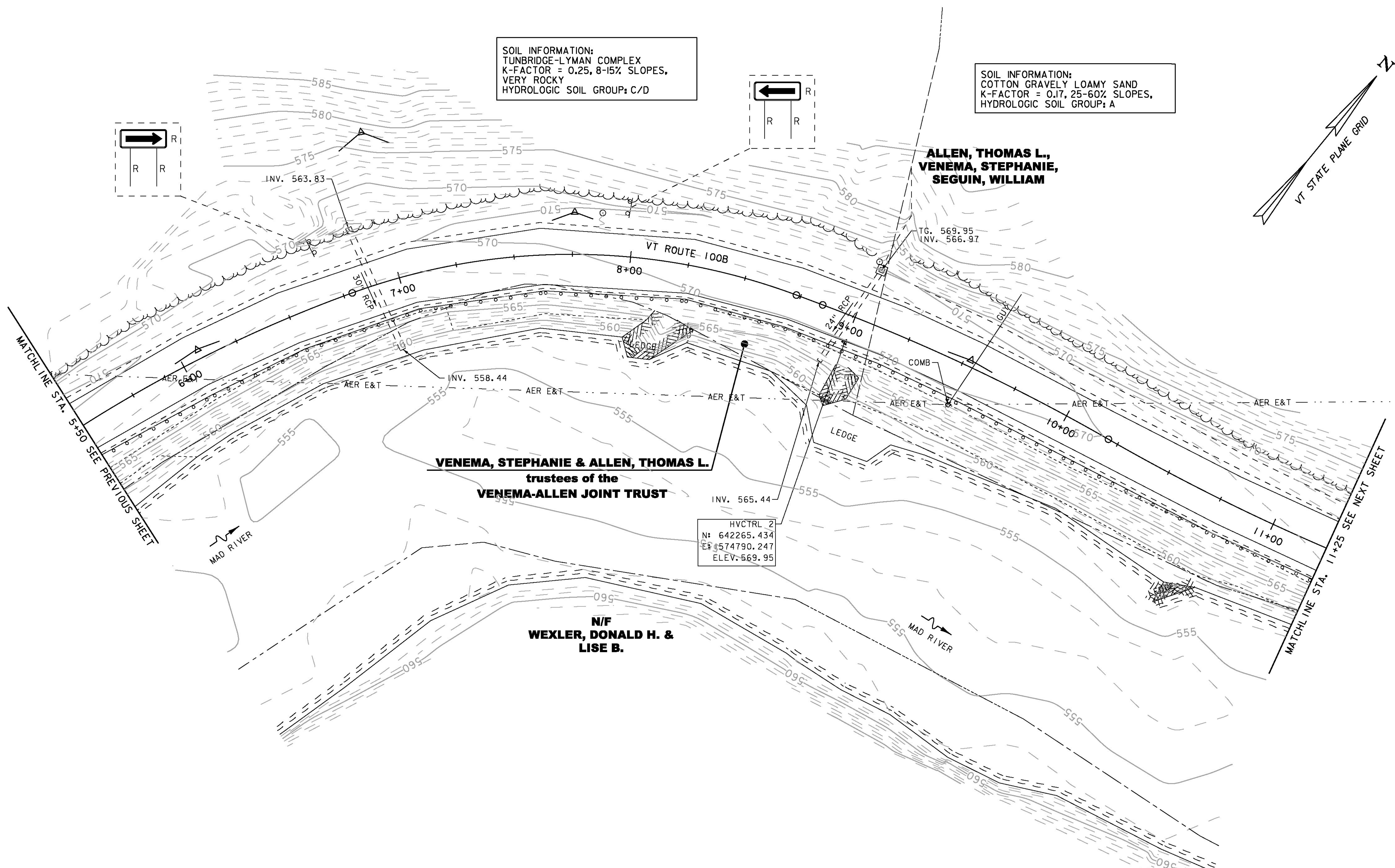
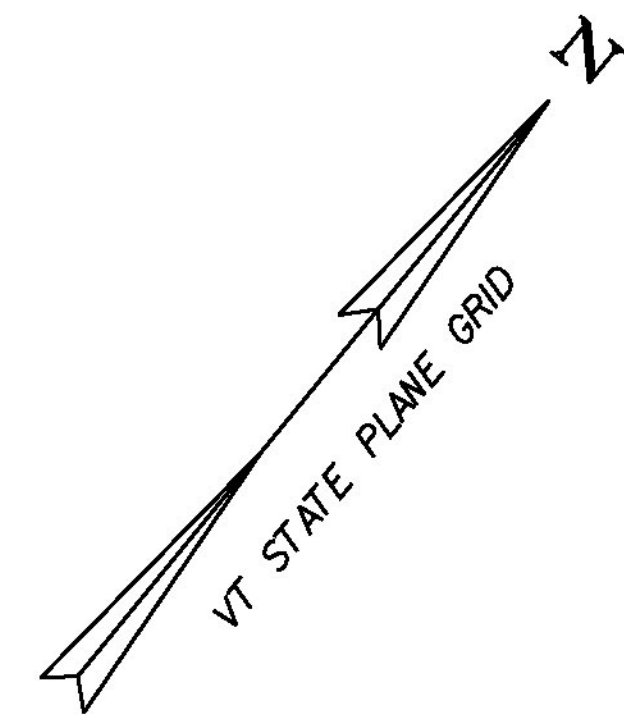
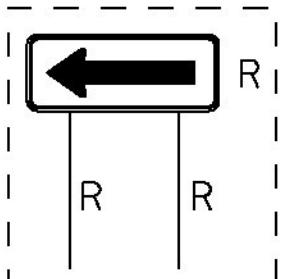
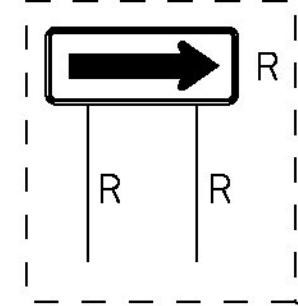

MATCHLINE STA. 5+50 SEE PREVIOUS SHEET

MATCHLINE STA. 11+25 SEE NEXT SHEET

VENEMA, STEPHANIE & ALLEN, THOMAS L.
 trustees of the
VENEMA-ALLEN JOINT TRUST

N/F
WEXLER, DONALD H. &
LISE B.

ALLEN, THOMAS L.,
VENEMA, STEPHANIE,
SEGUIN, WILLIAM

HVCTRL 2
 N: 642265.434
 E: 9574790.247
 ELEV: 569.95

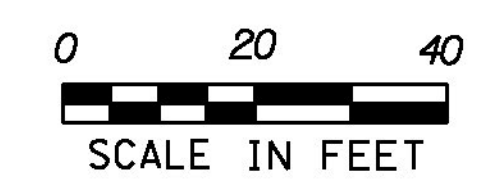

PROJECT NAME: MORETOWN	PLOT DATE: 2/17/2015
PROJECT NUMBER: ER STP 0167 (15)	DRAWN BY: B. MACK
FILE NAME: z12c524.EPSC.dgn	CHECKED BY: J. TUCKER
PROJECT LEADER: J. TUCKER	EPSC EXISTING CONDITIONS - SHEET 2
DESIGNED BY: B. BRESLEND	SHEET 33 OF 57