

GEOTEXTILE UNDER STONE FILL
 STA. 2+33 - STA. 2+58 LT
 STA. 4+76 - STA. 4+97 LT

STONE FILL, TYPE II
 STA. 2+33 - STA. 5+50 RT
 STA. 2+33 - STA. 2+58 LT
 STA. 4+76 - STA. 4+97 LT

STONE FILL, TYPE IV
 STA. 2+33 - STA. 5+50 RT

GRUBBING MATERIAL
 STA. 2+33 - STA. 5+50 RT
 STA. 2+33 - STA. 2+58 LT
 STA. 4+76 - STA. 4+97 LT

STEEL BEAM GUARDRAIL, GALVANIZED
 STA. 2+07 - STA. 5+50 RT

REMOVING SIGNS
 AS SHOWN - 3

REMOVAL AND DISPOSAL OF GUARDRAIL
 STA. 2+26 - STA. 5+50 RT

TEMPORARY 4 INCH WHITE LINE, PAINT
 STA. 1+00 - STA. 5+50 (SOLID LT & RT)

TEMPORARY 4 INCH YELLOW LINE, PAINT
 STA. 1+00 - STA. 5+50 (SOLID LT & RT)

DURABLE 4 INCH WHITE LINE (SEE OPTION ITEMS)
 STA. 1+00 - STA. 5+50 (SOLID LT & RT)

DURABLE 4 INCH YELLOW LINE (SEE OPTION ITEMS)
 STA. 1+00 - STA. 5+50 (SOLID LT & RT)

CONSTRUCT GRAVEL DRIVES
W/ 4'-0" PAVED APRON

STA. 1+57.00 - STA. 2+01.00 LT - 44'-0"
 MATCH EXISTING DRIVE AT LIMIT OF WORK

6 INCH UNDERDRAIN PIPE
 STA. 2+65 - STA. 4+85 LT
 STA. 5+00 - STA. 5+50 LT

RELOCATE MAILBOX, SINGLE SUPPORT
 STA. 2+08 LT

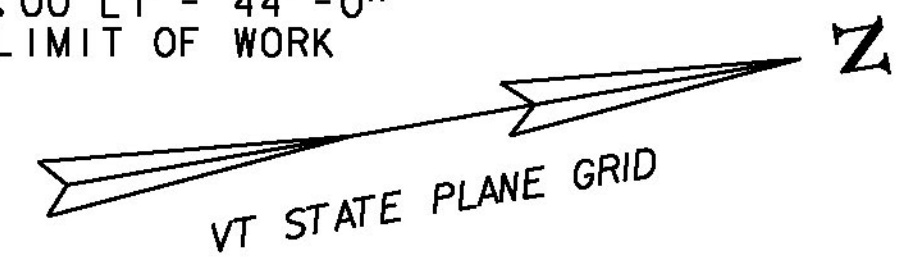

2
ALLEN, THOMAS L.,
VENEMA, STEPHANIE,
SEGUIN, WILLIAM

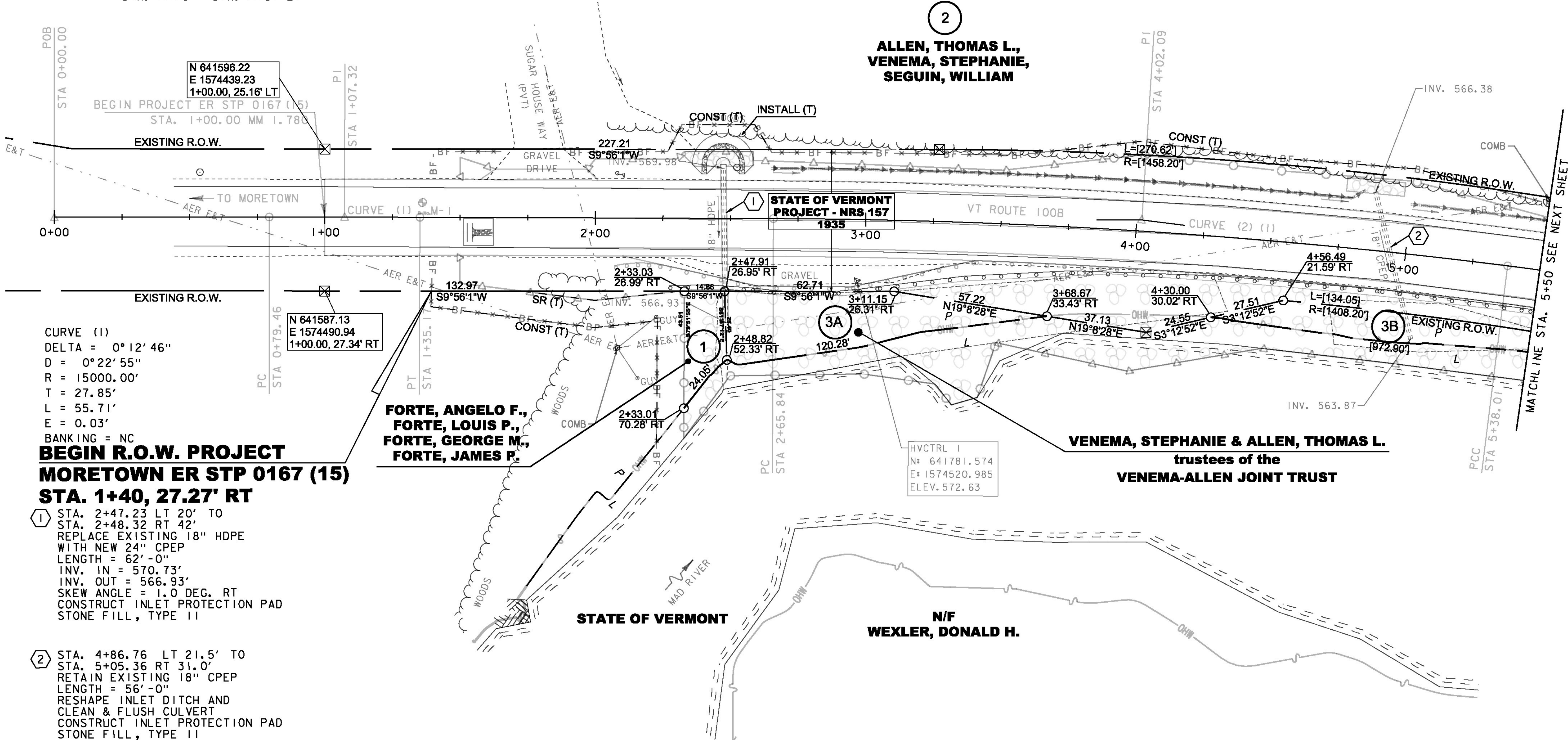

CURVE (1)
 DELTA = 0°12'46"
 D = 0°22'55"
 R = 15000.00'
 T = 27.85'
 L = 55.71'
 E = 0.03'
 BANKING = NC

BEGIN R.O.W. PROJECT
MORETOWN ER STP 0167 (15)
STA. 1+40, 27.27' RT

1 STA. 2+47.23 LT 20' TO
 STA. 2+48.32 RT 42'
 REPLACE EXISTING 18" HDPE
 WITH NEW 24" CPEP
 LENGTH = 62'-0"
 INV. IN = 570.73'
 INV. OUT = 566.93'
 SKEW ANGLE = 1.0 DEG. RT
 CONSTRUCT INLET PROTECTION PAD
 STONE FILL, TYPE II

2 STA. 4+86.76 LT 21.5' TO
 STA. 5+05.36 RT 31.0'
 RETAIN EXISTING 18" CPEP
 LENGTH = 56'-0"
 RESHAPE INLET DITCH AND
 CLEAN & FLUSH CULVERT
 CONSTRUCT INLET PROTECTION PAD
 STONE FILL, TYPE II

CURVE (2)
 DELTA = 61°04'58"
 D = 2°32'47" (1) D = 9°42'40" (2) D = 20°50'05" (3)
 R = 2250.00' (1) R = 590.00' (2) R = 275.00' (3)
 T = 455.58' (1) T = 199.13' (2)
 L = 272.17' (1) L = 140.79' (2) L = 194.29' (3)
 E = 45.66'
 BANKING = 0.034 FT/FT (1) 0.076 FT/FT (2) 0.077 FT/FT (3)
 40 MPH 40 MPH 30MPH

LINES SHOWN ON THIS PLAN AS EXISTING
 PROPERTY LINES P/L ARE BELIEVED TO
 BE ACCURATE BUT SHOULD NOT BE RELIED
 UPON FOR PURPOSES UNRELATED TO THE
 STATE OF VERMONT'S ACQUISITION OF LAND
 AND RIGHTS FOR THIS PROJECT.

**FOR R.O.W.
 USE ONLY**

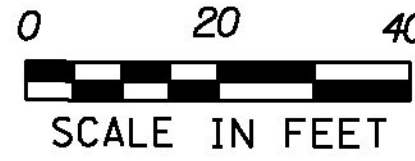

PROJECT NAME: MORETOWN
 PROJECT NUMBER: ER STP 0167(15)

FILE NAME: r12c524lay1.dgn
 PROJECT LEADER: P. LIBBY
 DESIGNED BY: DUBOIS & KING
 R.O.W. LAYOUT SHEET 1 OF 3

PLOT DATE: 03-NOV-2014
 DRAWN BY: A. EGZI
 CHECKED BY: R. CLOUTIER
 SHEET 21 OF 57