

**CONSTRUCTION APPROACH SIGNING**

NOT TO SCALE  
SEE STDS T-1 AND T-10 FOR SIGN PLACEMENT

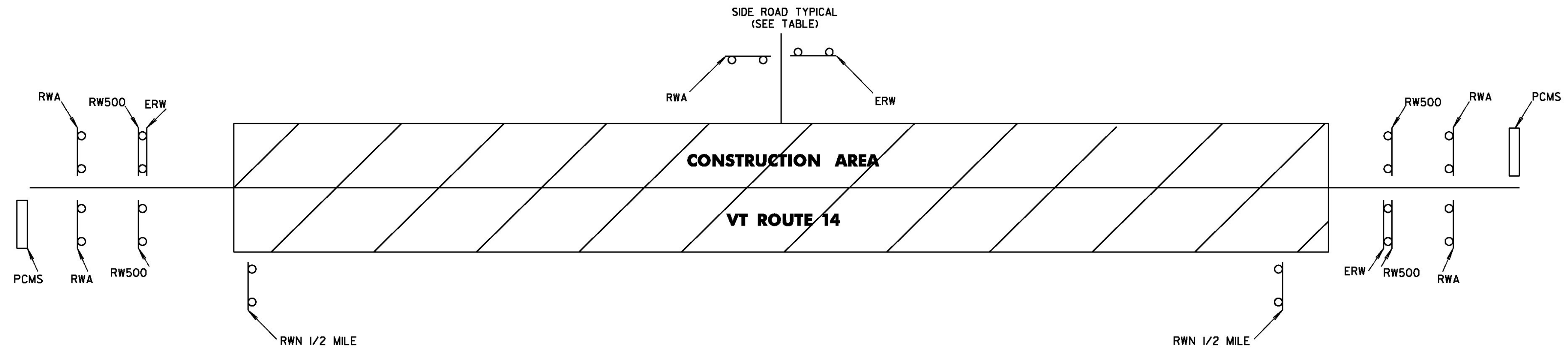

**NOTES:**

1. THE CONTRACTOR SHALL SUBMIT A SITE SPECIFIC TRAFFIC CONTROL PLAN TO THE ENGINEER FOR APPROVAL PRIOR TO THE START OF CONSTRUCTION. THE COST OF PREPARING THIS PLAN (AND MAKING CHANGES IF NECESSARY) WILL NOT BE PAID SEPARATELY BUT WILL BE PAID AS PART OF ITEM 641.0, "TRAFFIC CONTROL". THE TRAFFIC CONTROL PLAN SHALL BE IN COMPLIANCE WITH VTRANS STANDARDS AND 2009 MUTCD. WHERE CONFLICTS EXIST, THE 2009 MUTCD SHALL GOVERN.
2. THE CONTRACTOR SHALL INCLUDE A CONSTRUCTION SIGN APPROACH PACKAGE FOR EXPECTED LANE CLOSURES AND WORK ZONE SPEED REDUCTIONS IN COMPLIANCE WITH THE TRAFFIC CONTROL NOTES AND PART 6 OF THE 2009 MUTCD. PAYMENT FOR PROVIDING THIS PACKAGE WILL BE PAID AS PART OF ITEM 641.0, "TRAFFIC CONTROL".
3. THE BID PRICE FOR "TRAFFIC CONTROL", ITEM 641.0, SHALL INCLUDE ALL OF THE FOLLOWING, AS NEEDED: APPROACH AND ON-PROJECT CONSTRUCTION SIGNING, PORTABLE ARROW BOARDS, BARRELS, CONES, BARRICADES, TEMPORARY REGULATORY AND WARNING SIGNS, AND POSTS AS DETAILED IN VAOT STANDARDS. ALL ADJUSTING, RELOCATING, AND REMOVING OF THESE DEVICES AS DIRECTED BY THE ENGINEER SHALL ALSO BE INCLUDED. THE FOLLOWING ITEMS WILL BE PAID FOR SEPARATELY:  
646.602, 646.612 - TEMPORARY PAVEMENT MARKINGS  
630.10 UNIFORMED TRAFFIC OFFICERS, 630.15 - FLAGGERS
4. THE MUTCD 2009 AND ITS LATEST REVISIONS SHALL BE THE STANDARD FOR ALL TRAFFIC CONTROL DEVICES. EXISTING SIGNS, SIGNALS AND MARKINGS SHALL BE VALID UNTIL SUCH TIME AS THEY ARE REPLACED OR RECONSTRUCTED. WHEN NEW TRAFFIC CONTROL DEVICES ARE ERECTED OR PLACED OR EXISTING TRAFFIC CONTROL DEVICES ARE REPLACED OR REPAIRED THE EQUIPMENT, DESIGN, METHOD OF INSTALLATION, PLACEMENT OR REPAIR SHALL CONFORM WITH SUCH STANDARDS.
5. CONES SHALL BE USED TO CLEARLY DEFINE THE TRAVEL SPACE AND PROVIDE SEPARATION FROM THE WORK SPACE ALONG ITS ENTIRE LENGTH.
6. AS THE PAVING OPERATION MOVES, THE FLAGGER SIGNS SHALL BE MOVED ACCORDINGLY. AT NO TIME SHOULD THE FLAGGER SYMBOL SIGN BE MORE THAN 1000 FT FROM THE FLAGGER STATION. FLAGGER SIGNS SHALL BE COVERED OR TURNED AWAY IF FLAGGING OPERATIONS CEASE FOR MORE THAN 15 MINUTES.
7. NO CONSTRUCTION SIGNS SHALL BE INSTALLED AS TO INTERFERE OR OBSTRUCT THE VIEW OF EXISTING TRAFFIC CONTROL DEVICES, STOPPING SIGHT DISTANCE, AND CORNER SIGHT DISTANCE FROM DRIVES AND TOWN HIGHWAYS.

8. ALL PERMANENT SIGNS THAT CONFLICT WITH TEMPORARY TRAFFIC CONTROL WILL BE COMPLETELY COVERED, THE PAYMENT FOR WHICH WILL BE INCLUDED IN THE UNIT PRICE BID FOR ITEM 641.0 TRAFFIC CONTROL.
9. CONSTRUCTION SIGNS SHALL BE IN NEW OR LIKE NEW CONDITION PER VAOT STANDARDS.
10. DIAMOND SHAPED SIGNS SHALL BE 4'X4' WITH BLACK TEXT AND BORDER ON A RETROREFLECTIVE FLUORESCENT ORANGE BACKGROUND.
11. CONSTRUCTION ZONE SIGNS SHALL BE INSTALLED AS OUTLINED IN THE SPECIAL PROVISIONS.
12. WHERE TEMPORARY SIGNS ARE PLACED BEHIND GUARDRAIL, THEY SHALL BE ADJUSTED SUCH THAT THE BOTTOM OF THE SIGNS ARE ABOVE THE TOP OF GUARDRAIL.

	ROAD WORK AHEAD	END ROAD WORK	ROAD WORK 500 FT	ROAD WORK NEXT 1/2 MILES	PCMS
<b>SHARON</b>					
BEGIN PROJECT (VT 14)	2	1	2	1	1
WHITE BROOK RD	1	1			
END PROJECT (VT 14)	2	1	2	1	1
TOTALS	5	3	4	2	2

**LEGEND**

- RWA = ROAD WORK AHEAD
- RW500 = ROAD WORK 500 FT
- ERW = END ROAD WORK
- RWN = ROAD WORK NEXT 1/2 MILE
- PCMS = PORTABLE CHANGEABLE MESSAGE SIGN

**DETAILS ARE NOT TO SCALE**

PROJECT NAME: SHARON	PLOT DATE: 3/31/2015
PROJECT NUMBER: ER STP 0147(20)	DRAWN BY: B. MACK
FILE NAME: z12c410.dgn	CHECKED BY: A. SANZ
PROJECT LEADER: J. TUCKER	SHEET 65 OF 66
DESIGNED BY: B. BRESLEND	
CONSTRUCTION APPROACH SIGNING SHEET	