

STONE FILL, TYPE I
 STA. 328+53 - STA. 328+67 LT
 STA. 328+59 - STA. 328+90 RT

STONE FILL, TYPE II
 STA. 330+00 - STA. 331+50 LT

GRUBBING MATERIAL (12")
 STA. 330+00 - STA. 331+50 LT

GRUBBING MATERIAL (6")
 STA. 328+59 - STA. 328+90 RT

GEOTEXTILE UNDER STONE FILL
 STA. 328+53 - STA. 328+67 LT
 STA. 328+59 - STA. 328+90 RT

TEMPORARY 4 INCH WHITE LINE, PAINT
 STA. 328+25 - STA. 333+00 (SOLID LT & RT)

TEMPORARY 4 INCH YELLOW LINE, PAINT
 STA. 328+25 - STA. 333+00 (SOLID LT & RT)

DURABLE 4 INCH WHITE LINE (SEE OPTION ITEMS)
 STA. 328+25 - STA. 333+00 (SOLID LT & RT)

DURABLE 4 INCH YELLOW LINE (SEE OPTION ITEMS)
 STA. 328+25 - STA. 333+00 (SOLID LT & RT)

6 INCH UNDERDRAIN PIPE
 STA. 328+25 - STA. 328+50 RT

REMOVE AND RESET GUARDRAIL
 STA. 328+25 - STA. 333+00 LT

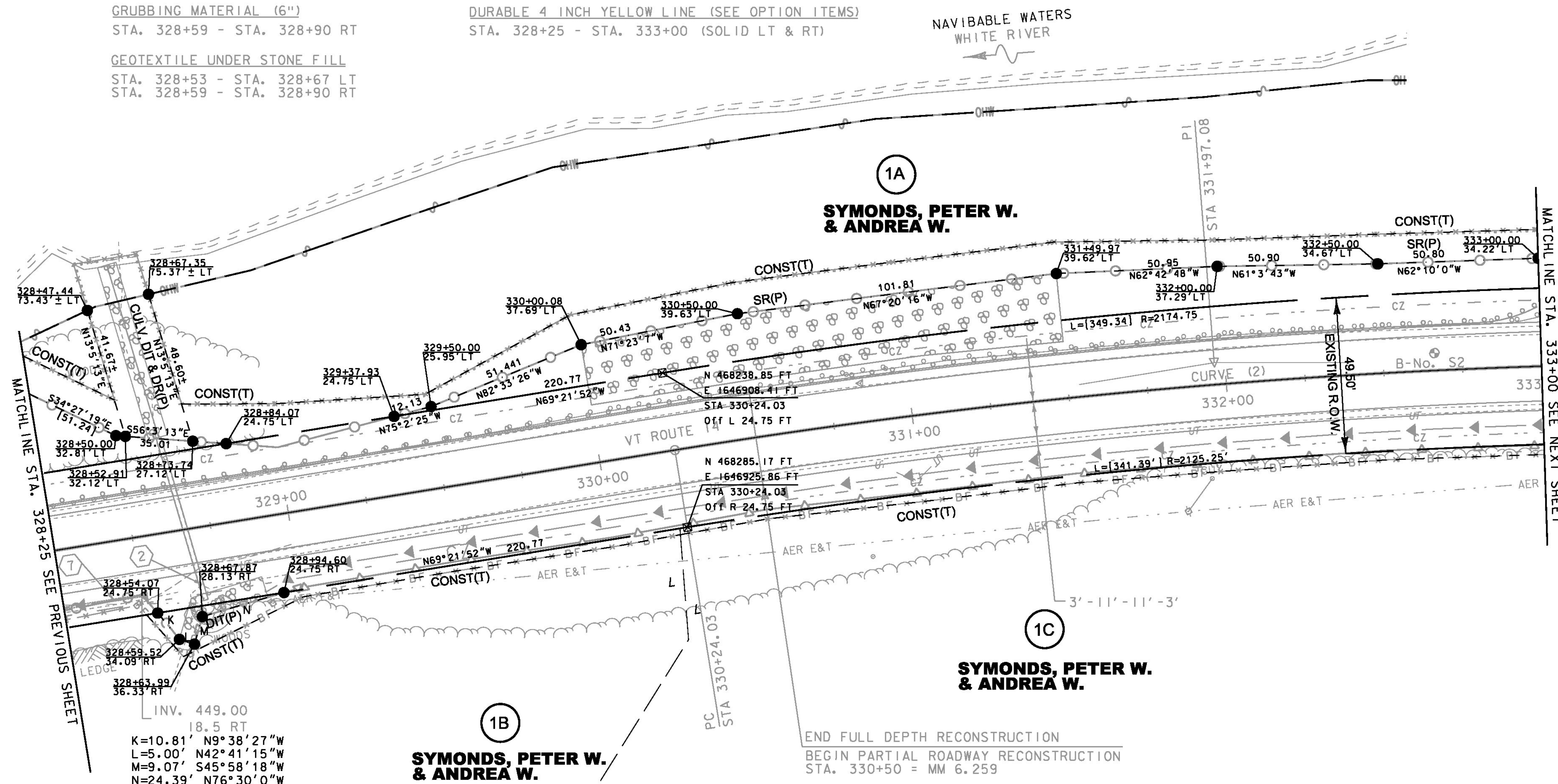
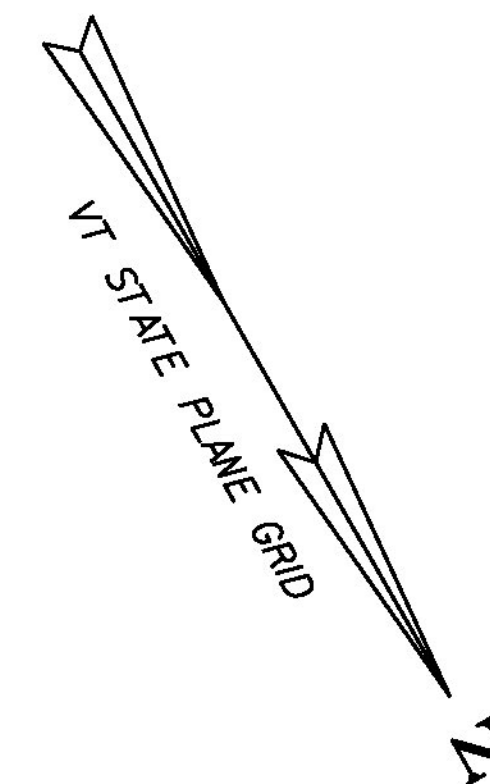

② STA. 328+70.00 RT 23' TO
 STA. 328+63.30 LT 30'
 REPLACE EXISTING 15" CMP
 WITH NEW 24" CPEP (SL)
 LENGTH = 54'-0"
 INV. IN = 449.93'
 INV. OUT = 446.77'
 ASKEW ANGLE = 82.9°RT
 CONSTRUCT INLET PROTECTION PAD
 STONE FILL, TYPE I

⑦ STA. 328+25.00 RT 18.5' TO
 STA. 328+50.00 RT 18.5'
 INSTALL 6" UNDERDRAIN
 LENGTH = 25'-0"

BARRIER FENCE
 STA. 328+25.00 - STA. 333+00.00 RT
 GEOTEXTILE FOR SILT FENCE, WOVEN WIRE REINFORCED
 STA. 328+25.00 - STA. 333+00.00 LT
 INLET PROTECTION DEVICE, TYPE I
 STA. 328+70.00 RT
 TEMPORARY STONE CHECK DAM, TYPE I
 STA. 328+25.00 - 328+52.00 RT
 STA. 328+97.00 - 333+00.00 RT

LINE SHOWN ON THIS PLAN AS EXISTING
 PROPERTY LINES P/L ARE BELIEVED TO
 BE ACCURATE BUT SHOULD NOT BE RELIED
 UPON FOR PURPOSES UNRELATED TO THE
 STATE OF VERMONT'S ACQUISITION OF LAND
 AND RIGHTS FOR THIS PROJECT.

CURVE (2)
 DELTA = 9°12'13"
 D = 2°39'54"
 R = 2150.00'
 T = 173.05'
 L = 345.36'
 E = 6.95'
 BANKING = 0.049 FT/FT AT 50 MPH

**FOR R.O.W.
 USE ONLY**

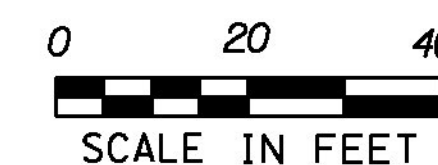

PROJECT NAME: SHARON
 PROJECT NUMBER: STP 0147 (20)

FILE NAME: z12c410bdr.dgn
 PROJECT LEADER: J. TUCKER
 DESIGNED BY: B. MACK
 ROW LAYOUT SHEET 2

PLOT DATE: 10-SEP-2014
 DRAWN BY: B. MACK
 CHECKED BY: J. TUCKER
 ROW SHEET 23 OF 66