

NW, SW, & SE CORNERS

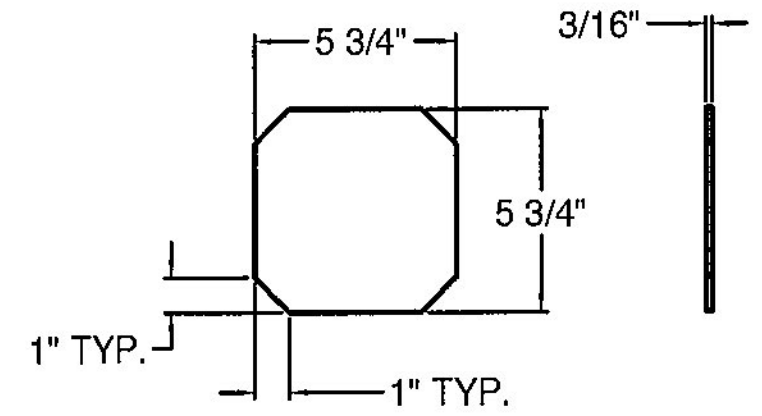

6" X 6" KICKBACK ENDCAP DETAIL

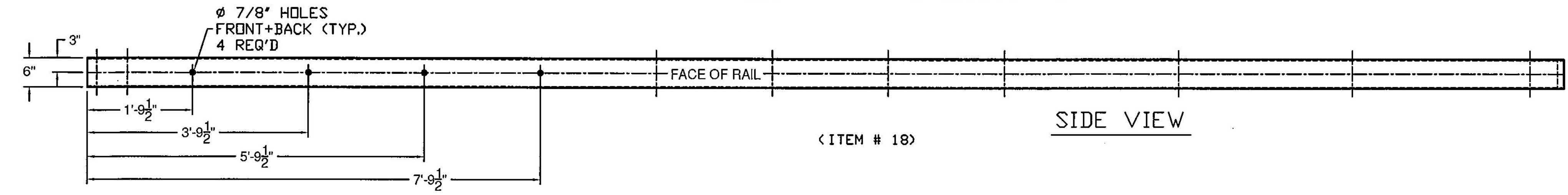

SIDE VIEW

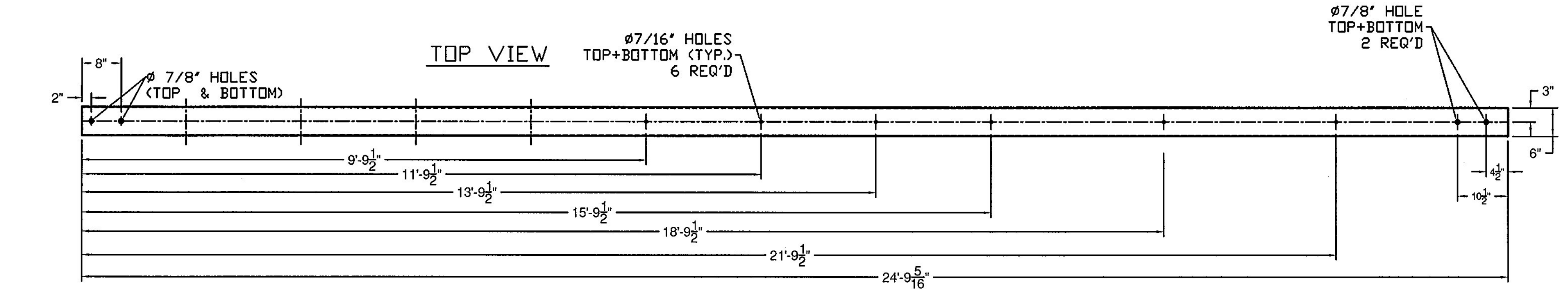

TOP VIEW

NW, SW, & SE CORNERS

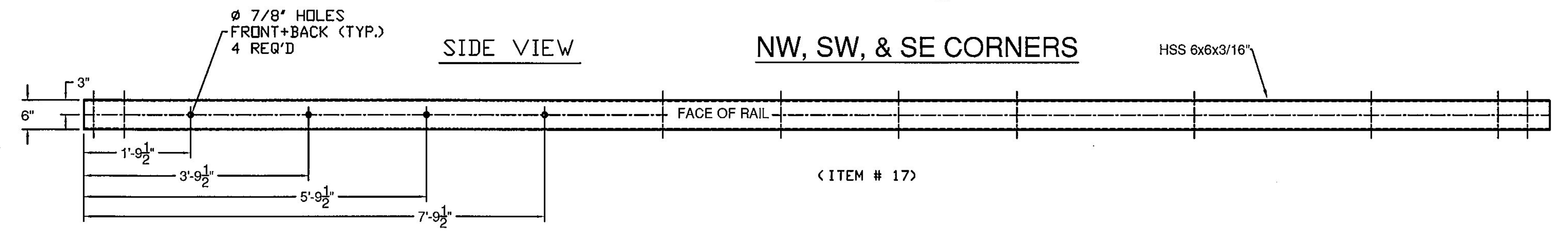

SIDE VIEW

<ITEM # 17>

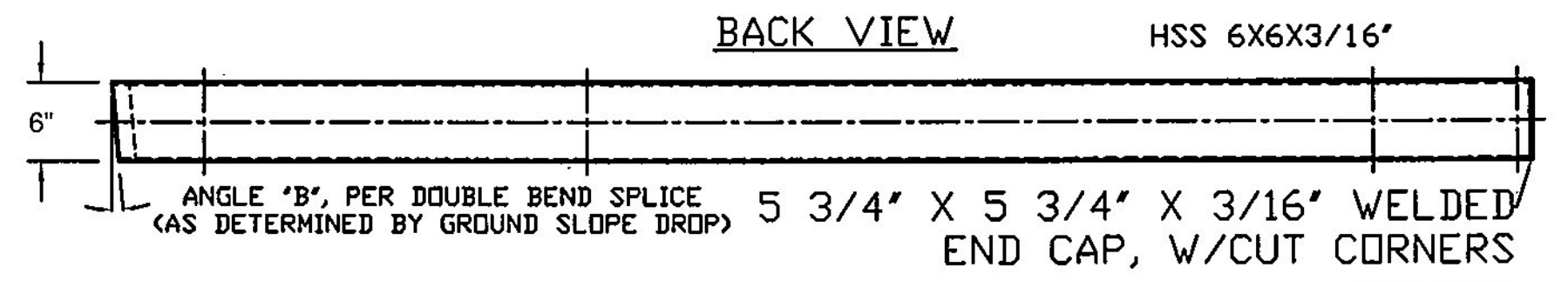

TOP VIEW

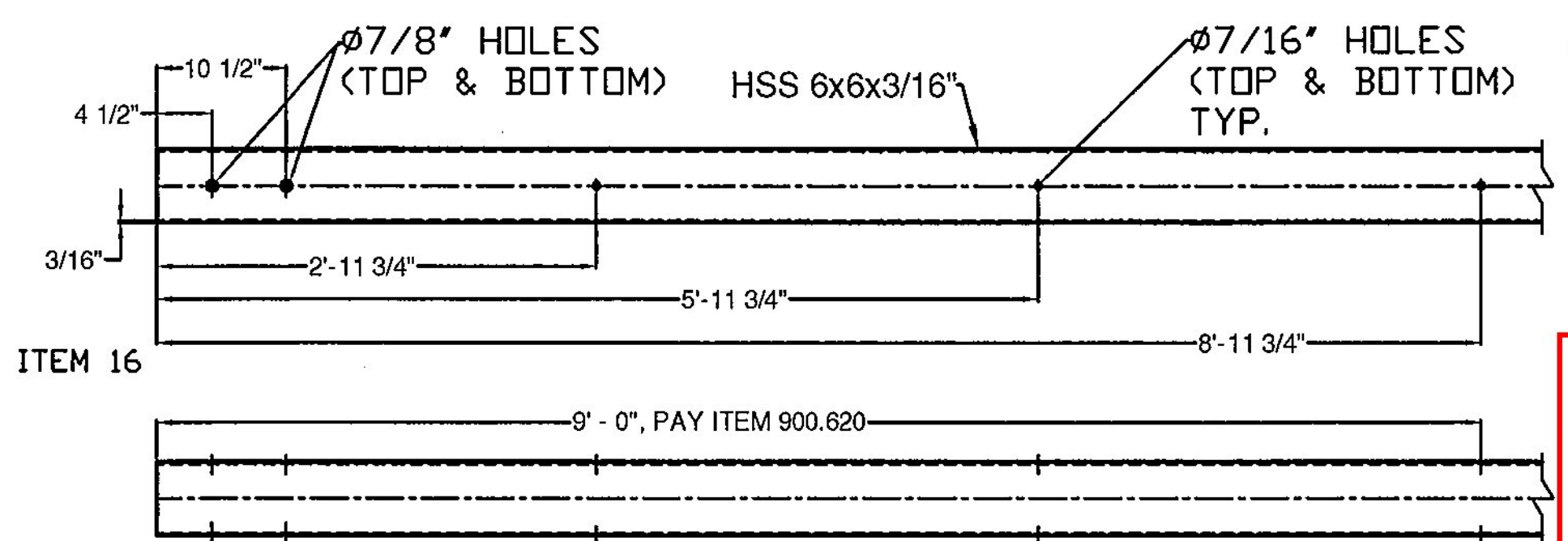
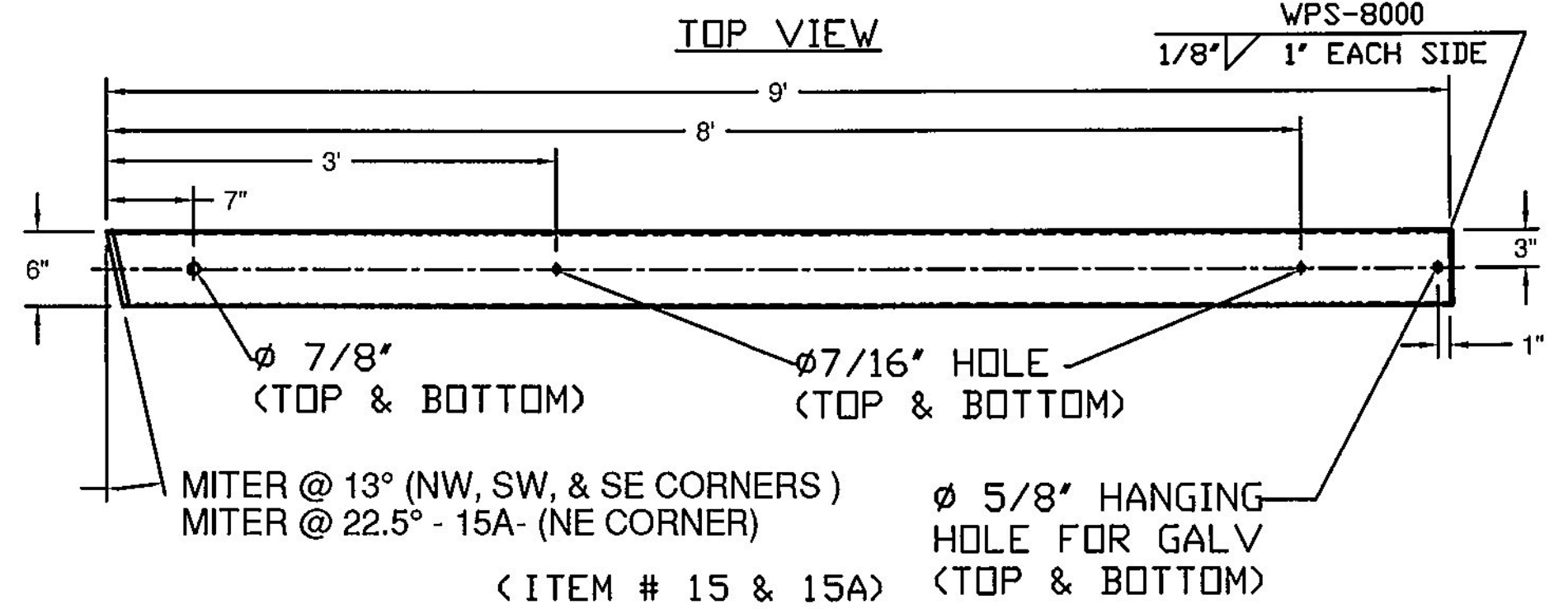

ITEM 16

9' - 0", PAY ITEM 900.620

Vermont Agency of Transportation  
**RECEIVED**  
CK'D BY TYLin OK'D BY TYLin  
February 13, 2017  
RESUBMIT No Approved  
BY Kristin Higgins DATE 2/15/2017

**T.Y. LIN INTERNATIONAL**  
THE STAMPED DOCUMENTS ARE HEREBY:  
X APPROVED  
APPROVED AS NOTED  
REVISE AND RESUBMIT  
SEE TRANSMITTAL FOR ADDITIONAL INFORMATION AS APPLICABLE.  
THIS REVIEW IS FOR GENERAL CONFORMANCE WITH DESIGN CONCEPT ONLY. ANY DEVIATION FROM THE PLANS OR SPECIFICATIONS NOT CLEARLY NOTED BY THE CONTRACTOR HAS NOT BEEN REVIEWED. REVIEW BY THE ENGINEER SHALL NOT RELIEVE THE CONTRACTOR OF THE CONTRACTUAL RESPONSIBILITY FOR ANY ERRORS OR DEVIATION FROM THE CONTRACT REQUIREMENTS.  
JOSH OLUND REVIEWER February 15, 2017 DATE

ITEM #: 900.620  
STRUCTURAL STEEL TO COMPLY W/ ASTM A6  
TOLERANCE UNLESS OTHERWISE NOTED:  
FRACTIONS = ± 1/16"  
ANGLES = ± 1/2"  
DIAMETERS = ± 1/32"

SHEET 5 OF 6

**TRANSITION - CONCRETE PARAPET TO HIGHWAY GUIDE RAIL**  
PROJECT 148 CHELSEA BHF 0169(9), VT ROUTE 110, RURAL MAJOR COLLECTOR BRIDGE 9  
TOWN OF CHELSEA, COUNTY OF ORANGE, VERMONT

R NO.	DATE	DESCRIPTION	BY	R NO.	DATE	DESCRIPTION	BY
E 1	2/7/17	REVISED PER 2/3/17 DWG REVIEW	D.K.	E			

DRAWN	D.K.	1/3/17
CHECKED	E.P.	1/3/17
APPROVED	D.L.	1/12/17
SCALE	SCHEMATIC	
DRAWING NO.	R.L. LAFAYETTE - CHELSEA (9) - 1	

**ELDERLEE, INC.**  
OAKS CORNERS, NEW YORK 14518  
email: dlong@elderlee.com / epeek@elderlee.com  
Tel: 315-789-6670 Fax: 315-789-6615