

| LOAD DATA | |
|-----------|----------|
| DEAD LOAD | 92 KIPS |
| LIVE LOAD | 132 KIPS |

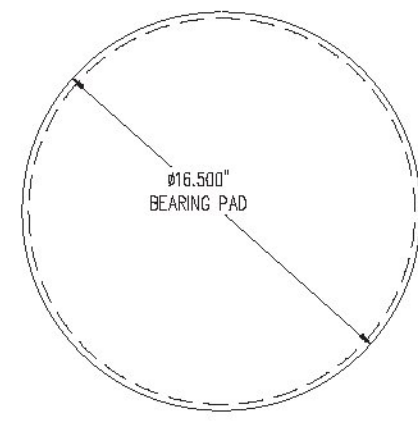

2A - PLAN VIEW
LAMINATED ELASTOMERIC BEARING
DSB ITEM 51817.1103A1.1
(4) REQ'D @ BRIDGE 11, ABUTMENT 1
(4) REQ'D @ BRIDGE 11, ABUTMENT 2
(8) REQ'D TOTAL

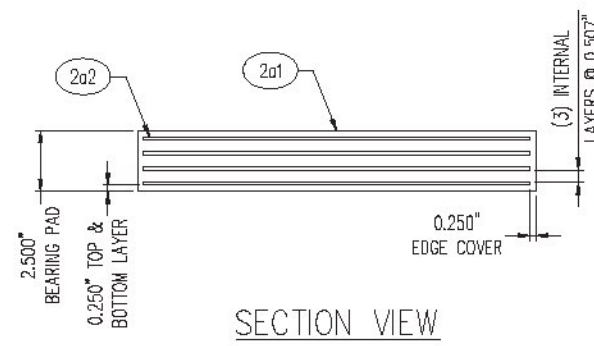

SECTION VIEW

Vermont Agency of Transportation
RECEIVED
CK'D BY T.Y.Lin OK'D BY T.Y.Lin
February 13, 2017
RESUBMIT No Approved
By Kelson Higgins DATE 2/14/2017

T.Y. LIN INTERNATIONAL
THE STAMPED DOCUMENTS ARE HEREBY:
-X- APPROVED
APPROVED AS NOTED
RELEASE AND RESUBMIT
SEE TRANSMITTAL FOR ADDITIONAL INFORMATION AS APPLICABLE.
THIS REVIEW IS FOR GENERAL COORDINATION WITH DESIGN CONCEPT ONLY. ANY DEVIATION FROM THE PLANS OR SPECIFICATIONS NOT CLEARLY REVIEWED BY THE CONTRACTOR HAS NOT BEEN REVIEWED BY THE ENGINEER AND SHALL NOT RELIEVE THE CONTRACTOR OF THE CONTRACTUAL RESPONSIBILITY FOR ANY ERRORS OR DEVIATION FROM THE CONTRACT REQUIREMENTS.
02/08/2018 February 14, 2017
02/08/2018 DATE

D.S. BROWN
D.S. BROWN COMPANY
300 E. CHERRY STREET
NORTH BATHING, OHIO 44882
419.527.2200
FAX: 419.220.0202
WWW.DSBROWN.COM

| NO. | QTY | DESCRIPTION | MATERIAL | LENGTH | REMARKS | INT. | REV. |
|-----|-----|---------------------|----------------|--------|---------|------|------|
| 2A | 8 | ELASTOMERIC BEARING | 51817.1103A1.1 | | | | 49 |
| 2a1 | 8 | 2.100\"/> | | | | | |

| TOLERANCE TABLE | |
|--|---------------------------|
| DESCRIPTION | TOLERANCE (INCHES U.S.G.) |
| ELASTOMERIC BEARING DESIGN THICKNESS < 1.250" | -0, +0.1181 |
| ELASTOMERIC BEARING DESIGN THICKNESS > 1.250" | -0, +0.2362 |
| ELASTOMERIC BEARING PLAN DIMENSIONS < .30" | -0, +0.2362 |
| ELASTOMERIC BEARING PLAN DIMENSIONS > .30" | -0, +0.4724 |
| THICKNESS OF INDIVIDUAL LAYERS OF ELASTOMER (LAMINATED BEARINGS ONLY) AT ANY POINT WITHIN THE BEARING | ±0.1181 |
| DEVIATION FROM A PLANE PARALLEL TO THE THEORETICAL SURFACE (AS DETERMINED BY MEASUREMENTS AT THE EDGE OF THE BEARINGS) (PARALLELISM) | |
| TOP & BOTTOM | ±0.0590 |
| SPIN | ±0.2362 |
| POSITION OF EXPOSED CONNECTION MEMBERS | ±0.1181 |
| ELASTOMERIC EDGE COVER | -0, +0.1181 |
| ELASTOMERIC BEARING HOLE OR SLOT SIZE | ±0.1181 |
| ELASTOMERIC BEARING HOLE OR SLOT LOCATION | ±0.1181 |

GENERAL NOTES:

- ALL MATERIALS SHALL CONFORM TO THE 2011 VERMONT AGENCY OF TRANSPORTATION STANDARD SPECIFICATIONS FOR CONSTRUCTION.
- THIS SHOP DRAWING WAS PREPARED IN ACCORDANCE WITH THE CONTRACT PLANS AND SPECIFICATIONS. THE D.S. BROWN COMPANY DOES NOT ACCEPT LIABILITY FOR THE DESIGN OF THE PRODUCTS DETAILED IN THIS SHOP DRAWING.
- THE D.S. BROWN COMPANY TO SUPPLY ONLY THE PARTS SHOWN ON THIS DRAWING.
- THE BEARINGS SHALL BE SAMPLED AND TESTED IN ACCORDANCE WITH AASHTO M281.
- INTERNAL ALIGNMENT PINS: AFTER FABRICATION, HOLES TO BE FILLED WITH ELASTOMER MATERIAL EQUIVALENT TO THAT USED IN THE MANUFACTURING OF THE PAD.
- WELDING PROCEDURES, IF APPLICABLE, SHALL BE ESTABLISHED BY THE CONTRACTOR TO RESTRICT THE MAXIMUM TEMPERATURE REACHED BY SURFACES IN CONTACT WITH THE ELASTOMER TO 200°F (93°C). TEMPERATURES SHALL BE DETERMINED BY TEMPERATURE INDICATING WAX PENCILS OR OTHER SUITABLE MEANS.
- IN ACCORDANCE WITH STATE SPECIFICATIONS, FABRICATOR MAY USE EITHER NEOPRENE OR NATURAL RUBBER FOR THE ELASTOMER.

| REV. | DESCRIPTION | DATE | DET. | CHK. |
|------|-------------|---------|------|------|
| 1 | NEW SHEET | 2/10/17 | EMF | ECW |

| ITEM | QUANTITY |
|----------------------------------|----------|
| LOCATION - VT RTE 110 | - |
| BRIDGE - 11 | - |
| PROJECT - 12C150 | - |
| F.P. NO. - BHF 0169 (9) & (10) | - |
| P.C. NO. - 1 | - |
| DESIGNER - T.Y.LIN INTERNATIONAL | - |
| CUSTOMER - CNU CONSTRUCTORS | - |

| REVISED | N.T.S. | EMF | ECW | DATE | REV. | BY |
|-------------------------------|--------|------|-----|---------|------|----|
| VERSIFLEX ELASTOMERIC BEARING | 51817 | 1103 | 1 | 2/10/17 | 02 | |