

MISCELLANEOUS MATERIALS

ITEM	MARK	QTY.	DESCRIPTION	REMARKS
1	MK-CH4	2	SET OF (3) 0.60"Ø STRAND LIFTING LOOPS	SEE DETAIL, THIS SHEET
2	MK-CH5	1	SET OF (3) 0.60"Ø STRAND LIFTING LOOPS	SEE DETAIL, THIS SHEET
3	MK-CH6	1	SET OF (3) 0.60"Ø STRAND LIFTING LOOPS	SEE DETAIL, THIS SHEET
4		1	BRIDGE PLAQUE	SUPPLIED BY OTHERS
5				
6		66	#4 x 6'-0" (EPOXY COATED)	
7		21	#4 x 6'-10" (EPOXY COATED)	INCLUDES (1) ADDITIONAL BAR FOR TESTING
8		4	#4 x 8'-8" (EPOXY COATED)	
9		20	#4 x 8'-0" (EPOXY COATED)	
10		2	#4 x 6'-5" (EPOXY COATED)	
11		20	#4 x 5'-2" (EPOXY COATED)	
12		2	#4 x 5'-7" (EPOXY COATED)	
13				
14				
15				

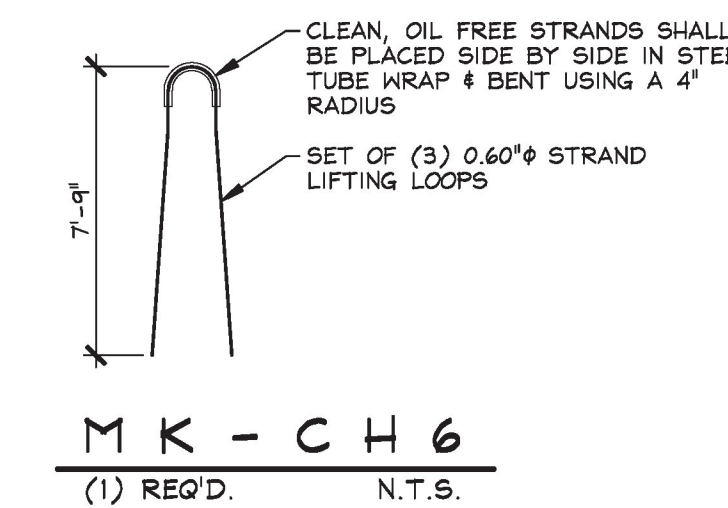
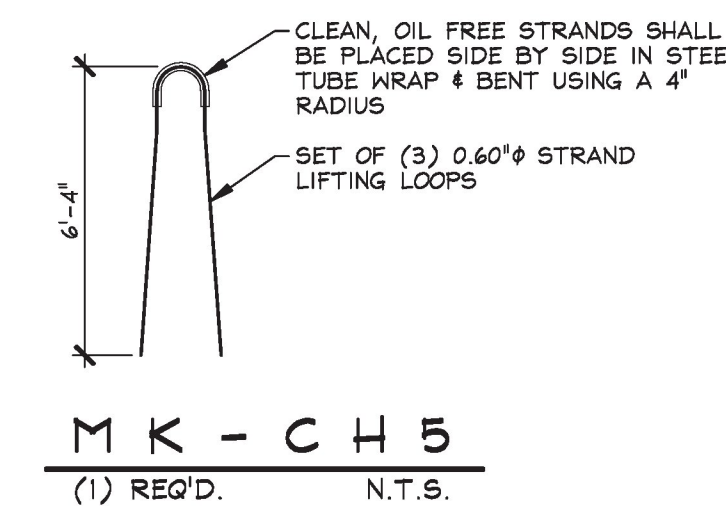
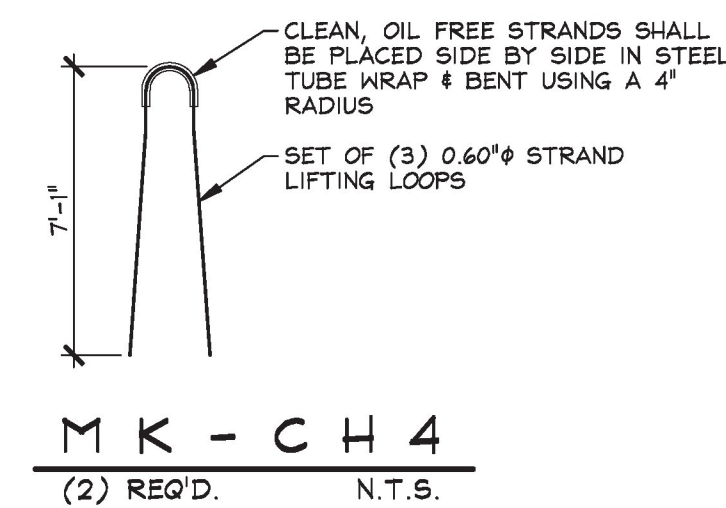
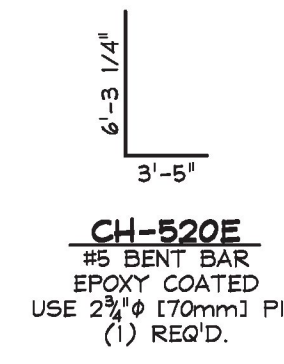
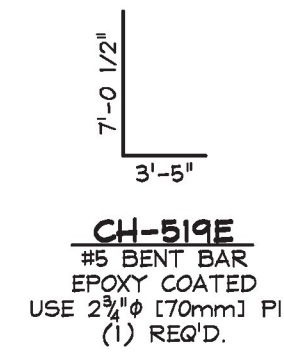
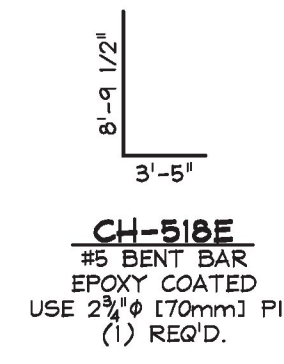
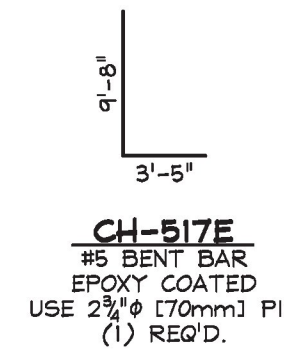
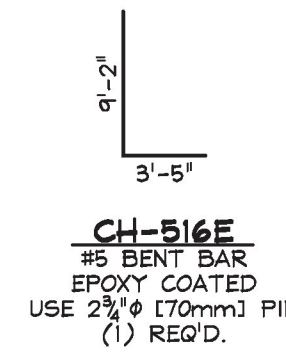
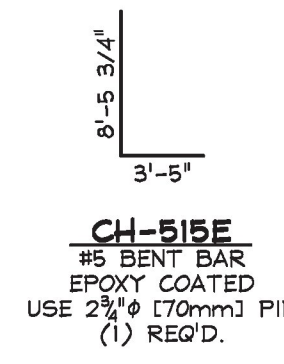
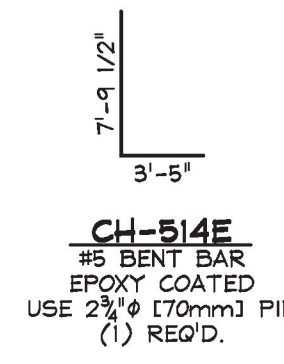
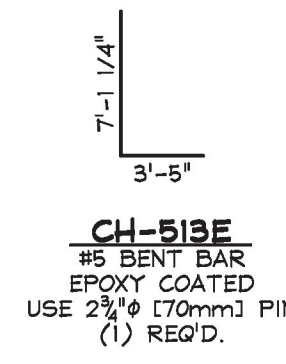
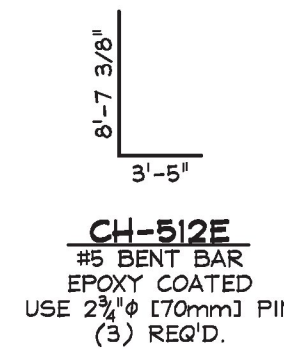
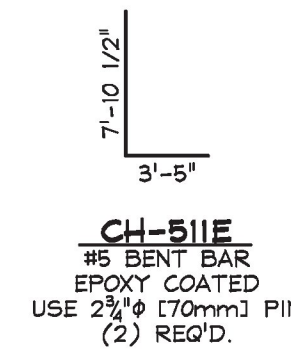
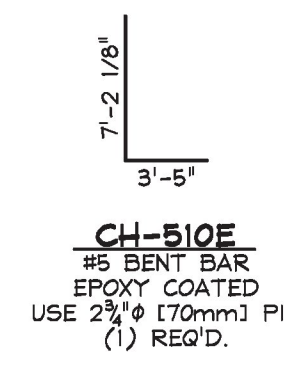
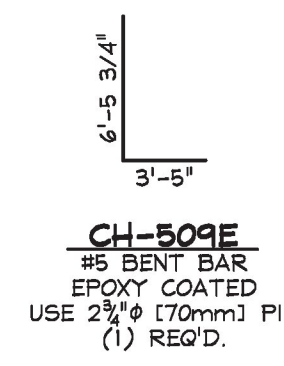
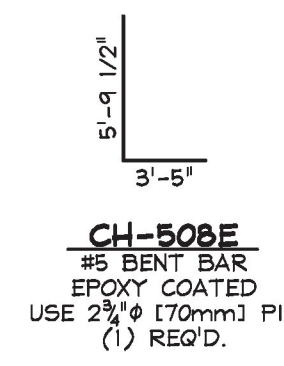
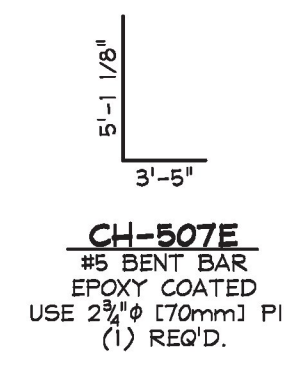
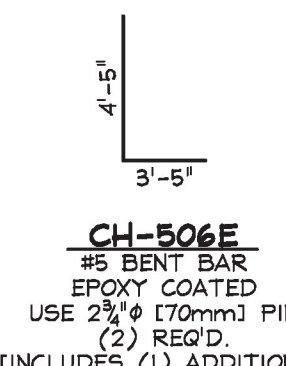
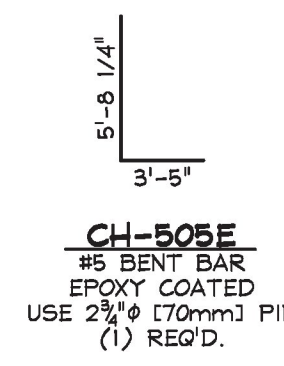
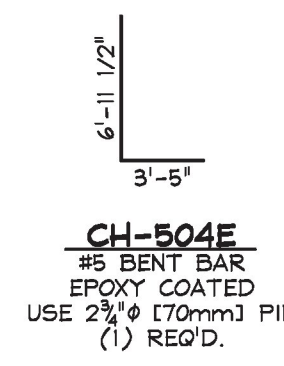
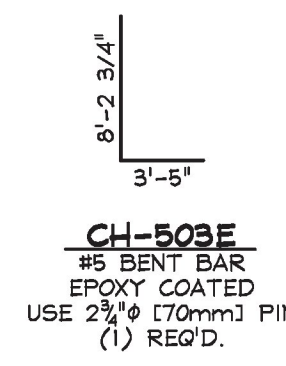
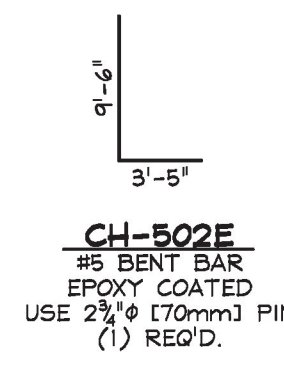
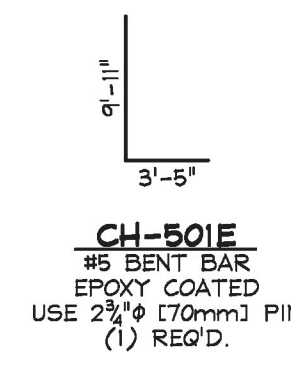
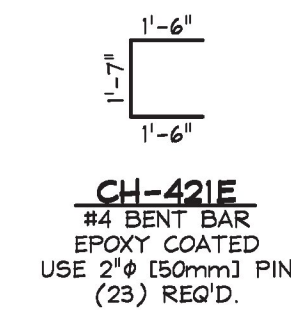
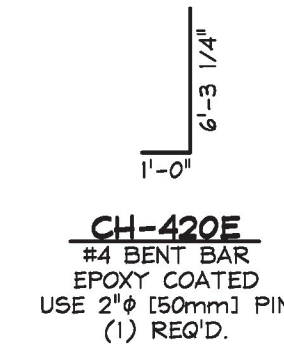
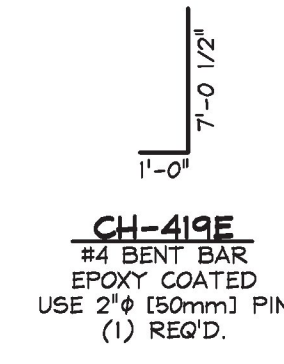
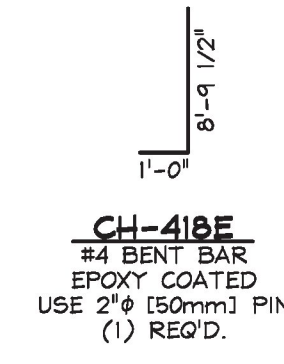
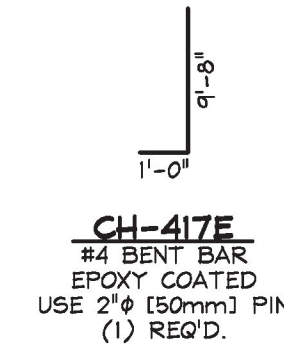
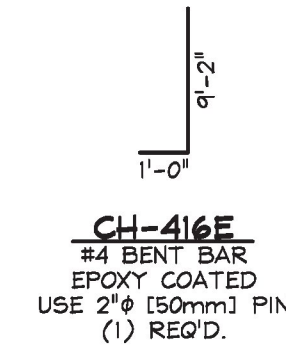
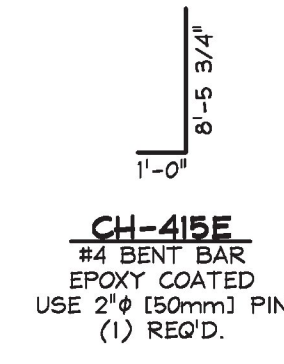
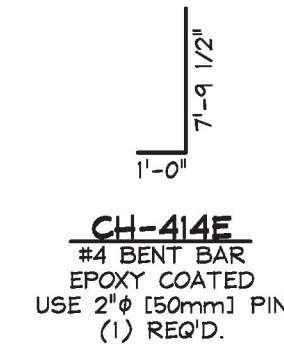
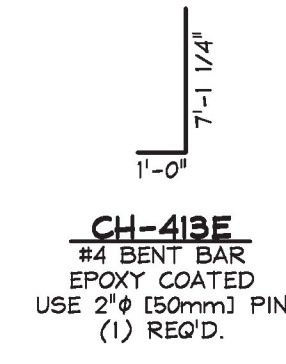
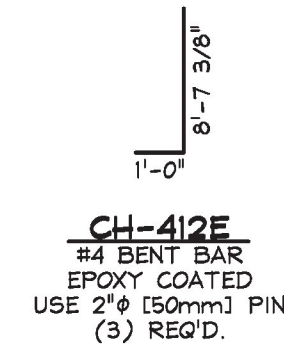
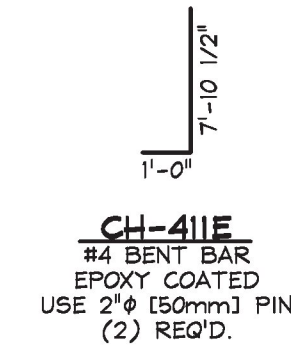
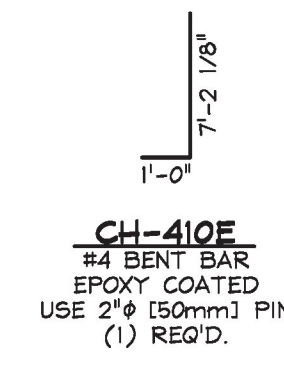
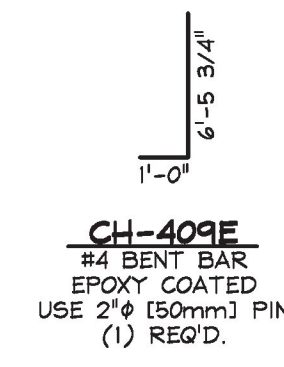
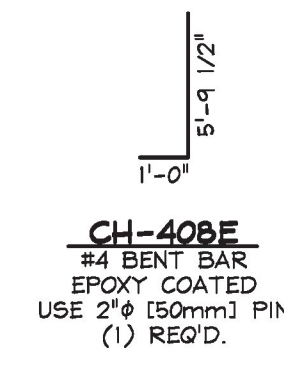
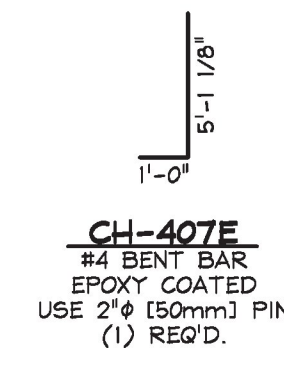
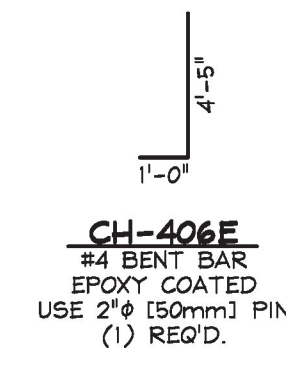
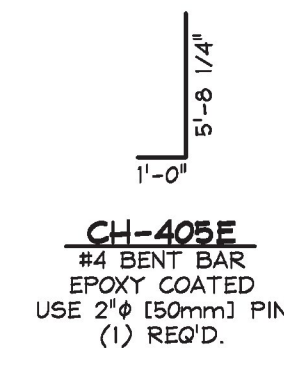
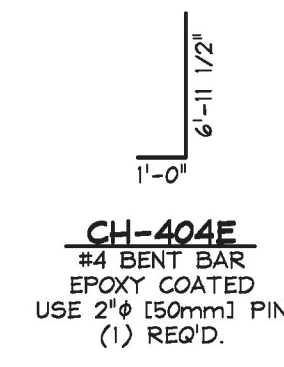
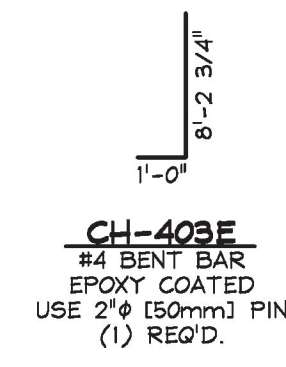
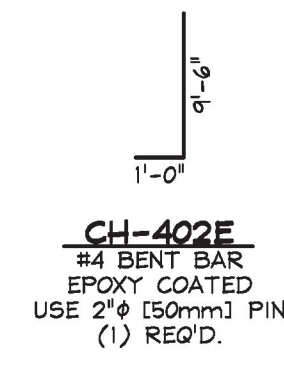
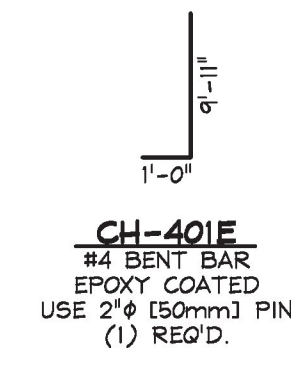

T.Y. LIN INTERNATIONAL
 THE STAMPED DOCUMENTS ARE HEREBY:
 APPROVED
 APPROVED AS NOTED
 REVISE AND RESUBMIT
 SEE TRANSMITTAL FOR ADDITIONAL INFORMATION AS APPLICABLE.
 THIS REVIEW IS FOR GENERAL CONFORMANCE WITH DESIGN CONCEPT ONLY. ANY DEVIATION FROM THE PLANS OR SPECIFICATIONS NOT CLEARLY NOTED BY THE CONTRACTOR HAS NOT BEEN REVIEWED. REVIEW BY THE ENGINEER SHALL NOT RELIEVE THE CONTRACTOR OF THE CONTRACTUAL RESPONSIBILITY FOR ANY ERRORS OR DEVIATION FROM THE CONTRACT REQUIREMENTS.
 JOSH OLUND REVIEWER March 29, 2017 DATE

3-27-17 REVISED PER RE-DESIGN
 APPROVAL STAMP:
 Vermont Agency of Transportation
RECEIVED
 CK'D BY TYLin OK'D BY TYLin
 March 28, 2017
 RESUBMIT No Approved
 BY Kristin Higgins DATE 3/31/2017

J.P. CARRARA & SONS INC.
 Precast & Prestress Manufacturer
 2464 OSE STR., MIDDLEBURY, VERMONT 05753 Phone:(802)388-6361 Fax:(802)388-9010
 CPM CONSTRUCTORS CONTRACTOR FREEPORT, MAINE
 STATE OF VERMONT AGENCY OF TRANSPORTATION COUNTY OF ORANGE
 TOWN OF CHELSEA
 VT ROUTE 110, RURAL MAJOR COLLECTOR BRIDGE NO.: 9 PROJECT NO.: BHF 0169(9)
 PRECAST RETAINING WALL MATERIALS LIST
 DATE: FEB. 28, 2017
 SCALE: NOTED
 CHKD: - DFTM: B.L.
 JOB NO: 23505-016
 DWG. NO: **M3**
 BRIDGE 9