

ABUTMENT I RECONSTRUCTION PLAN

SCALE: 3/8" = 1'-0"

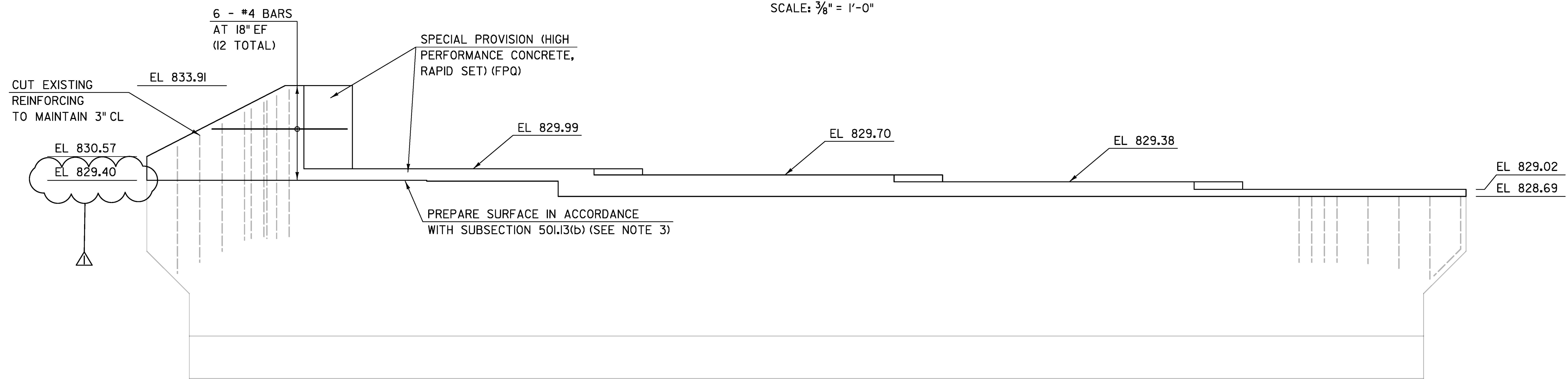

ABUTMENT I RECONSTRUCTION ELEVATION

SCALE: 3/8" = 1'-0"

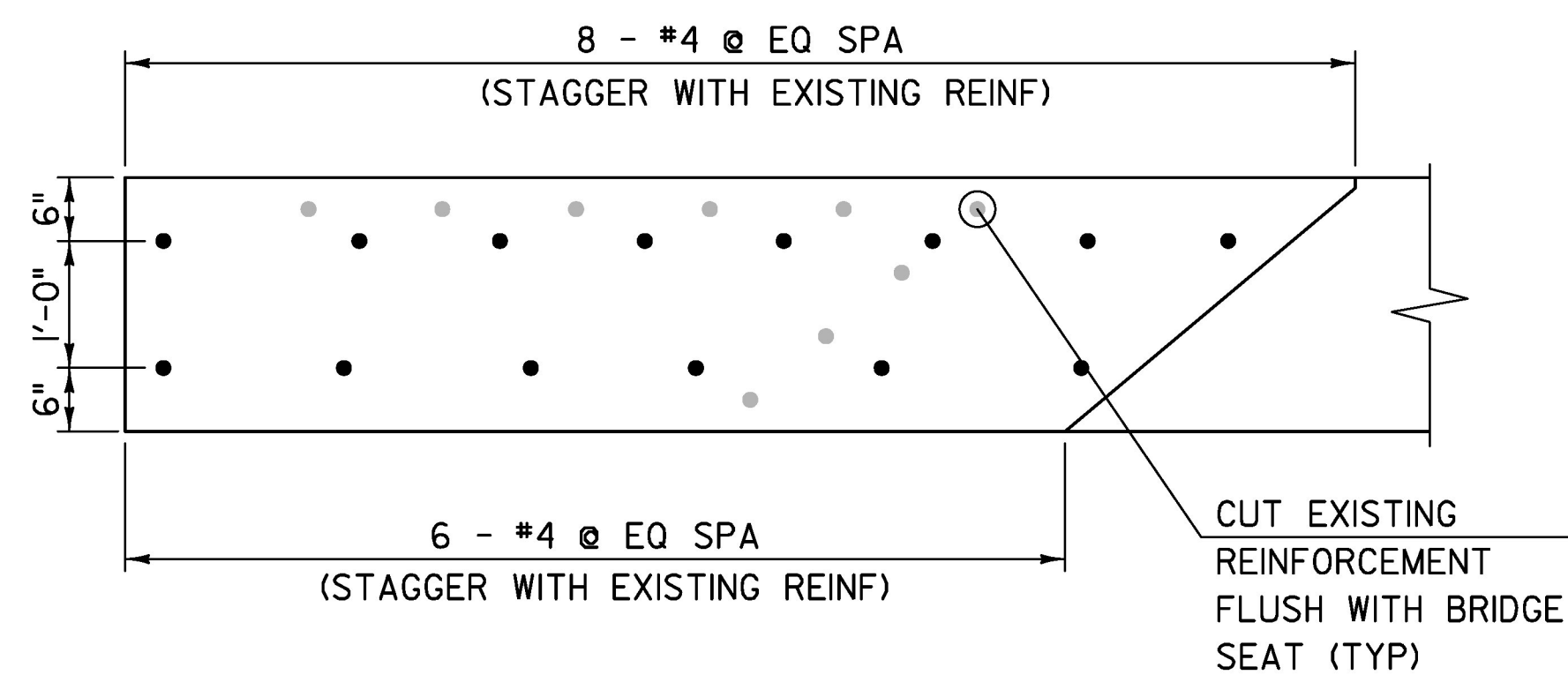

ALTERNATE WINGWALL 2 REINFORCEMENT DETAIL

(PROPOSED HORIZONTAL REINFORCEMENT NOT SHOWN FOR CLARITY)

SCALE: 3/4" = 1'-0"

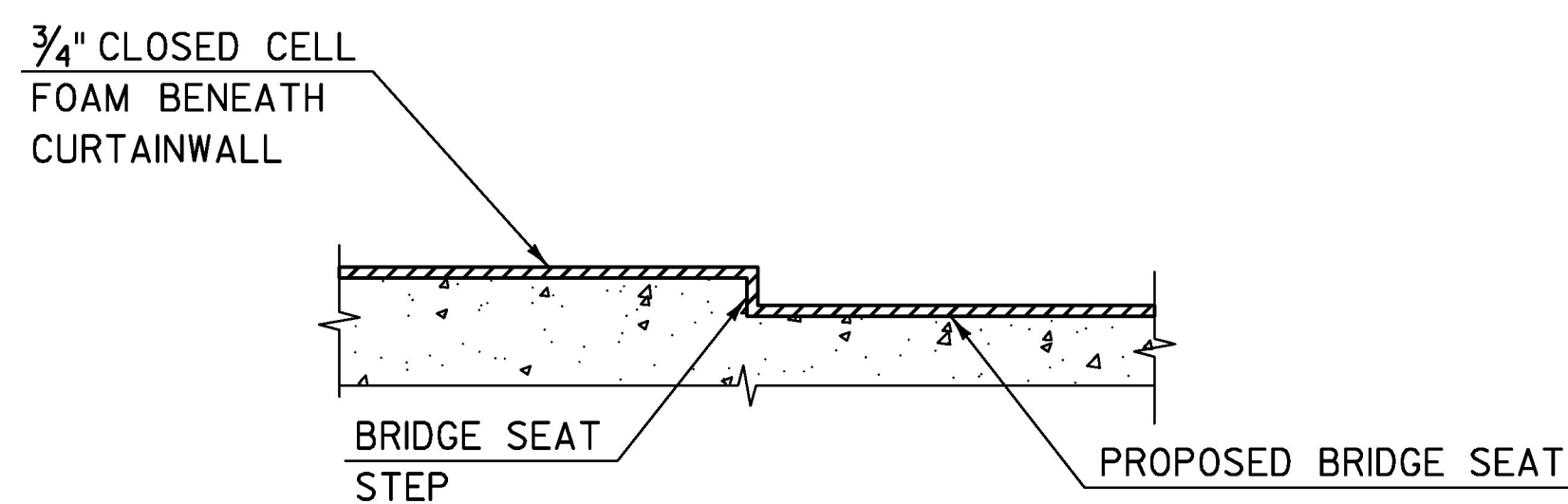

SECTION A-A

NTS

NOTES:

1. AT THE CONTRACTOR'S OPTION, EXISTING VERTICAL REINFORCEMENT IN THE PROPOSED WINGWALLS MAY BE CUT FLUSH WITH THE EXISTING BRIDGE SEAT AND NEW REINFORCEMENT DRILLED AND GROUTED IN ACCORDANCE WITH THESE PLANS AND SUBSECTION 507.06. DRILLED AND GROUTED DOWELS SHALL BE EMBEDDED IN THE EXISTING CONCRETE A MINIMUM OF 9 INCHES. PAYMENT WILL BE MADE UNDER ITEM 529.20, "PARTIAL REMOVAL OF STRUCTURE."
2. PROPOSED HORIZONTAL REINFORCEMENT WITHIN THE WINGWALL SHALL BE DETAILED BY THE CONTRACTOR IN ACCORDANCE WITH SUBSECTION 507.03. PAYMENT FOR DETAILING, FURNISHING, AND INSTALLING THE PROPOSED HORIZONTAL REINFORCEMENT WITHIN THE WINGWALL WILL BE MADE UNDER ITEM 507.11, "REINFORCING STEEL, LEVEL 1."
3. PAYMENT FOR SURFACE PREPARATION OF THE EXISTING BRIDGE SEAT WILL BE MADE UNDER ITEM 900.608, "SPECIAL PROVISION (HIGH PERFORMANCE CONCRETE, RAPID SET) (FPQ)."

PROJECT NAME: CHelsea
PROJECT NUMBER: BHF 0169(10)

FILE NAME: z12ci52abu1.dgn
PROJECT LEADER: J. OLUND
DESIGNED BY: B. TOOTHAKER
ABUTMENT I RECONSTRUCTION

PLOT DATE: 10/28/2016
DRAWN BY: J. HOWE
CHECKED BY: J. OLUND
SHEET 113 OF 137

REV	DATE	DESCRIPTION
△	10/31/2016	ELEVATION CORRECTION

TYLIN INTERNATIONAL