

**SUPERSTRUCTURE PLAN**  
 SCALE: 3/16" = 1'-0"

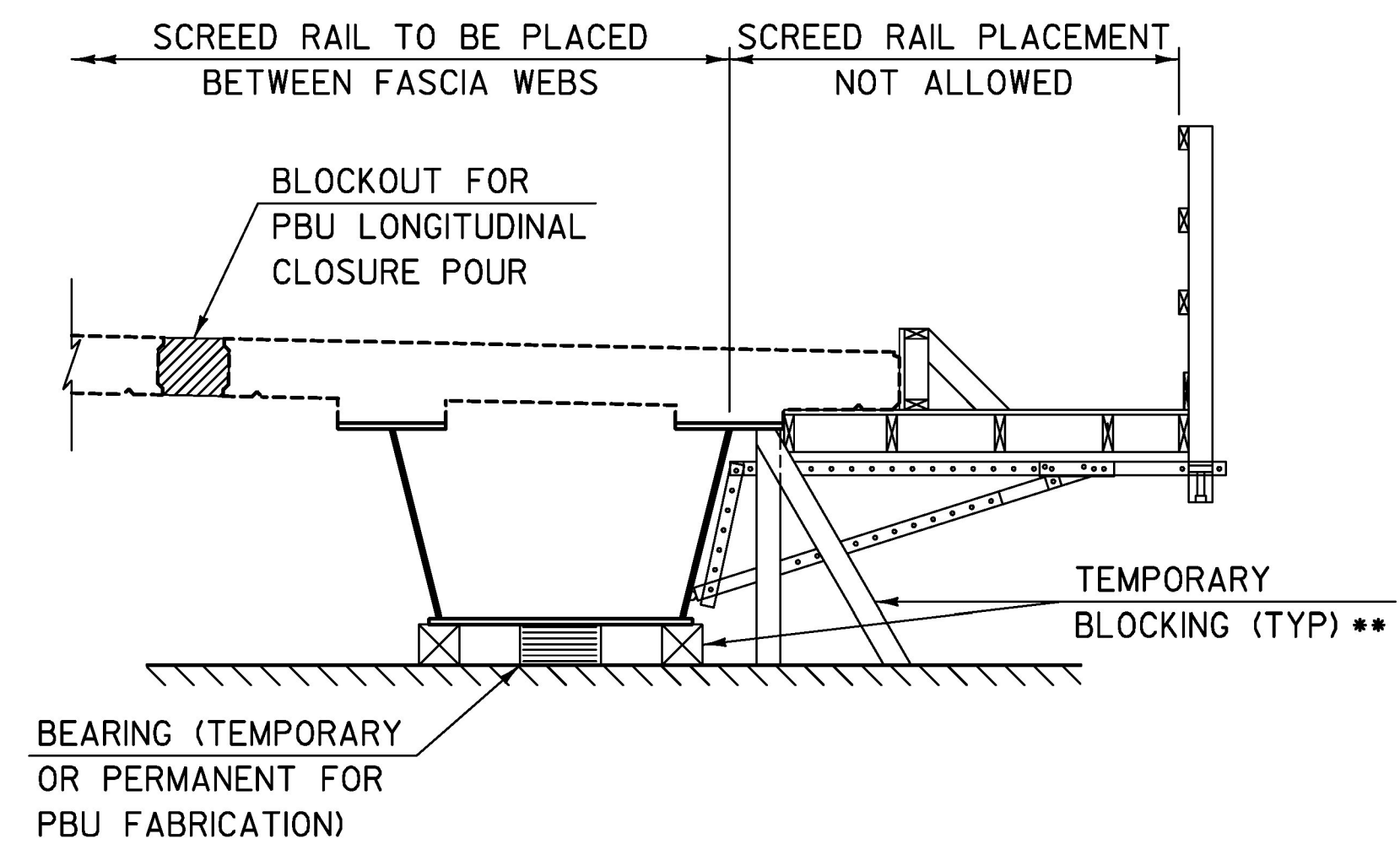

**TEMPORARY BLOCKING DETAIL**  
 SCALE: 1/2" = 1'-0"

\*\* TEMPORARY BLOCKING MAY BE NEEDED DURING DECK CASTING AND OTHER OPERATIONS TO PREVENT OVERTURNING OF THE GIRDERS CAUSED BY ECCENTRIC LOADING. THE CONTRACTOR SHALL INVESTIGATE AND INCORPORATE THE USE OF TEMPORARY BLOCKING DURING ALL OPERATIONS WITH ECCENTRIC LOADING, SUCH AS SCREED RAIL LOADING AND LIVE LOADING ON OVERHANG BRACKETS. TEMPORARY BLOCKING AND SUPPORTING CALCULATIONS SHOWING STABILITY OF THE GIRDERS SHALL BE SUBMITTED WITH THE PBU ERECTION PLAN.

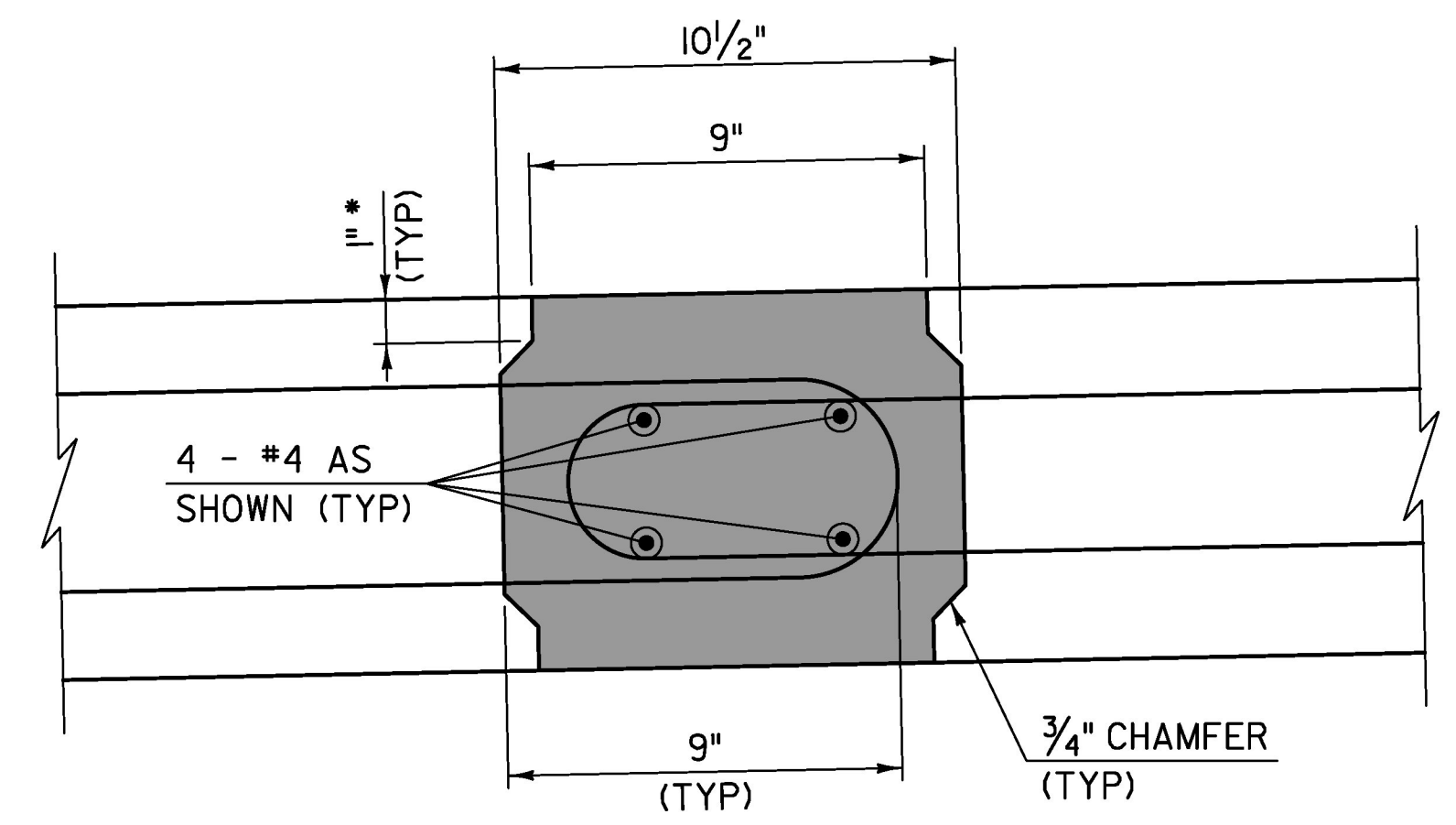

**CLOSURE POUR DETAIL SECTION**  
 SCALE: 3" = 1'-0"

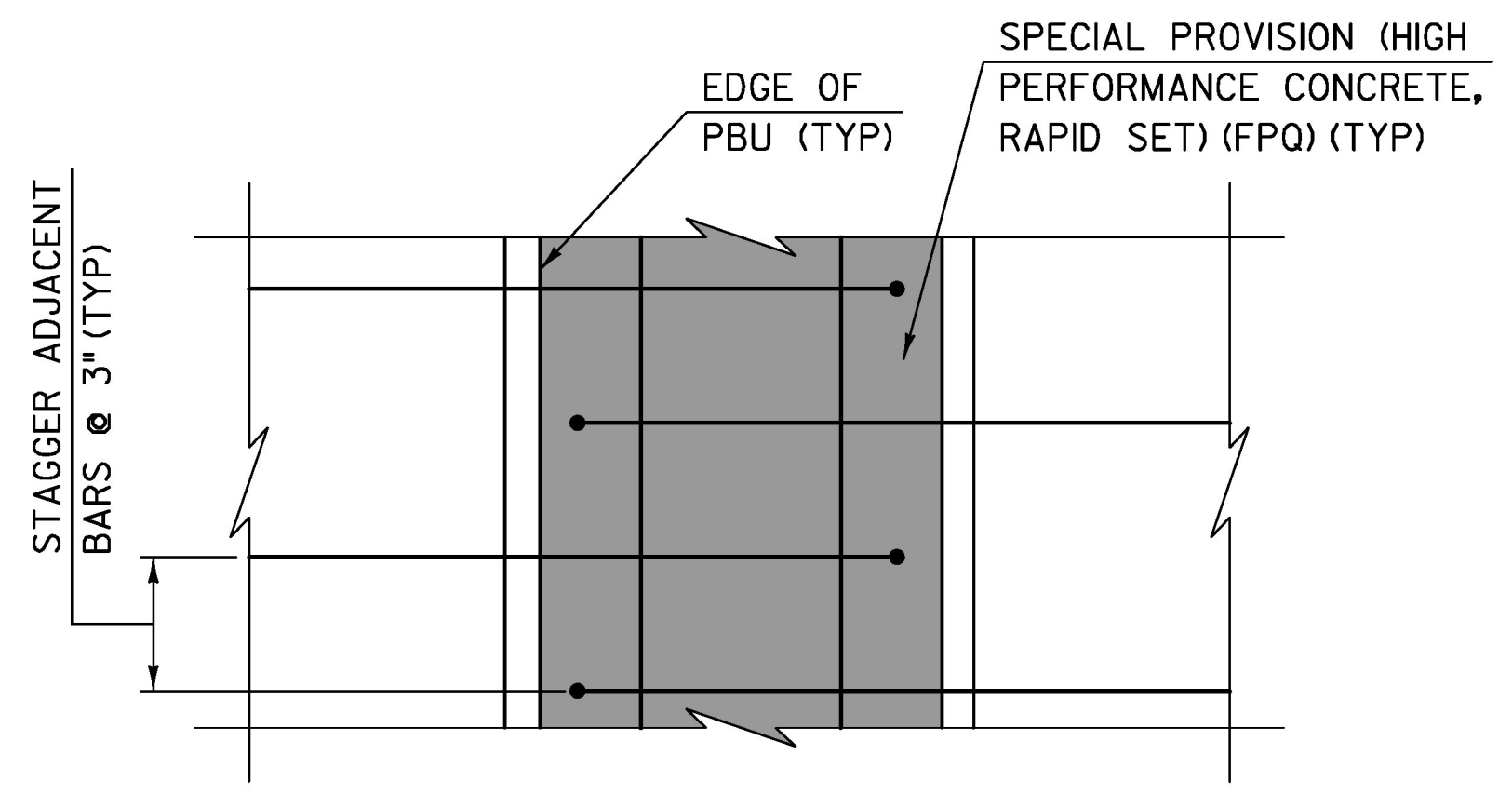

**CLOSURE POUR DETAIL PLAN**  
 SCALE: 3" = 1'-0"

\* NOTED DIMENSIONS AND/OR ELEVATIONS ARE BASED ON A FINAL DECK THICKNESS OF 8 1/2 INCHES. SEE PROJECT NOTES FOR ADDITIONAL INFORMATION.

<b>TYLIN</b> INTERNATIONAL	PROJECT NAME: CHelsea	PLOT DATE: 8/31/2016
	PROJECT NUMBER: BHF 0169(9)	DRAWN BY: S. MORGAN
	FILE NAME: z12ci50deck.dgn PROJECT LEADER: J. OLUND DESIGNED BY: T. POULIN SUPERSTRUCTURE PLAN	CHECKED BY: J. OLUND SHEET 39 OF 137