

1.9" Radius, 0.8" Border, 0.5" Indent, Black on Yellow;
 "UNSAFE" C; "TO PASS" C;

VW-092

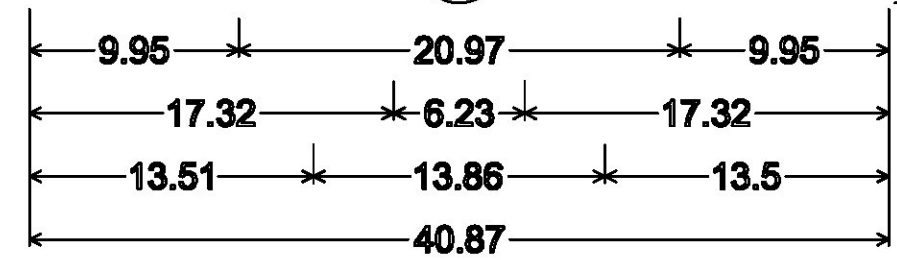

30.00" across sides 1.88" Radius, 0.75" Border,
 0.50" Indent, Black on Yellow;
 "UNSAFE" C; "TO" C; "PASS" C;

VW-619

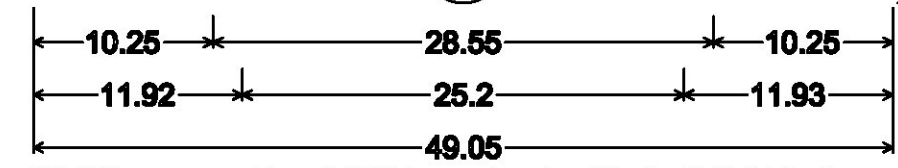
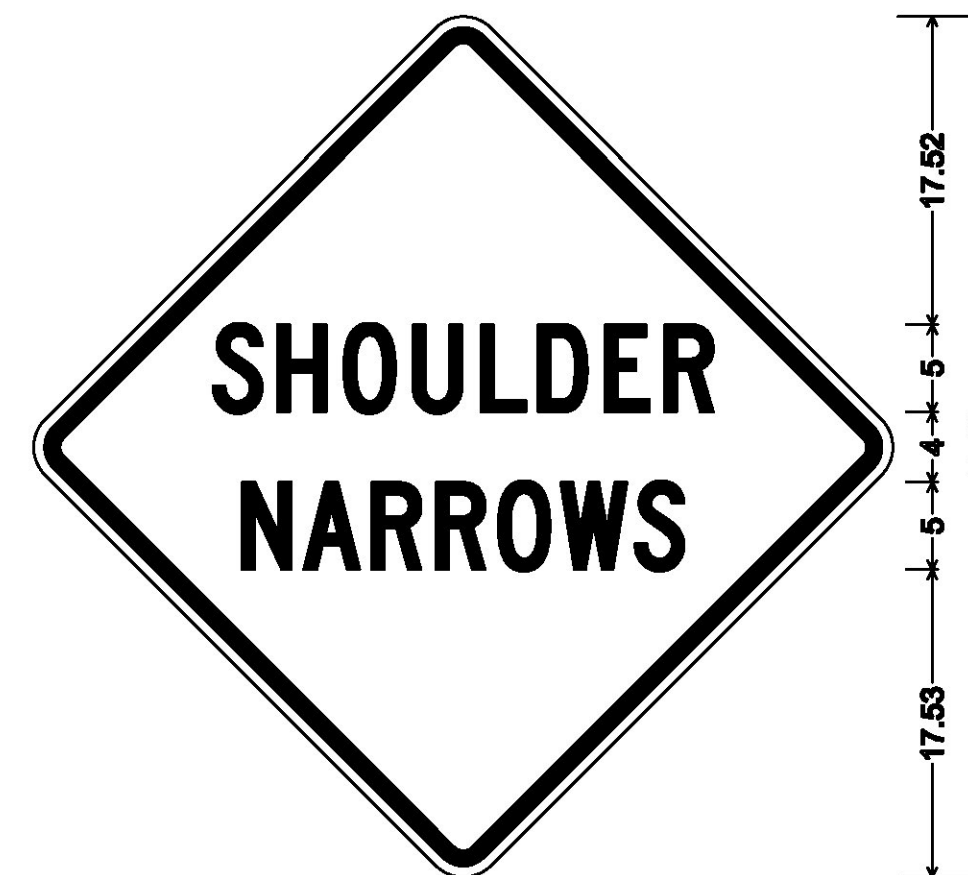

36.00" across sides 0.88" Inner border Black, 2.25" Radius,
 0.63" Outer border, Yellow on Yellow;
 "SHOULDER" Black C; "NARROWS" Black C;

VW-619

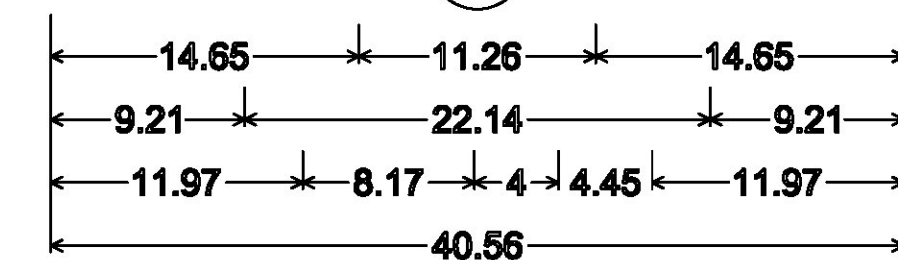
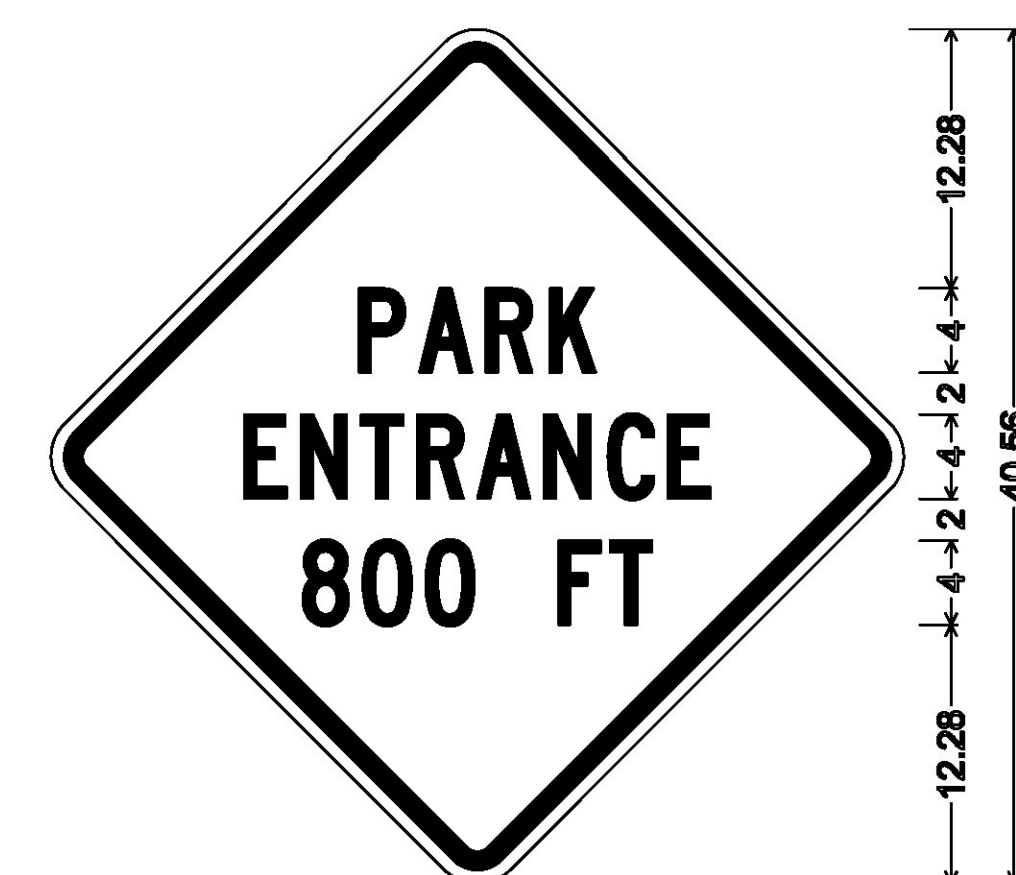

30.00" across sides 0.88" Inner border Black, 2.25" Radius,
 0.63" Outer border, Yellow on Yellow;
 "PARK" Black C; "ENTRANCE" Black C;
 "800 FT" Black C;

VW-730

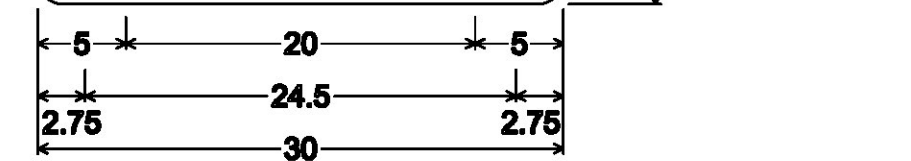

1.500" Radius, 0.625" Border, 0.375" Indent, Black on Yellow;
 "TRUCKS" B; "ENTERING" B;

VW-202P

ALL DIMENSIONS SHOWN IN INCHES, EXCEPT WHERE NOTED.
 NOT TO SCALE

PROJECT NAME: ALBURGH-COLCHESTER
 PROJECT NUMBER: STPG SIGN(45)

TYLIN INTERNATIONAL

FILE NAME: z12b530_SD02.dgn
 PROJECT LEADER: D. BRYANT
 DESIGNED BY: B. TOOTHAKER
 SIGN DETAILS B

PLOT DATE: 4/15/2014
 DRAWN BY: J. BLANCHARD
 CHECKED BY: K. KERN
 SHEET II OF 167