

CONSTRUCTION APPROACH SIGNING

NOT TO SCALE

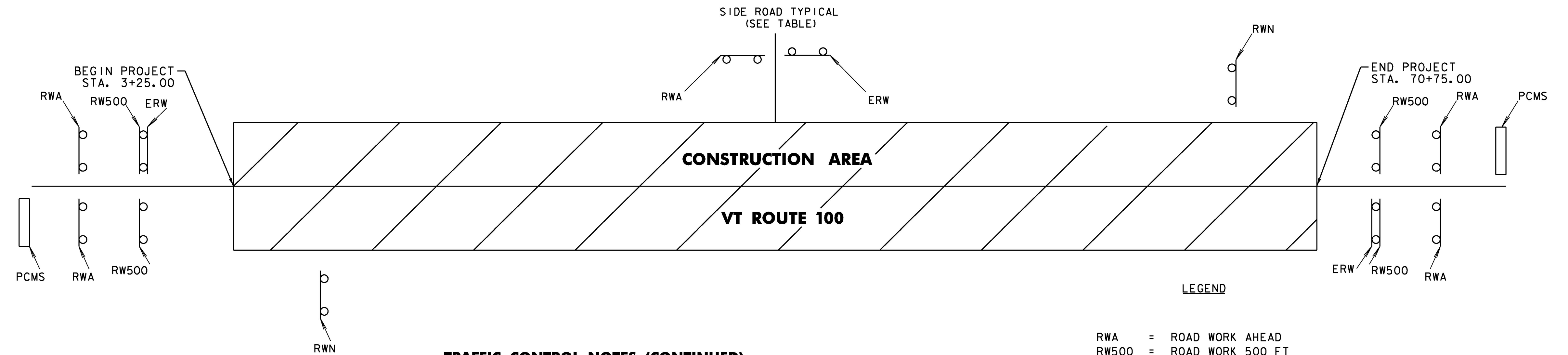

TRAFFIC CONTROL NOTES

- PER SECTION 105.03, THE CONTRACTOR SHALL SUBMIT A SITE SPECIFIC TRAFFIC CONTROL PLAN TO THE ENGINEER FOR APPROVAL PRIOR TO THE START OF CONSTRUCTION. CONSTRUCTION OPERATIONS SHALL NOT BEGIN UNTIL BEING APPROVED BY THE ENGINEER. THE COST OF PREPARING THIS PLAN (AND MAKING CHANGES IF NECESSARY) WILL NOT BE PAID SEPARATELY BUT WILL BE PAID UNDER ITEM 641.10, "TRAFFIC CONTROL". THE TRAFFIC CONTROL PLAN SHALL BE IN COMPLIANCE WITH VTRANS STANDARDS AND 2009 MUTCD. WHERE CONFLICTS EXIST, THE 2009 MUTCD SHALL GOVERN.
- THE CONTRACTOR SHALL INCLUDE A CONSTRUCTION SIGN APPROACH PACKAGE FOR EXPECTED LANE CLOSURES AND WORK ZONE SPEED REDUCTIONS IN COMPLIANCE WITH THE TRAFFIC CONTROL NOTES AND PART 6 OF THE 2009 MUTCD. PAYMENT FOR PROVIDING THIS PACKAGE WILL BE PAID UNDER ITEM 641.10, "TRAFFIC CONTROL".
- THE BID PRICE FOR "TRAFFIC CONTROL", ITEM 641.10, SHALL INCLUDE ALL OF THE FOLLOWING, AS NEEDED: APPROACH AND ON-PROJECT CONSTRUCTION SIGNING, PORTABLE ARROW BOARDS, BARRELS, CONES, BARRICADES, TEMPORARY REGULATORY AND WARNING SIGNS, AND POSTS AS DETAILED IN VTRANS STANDARDS. ALL ADJUSTING, RELOCATING, AND REMOVING OF THESE DEVICES AS DIRECTED BY THE ENGINEER SHALL ALSO BE INCLUDED. THE FOLLOWING ITEMS WILL BE PAID FOR SEPARATELY:
 646.602, 646.612 - TEMPORARY PAVEMENT MARKINGS
 630.10 - UNIFORMED TRAFFIC OFFICERS
 630.15 - FLAGGERS
 641.15 - PORTABLE CHANGEABLE MESSAGE SIGN
 900.640 - SPECIAL PROVISION (BARRIER FOR TEMPORARY TRAFFIC PROTECTION)
- THE MUTCD 2009 AND ITS LATEST REVISIONS SHALL BE THE STANDARD FOR ALL TRAFFIC CONTROL DEVICES. EXISTING SIGNS, SIGNALS AND MARKINGS SHALL BE VALID UNTIL SUCH TIME AS THEY ARE REPLACED OR RECONSTRUCTED. WHEN NEW TRAFFIC CONTROL DEVICES ARE ERECTED OR PLACED OR EXISTING TRAFFIC CONTROL DEVICES ARE REPLACED OR REPAIRED THE EQUIPMENT, DESIGN, METHOD OF INSTALLATION, PLACEMENT OR REPAIR SHALL CONFORM WITH SUCH STANDARDS.
- CONES SHALL BE USED TO CLEARLY DEFINE THE TRAVEL SPACE AND PROVIDE SEPARATION FROM THE WORK. DRUMS SHALL BE USED FOR DROP-OFF AREAS AND AREAS WHERE GUARDRAIL SHALL BE REMOVED.
- AS THE PAVING OPERATION MOVES, THE FLAGGER SIGNS SHALL BE MOVED ACCORDINGLY. AT NO TIME SHOULD THE FLAGGER SYMBOL SIGN BE MORE THAN 1000 FT FROM THE FLAGGER STATION. FLAGGER SIGNS SHALL BE COVERED OR TURNED AWAY IF FLAGGING OPERATIONS CEASE FOR MORE THAN 15 MINUTES.
- NO CONSTRUCTION SIGNS SHALL BE INSTALLED AS TO INTERFERE OR OBSTRUCT THE VIEW OF EXISTING TRAFFIC CONTROL DEVICES, STOPPING SIGHT DISTANCE, AND CORNER SIGHT DISTANCE FROM DRIVES AND TOWN HIGHWAYS.
- ALL PERMANENT SIGNS THAT CONFLICT WITH TEMPORARY TRAFFIC CONTROL SHALL BE COMPLETELY COVERED. PAYMENT WILL BE INCLUDED IN THE UNIT PRICE BID FOR ITEM 641.10 "TRAFFIC CONTROL".
- CONSTRUCTION SIGNS SHALL BE IN NEW OR LIKE NEW CONDITION PER VTRANS STANDARDS.
- DIAMOND SHAPED SIGNS SHALL BE 4'X4' WITH BLACK TEXT AND BORDER ON A RETROREFLECTIVE FLOURESCENT ORANGE BACKGROUND WITH A MINIMUM ASTM VII OR VIII RETROREFLECTIVE SHEETING.
- CONSTRUCTION ZONE SIGNS SHALL BE INSTALLED AS OUTLINED IN THE SPECIAL PROVISIONS.
- WHERE TEMPORARY SIGNS ARE PLACED BEHIND GUARDRAIL, THEY SHALL BE ADJUSTED SUCH THAT THE BOTTOM OF THE SIGNS ARE ABOVE THE TOP OF GUARDRAIL.

TRAFFIC CONTROL NOTES (CONTINUED)

- THE CONTRACTOR SHALL PROVIDE ACCESS THROUGH THE WORK ZONE FOR EMERGENCY VEHICLES AT ALL TIMES.
- A MINIMUM LANE WIDTH OF 10 FT. SHALL BE MAINTAINED, INCLUDING SHOULDERS.
- WHEN COLD PLANED BITUMINOUS PAVEMENT IS OPEN TO TRAFFIC, A "MOTORCYCLES USE CAUTION" SIGN, AS PER VTRANS STANDARD T-28, SHALL BE PROVIDED.
- THE CONTRACTOR SHALL LEAVE NO LONGITUDINAL DROP-OFFS DURING THE OVERNIGHT HOURS. THEREFORE, THE FULL ROADWAY WIDTH SHALL BE COLD PLANED OR PAVED DURING THE DAILY WORK PERIOD. WHEN NECESSARY, DROP-OFF PROTECTION IN THESE AREAS SHALL CONFORM TO VTRANS STANDARD T-35.
- MAINTAIN ACCESS TO ALL PROPERTIES AT ALL TIMES FOR EMERGENCY VEHICLES. MAINTAIN ACCESS TO ALL COMMERCIAL AND MUNICIPAL PROPERTIES DURING BUSINESS HOURS. ACCESS TO RESIDENTIAL PROPERTIES MAY BE RESTRICTED FOR A SHORT DURATION (A FEW HOURS). ANY RESTRICTIONS SHALL BE COORDINATED WITH THE PROPERTY OWNER. COORDINATE MAJOR WORK ON COMMERCIAL OR MUNICIPAL ACCESSES WITH THE OWNER AT LEAST ONE WEEK PRIOR TO STARTING THE WORK. ALL ACCESSES SHALL ALSO BE KEPT FREE OF WORK. TRAFFIC SHALL BE CONTROLLED BY UNIFORMED TRAFFIC OFFICERS OR FLAGGERS AS REQUIRED BY THE ENGINEER.
- TRAFFIC SHALL NOT BE CHANGED FROM ONE TRAFFIC PATTERN TO THE NEXT TRAFFIC PATTERN UNTIL ALL TEMPORARY MARKINGS AND SIGNING ARE COMPLETED. ANY CONFLICTING MARKINGS SHALL BE REMOVED.

- LEGEND**
- RWA = ROAD WORK AHEAD
 - RW500 = ROAD WORK 500 FT
 - ERW = END ROAD WORK
 - RWN = ROAD WORK NEXT 1 MILE
 - PCMS = PORTABLE CHANGEABLE MESSAGE SIGN

	ROAD WORK AHEAD	END ROAD WORK	ROAD WORK 500 FT	ROAD WORK NEXT 1 MILE	PCMS
GRANVILLE					
BEGIN PROJECT (VT 100)	2	1	2	1	1
END PROJECT (VT 100)	2	1	2	1	1
TOTALS	4	2	4	2	2

DETAILS ARE NOT TO SCALE

GRANVILLE	
PROJECT NUMBER: ER STP 013-4 (40)	
FILE NAME: z12b520.dgn	PLOT DATE: 7/8/2015
PROJECT LEADER: J. TUCKER	DRAWN BY: B. BRESLEND
DESIGNED BY: B. BRESLEND	CHECKED BY: A. SANZ
CONSTRUCTION APPROACH SIGNING SHEET SHEET 127 OF 141	