

SOIL INFORMATION:
LYMAN-BERKSHIRE VERY ROCKY COMPLEX
K-FACTOR = 0.27/0.31, 20%-50% SLOPES
ERODIBILITY: LOW TO MODERATE
HYDROLOGICAL SOIL GROUP:D/B

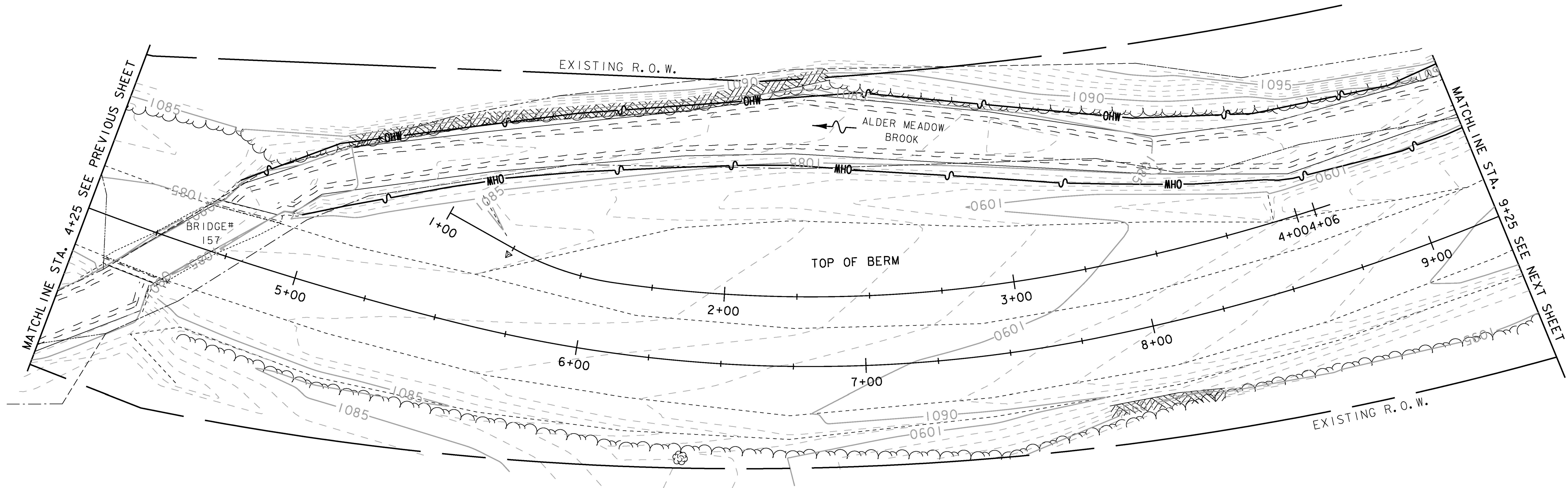

SOIL INFORMATION:
LYMAN-BERKSHIRE VERY ROCKY COMPLEX
K-FACTOR = 0.27/0.31, 20%-50% SLOPES
ERODIBILITY: LOW TO MODERATE
HYDROLOGICAL SOIL GROUP:D/B



PROJECT NAME:	GRANVILLE
PROJECT NUMBER:	ER STP 013-4 (40)
FILE NAME:	z12b520EPSC_bdr.dgn
DESIGNED BY:	B. BRESLEND
EPSC EXISTING CONDITIONS SHEET 2	
PLOT DATE:	7/8/2015
DRAWN BY:	B. BRESLEND
CHECKED BY:	J. TUCKER
	SHEET 41 OF 141