

18 STA. 66+70.70 LT 17.8' TO
 STA. 66+67.00 RT 32.1'
 REPLACE EXISTING 18" CMP
 WITH NEW 24" CPEP (SL)
 LENGTH = 50'-0"
 CONSTRUCT NEW HEADWALL PER STD. D-33
 PROPOSED INV. IN = 1255.00'
 PROPOSED INV. OUT = 1253.50'

19 RETAIN EXISTING 18" RCP
 CLEAN AND FLUSH CULVERT

TEMPORARY 4 INCH WHITE LINE, PAINT
 STA. 65+25.00 - STA. 71+00.00 (SOLID LT & RT)

TEMPORARY 4 INCH YELLOW LINE, PAINT
 STA. 65+25.00 - STA. 71+00.00 (SOLID LT & RT)

DURABLE 4 INCH WHITE LINE (SEE OPTION ITEMS)
 STA. 65+25.00 - STA. 71+00.00 (SOLID LT & RT)

DURABLE 4 INCH YELLOW LINE (SEE OPTION ITEMS)
 STA. 65+25.00 - STA. 71+00.00 (SOLID LT & RT)

REMOVAL AND DISPOSAL OF GUARDRAIL
 STA. 65+25.00 - STA. 71+00.00 RT

STEEL BEAM GUARDRAIL, GALVANIZED
 STA. 66+25.00 - STA. 71+00.00 RT

STEEL BEAM GUARDRAIL, GALVANIZED W/8 FEET POSTS
 STA. 65+25.00 - STA. 66+25.00 RT

REMOVING SIGNS
 AS SHOWN - I

STONE FILL, TYPE I
 STA. 66+65.00 - STA. 66+77.00 LT

END APPROACH
 STA. 71+00.00 (MM. 6.066)
 MATCH EXISTING

END PROJECT
 STA. 70+75.00 (MM. 6.061)

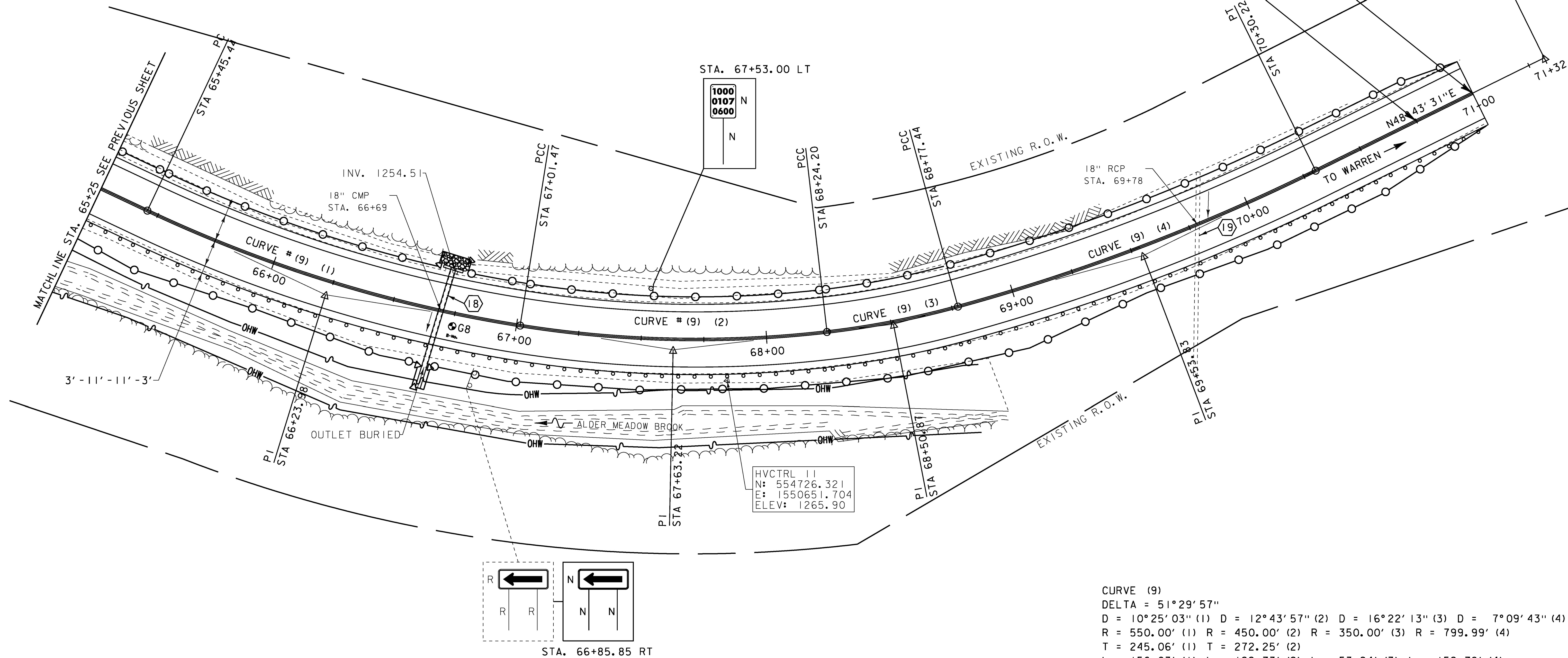
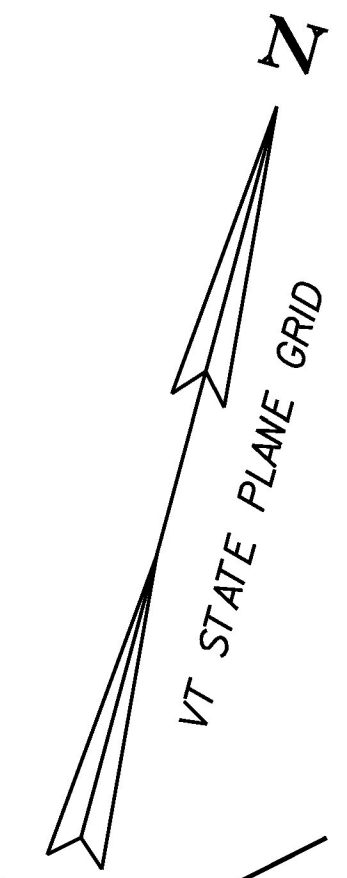

1000
 0107
 0600
 N

HVCTRL 11
 N: 554726.321
 E: 1550651.704
 ELEV: 1265.90

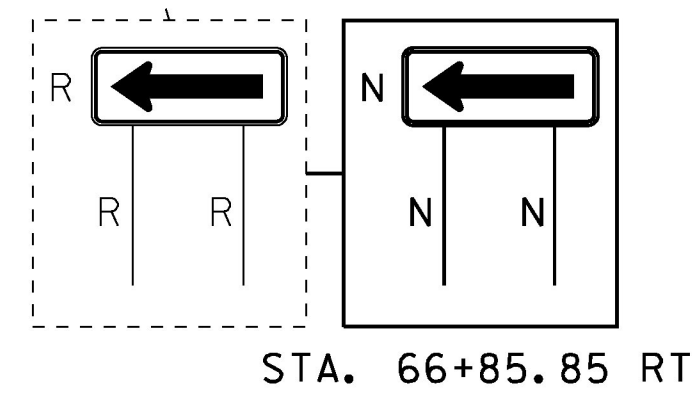

CURVE (9)
 DELTA = 51°29'57"
 D = 10°25'03" (1) D = 12°43'57" (2) D = 16°22'13" (3) D = 7°09'43" (4)
 R = 550.00' (1) R = 450.00' (2) R = 350.00' (3) R = 799.99' (4)
 T = 245.06' (1) T = 272.25' (2)
 L = 156.03' (1) L = 122.73' (2) L = 53.24' (3) L = 152.78' (4)
 E = 52.13'

SIGN LEGEND
 R = REMOVE
 R&S = REMOVE AND SALVAGE
 RET = RETAIN
 S = SALVAGED
 N = NEW
 B-B = BACK TO BACK
 --- = EXISTING
 — = NEW

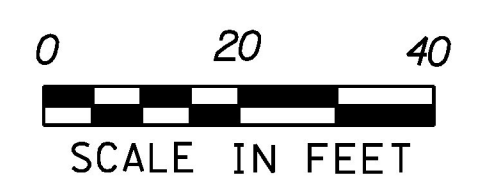

PROJECT NAME: GRANVILLE
 PROJECT NUMBER: ER STP 013-4 (40)

z12b520bdr.dgn
 PROJECT LEADER: J. TUCKER
 DESIGNED BY: B. BRESLEND
 PROJECT LAYOUT SHEET 13

PLOT DATE: 7/8/2015
 DRAWN BY: B. BRESLEND
 CHECKED BY: J. TUCKER
 SHEET 37 OF 141