

9 STA. 37+93.81 LT 24.6' TO STA. 38+18.27 RT 19.1' REPLACE EXISTING 18" CMP WITH NEW 24" CPEP (SL) LENGTH = 50'-0" CONSTRUCT NEW HEADWALL PER STD. D-33 PROPOSED INV. IN = 1159.11' PROPOSED INV. OUT = 1158.73'

10 STA. 39+99.59 RT 21.5' REMOVE EXISTING DI STA. 39+99.59 RT 21.5' INSTALL 4'X6' PRECAST DROP INLET WITH TWO CAST IRON GRATES (TYPE E) RIM = 1167.90' REPLACE EXISTING 18" CMP WITH NEW 24" CPEP (SL) FROM NEW DI TO STA. 39+98.78 LT 24.5' LENGTH = 44'-0" PROPOSED INV. @ DI = 1164.40' PROPOSED INV. OUT = 1163.57'

11 STA. 41+07.60 RT 18.92' REMOVE EXISTING DI STA. 41+07.60 RT 18.92' INSTALL 4'X6' PRECAST DROP INLET WITH TWO CAST IRON GRATES (TYPE E) RIM = 1174.00' REPLACE EXISTING 18" CMP WITH NEW 24" CPEP (SL) FROM NEW DI TO STA. 40+79.37 LT 24.34' LENGTH = 50'-0" PROPOSED INV. @ DI = 1170.50' PROPOSED INV. OUT = 1168.00'

12 STA. 42+31.86 RT 18.84' REMOVE EXISTING DI STA. 42+31.86 RT 18.84' INSTALL 4'X6' PRECAST DROP INLET WITH TWO CAST IRON GRATES (TYPE E) RIM = 1179.00' REPLACE EXISTING 18" CMP WITH NEW 24" CPEP (SL) FROM NEW DI TO STA. 42+16.30 LT 24.32' LENGTH = 44'-0" PROPOSED INV. @ DI = 1175.50' PROPOSED INV. OUT = 1173.30'

TEMPORARY 4 INCH WHITE LINE, PAINT STA. 37+25.00 - STA. 42+75.00 (SOLID LT & RT)

TEMPORARY 4 INCH YELLOW LINE, PAINT STA. 37+25.00 - STA. 42+75.00 (SOLID LT & RT)

DURABLE 4 INCH WHITE LINE (SEE OPTION ITEMS) STA. 37+25.00 - STA. 42+75.00 (SOLID LT & RT)

DURABLE 4 INCH YELLOW LINE (SEE OPTION ITEMS) STA. 37+25.00 - STA. 42+75.00 (SOLID LT & RT)

STONE FILL, TYPE I
 STA. 38+13.00 - STA. 38+26.00 RT
 STA. 39+94.00 - STA. 40+05.00 RT
 STA. 41+02.00 - STA. 41+14.00 RT
 STA. 42+26.00 - STA. 42+38.80 RT

REMOVAL AND DISPOSAL OF GUARDRAIL
 STA. 37+25.00 - STA. 37+38.00 LT
 STA. 37+25.00 - STA. 37+57.00 RT
 STA. 40+91.00 - STA. 42+75.00 LT

STEEL BEAM GUARDRAIL, GALVANIZED
 STA. 37+25.00 - STA. 42+62.25 LT
 MANUFACTURED TERMINAL SECTION, FLARED
 STA. 37+25.00 - STA. 37+56.50 RT
 STA. 42+62.25 - STA. 42+75.00 LT

REMOVING SIGNS
 AS SHOWN - 2

STONE FILL, TYPE II
 STA. 37+25.00 - STA. 42+75.00 LT

RIPRAP, HEAVY TYPE
 STA. 37+25.00 - STA. 42+75.00 LT

GRUBBING MATERIAL (12")
 STA. 37+25.00 - STA. 42+75.00 LT

GEOTEXTILE UNDER STONE FILL
 STA. 39+93.59 - STA. 40+05.48 RT
 STA. 41+01.50 - STA. 41+13.73 RT
 STA. 42+25.84 - STA. 42+37.84 RT

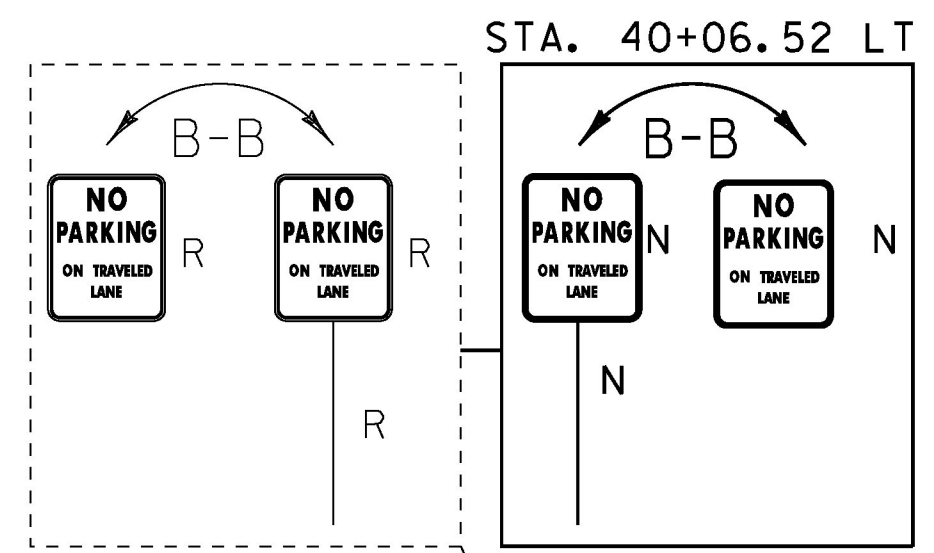
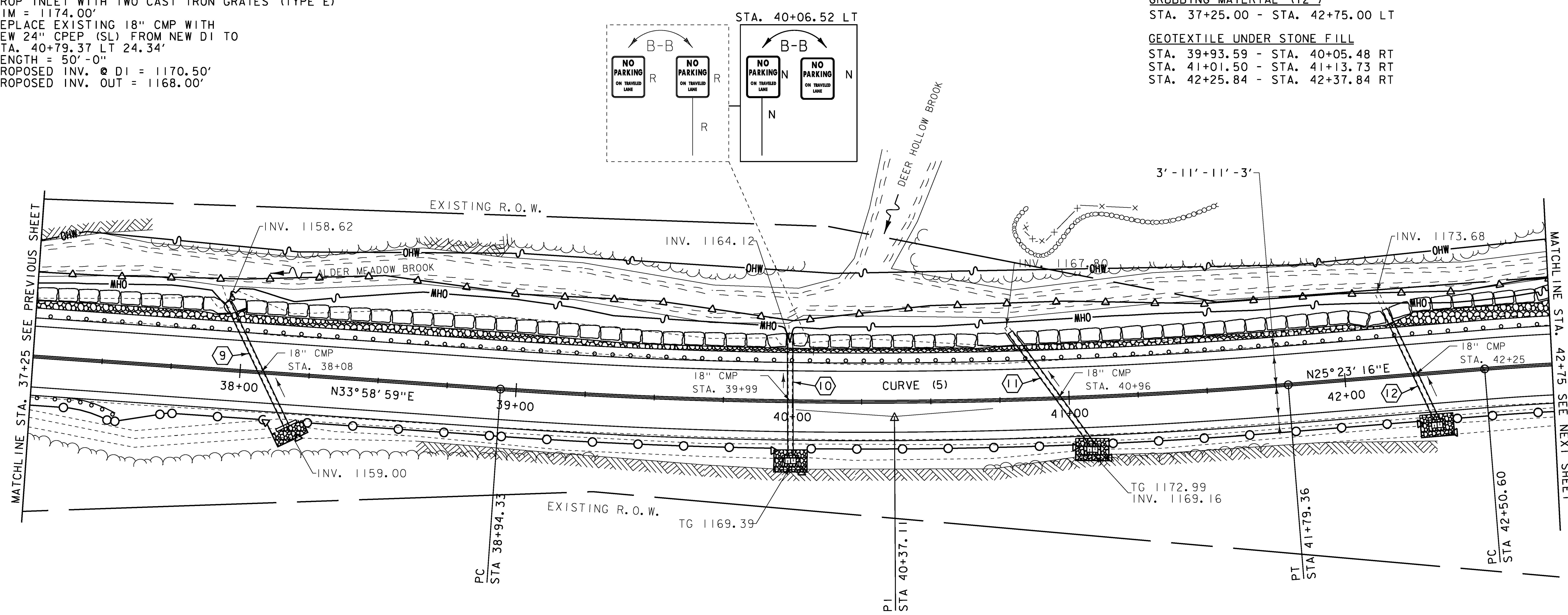
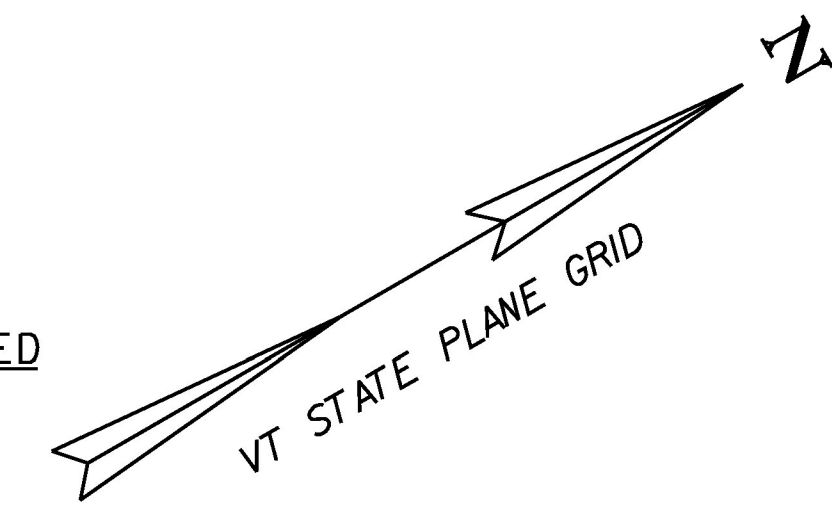

SIGN LEGEND
 R = REMOVE
 R&S = REMOVE AND SALVAGE
 RET = RETAIN
 S = SALVAGED
 N = NEW
 B-B = BACK TO BACK
 --- = EXISTING
 — = NEW

CURVE (5)
 DELTA = 8° 35' 43"
 D = 3° 00' 56"
 R = 1900.00'
 T = 142.79'
 L = 285.03'
 E = 5.36'

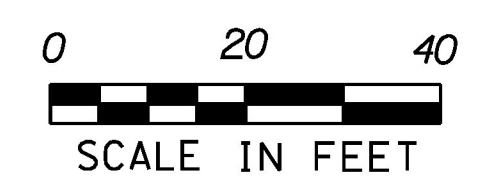

PROJECT NAME: GRANVILLE
 PROJECT NUMBER: ER STP 013-4 (40)
 z12b520bdr.dgn
 PROJECT LEADER: J. TUCKER
 DESIGNED BY: B. BRESLEND
 PROJECT LAYOUT SHEET 8
 PLOT DATE: 7/8/2015
 DRAWN BY: B. BRESLEND
 CHECKED BY: J. TUCKER
 SHEET 32 OF 141