

5 STA. 23+61.48 LT 17.96' TO  
 STA. 23+69.48 LT 17.96'  
 REMOVE EXISTING HEADWALL  
 CONSTRUCT NEW HEADWALL  
 PER STD. D-33 FOR EXISTING 24" RCP  
 CLEAN AND FLUSH EXISTING PIPE

6 STA. 25+68.18 LT 20.0' TO  
 STA. 25+69.47 RT 25.0'  
 REMOVE EXISTING HEADWALL  
 REPLACE EXISTING 24" CMP  
 WITH NEW 24" CPEP (SL)  
 LENGTH = 45'-0"  
 CONSTRUCT NEW HEADWALL PER STD. D-33  
 PROPOSED INV. IN = 1130.41'  
 PROPOSED INV. OUT = 1127.38'

TEMPORARY 4 INCH WHITE LINE, PAINT  
 STA. 20+25.00 - STA. 26+00.00 (SOLID LT & RT)  
 TEMPORARY 4 INCH YELLOW LINE, PAINT  
 STA. 20+25.00 - STA. 26+00.00 (SOLID LT & RT)  
 DURABLE 4 INCH WHITE LINE (SEE OPTION ITEMS)  
 STA. 20+25.00 - STA. 26+00.00 (SOLID LT & RT)  
 DURABLE 4 INCH YELLOW LINE (SEE OPTION ITEMS)  
 STA. 20+25.00 - STA. 26+00.00 (SOLID LT & RT)

STEEL BEAM GUARDRAIL, GALVANIZED  
 STA. 20+25.00 - STA. 26+00.00 RT  
 STONE FILL, TYPE I  
 STA. 23+59.00 - STA. 23+71.00 LT  
 STA. 25+62.00 - STA. 25+74.00 LT  
 STONE FILL, TYPE II  
 STA. 20+25.00 - STA. 26+00.00 RT  
 RIPRAP, HEAVY TYPE  
 STA. 20+25.00 - STA. 26+00.00 RT  
 GRUBBING MATERIAL (12")  
 STA. 20+25.00 - STA. 26+00.00 RT

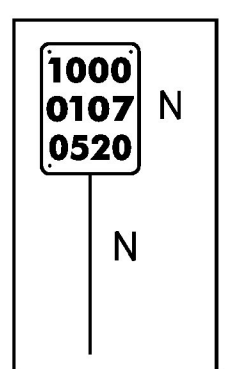
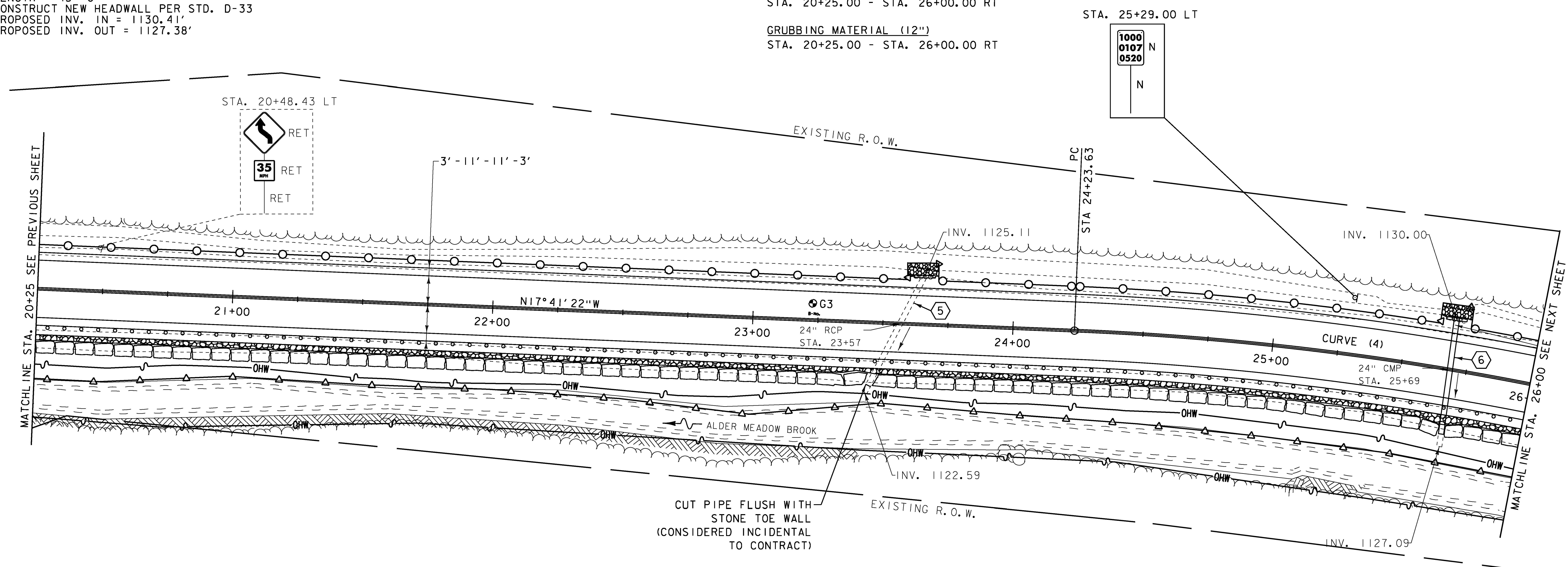
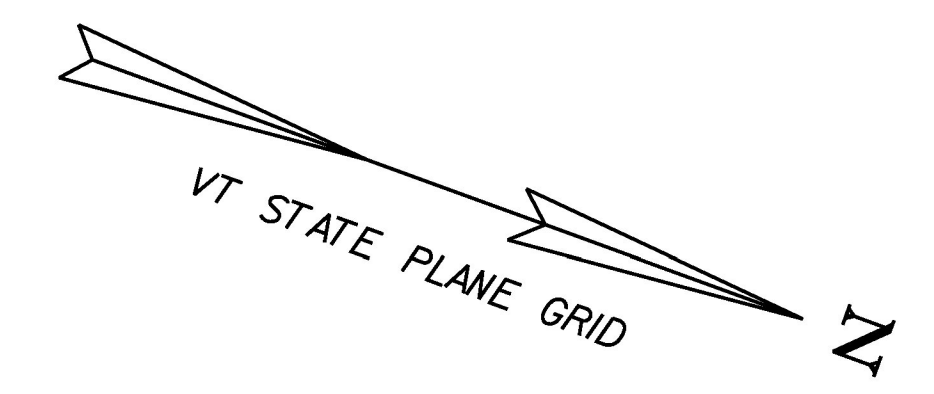

**SIGN LEGEND**  
 R = REMOVE  
 R&S = REMOVE AND SALVAGE  
 RET = RETAIN  
 S = SALVAGED  
 N = NEW  
 B-B = BACK TO BACK  
 --- = EXISTING  
 — = NEW

CUT PIPE FLUSH WITH  
 STONE TOE WALL  
 (CONSIDERED INCIDENTAL  
 TO CONTRACT)

CURVE (4)  
 DELTA = 51°40'21"  
 D = 4°57'38"  
 R = 1155.00'  
 T = 559.25'  
 L = 1041.64'  
 E = 128.27'

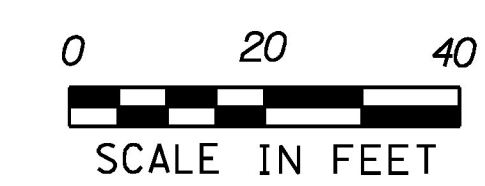

PROJECT NAME: GRANVILLE  
 PROJECT NUMBER: ER STP 013-4 (40)  
 z12b520bdr.dgn  
 PROJECT LEADER: J. TUCKER  
 DESIGNED BY: B. BRESLEND  
 PROJECT LAYOUT SHEET 5  
 PLOT DATE: 7/8/2015  
 DRAWN BY: B. BRESLEND  
 CHECKED BY: J. TUCKER  
 SHEET 29 OF 141