

**TYPICAL SHOULDER WIDENING SLOPE SECTION**

STA. 45+74.00 TO STA. 47+46.00 LT  
STA. 47+70.00 TO STA. 70+75.00 RT

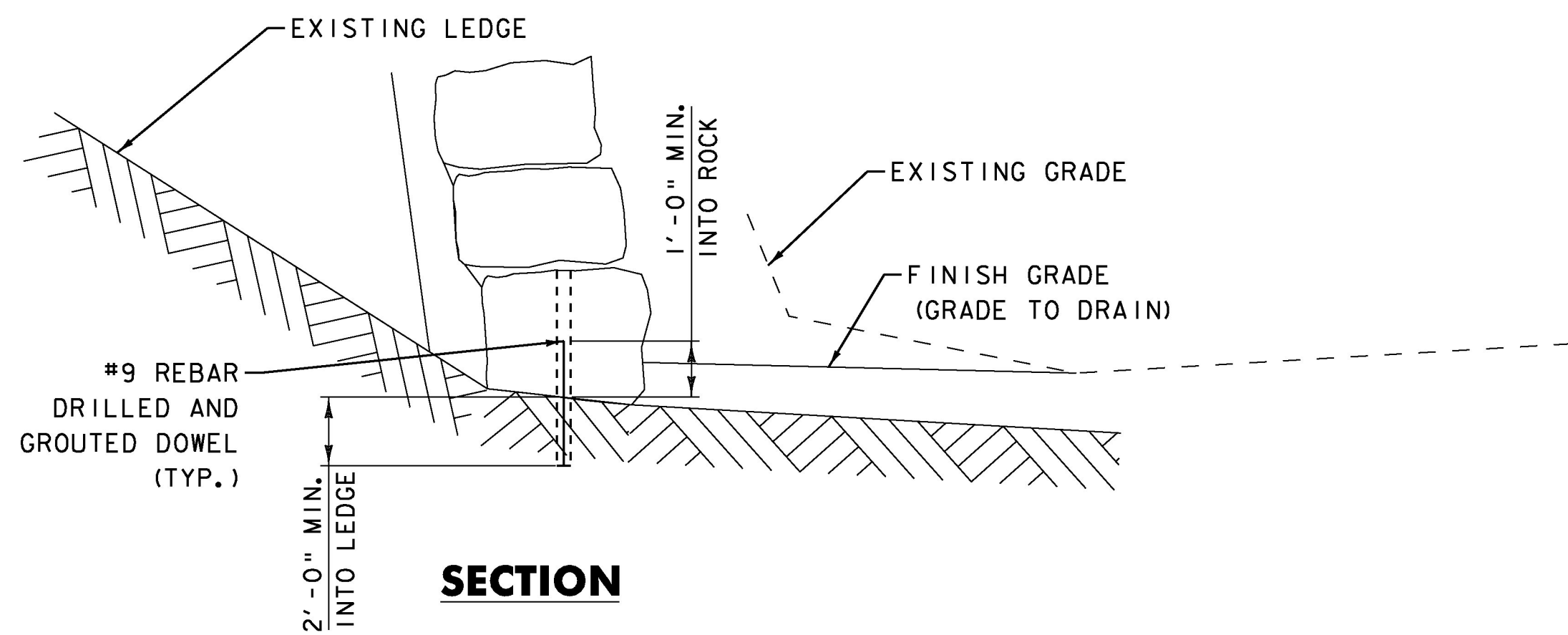

**STONE TOE WALL DETAIL**

NO AREAS IDENTIFIED

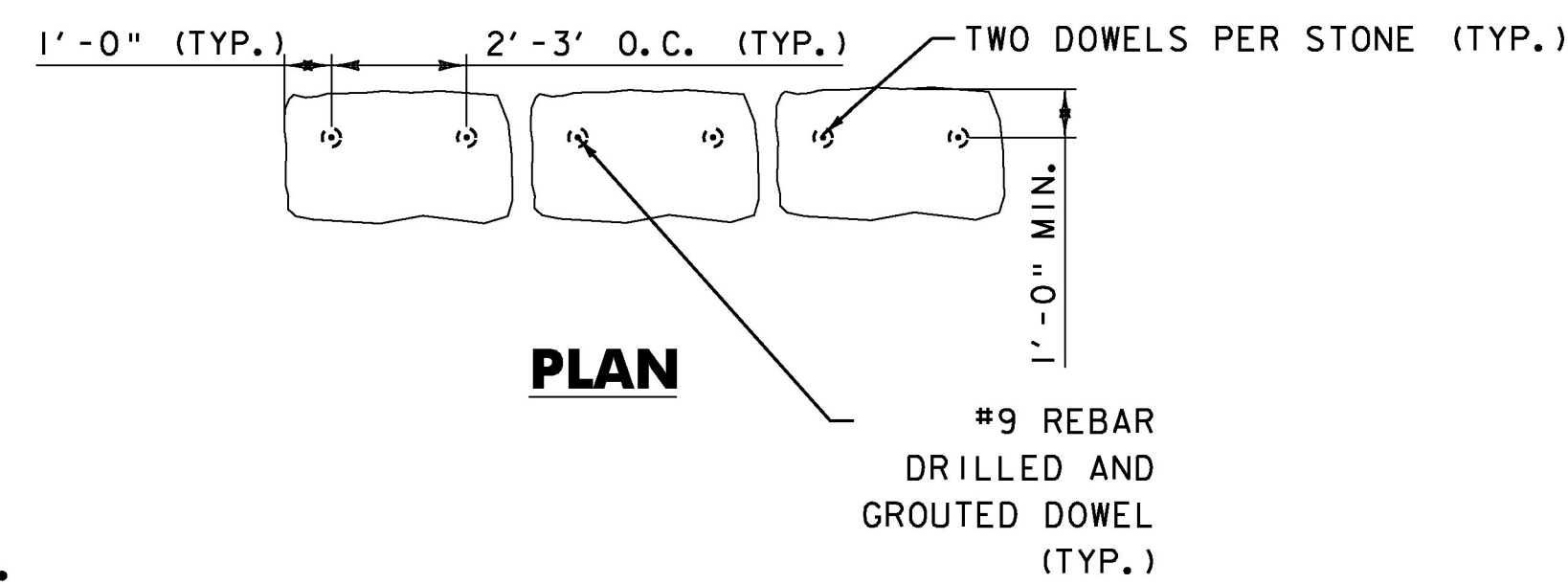

**NOTES:**

1. THE DRILLED AND GROUTED BAR TO BE USED WHERE LEDGE IS ENCOUNTERED LESS THAN 4'-0" BELOW THE EXISTING GRADE AND THE LEDGE CAN NOT BE REMOVED BY MECHANICAL MEANS, AS DETERMINED BY THE ENGINEER.
2. QUANTITIES HAVE BEEN ESTIMATED FOR ITEMS 507.11 "REINFORCING STEEL, LEVEL 1" AND ITEM 507.16 "DRILLING AND GROUTING DOWELS" AND ARE TO BE USED AT THE DISCRETION OF THE ENGINEER.
3. LOCATIONS OF DOWELS ARE FOR GUIDANCE ONLY. FINAL LOCATION OF DOWELS TO BE DETERMINED BY THE ENGINEER.
4. A NON SHRINK EPOXY SHALL BE USED IN THE PLACING OF DOWELS AND APPROVED BY THE ENGINEER. PAYMENT WILL BE INCLUDED IN THE UNIT PRICE BID FOR CONTRACT ITEM 507.16.

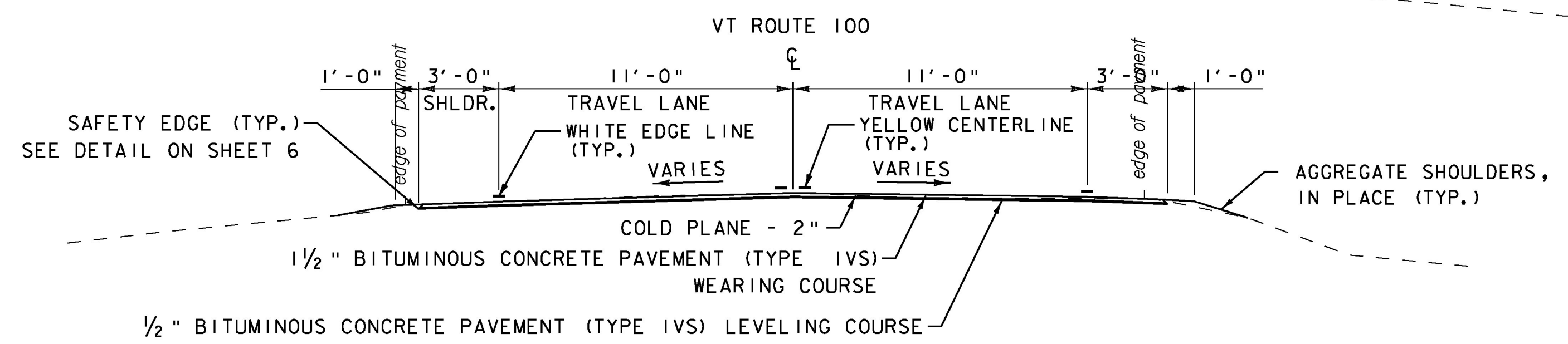

**TYPICAL COLD PLANE, LEVEL AND OVERLAY SECTION**

STA. 3+25.00 - STA. 4+49.00  
STA. 4+72.00 - STA. 8+71.00  
STA. 42+85.00 - STA. 45+74.00

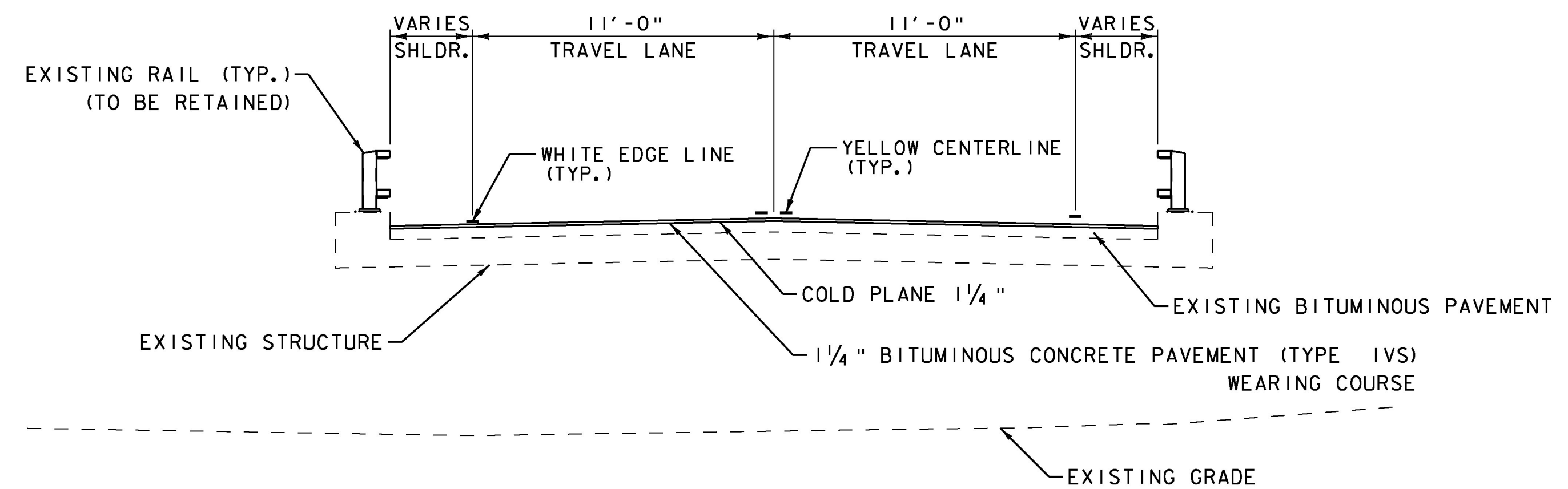

**TYPICAL COLD PLANE, LEVEL AND OVERLAY BRIDGE SECTION**

STA. 4+49.00 - STA. 4+72.00 (BRIDGE 157)  
STA. 15+20.00 - STA. 15+36.00 (BRIDGE 158)  
STA. 36+41.00 - STA. 36+64.00 (BRIDGE 159)  
STA. 47+46.00 - STA. 47+70.00 (BRIDGE 160)

**DETAILS ARE NOT TO SCALE**

PROJECT NAME: GRANVILLE	
PROJECT NUMBER: ER STP 013-4 (40)	
FILE NAME: z12b520.dgn	PLOT DATE: 7/8/2015
PROJECT LEADER: J. TUCKER	DRAWN BY: B. BRESLEND
DESIGNED BY: B. BRESLEND	CHECKED BY: E. ANDREWS
TYPICAL SECTION SHEET 2	SHEET 5 OF 141