

4 INCH WHITE LINE  
 10+37.5 LT - 14+47.5 RT, 410 FT (EDGE LINE)  
 10+37.5 RT - 14+47.5 RT, 410 FT (EDGE LINE)

4 INCH YELLOW LINE  
 10+37.5 - 14+47.5, 820 FT (DOUBLE CENTER LINE)

REMOVING SIGNS

12+28.8 LT  
 12+36.9 RT

ERECTING SALVAGED SIGNS

12+28.8 LT  
 12+36.9 RT

DELINEATOR WITH STEEL POST

10+39.5 LT (TYPE III) BACK TO BACK  
 11+10.0 LT (TYPE III) BACK TO BACK  
 11+85.0 LT (TYPE III) BACK TO BACK  
 12+60.0 LT (TYPE III) BACK TO BACK  
 13+35.0 LT (TYPE III) BACK TO BACK  
 14+10.0 LT (TYPE III) BACK TO BACK

LEGEND

- [ ] = EXISTING SIGN
- R&S = REMOVE AND SALVAGE
- RET = RETAIN EXISTING SIGN OR POST
- EL = 4" WHITE EDGE LINE
- DYCL = 4" DOUBLE YELLOW CENTERLINE
- CL = 4" YELLOW CENTERLINE
- GORE = GORING
- N = NEW

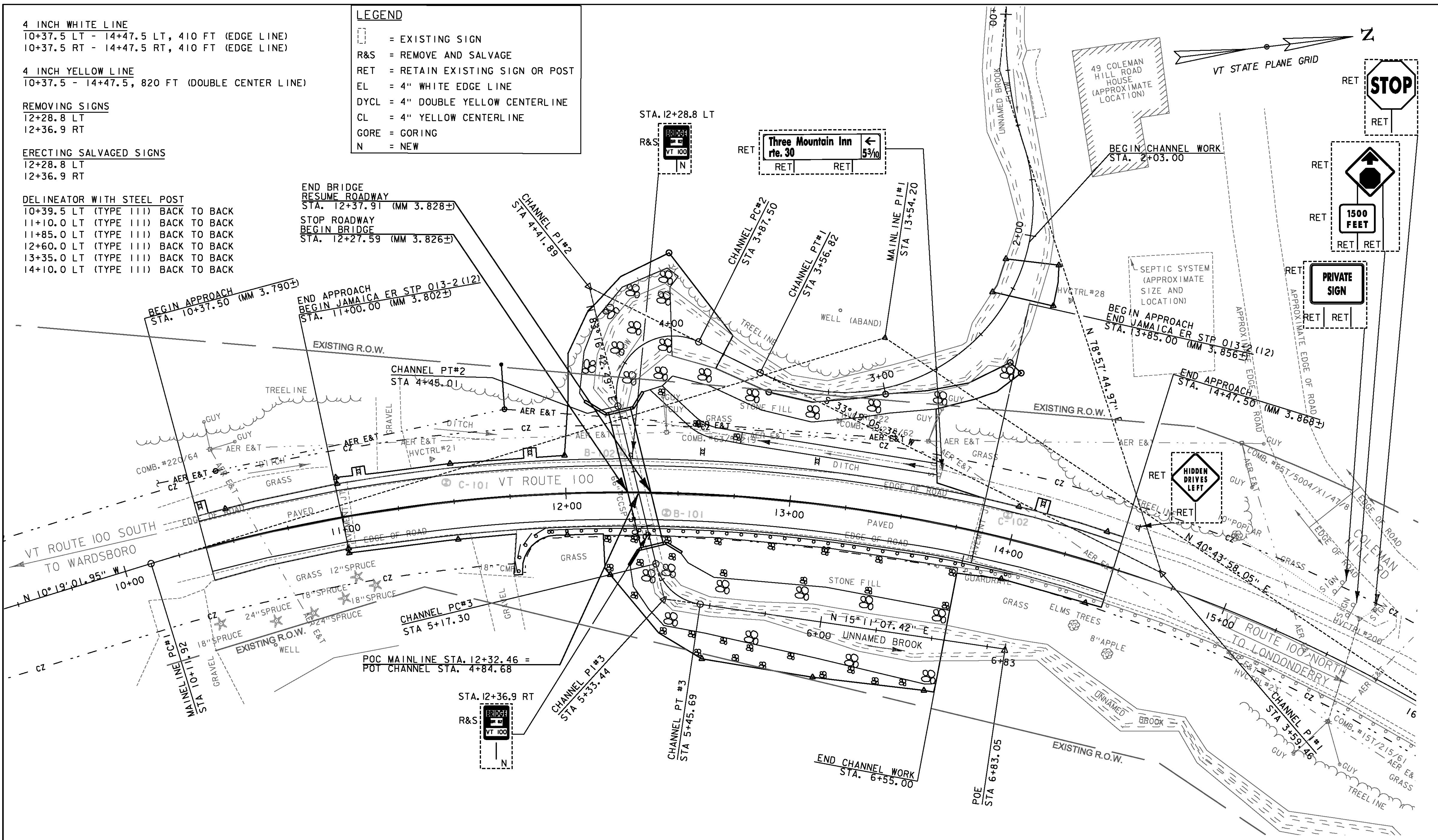

NOTE: ADJUST CENTERLINE AND EDGELINE PAVEMENT MARKINGS TO MATCH TO EXISTING AT BEG/END APPROACH

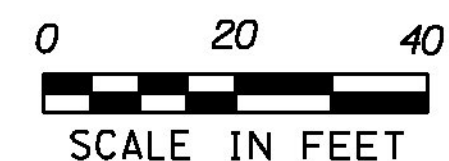

PROJECT NAME: JAMAICA  
 PROJECT NUMBER: ER STP 013-2(12)  
 FILE NAME: z12b474trfbdr.dgn  
 PROJECT LEADER: E. ATKINS  
 DESIGNED BY: M. BRADLEY  
 TRAFFIC SHEET  
 PLOT DATE: 02/27/2015  
 DRAWN BY: M. BRADLEY  
 CHECKED BY: E. ATKINS  
 SHEET 26 OF 48