

61D

61B

50B

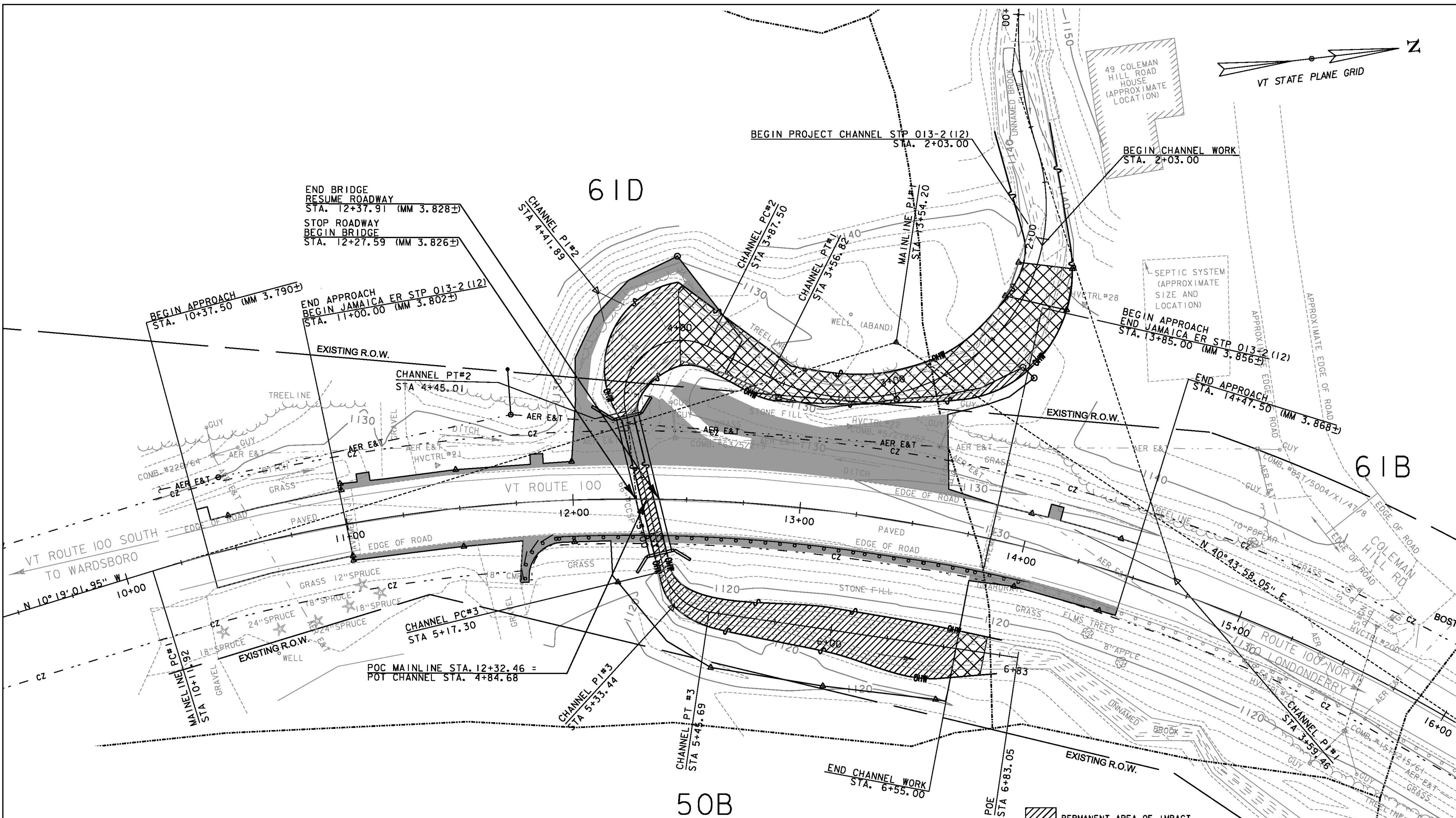

IMPACT BELOW ORDINARY HIGH WATER LINE
 APPROXIMATE AREA OF IMPACT = 8,440 SF +/- (0.194 AC)
 APPROXIMATE AREA OF PERMANENT IMPACT = 4,359 SF +/- (0.100 AC)
 APPROXIMATE AREA OF TEMPORARY IMPACT = 4,081 SF +/- (0.094 AC)
 APPROXIMATE VOLUME OF STONE FILL BELOW OHW = 575 CY +/-
 APPROXIMATE VOLUME OF STONE FILL PER LINEAR FOOT = 1.42 CY/LF +/-

- PERMANENT AREA OF IMPACT BELOW APPROXIMATE OHW
- TEMPORARY AREA OF IMPACT BELOW APPROXIMATE OHW



PROJECT NAME: JAMAICA
 PROJECT NUMBER: ER STP 013-2(12)
 FILE NAME: z12b474ecbdr.dgn
 PROJECT LEADER: E. ATKINS
 DESIGNED BY: M. BRADLEY
 EPSC FINAL CONDITIONS PLAN SHEET

PLOT DATE: 02/27/2015
 DRAWN BY: M. BRADLEY
 CHECKED BY: E. ATKINS
 SHEET 23 OF 48

NOTE:
 SEE CROSS SECTIONS FOR ADDITIONAL PROPOSED GRADING.