

GPS CONTROL POINTS

DANBY CORS ARP

PID DL2318
 N = 310162.23
 E = 1508688.83
 ELLIP HEIGHT = 636.36

STATION IS A GPS CONTINUOUSLY OPERATING REFERENCE STATION. STATION IS THE ANTENNA REFERENCE POINT OF THE GPS ANTENNA. LOCATED AT THE CURRIER MEMORIAL SCHOOL IN DANBY, VERMONT. THE MONUMENT IS ATTACHED TO A TWO STORY CONCRETE/BRICK BUILDING WITH AN 8 FT CONCRETE FOUNDATION BUILT IN 1966. MAST IS A 1.75 INCH DIA GALV. PIPE THAT IS 108 INCHES LONG. THE MAST ATTACHED TO A STEEL MOUNTING FRAME WITH THREE ATTACHMENTS CONSISTING OF 3/8 INCH SS THROUGH BOLTS. THE MOUNTING FRAME IS ATTACHED TO THE BUILDING USING 8 ATTACHMENT POINTS. ALL 8 ATTACHMENTS ARE THROUGH BOLTED AND CONSIST OF 1/2 INCH SS THREADED ROD AND NUTS.

TRAVERSE TIES

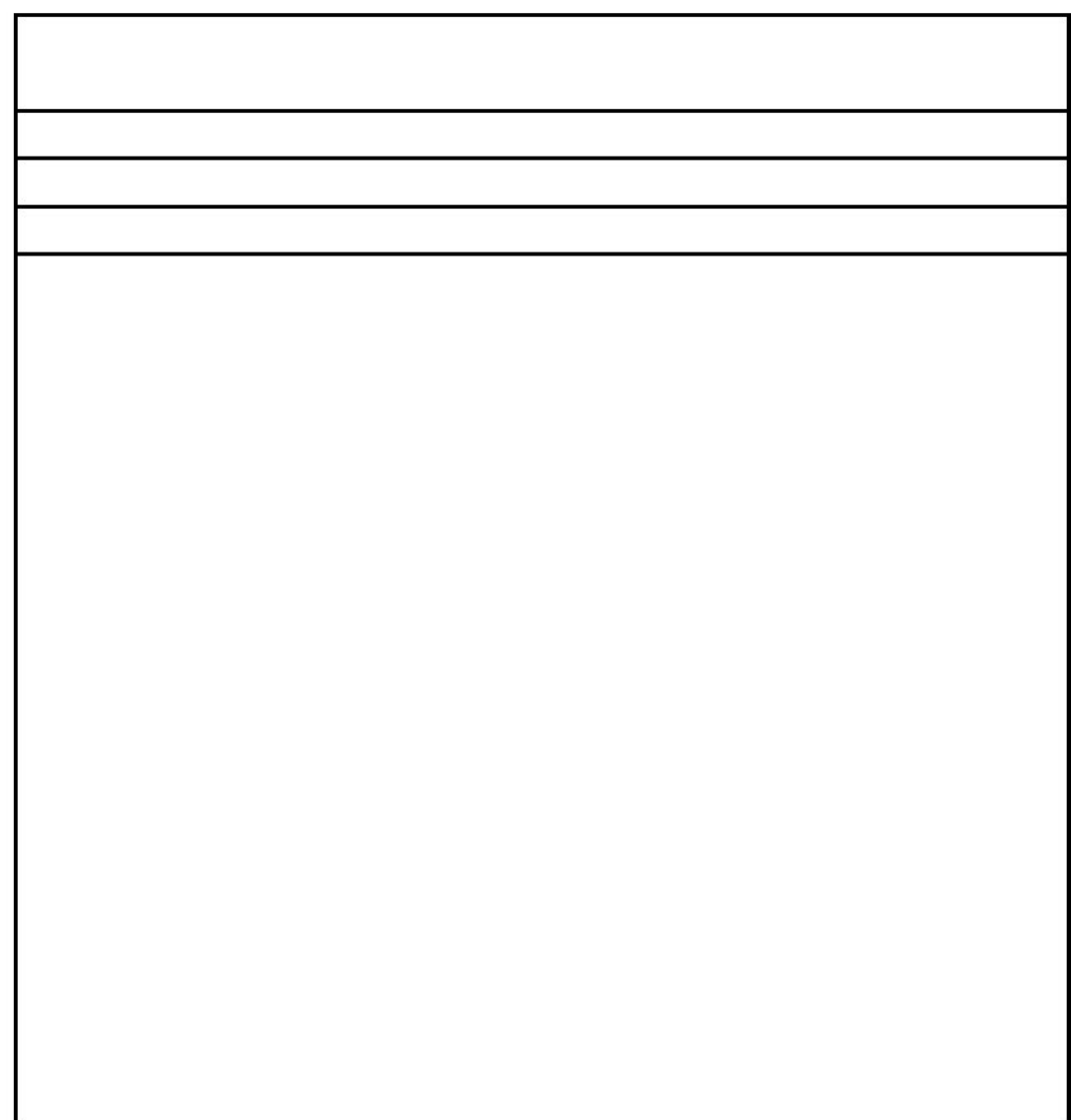
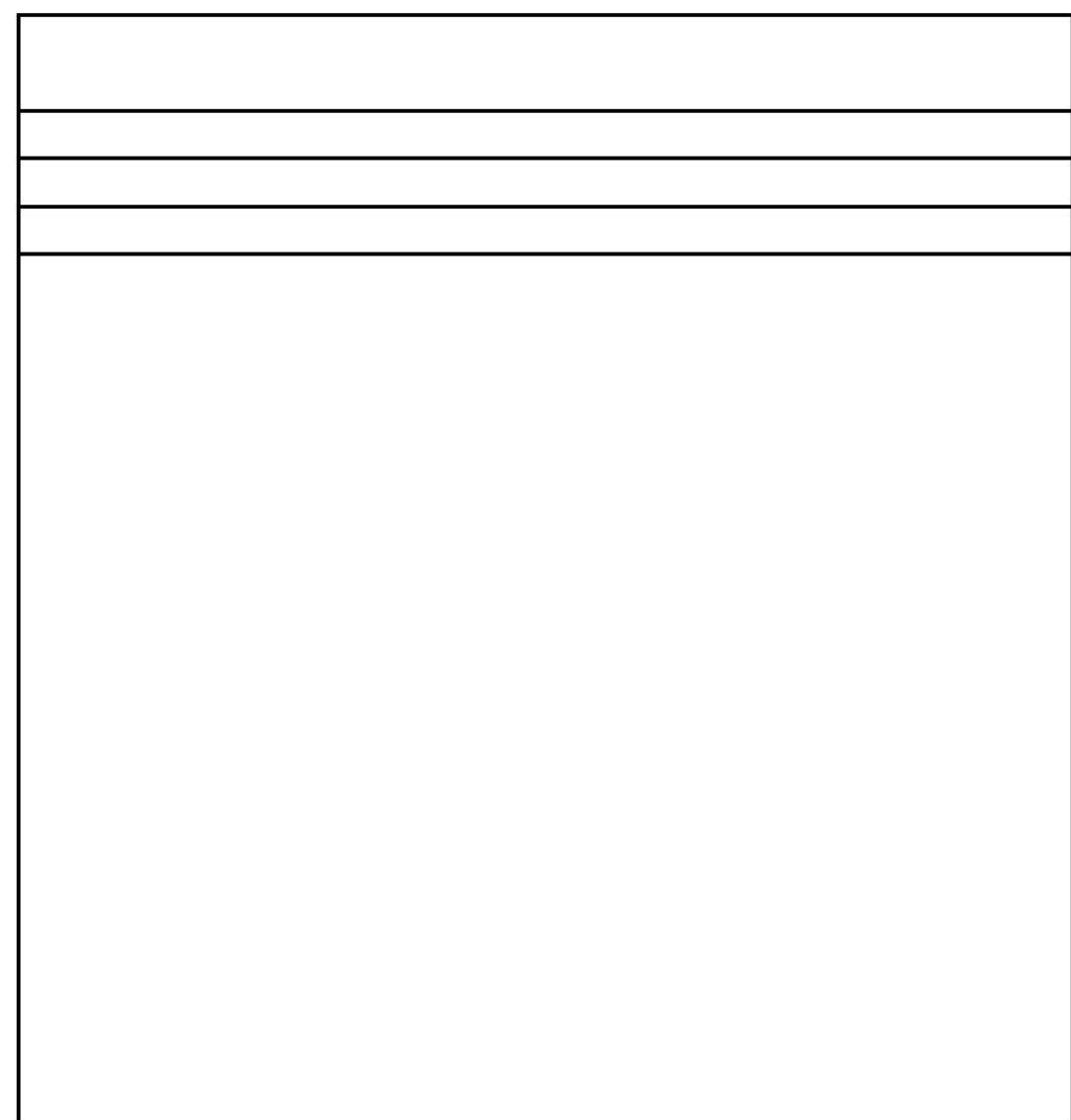
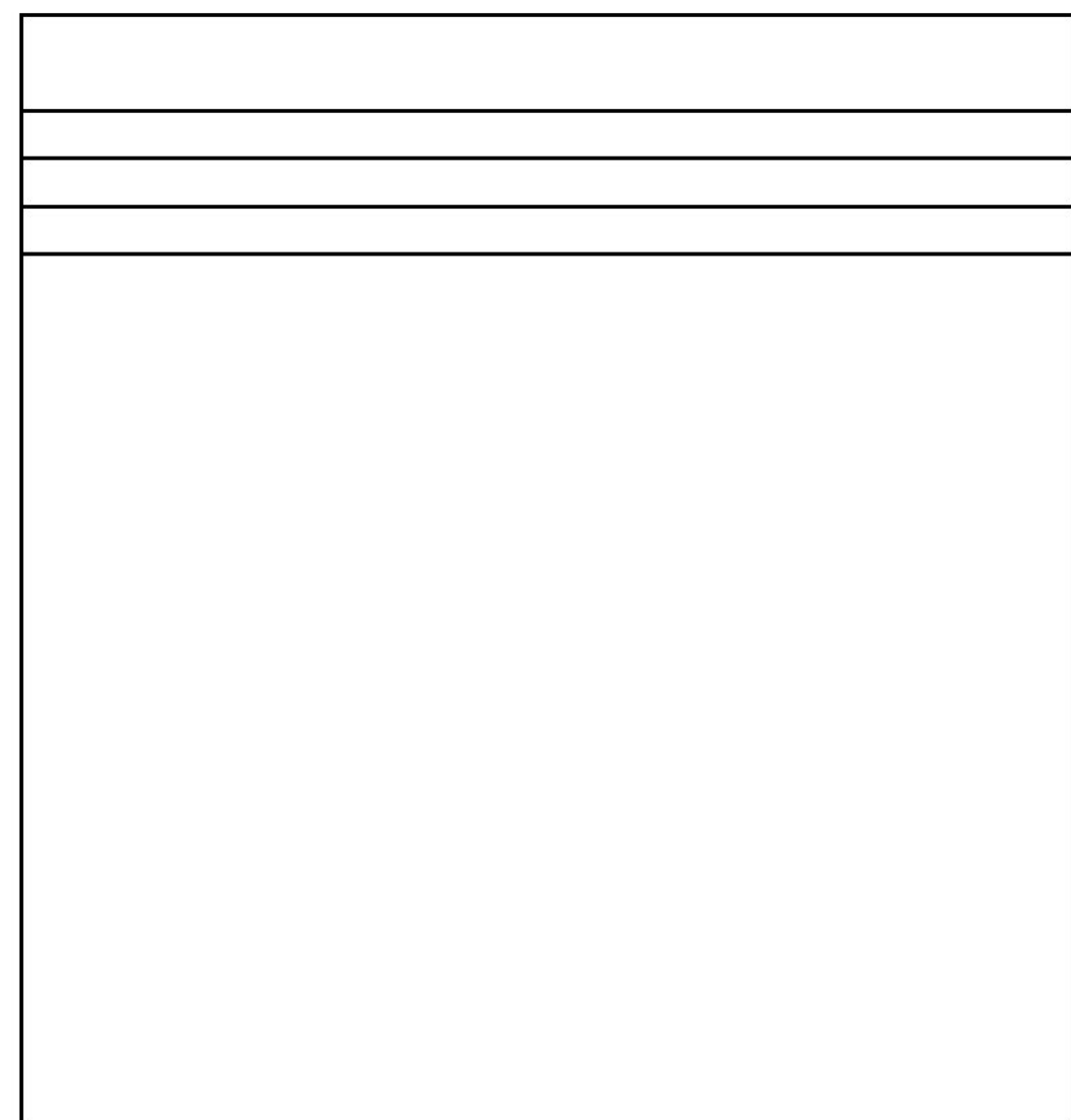
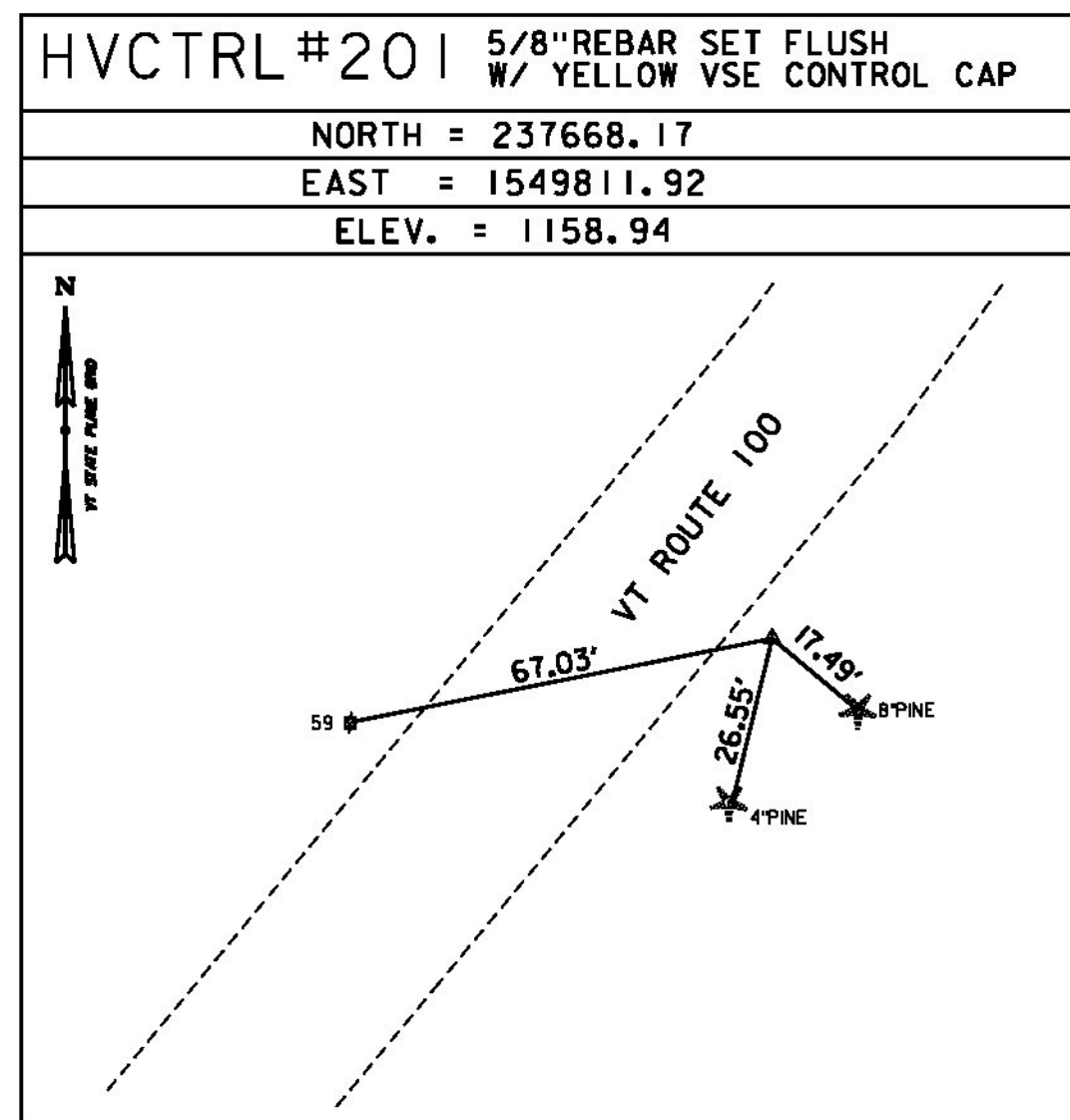
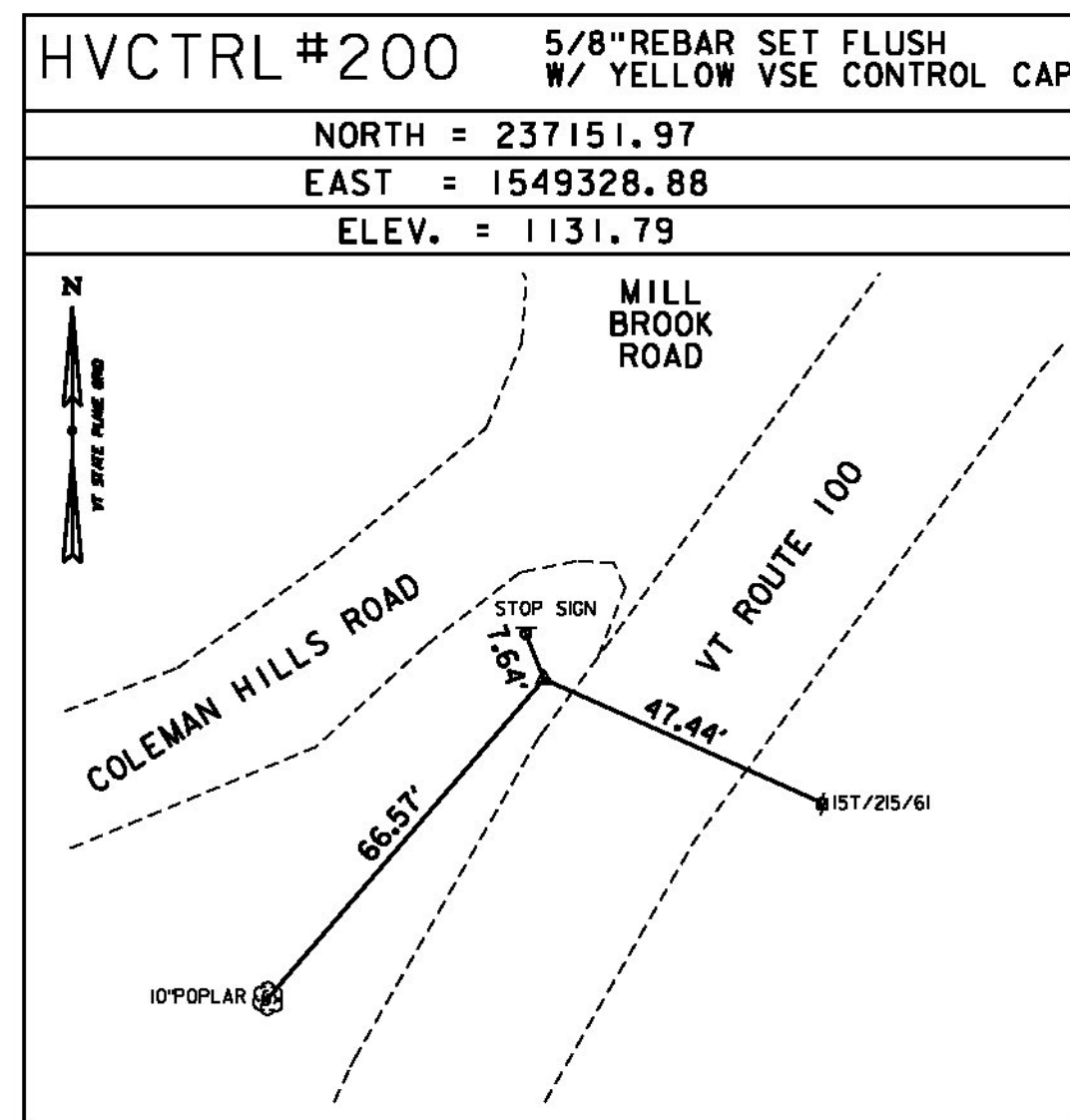

* CONTROL TIES COMPLETED: FEBRUARY 12, 2013 BY VSE, T. SCARZELLO-PC, T. COMSTOCK

ALIGNMENT TIES

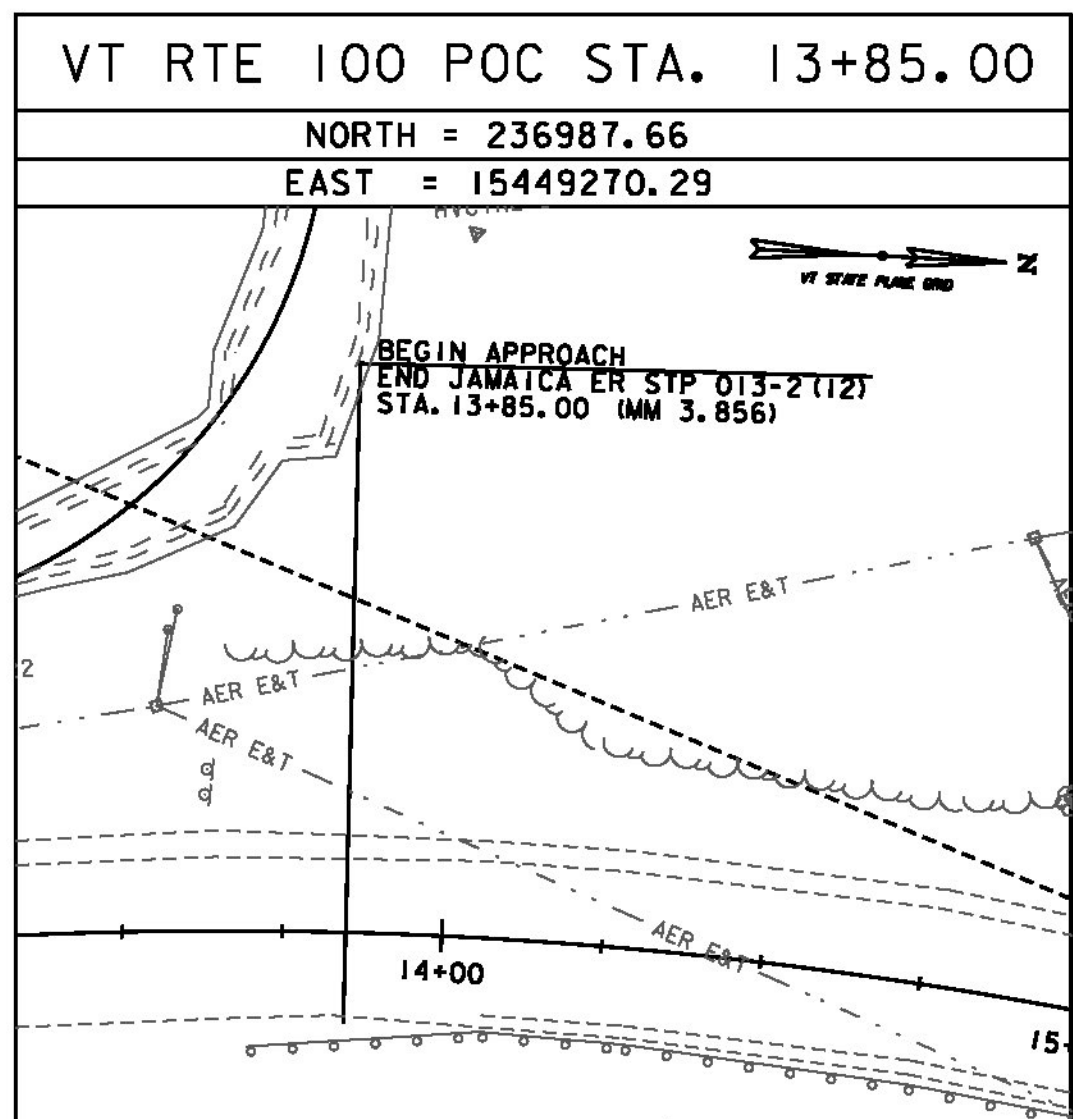
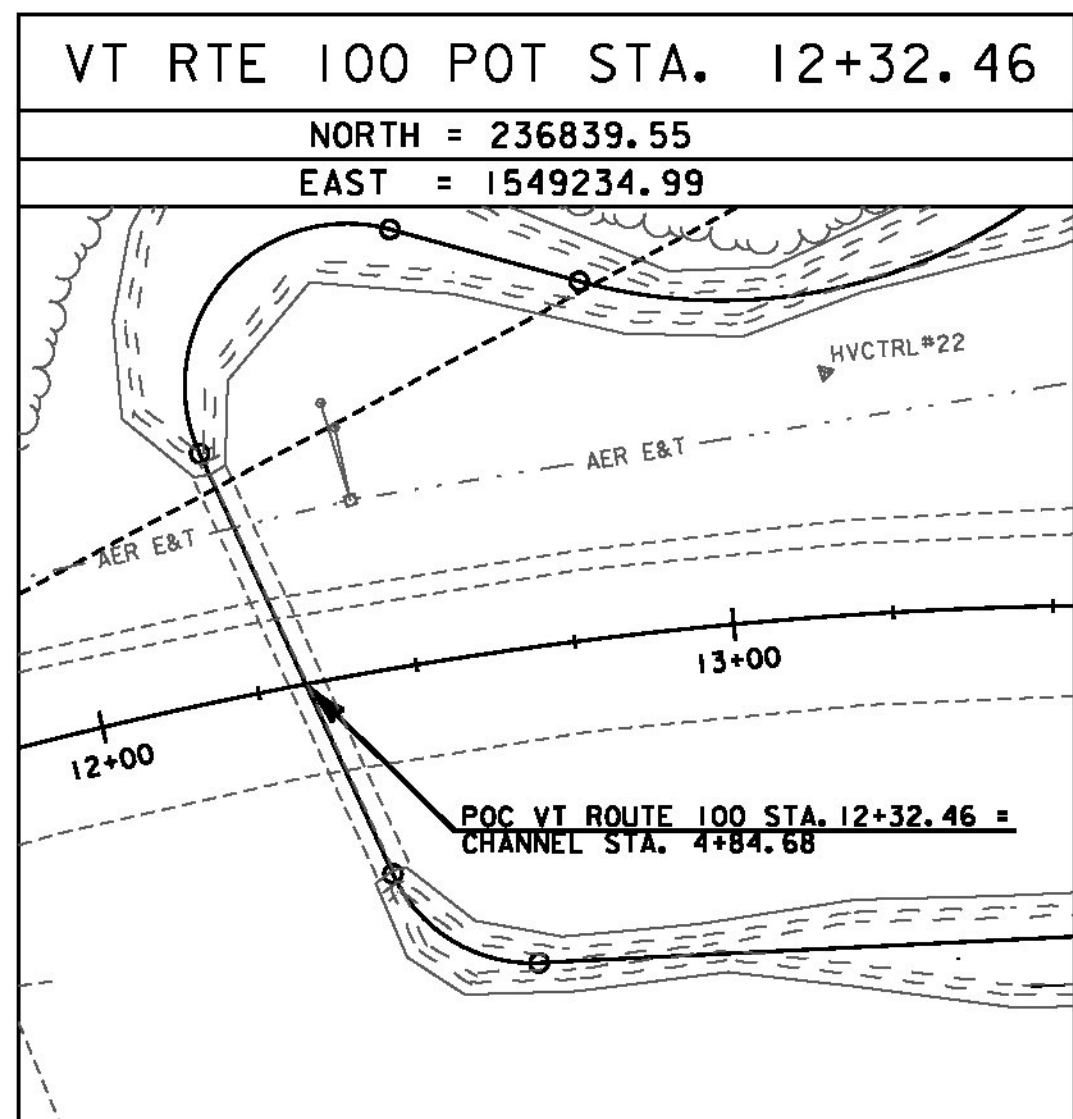
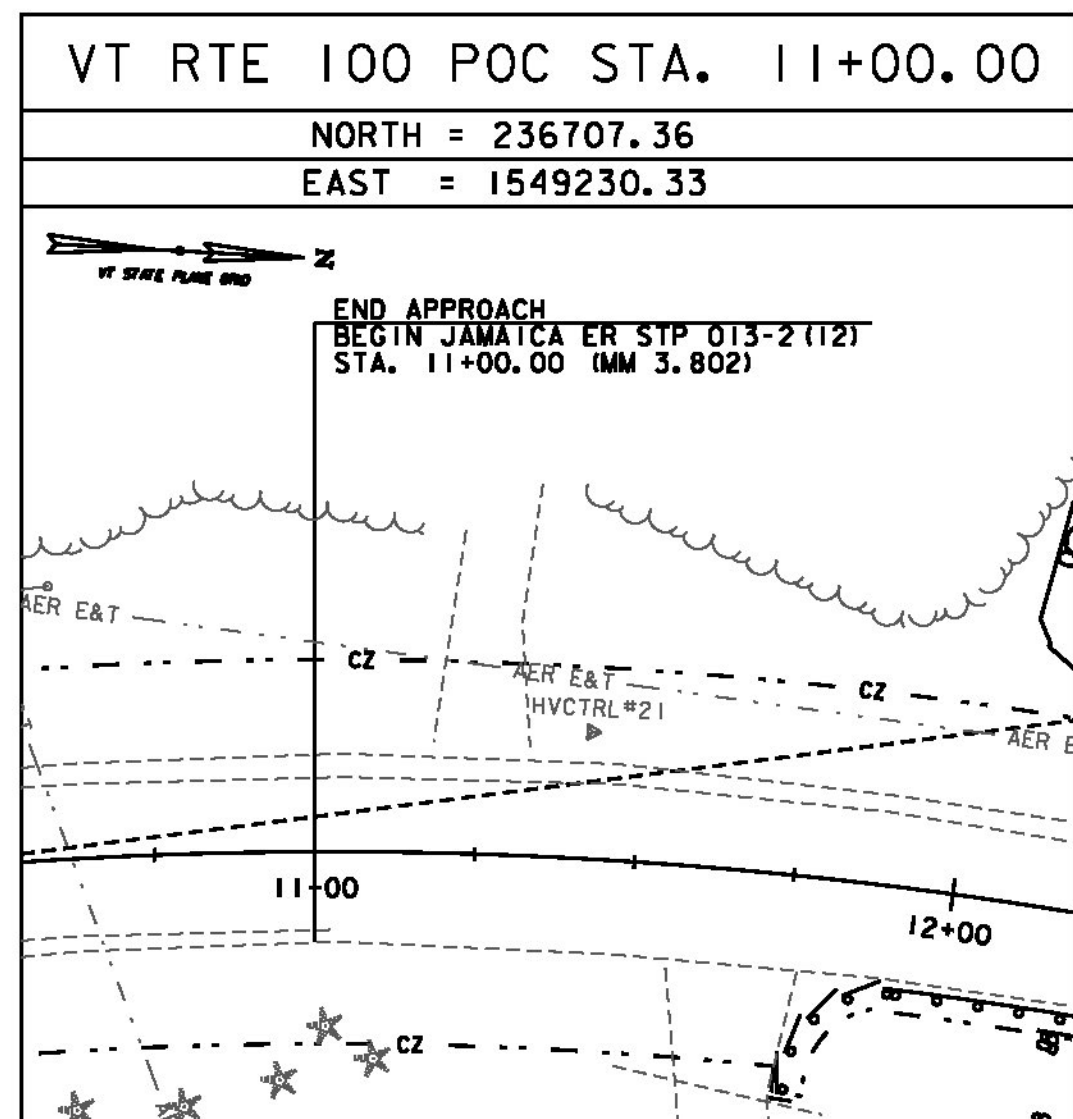
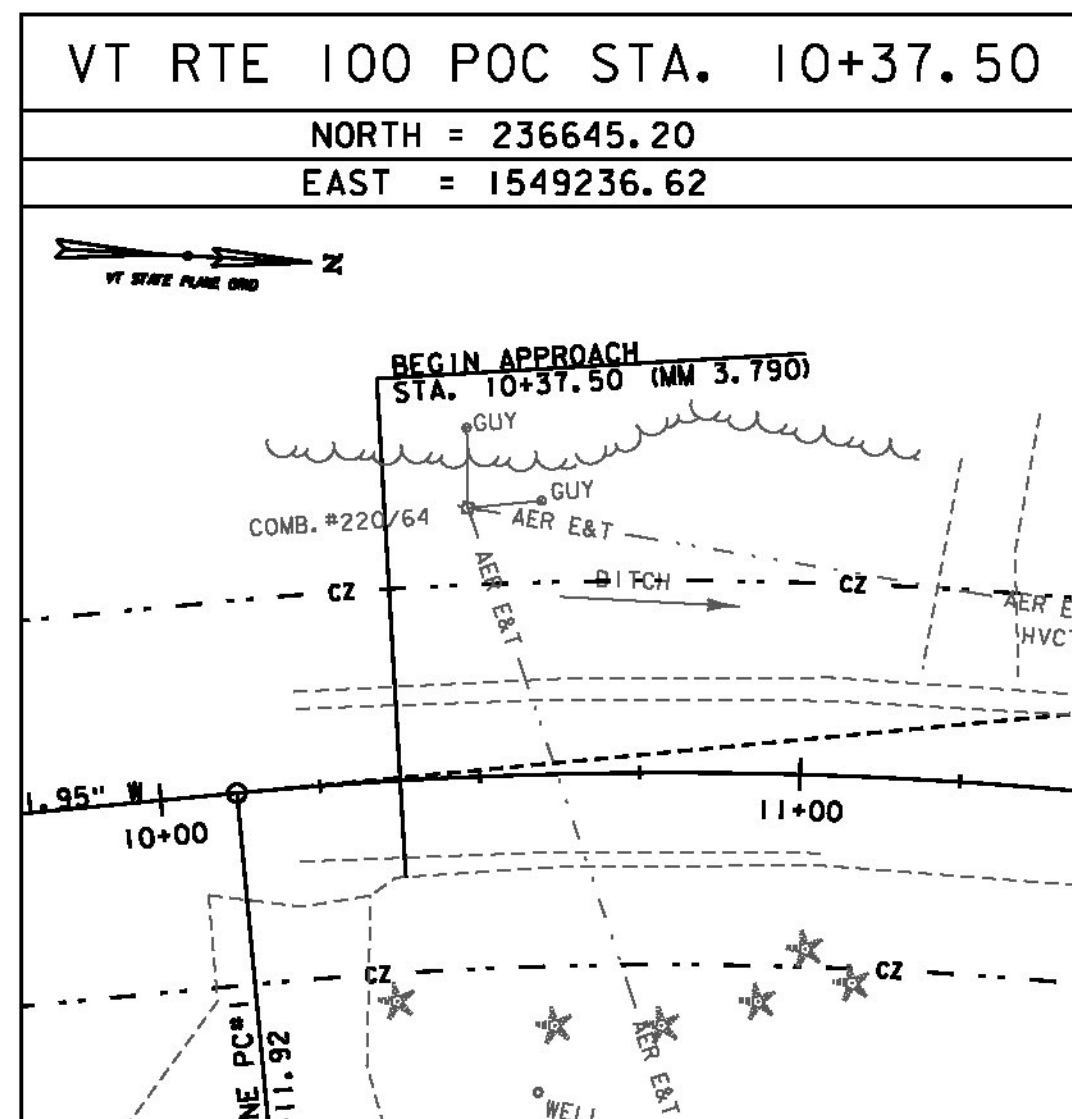
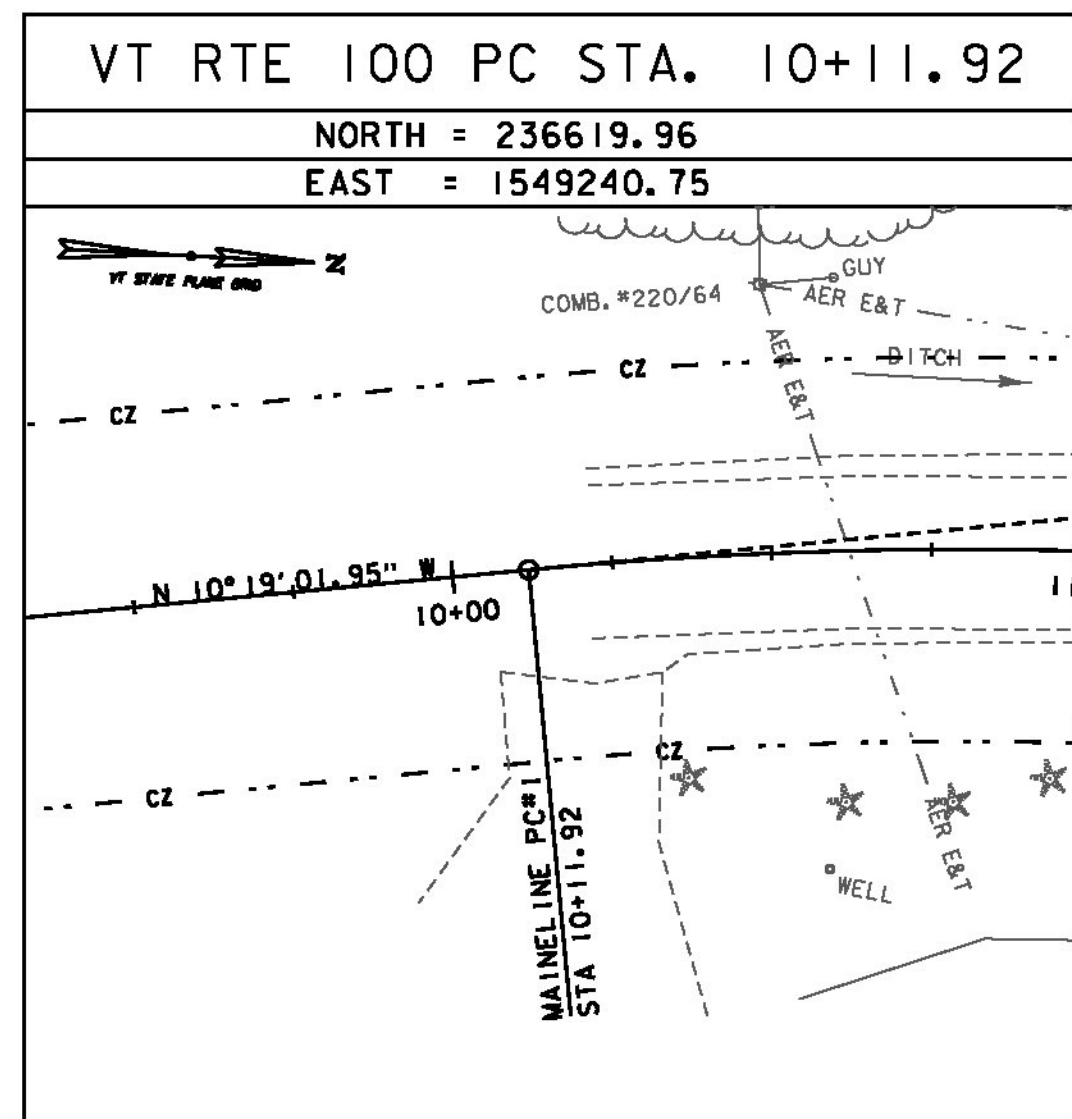

DATUM	
VERTICAL	NAVD 88(GEOD12A) FT
HORIZONTAL	NAD 83(2011) SFT
ADJUSTMENT	NONE

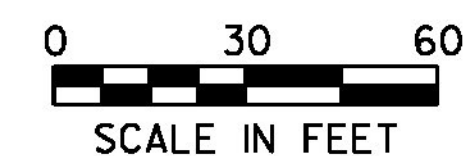

GREEN INTERNATIONAL AFFILIATES, INC.
 CIVIL AND STRUCTURAL ENGINEERS

PROJECT NAME:	JAMAICA	PLOT DATE:	02/27/2015
PROJECT NUMBER:	ER STP 013-2(12)	DRAWN BY:	C. MORIN
FILE NAME:	Z12b474t1.dgn	CHECKED BY:	E. ATKINS
PROJECT LEADER:	E. ATKINS	TIE SHEET 1	SHEET 7 OF 48
DESIGNED BY:	C. MORIN		