

GPS/NGS CONTROL POINTS

SOMERSET RD

PID AB7362
 N = 141730.78
 E = 1519571.26
 ELEV. = 1677.48

DESCRIBED BY VERMONT AGENCY OF TRANSPORTATION 1991 (CHR). GENERAL LOCATION, SEARSBURG, VT., ABOUT 4.5 MI (7.2 KM) WEST OF WILMINGTON, VT., ABOUT 12.5 MI (20.1 KM) EAST OF BENNINGTON, AND ABOUT 10.5 MI (16.9 KM) NORTH OF THE MASSACHUSETTS/VERMONT STATE LINE. TO REACH FROM THE INTERSECTION OF VT ROUTES 8 AND 9 IN SEARSBURG, GO EAST ALONG VT ROUTE 9 FOR 1.6 MI (2.6 KM) TO THE MARK ON THE LEFT. TO REACH FROM THE INTERSECTION OF VT ROUTES 9 AND 100 NORTH AT THE TRAFFIC LIGHT IN WILMINGTON, GO WEST ALONG VT ROUTE 9 FOR 5.0 MI (8.0 KM) TO THE MARK ON THE RIGHT, ABOUT 100 M (328.1 FT) SOUTHEAST OF A GRAY 1+1/2 STORY WOOD FRAME HOUSE WITH GARAGE. THE MARK IS SET 5 CM BELOW GROUND SURFACE IN THE TOP OF A 30 CM DIAMETER CONCRETE MONUMENT. IT IS 9.3 M (30.5 FT) EAST OF AND ABOUT 0.5 M (1.6 FT) LOWER THAN THE CENTERLINE OF VT ROUTE 9, 3.4 M (11.2 FT) EAST OF THE EAST FACE OF A STEEL GUARD RAIL, 7.6 M (24.9 FT) WEST OF POLE 75/574, 28.2 M (92.5 FT) SOUTH OF A PICNIC AREA/NEPCO SIGN, AND 0.5 M (1.6 FT) WEST OF A FIBERGLASS WITNESS POST. NOTE, THIS MARK IS INTERVISIBLE WITH MARK SOMERSET RD AZ MK.

SOMERSET RD AZ MK

PID AB7361
 N = 143739.14
 E = 1518317.53
 ELEV. = 1819.94

RECOVERY NOTE BY VERMONT GEODETIC SURVEY 2011 (MJA). GENERAL LOCATION, SEARSBURG. TO REACH FROM THE INTERSECTION OF VT ROUTE 8 AND VT ROUTE 9, GO EAST ALONG VT ROUTE 9 FOR 0.9 MI (1.4 KM) TO THE SITE OF THE MARK ON THE LEFT. THE MARK IS SET 30 CM (12 INCHES) BELOW GROUND SURFACE IN THE TOP OF A 30 CM (12 INCH) DIAMETER CONCRETE MONUMENT. IT IS 10.9 M (35.8 FT) EAST OF AND 0.3 M (1.0 FT) LOWER THAN THE CENTERLINE OF VT ROUTE 9, 2.5 M (8.2 FT) EAST OF THE VT ROUTE 9 EAST EDGE OF PAVEMENT, 35.1 M (115.2 FT) NORTH-NORTHWEST OF POLE NO 354/57, 37.7 M (123.7 FT) SOUTH OF POLE NO 571/3-01, 19.4 M (63.6 FT) EAST OF THE MOST EASTERLY SUPPORT POST FOR A RUNAWAY TRUCK RAMP SIGN WITH FLASHING LIGHTS, 30.5 M (100.1 FT) SOUTHWEST OF THE CENTER THE EAST (OUTLET) END OF A 60 CM (24 INCH) DIAMETER METAL CULVERT WITH STEEL MARKER POST AND 0.3 M (1.0 FT) WEST OF A FIBERGLASS WITNESS POST.

TRAVERSE TIES

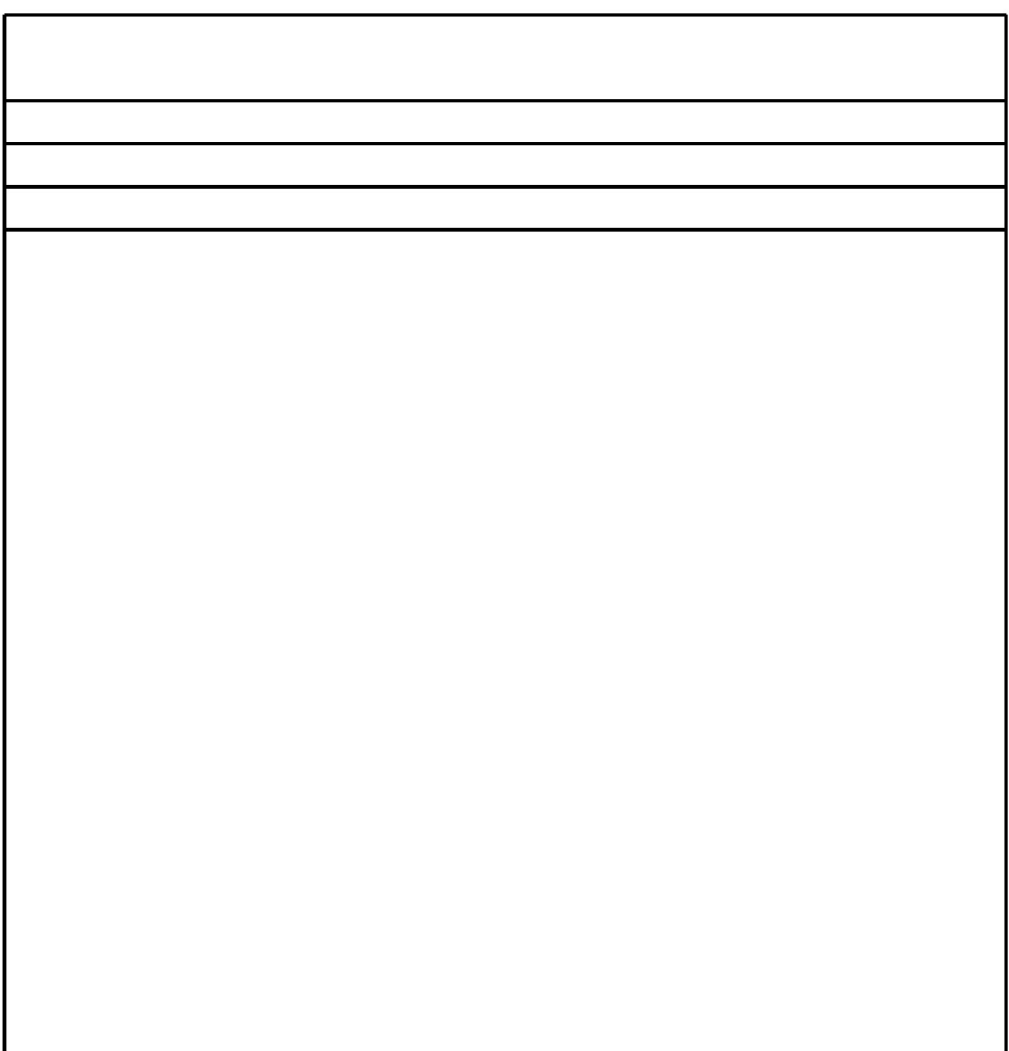
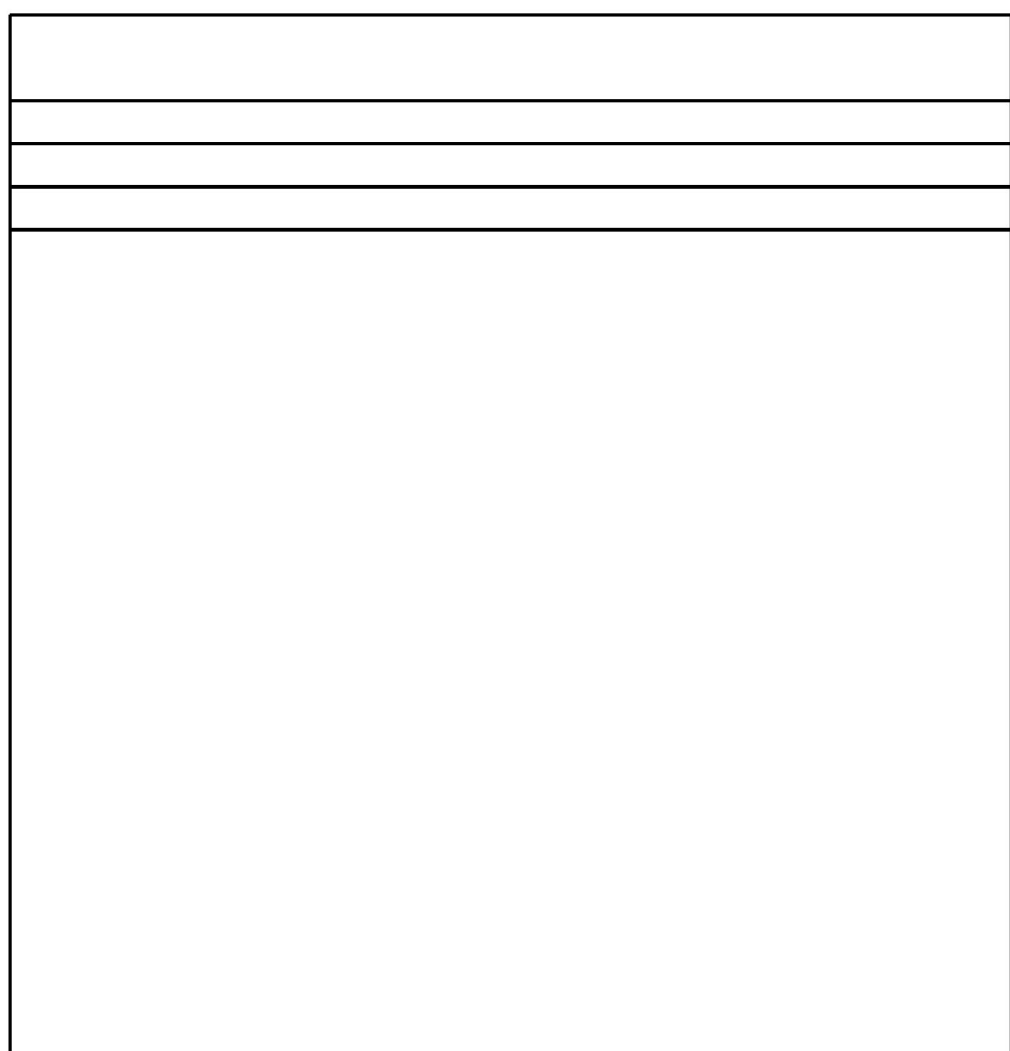
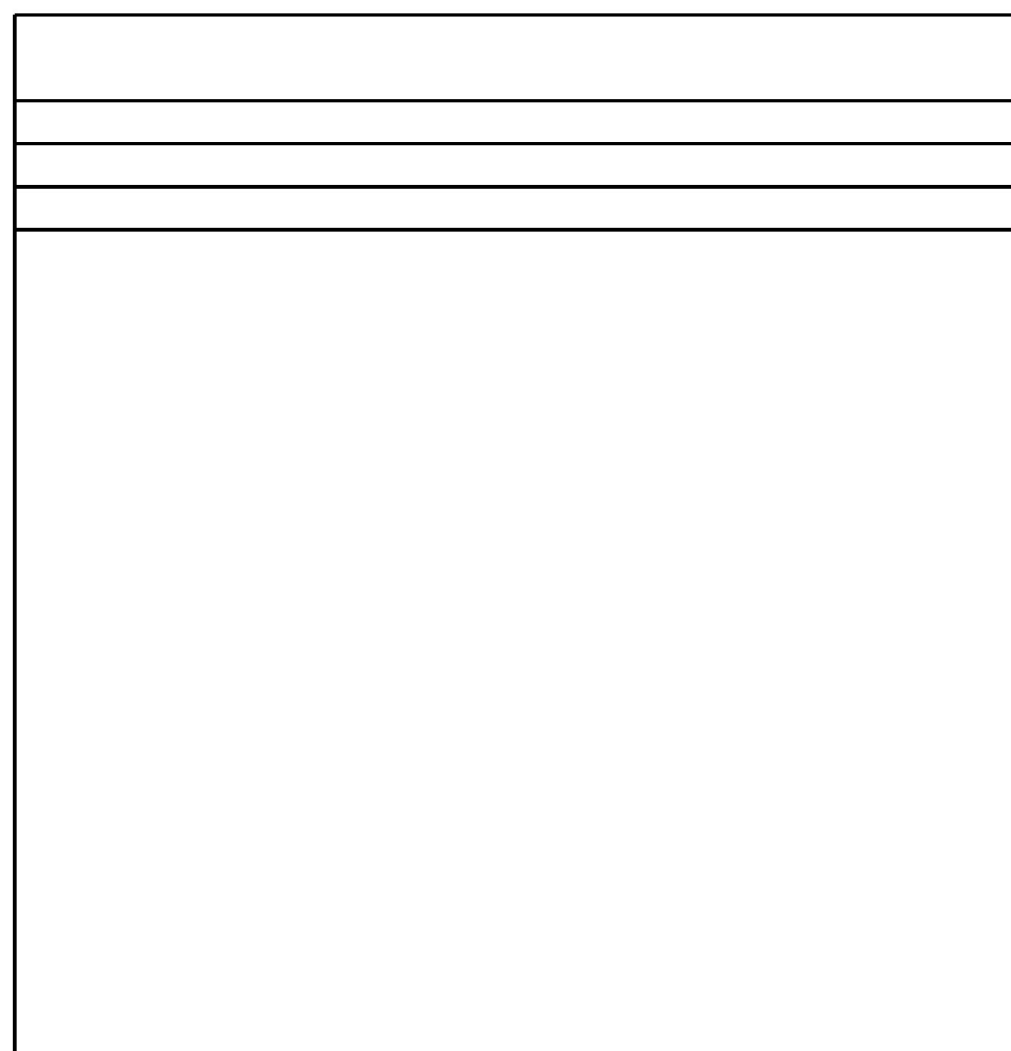
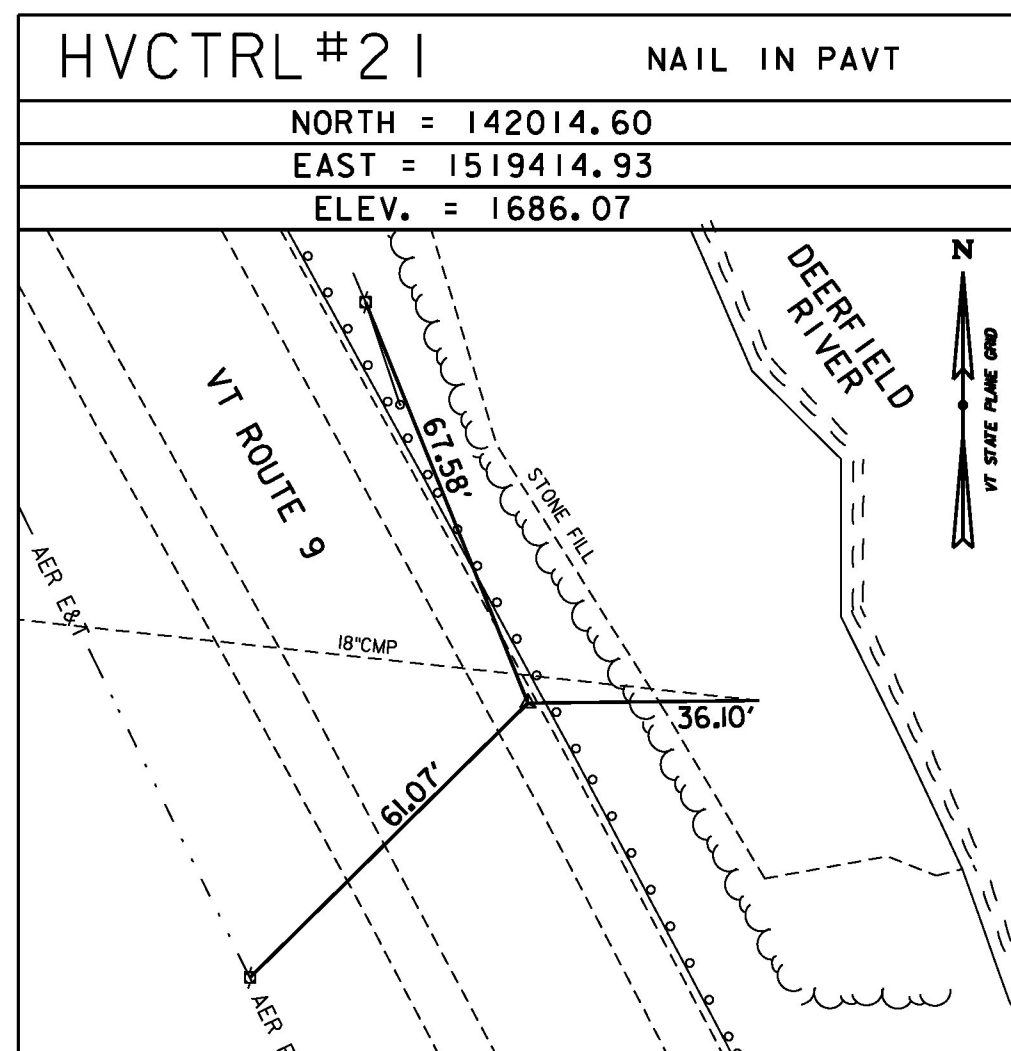
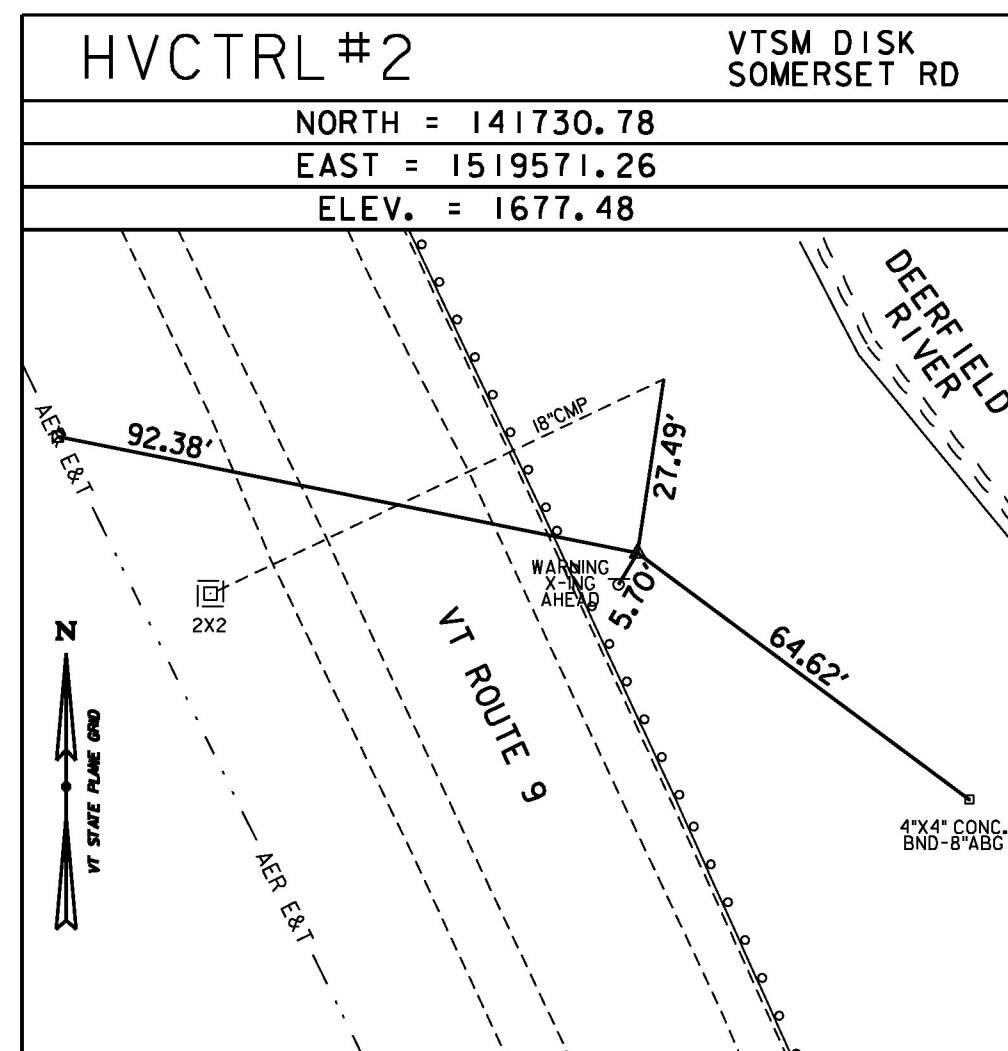

* CONTROL POINT #21 SET JANUARY 19, 2013 BY PATON SURVEYS, C. PATON-PC

ALIGNMENT TIES

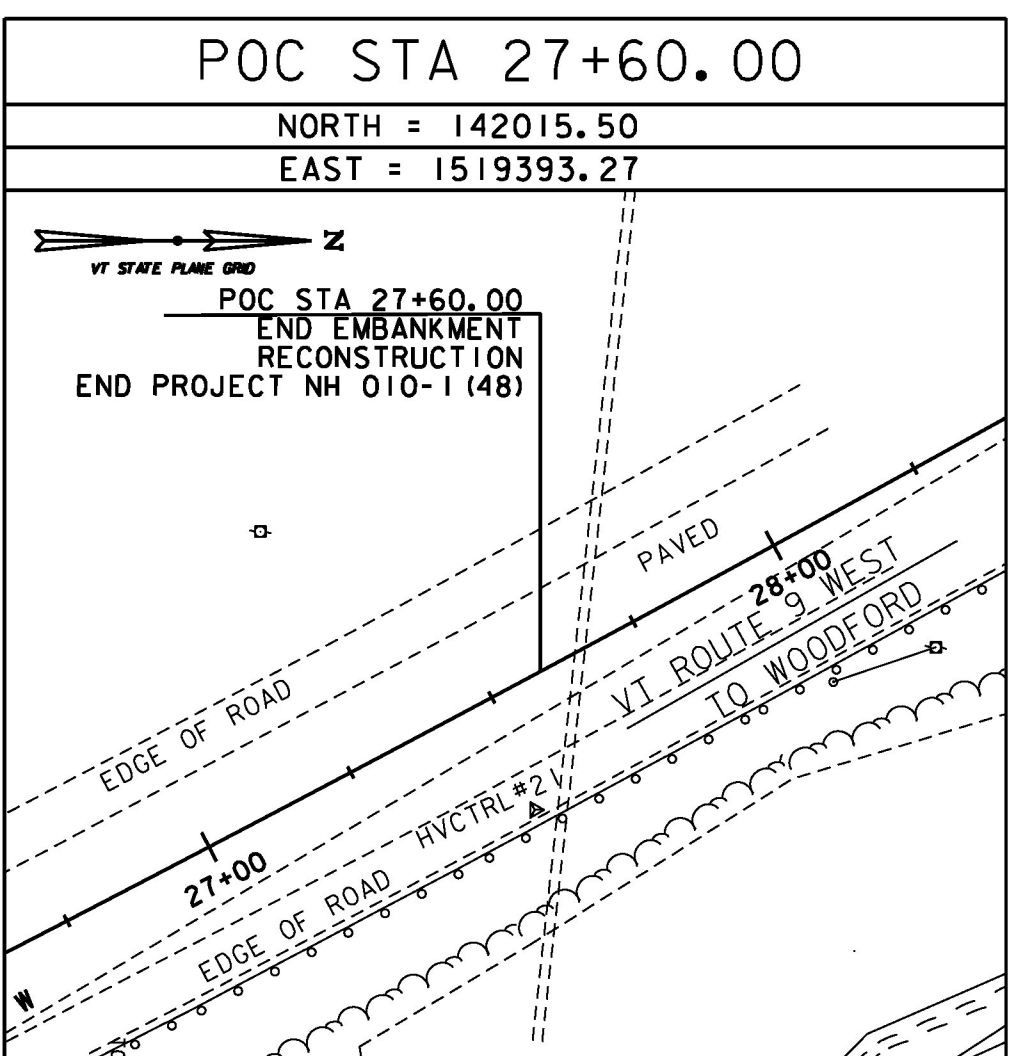
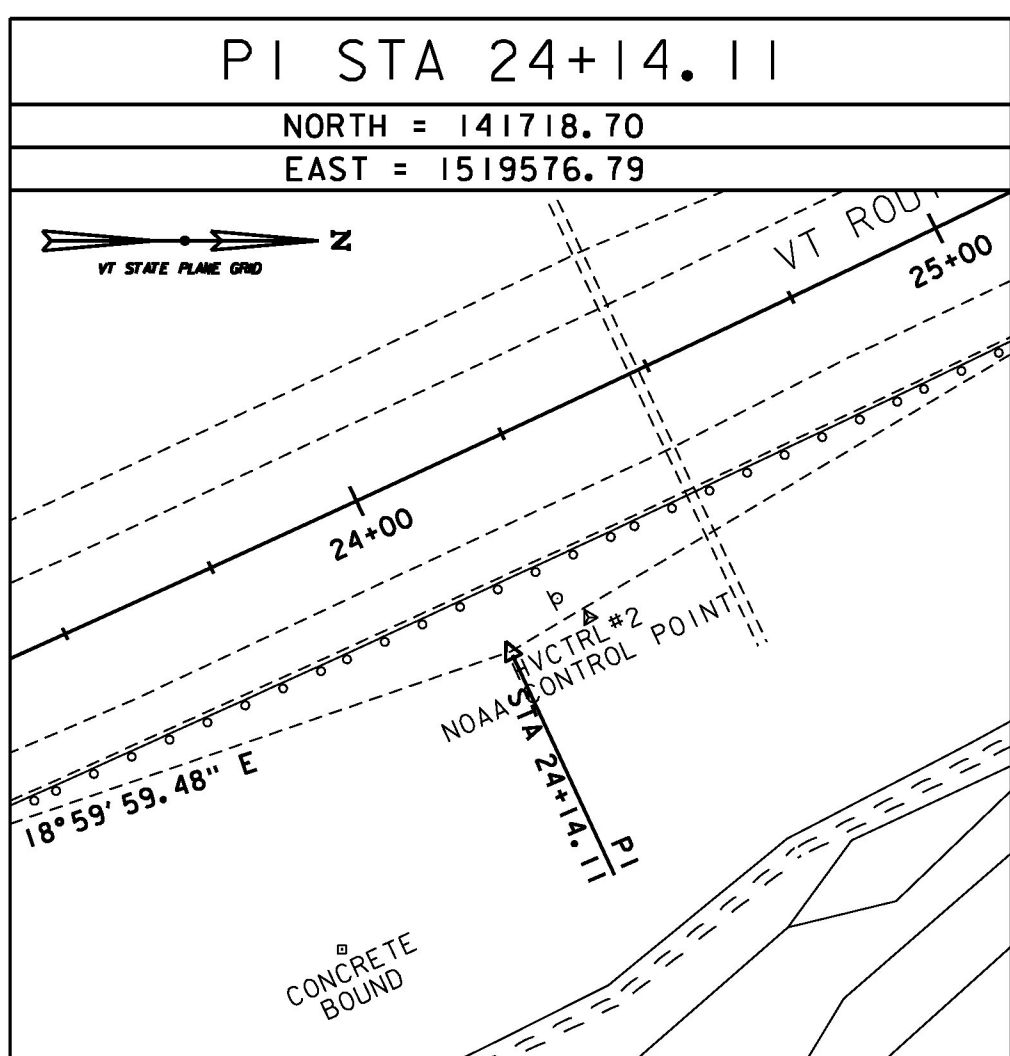
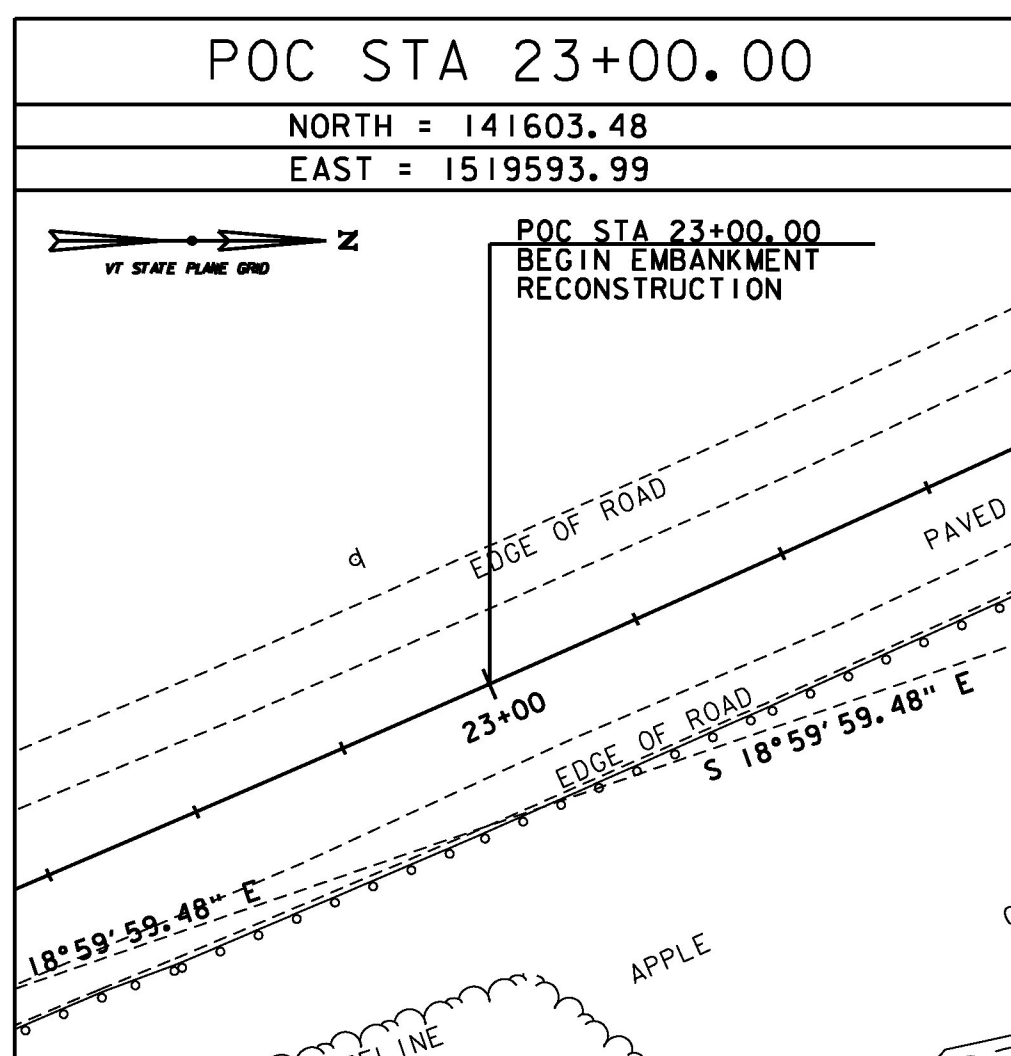
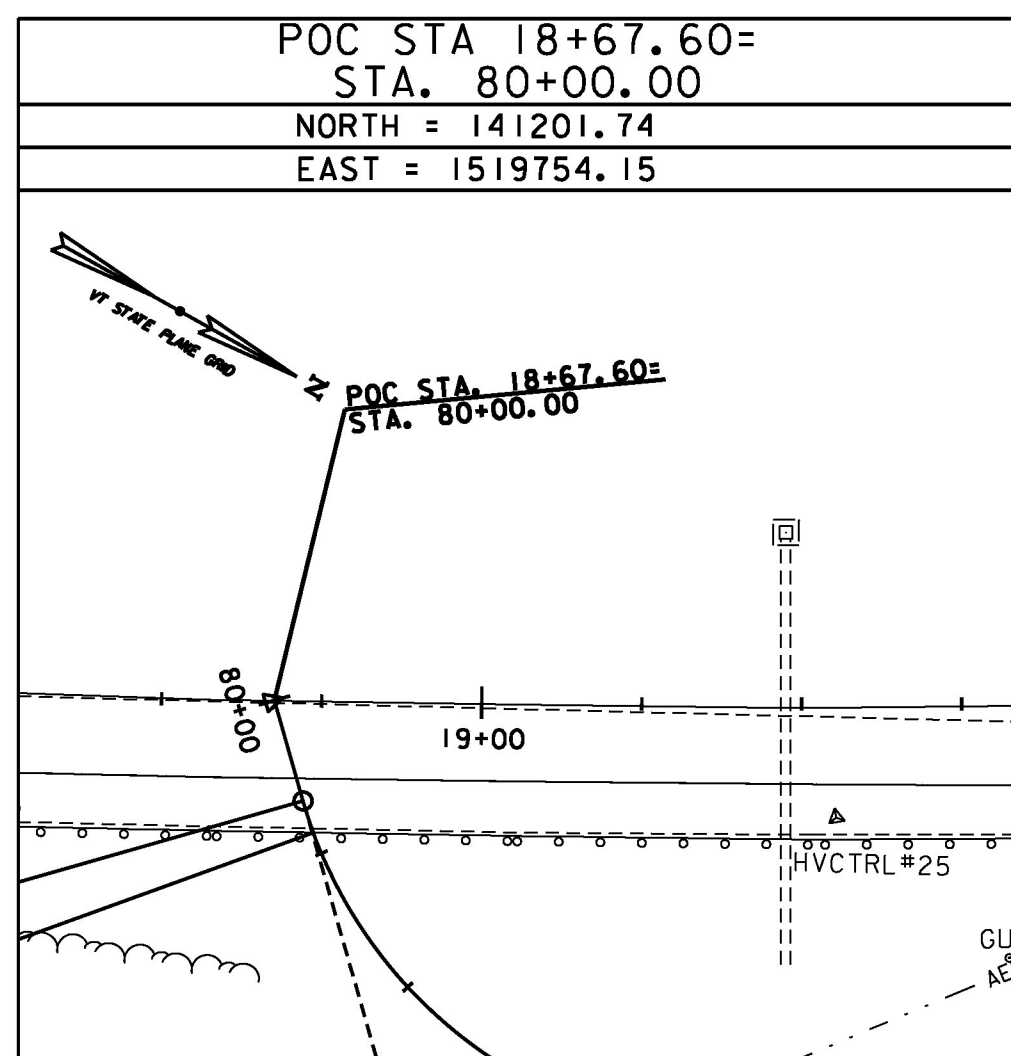
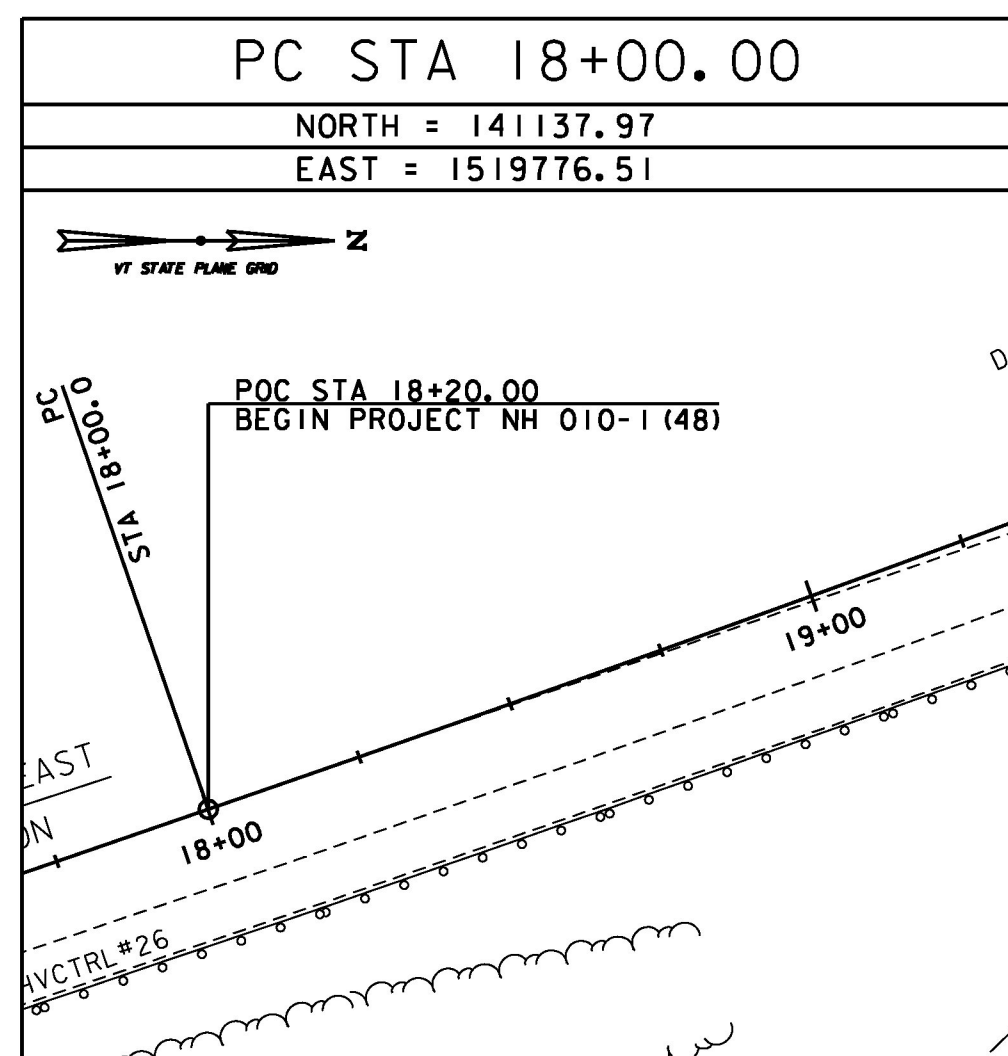

DATUM	
VERTICAL	NAVD 88 FT
HORIZONTAL	NAD 83(1992) sFT
ADJUSTMENT	NONE

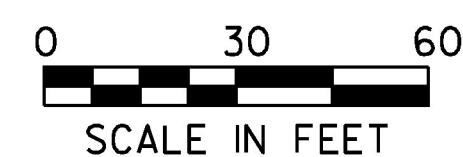

SCALE IN FEET
 GREEN INTERNATIONAL AFFILIATES, INC.
 CIVIL AND STRUCTURAL ENGINEERS

PROJECT NAME: SEARSBURG
 PROJECT NUMBER: NH 010-1(48)

FILE NAME: z12B4041e2.dgn
 PROJECT LEADER: E. ATKINS
 DESIGNED BY: M. BRADLEY
 TIE SHEET 1

PLOT DATE: 6/16/2014
 DRAWN BY: C. MORIN
 CHECKED BY: E. ATKINS
 SHEET 7 OF 45