

BEGIN R.O.W. PROJECT

END R.O.W. PROJECT

**BF 013-1(22)
STA. 283+44
21.34' LT**

**BF 013-1(22)
STA. 285+34
20.54' LT**

**1A
DEWEY, PEARL G.**

**2
YOUNG, JR., RAYMOND P.
& NANCY L.**

DEWEY, PEARL G.

1B

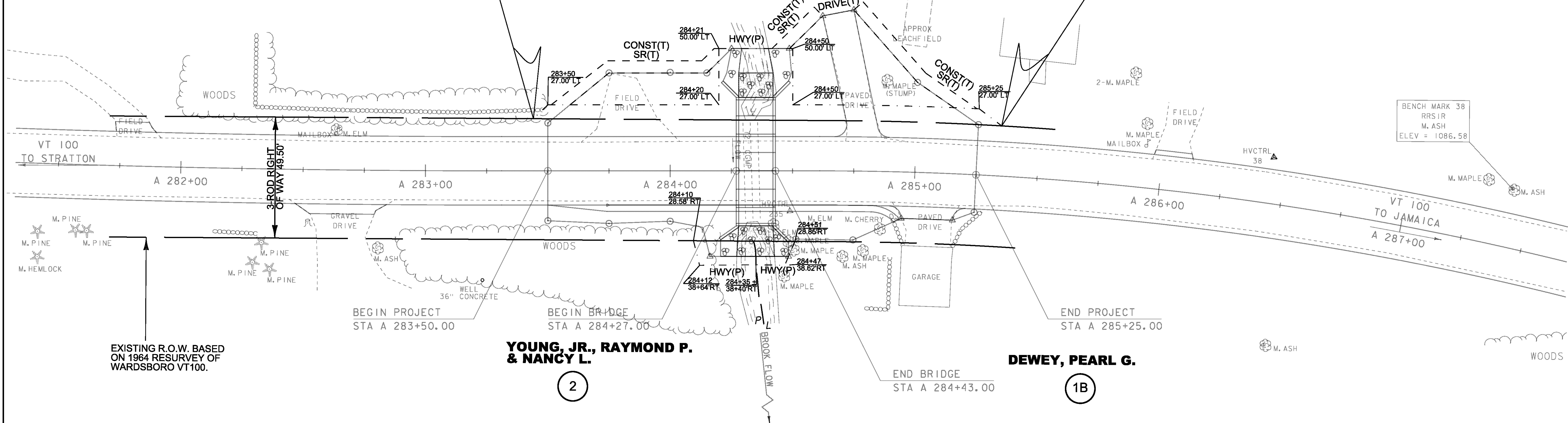

EXISTING R.O.W. BASED ON 1964 RESURVEY OF WARDBORO VT100.

ROW LAYOUT SHEET

SCALE 1" = 20' - 0"

| | |
|------------------------------|--------------------------|
| PROJECT NAME: WARDBORO | PLOT DATE: 26-FEB-2014 |
| PROJECT NUMBER: BF 013-1(22) | DRAWN BY: J. BLANCHARD |
| FILE NAME: sl3b074bdr.dgn | CHECKED BY: J. BLANCHARD |
| PROJECT LEADER: K. HIGGINS | SHEET 443 OF 444 |
| DESIGNED BY: J. SALVATORI | |
| ROW LAYOUT SHEET | |