

BRISSETTE, LAURA M.

2

N/F JOSLIN, JEAN M.

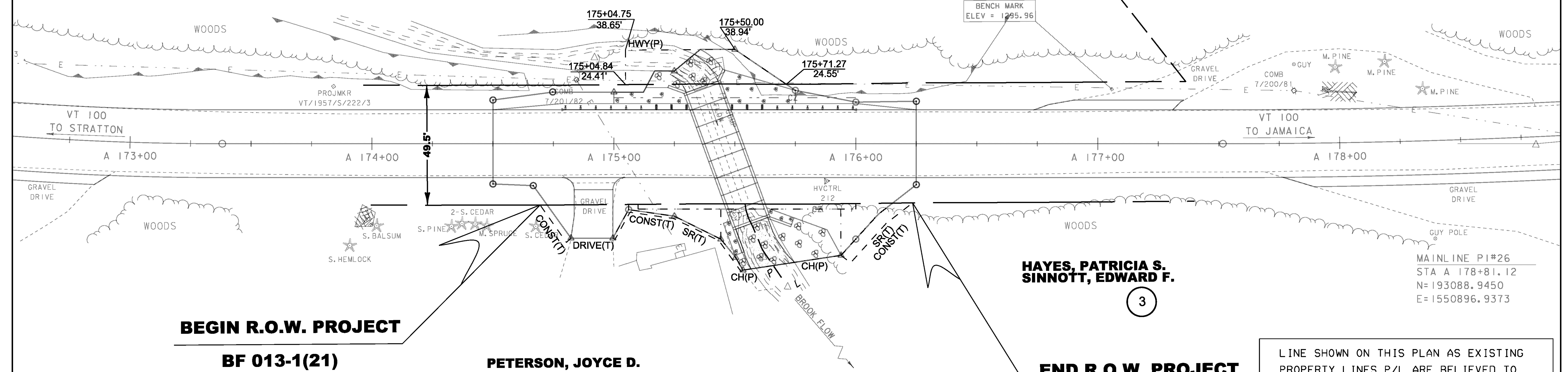

BEGIN R.O.W. PROJECT

**BF 013-1(21)
STA. 174+69
25' RT**

PETERSON, JOYCE D.

1

**HAYES, PATRICIA S.
SINNOTT, EDWARD F.**

3

END R.O.W. PROJECT

**BF 013-1(21)
STA. 176+23
24' RT**

MAINLINE P1#26
STA A 178+81.12
N= 193088.9450
E= 1550896.9373

LINE SHOWN ON THIS PLAN AS EXISTING PROPERTY LINES P/L ARE BELIEVED TO BE ACCURATE BUT SHOULD NOT BE RELIED UPON FOR PURPOSES UNRELATED TO THE STATE OF VERMONT'S ACQUISITION OF LAND AND RIGHTS FOR THIS PROJECT.

ROW LAYOUT SHEET

SCALE 1" = 20'-0"
20 0 20

ALL DRIVES AS INDICATED ON PLANS ARE SUBJECT TO PERMITS PURSUANT TO TITLE 19 SECTION IIII, V. S. A.

PROJECT NAME: WARDBORO	PLOT DATE: 26-FEB-2014
PROJECT NUMBER: BF 013-1(21)	DRAWN BY: MR
FILE NAME: r13b072zzz.dgn	CHECKED BY: JB
PROJECT LEADER: K. HIGGINS	SHEET 422 OF 444
DESIGNED BY: J. SALVATORI	
ROW LAYOUT SHEET	