

STEEL BEAM GUARDRAIL, GALVANIZED W 8/ POSTS  
 STA A 138+51 - STA A 147+87 RT  
 STA A 148+64 - STA A 152+32 LT  
 STA A 151+25 - STA A 151+44 RT

REMOVE AND DISPOSE OF GUARDRAIL  
 STA A 138+38 - STA A 148+00 RT  
 STA A 148+85 - STA A 152+40 LT  
 STA A 151+29 - STA A 151+56 RT

STEEL BEAM GUARDRAIL, GALVANIZED  
 STA A 147-87 - STA A 148+00 RT  
 STA A 148+51 - STA A 148+64 LT  
 STA A 151+12 - STA A 151+25 RT  
 STA A 151+44 - STA A 151+57 RT  
 STA A 152+32 - STA A 152+45 LT

ANCHOR FOR STEEL BEAM RAIL  
 STA A 147+91 RT  
 STA A 148+60 LT  
 STA A 151+21 RT  
 STA A 151+48 RT  
 STA A 152+36 LT

DELINEATOR WITH STEEL POSTS  
 STA A 148+00 RT  
 STA A 148+51 LT  
 STA A 151+12 RT  
 STA A 151+57 RT  
 STA A 152+45 LT

STONE FILL, TYPE I  
~~STA A 146+75 - STA A 146+50 RT~~  
~~STA A 145+41 - STA A 145+9 RT~~  
 RELOCATE MAILBOX, SINGLE SUPPORT  
 STA A 152+71 LT

GRUBBING MATERIAL  
 STA A 145+75 - STA A 146+25 RT

GEOTEXTILE FOR SILT FENCE  
 STA A 145+75 - STA A 146+50 RT

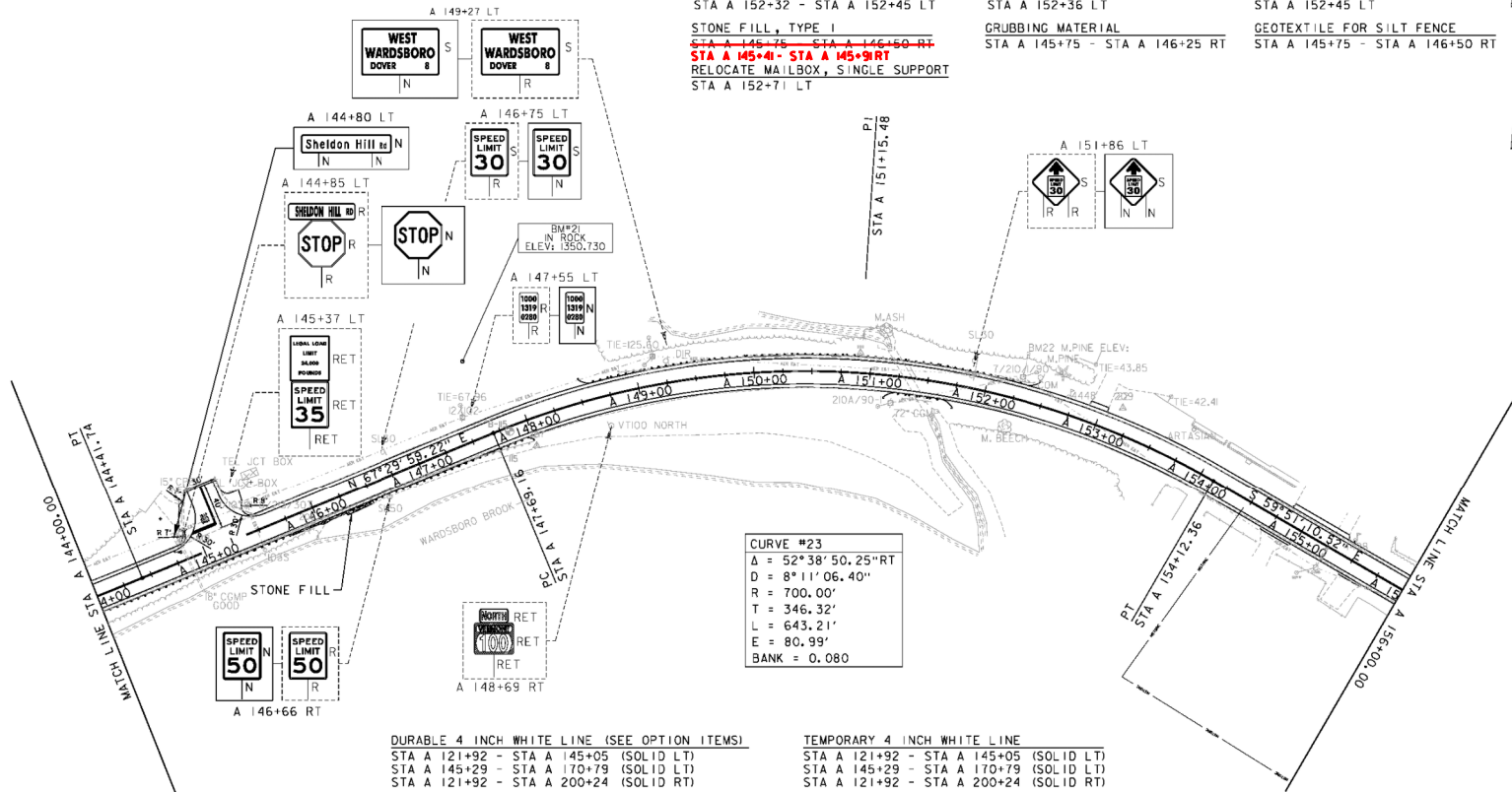
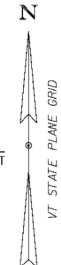

DURABLE 4 INCH WHITE LINE (SEE OPTION ITEMS)

STA A 121+92 - STA A 145+05 (SOLID LT)  
 STA A 145+29 - STA A 170+79 (SOLID LT)  
 STA A 121+92 - STA A 200+24 (SOLID RT)

TEMPORARY 4 INCH WHITE LINE

STA A 121+92 - STA A 145+05 (SOLID LT)  
 STA A 145+29 - STA A 170+79 (SOLID LT)  
 STA A 121+92 - STA A 200+24 (SOLID RT)

DURABLE 4 INCH YELLOW LINE (SEE OPTION ITEMS)

STA A 123+00 - STA A 144+97 (SOLID LT + RT)  
 STA A 145+17 LT (CENTERLINES TH #10)  
 STA A 145+38 - STA A 170+65 (SOLID LT + RT)

TEMPORARY 4 INCH YELLOW LINE

STA A 123+00 - STA A 144+97 (SOLID LT + RT)  
 STA A 145+17 LT (CENTERLINES TH #10)  
 STA A 145+38 - STA A 170+65 (SOLID LT + RT)

DURABLE LETTER OR SYMBOL (SEE OPTION ITEMS)

STA A 145+03 LT

DURABLE 24 INCH STOP BAR (SEE OPTION ITEMS)

STA A 145+03 LT

SIGN LEGEND

- R = REMOVE
- S = SALVAGE
- N = NEW
- RET = RETAIN
- T&T = THINNING & TRIMMING
- B-B = BACK TO BACK
- EXISTING = DASHED
- NEW = SOLID



PROJECT NAME:	WARDSBORO-JAMAICA
PROJECT NUMBER:	ER STP 013-1(17)
FILE NAME:	d2b236_bdr.dgn
PROJECT LEADER:	K. UPWAL
DESIGNED BY:	B. KIPP
PLAN SHEET 13	
PLAT DATE:	2/26/2014
DRAWN BY:	B. KIPP
CHECKED BY:	A. KEMPTON
SHEET	79 OF 444