

CONSTRUCT DRIVE (PAVED)
 VT II STA 13+25.00 - 13+75.00 RT
 COLD PLANING, BITUMINOUS PAVEMENT
 VTII STA 10+50.00 - 11+00.00
 VTII STA 13+25.00 - 13+75.00

4" YELLOW LINE
 VT II STA 10+50.00 - 13+75.00 LT/RT

4" WHITE LINE
 VT II STA 10+50.00 - 13+75.00 LT
 VT II STA 10+50.00 - 13+75.00 RT

STONE FILL, TYPE II
 VT II STA 11+40.00 - 11+88.00 RT
 VT II STA 11+45.00 - 11+88.00 LT
 VT II STA 12+33.83 - 12+58.50 RT
 VT II STA 12+33.83 - 12+44.00 LT

CAST-IN-PLACE CONCRETE CURB, TYPE B
 VT II STA 11+47.03 - 11+86.74 RT
 VT II STA 11+47.03 - 11+86.74 LT
 VT II STA 12+35.20 - 12+73.78 RT
 VT II STA 12+35.20 - 12+76.03 LT

BENCHMARK
 RR SPIKE IN POLE
 ELEV = 1073.34

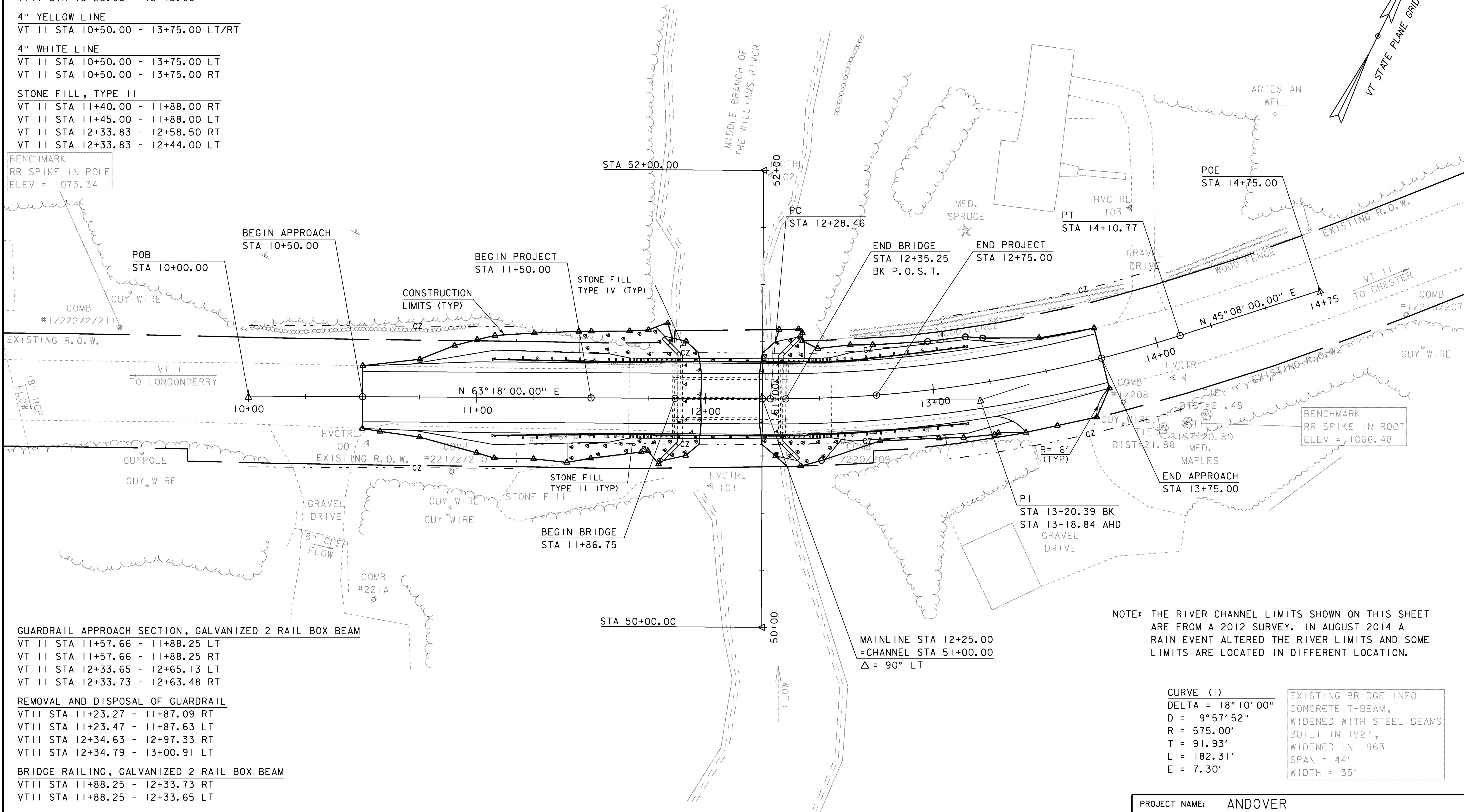
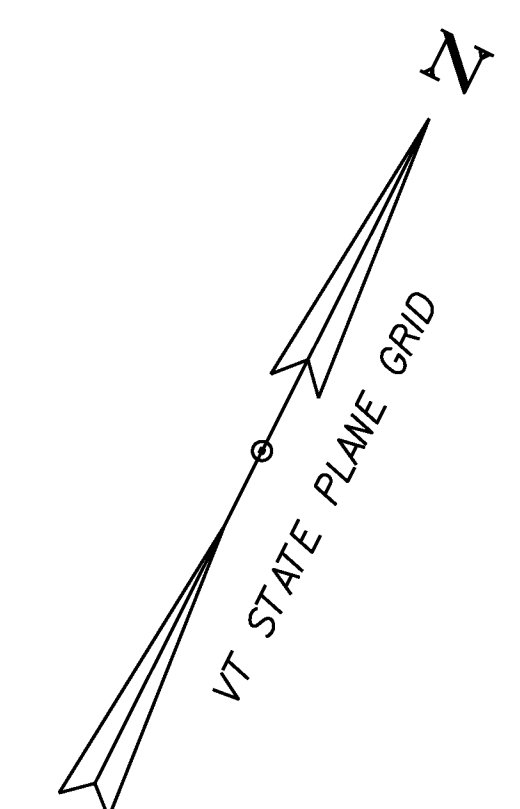

GUARDRAIL APPROACH SECTION, GALVANIZED 2 RAIL BOX BEAM
 VT II STA 11+57.66 - 11+88.25 LT
 VT II STA 11+57.66 - 11+88.25 RT
 VT II STA 12+33.65 - 12+65.13 LT
 VT II STA 12+33.73 - 12+63.48 RT

REMOVAL AND DISPOSAL OF GUARDRAIL
 VTII STA 11+23.27 - 11+87.09 RT
 VTII STA 11+23.47 - 11+87.63 LT
 VTII STA 12+34.63 - 12+97.33 RT
 VTII STA 12+34.79 - 13+00.91 LT

BRIDGE RAILING, GALVANIZED 2 RAIL BOX BEAM
 VTII STA 11+88.25 - 12+33.73 RT
 VTII STA 11+88.25 - 12+33.65 LT

MANUFACTURED TERMINAL SECTION, TANGENT
 VTII STA 11+07.67 - 11+57.66 RT
 VTII STA 11+07.67 - 11+57.66 LT
 VTII STA 12+63.48 - 13+12.15 RT
 VTII STA 12+65.13 - 13+16.55 LT

LAYOUT
 SCALE 1" = 20' - 0"
 20 0 20

NOTE: THE RIVER CHANNEL LIMITS SHOWN ON THIS SHEET ARE FROM A 2012 SURVEY. IN AUGUST 2014 A RAIN EVENT ALTERED THE RIVER LIMITS AND SOME LIMITS ARE LOCATED IN DIFFERENT LOCATION.

CURVE (1)
 DELTA = 18° 10' 00"
 D = 9° 57' 52"
 R = 575.00'
 T = 91.93'
 L = 182.31'
 E = 7.30'

EXISTING BRIDGE INFO
 CONCRETE T-BEAM,
 WIDENED WITH STEEL BEAMS
 BUILT IN 1927,
 WIDENED IN 1963
 SPAN = 44'
 WIDTH = 35'

PROJECT NAME: ANDOVER
 PROJECT NUMBER: BHF 016-1(29)
 FILE NAME: sl2bl40bdr_nul.dgn
 PROJECT LEADER: C. CARLSON
 DESIGNED BY: D. PETERSON
 LAYOUT
 PLOT DATE: 06-JAN-2015
 DRAWN BY: S. PIRO
 CHECKED BY: D. PETERSON
 SHEET II OF 48