

MD-5195
#5 BENT BAR
STAINLESS STEEL
USE 3/8" PIN
(42) REQ'D.

MD-5205
#5 BENT BAR
STAINLESS STEEL
USE 3/8" PIN
(28) REQ'D.

MD-5215
#5 BENT BAR
STAINLESS STEEL
USE 3/8" PIN
(8) REQ'D.

MD-5225
#5 BENT BAR
STAINLESS STEEL
USE 3/8" PIN
(4) REQ'D.

MD-5235
#5 BENT BAR
STAINLESS STEEL
USE 3/8" PIN
(2) REQ'D.

MD-5245
#5 BENT BAR
STAINLESS STEEL
USE 3/8" PIN
(4) REQ'D.

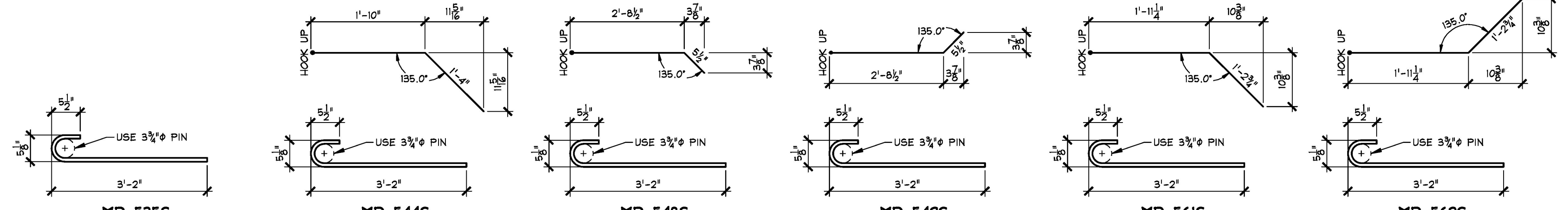

MD-5355
#5 BENT BAR (STD. HOOK)
STAINLESS STEEL
USE 3/8" PIN
(22) REQ'D.

MD-5445
#5 BENT BAR (STD. HOOK)
STAINLESS STEEL
USE 3/8" PIN
(8) REQ'D.

MD-5485
#5 BENT BAR (STD. HOOK)
STAINLESS STEEL
USE 3/8" PIN
(1) REQ'D.

MD-5495
#5 BENT BAR (STD. HOOK)
STAINLESS STEEL
USE 3/8" PIN
(1) REQ'D.

MD-5615
#5 BENT BAR (STD. HOOK)
STAINLESS STEEL
USE 3/8" PIN
(1) REQ'D.

MD-5625
#5 BENT BAR (STD. HOOK)
STAINLESS STEEL
USE 3/8" PIN
(1) REQ'D.

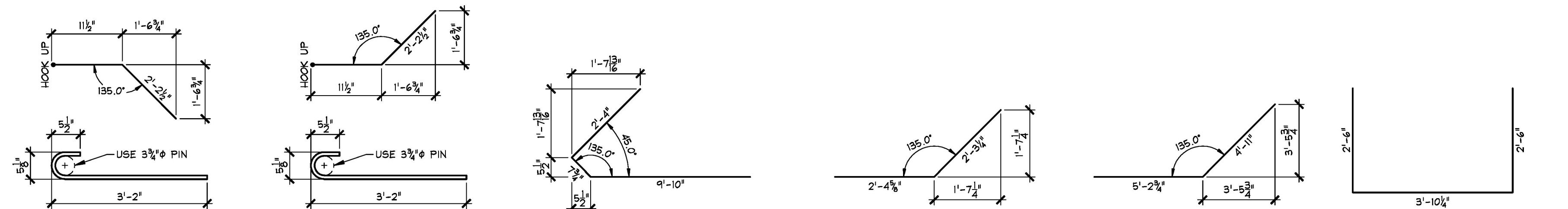

MD-5635
#5 BENT BAR (STD. HOOK)
STAINLESS STEEL
USE 3/8" PIN
(1) REQ'D.

MD-5645
#5 BENT BAR (STD. HOOK)
STAINLESS STEEL
USE 3/8" PIN
(1) REQ'D.

MD-5655
#5 BENT BAR
STAINLESS STEEL
USE 3/8" PIN
(16) REQ'D.

MD-5665
#5 BENT BAR
STAINLESS STEEL
USE 3/8" PIN
(16) REQ'D.

MD-5675
#5 BENT BAR
STAINLESS STEEL
USE 3/8" PIN
(2) REQ'D.

MD-5685
#5 BENT BAR
STAINLESS STEEL
USE 3/8" PIN
(11) REQ'D.

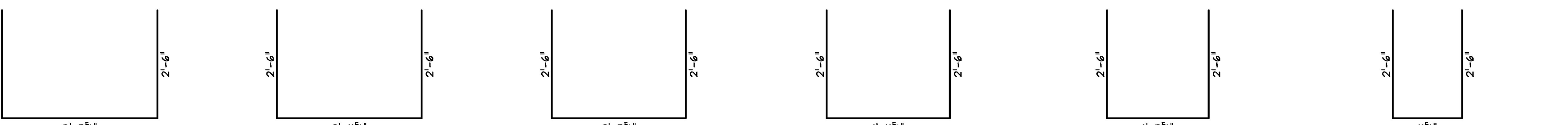

MD-5695
#5 BENT BAR
STAINLESS STEEL
USE 3/8" PIN
(1) REQ'D.

MD-5705
#5 BENT BAR
STAINLESS STEEL
USE 3/8" PIN
(1) REQ'D.

MD-5715
#5 BENT BAR
STAINLESS STEEL
USE 3/8" PIN
(1) REQ'D.

MD-5725
#5 BENT BAR
STAINLESS STEEL
USE 3/8" PIN
(1) REQ'D.

MD-5735
#5 BENT BAR
STAINLESS STEEL
USE 3/8" PIN
(1) REQ'D.

MD-5745
#5 BENT BAR
STAINLESS STEEL
USE 3/8" PIN
(1) REQ'D.

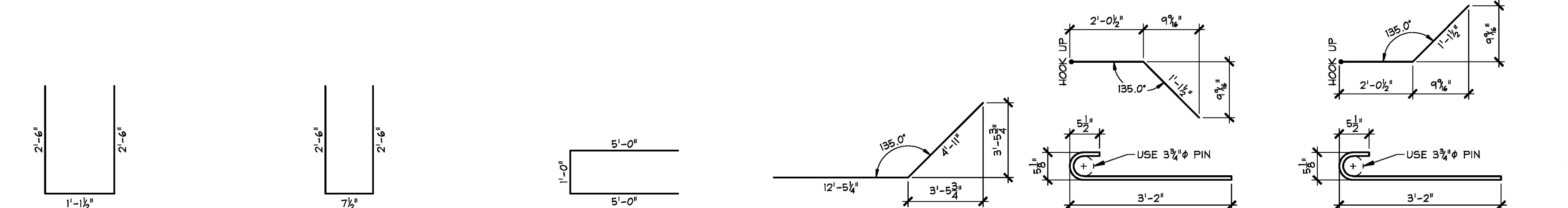

MD-5755
#5 BENT BAR
STAINLESS STEEL
USE 3/8" PIN
(1) REQ'D.

MD-5765
#5 BENT BAR
STAINLESS STEEL
USE 3/8" PIN
(1) REQ'D.

MD-5775
#5 BENT BAR
STAINLESS STEEL
USE 3/8" PIN
(22) REQ'D.

MD-5785
#5 BENT BAR
STAINLESS STEEL
USE 3/8" PIN
(12) REQ'D.

MD-5795
#5 BENT BAR (STD. HOOK)
STAINLESS STEEL
USE 3/8" PIN
(1) REQ'D.

MD-5805
#5 BENT BAR (STD. HOOK)
STAINLESS STEEL
USE 3/8" PIN
(1) REQ'D.



MD-5855
#5 BENT BAR
STAINLESS STEEL
USE 3/8" PIN
(8) REQ'D.

MD-5875
#5 BENT BAR
STAINLESS STEEL
USE 3/8" PIN
(2) REQ'D.

MD-5885
#5 BENT BAR
STAINLESS STEEL
USE 3/8" PIN
(10) REQ'D.

STRAIGHT BARS

ITEM	QTY.	DESCRIPTION	ITEM	QTY.	DESCRIPTION	ITEM	QTY.	DESCRIPTION
1	11	#5 x 16'-8 1/4" (STAINLESS STEEL)	21	2	#6 x 8'-0" (STAINLESS STEEL)	41	2	#6 x 5'-10" (STAINLESS STEEL)
2	11	#5 x 15'-9 3/4" (STAINLESS STEEL)	22	2	#6 x 7'-7" (STAINLESS STEEL)	42	2	#6 x 5'-5" (STAINLESS STEEL)
3	10	#5 x 9'-10 1/2" (STAINLESS STEEL)	23	2	#6 x 7'-2" (STAINLESS STEEL)	43	2	#6 x 4'-11" (STAINLESS STEEL)
4	10	#5 x 9'-10 1/2" (STAINLESS STEEL)	24	2	#6 x 6'-9" (STAINLESS STEEL)	44	2	#6 x 4'-6" (STAINLESS STEEL)
5	20	#5 x 5'-7 3/4" (STAINLESS STEEL)	25	5	#6 x 6'-4" (STAINLESS STEEL) (INCLUDES (1) FOR TESTING)	45	2	#6 x 4'-0" (STAINLESS STEEL)
6	52	#5 x 7'-9" (STAINLESS STEEL)	26	2	#6 x 5'-11" (STAINLESS STEEL)	46	2	#6 x 3'-6" (STAINLESS STEEL)
7	49	#5 x 9'-0" (STAINLESS STEEL)	27	2	#6 x 5'-11" (STAINLESS STEEL)	47	2	#6 x 3'-11" (STAINLESS STEEL)
8	20	#5 x 4'-0" (STAINLESS STEEL)	28	2	#6 x 5'-11" (STAINLESS STEEL)	48	2	#6 x 3'-1 1/2" (STAINLESS STEEL)
9	8	#5 x 9'-10" (STAINLESS STEEL)	29	2	#6 x 4'-8" (STAINLESS STEEL)	49		
10	14	#5 x 13'-3" (STAINLESS STEEL)	30	2	#6 x 4'-3" (STAINLESS STEEL)	50		
11		#5 x 13'-3" (STAINLESS STEEL)	31	2	#6 x 3'-10" (STAINLESS STEEL)	51		
12		#5 x 13'-3" (STAINLESS STEEL)	32	2	#6 x 3'-5" (STAINLESS STEEL)	52		
13		#5 x 13'-3" (STAINLESS STEEL)	33	2	#6 x 3'-0" (STAINLESS STEEL)	53		
14		#5 x 13'-3" (STAINLESS STEEL)	34		#6 x 3'-0" (STAINLESS STEEL)	54		
15		#5 x 13'-3" (STAINLESS STEEL)	35		#6 x 3'-0" (STAINLESS STEEL)	55		
16		#5 x 13'-3" (STAINLESS STEEL)	36	2	#6 x 8'-8" (STAINLESS STEEL)	56		
17		#5 x 9'-0" (STAINLESS STEEL)	37	2	#6 x 8'-2" (STAINLESS STEEL)	57		
18		#5 x 9'-10" (STAINLESS STEEL)	38	2	#6 x 7'-9" (STAINLESS STEEL)	58		
19		#5 x 9'-10" (STAINLESS STEEL)	39	2	#6 x 7'-3" (STAINLESS STEEL)	59		
20	4	#6 x 8'-5" (STAINLESS STEEL)	40	2	#6 x 6'-10" (STAINLESS STEEL)	60		

MISCELLANEOUS MATERIALS

ITEM	MARK	QTY.	DESCRIPTION	REMARKS
1		1	BRIDGE PLAQUE	SUPPLIED BY OTHERS
2		2	4" I.D. x 9'-6" PVC SLEEVE	
3		2	4" I.D. x 8'-3" PVC SLEEVE	
4		2	4" I.D. x 2'-6" PVC SLEEVE	
5				
6		8	8T x 10' SWIFT LIFT LIFTER (GALV.)	DOMESTIC ORIGIN (BUY AMERICAN)
7		4	20T x 19 3/4' SWIFT LIFT LIFTER (GALV.)	DOMESTIC ORIGIN (BUY AMERICAN)
8	MK-MD12	2	SET OF (3) 0.60" STRAND LIFTING LOOPS	SEE DETAIL THIS SHEET
9	MK-MD13	2	SET OF (3) 0.60" STRAND LIFTING LOOPS	SEE DETAIL THIS SHEET
10				

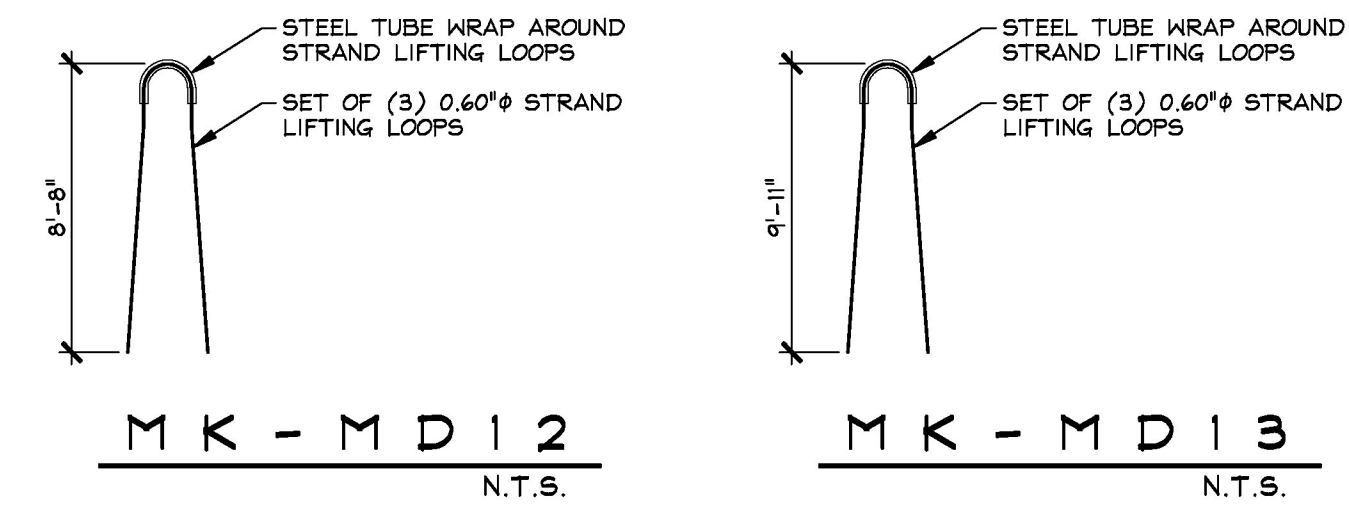

MK-MD12
N.T.S.

MK-MD13
N.T.S.

5-10-16 REVISED AS NOTED

APPROVAL STAMP:	J.P. CARRARA & SONS INC. Precast & Prestress Manufacturer 2484 CASE STR., MONTGOMERY, VERMONT 05753 Phone: (802)388-6361 Fax: (802)388-8010	A.L. ST. ONGE CONTRACTOR, INC. CONTRACTOR MONTGOMERY, VERMONT
	STATE OF VERMONT AGENCY OF TRANSPORTATION COUNTY OF WINDSOR	
	DATE: JAN. 12, 2016 SCALE: NOTED	
	CHKD: - DFTM: B.L. JOB NO: 23480-016	
TOWN OF WAITSFIELD VT ROUTE 100 (MINOR ARTERIAL) BRIDGE NO.: 177 PROJECT NO.: BRP 013-4(39)		
PRECAST WING WALLS MATERIALS LIST		
		DWG. NO: M4

Vermont Agency of Transportation
RECEIVED
ON: **May 10, 2016**
and Checked for
CONFORMANCE
BY: Rob Young DATE: 05/16/2016

Approved _____ X Approved As Noted _____
Noted _____

This review is only for general conformance with the design concept and the information given in the Construction Documents. Construction of concrete made on the shop drawings during the review does not release the Contractor from compliance with the requirements of the Plans and Specifications. Review of a specific item shall not include the entire item.

For dimensions to be confirmed and corrected at the job site, information that permits safety or the fabrication process or the design, including, but not limited to, sequence and positions of construction; coordination of the Work with that of other trades and performing all Work in a safe and satisfactory manner.

Date: 5/13/2016
By: D. Kell
McFarland Johnson

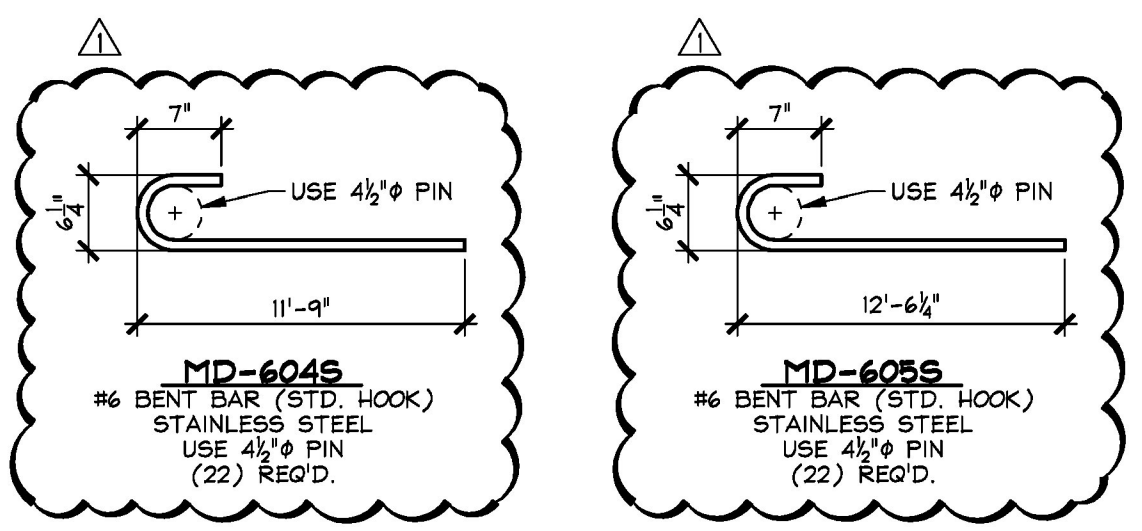

MD-6045
#6 BENT BAR (STD. HOOK)
STAINLESS STEEL
USE 4 1/2" PIN
(22) REQ'D.

MD-6055
#6 BENT BAR (STD. HOOK)
STAINLESS STEEL
USE 4 1/2" PIN
(22) REQ'D.