

SECTION A-A

LOCATION	RAD	CHD	AA	A1	A2	A3	A4	A8	PL PA (M270-50WT2)
1G1A TOP FLG	622.12	54'-0	54'-0 ³ / ₁₆	7	6 ⁹ / ₁₆	5 ¹ / ₄	3 ¹ / ₁₆	6'-9	PL 1 ¹ / ₈ x 20-ta (2/A)
1G1A BTM FLG	622.12	53'-10 ¹ / ₈	53'-10 ³ / ₈	7	6 ⁹ / ₁₆	5 ¹ / ₄	3 ¹ / ₁₆	6'-9 ³ / ₄	PL 1 ¹ / ₈ x 20-ba (2/A)
2G2A TOP FLG	629.37	54'-7 ³ / ₈	54'-7 ⁹ / ₁₆	7 ¹ / ₈	6 ¹¹ / ₁₆	5 ⁵ / ₁₆	3 ¹ / ₈	6'-9 ¹⁵ / ₁₆	PL 1 ¹ / ₈ x 20-ta (1/U)
2G2A BTM FLG	629.37	54'-5 ⁵ / ₈	54'-5 ¹³ / ₁₆	7 ¹ / ₁₆	6 ⁵ / ₈	5 ⁵ / ₁₆	3 ¹ / ₁₆	6'-9 ¹¹ / ₁₆	PL 1 ¹ / ₈ x 20-ba (1/U)
3G3A TOP FLG	636.62	55'-2 ¹³ / ₁₆	55'-3	7 ³ / ₁₆	6 ³ / ₄	5 ³ / ₈	3 ¹ / ₈	6'-10 ⁷ / ₈	PL 1 ¹ / ₈ x 20-ta (1/O)
3G3A BTM FLG	636.62	55'-1	55'-1 ¹ / ₄	7 ¹ / ₈	6 ¹¹ / ₁₆	5 ³ / ₈	3 ¹ / ₈	6'-10 ⁵ / ₈	PL 1 ¹ / ₈ x 20-ba (1/O)
4G4A TOP FLG	643.87	55'-10 ³ / ₁₆	55'-10 ⁷ / ₁₆	7 ¹ / ₄	6 ¹³ / ₁₆	5 ⁷ / ₁₆	3 ³ / ₁₆	6'-11 ³ / ₄	PL 1 ¹ / ₈ x 20-ta (1/N)
4G4A BTM FLG	643.87	55'-8 ¹ / ₂	55'-8 ¹¹ / ₁₆	7 ¹ / ₄	6 ³ / ₄	5 ⁷ / ₁₆	3 ³ / ₁₆	6'-11 ⁹ / ₁₆	PL 1 ¹ / ₈ x 20-ba (1/N)
5G5A TOP FLG	651.12	56'-5 ⁵ / ₈	56'-5 ¹³ / ₁₆	7 ³ / ₈	6 ⁷ / ₈	5 ¹ / ₂	3 ³ / ₁₆	7'-0 ¹¹ / ₁₆	PL 1 ¹ / ₈ x 20-ta (1/J)
5G5A BTM FLG	651.12	56'-3 ¹⁵ / ₁₆	56'-4 ³ / ₁₆	7 ⁵ / ₁₆	6 ⁷ / ₈	5 ¹ / ₂	3 ³ / ₁₆	7'-0 ¹ / ₂	PL 1 ¹ / ₈ x 20-ba (1/J)

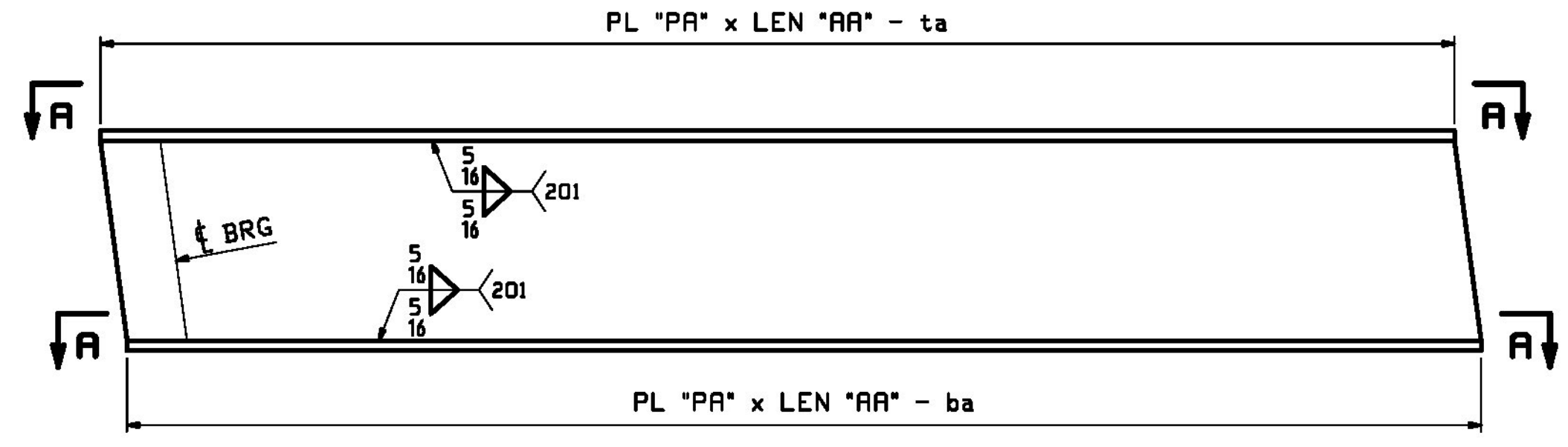

FLANGE DIAGRAMS FOR 1G1A THRU 5G5A

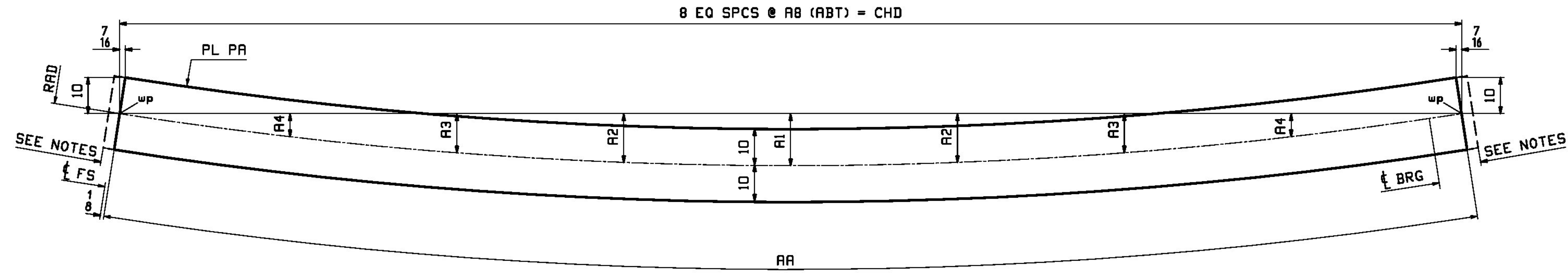

SECTION B-B

LOCATION	RAD	CHD	AA	A1	A2	A3	A4	A8	PL PA (M270-50WT2)
11G1C TOP FLG	622.12	53'-8 ³ / ₄	53'-8 ¹⁵ / ₁₆	6 ¹⁵ / ₁₆	6 ¹ / ₂	5 ¹ / ₄	3 ¹ / ₁₆	6'-8 ⁵ / ₈	PL 1 ¹ / ₈ x 20-ta (2/C)
11G1C BTM FLG	622.12	53'-9 ¹⁵ / ₁₆	53'-10 ¹ / ₈	7	6 ⁹ / ₁₆	5 ¹ / ₄	3 ¹ / ₁₆	6'-8 ³ / ₄	PL 1 ¹ / ₈ x 20-ba (2/A)
12G2C TOP FLG	629.37	54'-4 ¹ / ₄	54'-4 ⁷ / ₁₆	7 ¹ / ₁₆	6 ⁵ / ₈	5 ⁵ / ₁₆	3 ¹ / ₁₆	6'-9 ⁹ / ₁₆	PL 1 ¹ / ₈ x 20-ta (1/W)
12G2C BTM FLG	629.37	54'-3 ³ / ₈	54'-5 ⁵ / ₈	7 ¹ / ₁₆	6 ⁵ / ₈	5 ⁵ / ₁₆	3 ¹ / ₁₆	6'-9 ¹¹ / ₁₆	PL 1 ¹ / ₈ x 20-ba (1/U)
13G3C TOP FLG	636.62	54'-11 ¹¹ / ₁₆	54'-11 ¹⁵ / ₁₆	7 ¹ / ₈	6 ¹¹ / ₁₆	5 ⁵ / ₁₆	3 ¹ / ₈	6'-10 ⁷ / ₈	PL 1 ¹ / ₈ x 20-ta (1/S)
13G3C BTM FLG	636.62	55'-0 ⁷ / ₈	55'-1 ¹ / ₁₆	7 ¹ / ₈	6 ¹¹ / ₁₆	5 ³ / ₈	3 ¹ / ₈	6'-10 ⁵ / ₈	PL 1 ¹ / ₈ x 20-ba (1/O)
14G4C TOP FLG	643.87	55'-7 ³ / ₁₆	55'-7 ³ / ₈	7 ³ / ₁₆	6 ³ / ₄	5 ³ / ₈	3 ¹ / ₈	6'-11 ³ / ₈	PL 1 ¹ / ₈ x 20-ta (1/N)
14G4C BTM FLG	643.87	55'-8 ³ / ₈	55'-8 ⁹ / ₁₆	7 ¹ / ₄	6 ³ / ₄	5 ⁷ / ₁₆	3 ³ / ₁₆	6'-11 ⁹ / ₁₆	PL 1 ¹ / ₈ x 20-ba (1/N)
15G5C TOP FLG	651.12	56'-2 ¹¹ / ₁₆	56'-2 ⁷ / ₈	7 ⁵ / ₁₆	6 ¹³ / ₁₆	5 ⁷ / ₁₆	3 ³ / ₁₆	7'-0 ⁵ / ₁₆	PL 1 ¹ / ₈ x 20-ta (1/L)
15G5C BTM FLG	651.12	56'-3 ³ / ₄	56'-4	7 ⁵ / ₁₆	6 ⁷ / ₈	5 ¹ / ₂	3 ³ / ₁₆	7'-0 ¹ / ₂	PL 1 ¹ / ₈ x 20-ba (1/J)

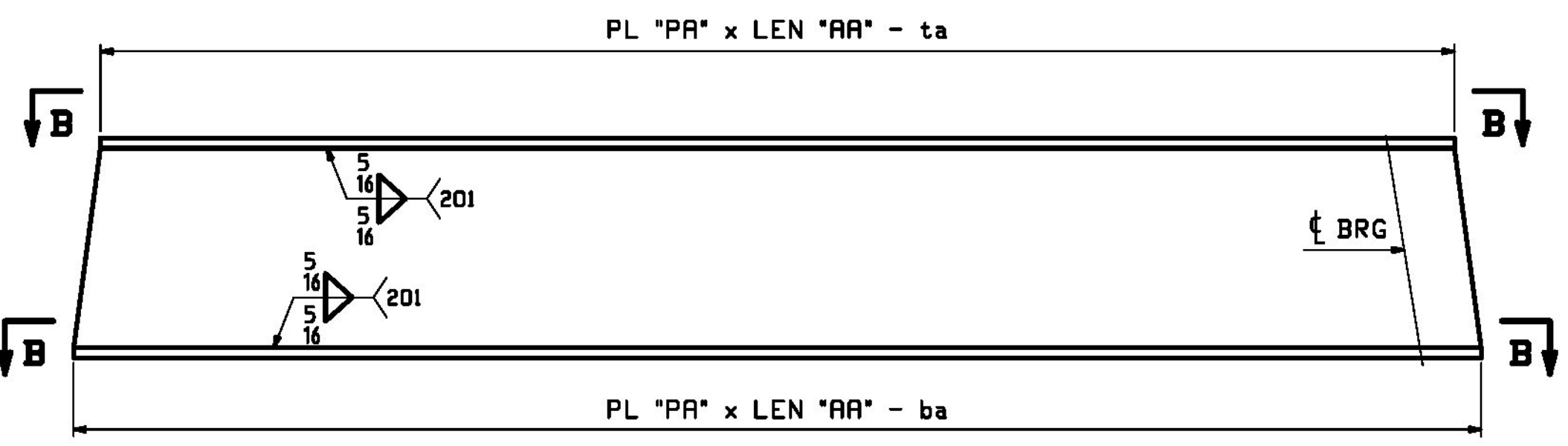

FLANGE DIAGRAMS FOR 11G1C THRU 15G5C

Vermont Agency of Transportation
RECEIVED
10-5-17_713_Shop_Drawings_REV2.pdf
 CK'D BY CLB OK'D BY CWC
October 5, 2017
 RESUBMIT NO Approved
 BY C. CARLSON DATE 10/05/17

- NOTES:
 1. FOR GENERAL NOTES SEE DRAWING GNI.
 2. T2 DENOTES MATERIAL SUBJECT TO CHARPY V-NOTCH TEST AT H FREQ. FOR ZONE 2
 3. TRIM FLANGES AFTER ASSEMBLY.

REV.	DATE	REMARKS	DWN	CHK	APVL	SHOP
0						
MATERIAL:		SURFACE PREP. & PAINT:		HOLES:		SHOP BOLTS:
M270-50WT2		SEE DWG GNI				
DESCRIPTION: FLANGE DIAGRAMS						
STRUCTURE: VT RTE 15A OVER LAMOILLE RIVER ROUTE No. VT 15A, MAJOR COLLECTOR BRIDGE No. 1 COUNTY OF LAMOILLE			DRAWN: JTB DATE: 08/01		DATE: 08/30	
LOCATION: MORRISTOWN, VT			JOB NO. 713		DWG NO. F1	
PROJ NO. BRS-0240(3)S & STP HES 030-2(28)			REV. 1		REV. 1	
CUSTOMER: STATE OF VERMONT R.O.T.						

CASCO BAY STEEL STRUCTURES, INC.
 1 WALLACE AVE. PHONE (207) 780-6722
 SOUTH PORTLAND, ME 04106 FAX. (207) 780-6726

173 F1.dwg, 1.001, 08/08/17, 11:00 AM, C:\Users\jcarlson\OneDrive\Documents\173.dwg