

REMOVAL AND DISPOSAL OF GUARDRAIL
STA. 203+00.00 OFFSET 19.35' RT - STA. 206+69.06 OFFSET 39.08' RT

HD STEEL BEAM GUARDRAIL, GALVANIZED W/ 8 FEET POSTS
STA. 203+00.00 - STA. 206+16.24 RT

COLD PLANING, BITUMINOUS PAVEMENT
STA. 203+00.00 - STA. 203+50.00

MANUFACTURED TERMINAL SECTION, TANGENT
STA. 208+80.68 - STA. 209+00.00 LT
STA. 206+16.24 - STA. 206+65.17 RT

CONSTRUCT DRIVE (PAVED)
STA. 208+21.00 LT (12'-0" WIDE) (25'-9" LENGTH)

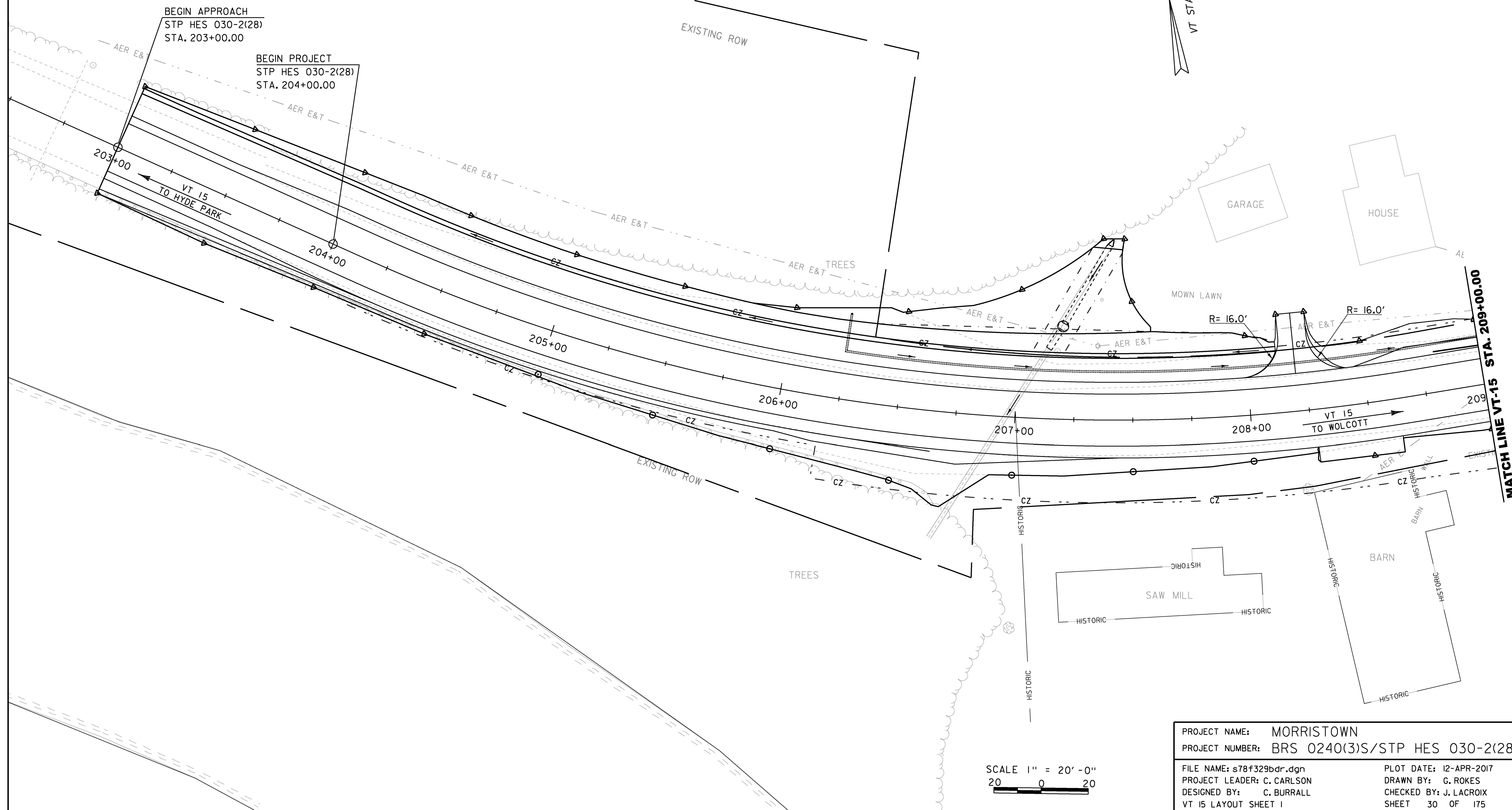
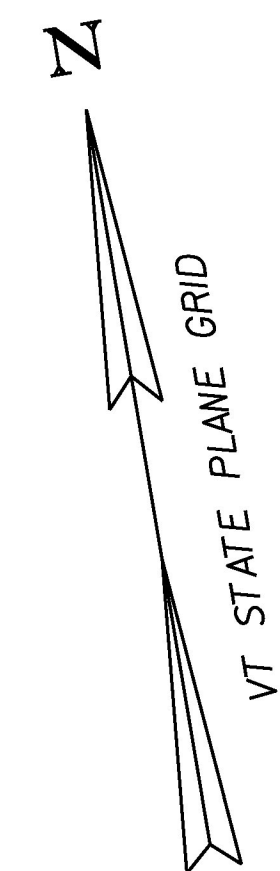

BEGIN APPROACH
STP HES 030-2(28)
STA. 203+00.00

BEGIN PROJECT
STP HES 030-2(28)
STA. 204+00.00

SCALE 1" = 20'-0"
20 0 20

PROJECT NAME:	MORRISTOWN
PROJECT NUMBER:	BRS 0240(3)S/STP HES 030-2(28)
FILE NAME:	s78f329bdr.dgn
PROJECT LEADER:	C. CARLSON
DESIGNED BY:	C. BURRALL
VT 15 LAYOUT SHEET I	
PLOT DATE:	12-APR-2017
DRAWN BY:	G. ROKES
CHECKED BY:	J. LACROIX
SHEET	30 OF 175