

NOTE:

A SOLID LINE IN THE DIRECTION OF TRAVEL BEGINS AT A LOCATION 400 FEET MIN. IN ADVANCE OF THE BEGIN TAPER FOR THE PAVEMENT WIDTH TRANSITION. PASSING ZONE SHOWN FOR REFERENCE ONLY, ACTUAL MARKINGS BASED ON FIELD CONDITIONS.

$L = \frac{WS^2}{60}$ WHEN S = 40 MPH OR LESS
 $L = WS$ WHEN S = 45 MPH OR GREATER

EDGELINES SHALL BE 1' - 0" MIN. FROM CURB

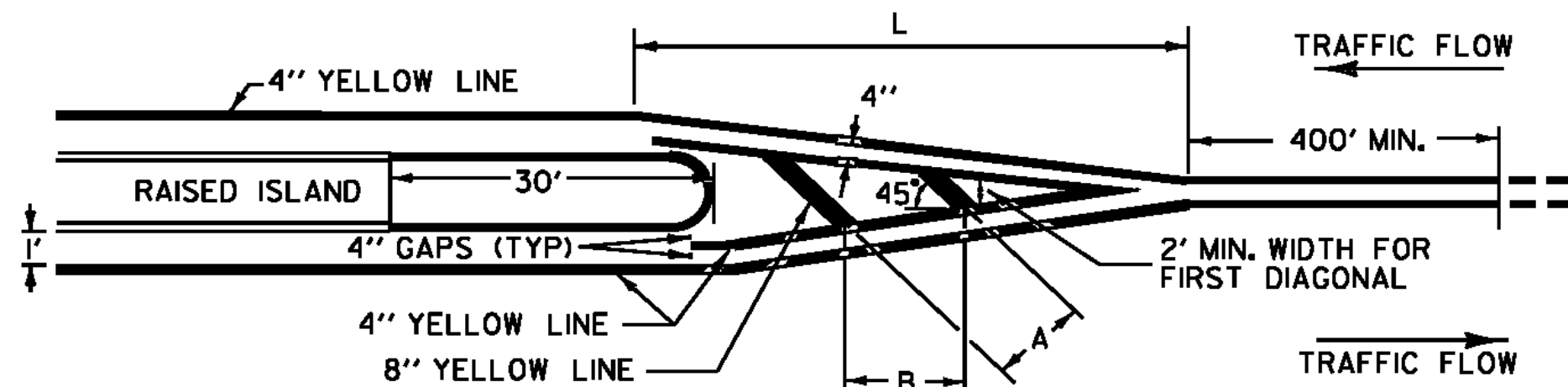

RAISED ISLAND APPROACH MARKINGS

DIMENSIONS		CONDITIONS FOR USE	
A	B		
5'	7'	LOW SPEED OR HIGH SPEED/W POOR SIGHT DISTANCE, <200'	WHERE LENGTH OF DIAGONAL AREA IS 75' MAX.
10'	14'	HIGH SPEED AND GOOD SIGHT DISTANCE, ≥200'	WHERE LENGTH OF DIAGONAL AREA EXCEEDS 75'

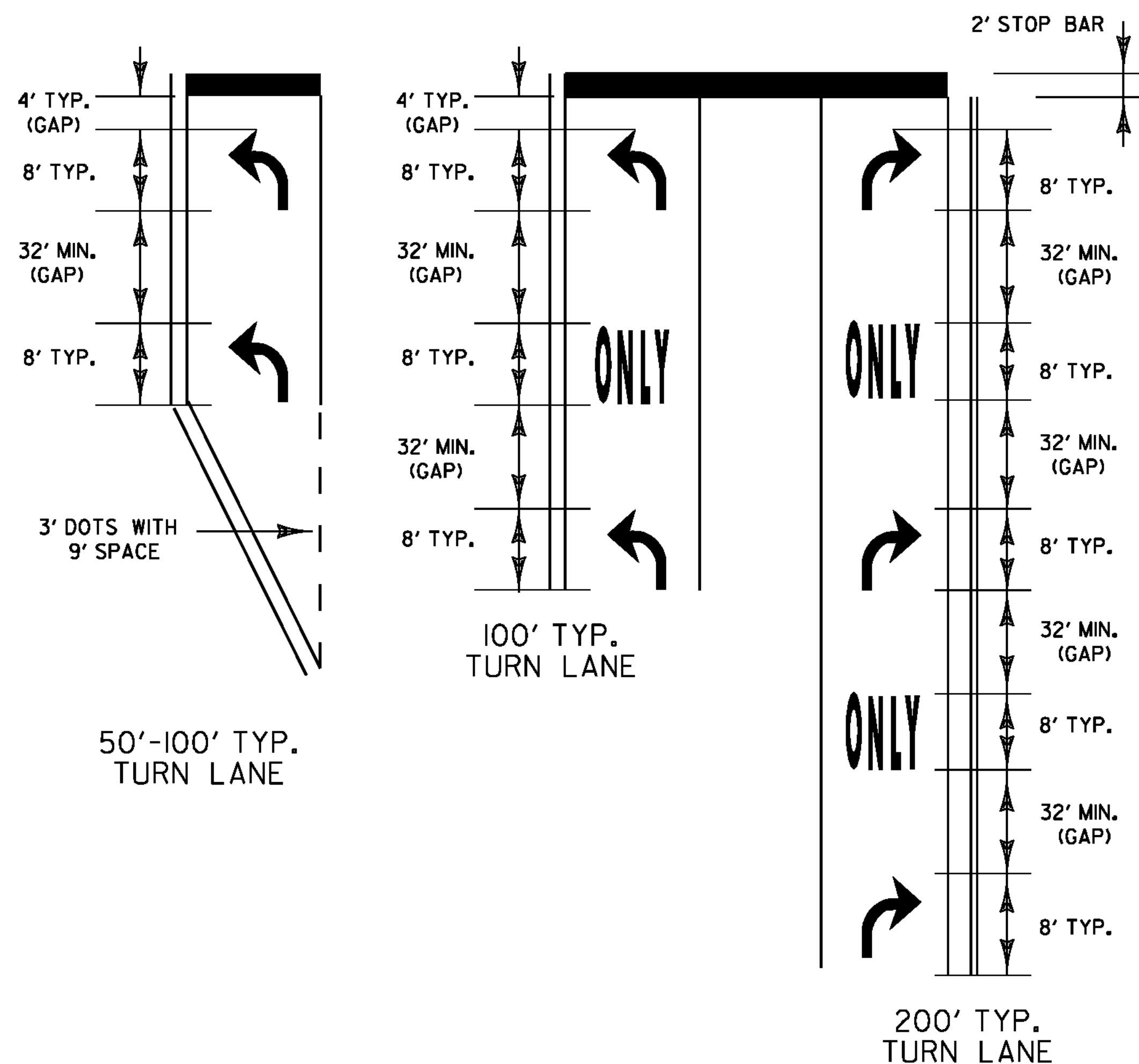

50'-100' TYP. TURN LANE

200' TYP. TURN LANE

TURN ARROWS SHALL BE PLACED AT THE BEGIN AND END OF THE LEFT OR RIGHT TURN LANE.

IF LANE LENGTH IS LESS THAN 100', TURN ARROWS SHOULD BE PLACED AT THE BEGINNING AND END OF THE LEFT OR RIGHT TURN LANE.

THE "ONLY" WORD MARKINGS SHALL BE USED TO SUPPLEMENT LANE-USE ARROW MARKINGS FOR TURN LANES 100' OR LONGER.

MORE ARROWS AND ONLY'S ARE OPTIONAL WHEN SPACE PERMITS. ARROW MARKINGS START AT THE BEGINNING OF THE SOLID LANE LINE.

STOP BARS ARE INSTALLED ONLY WHERE A STOP SIGN OR TRAFFIC SIGNAL ARE LOCATED. STOP LETTERS ARE OPTIONAL. IF INSTALLED THEY SHALL BE 4' FROM THE STOP BAR.

THE LONGITUDINAL SPACE BETWEEN WORD OR SYMBOL MESSAGE MARKINGS, SHOULD BE AT LEAST FOUR TIMES THE HEIGHT OF THE CHARACTERS FOR LOW SPEED ROADS, BUT NOT MORE THAN TEN TIMES THE HEIGHT OF THE CHARACTERS UNDER ANY CONDITIONS.

EXCLUSIVE TURN LANES (LEFT OR RIGHT), LANE LINES SHALL BE SOLID AND EXTEND BACK FROM THE STOP LINE TO THE POINT OF FULL LANE WIDTH OF THE TURN LANE. 3' DOTS WITH A 9' SPACE SHOULD BE EXTENDED THE FULL LENGTH OF THE LANE TAPER.

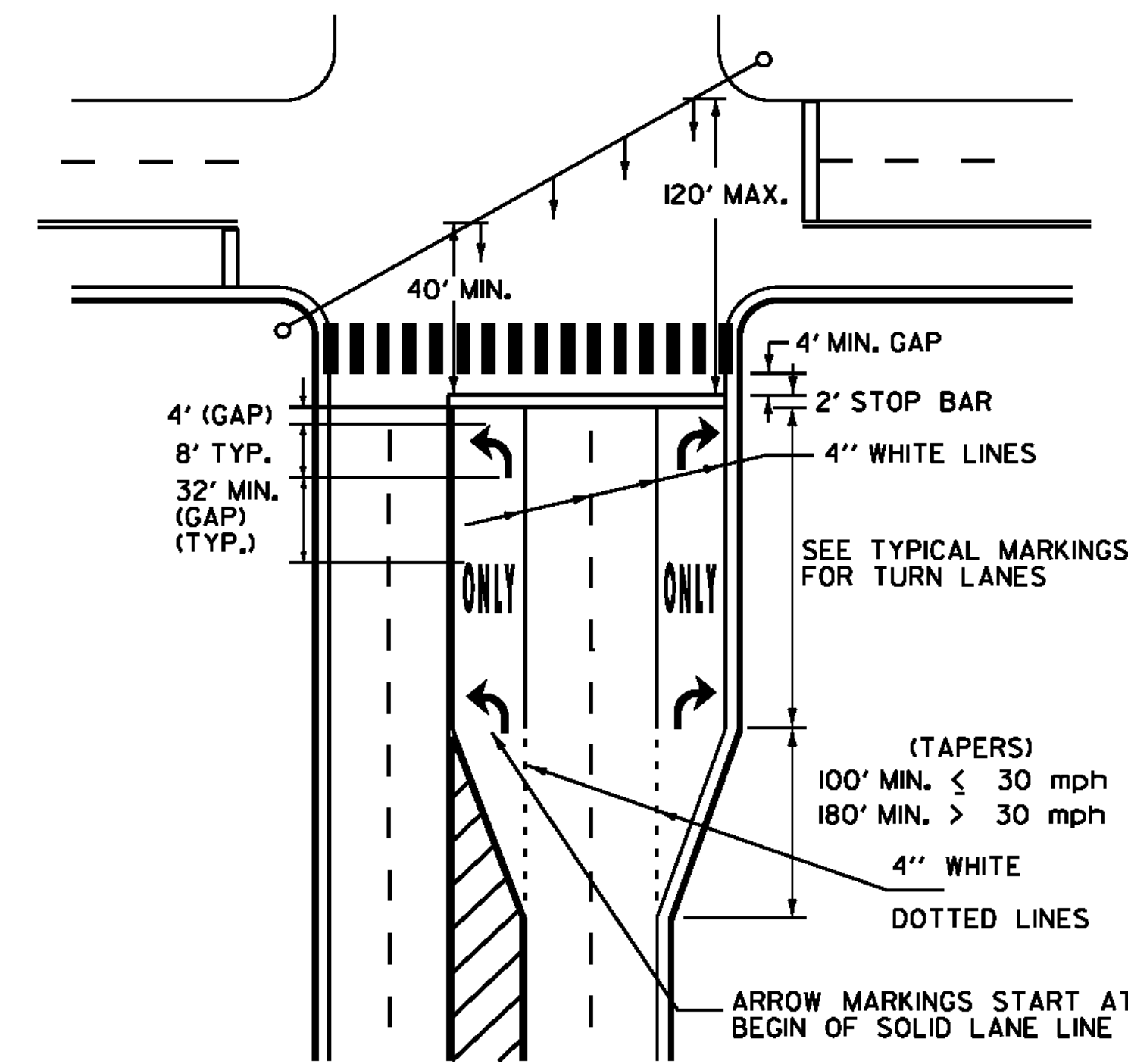

TYPICAL MARKINGS FOR SIGNALIZED INTERSECTION

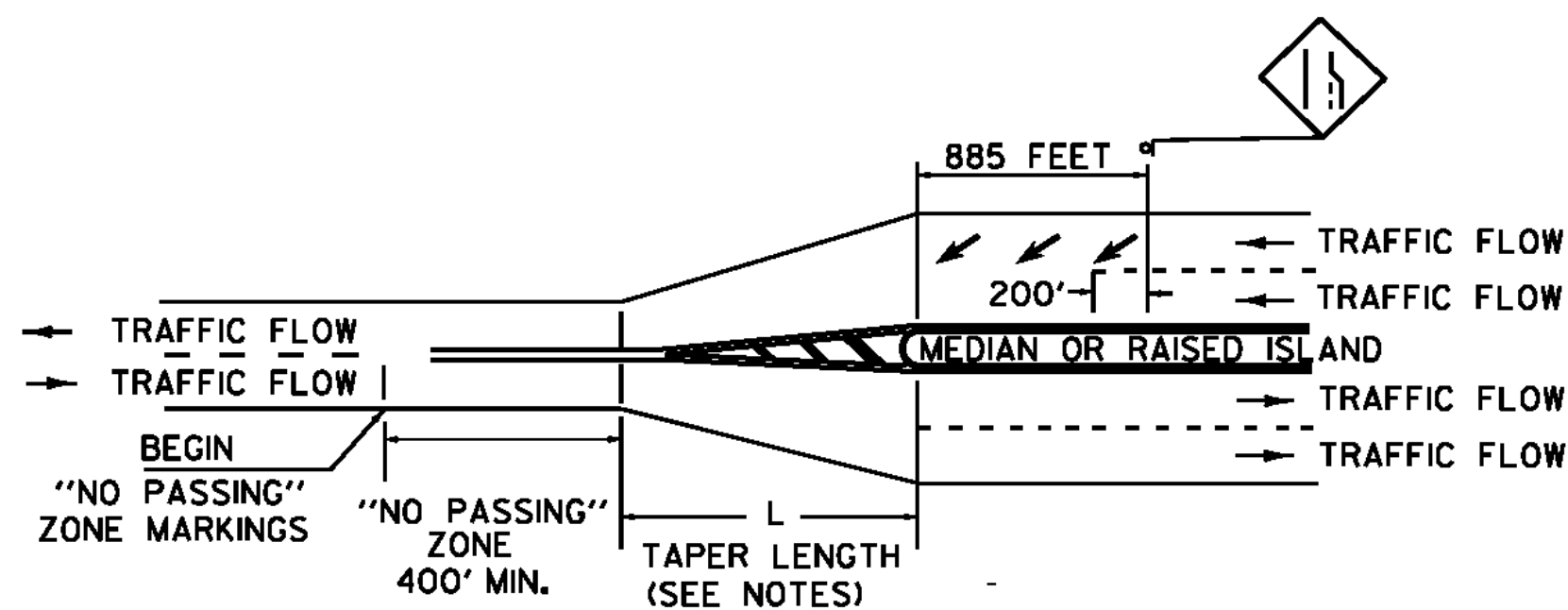

"NO PASSING" ZONE LAYOUT IN PAVEMENT WIDTH TRANSITIONS, TWO LANE HIGHWAY TO DIVIDED HIGHWAY

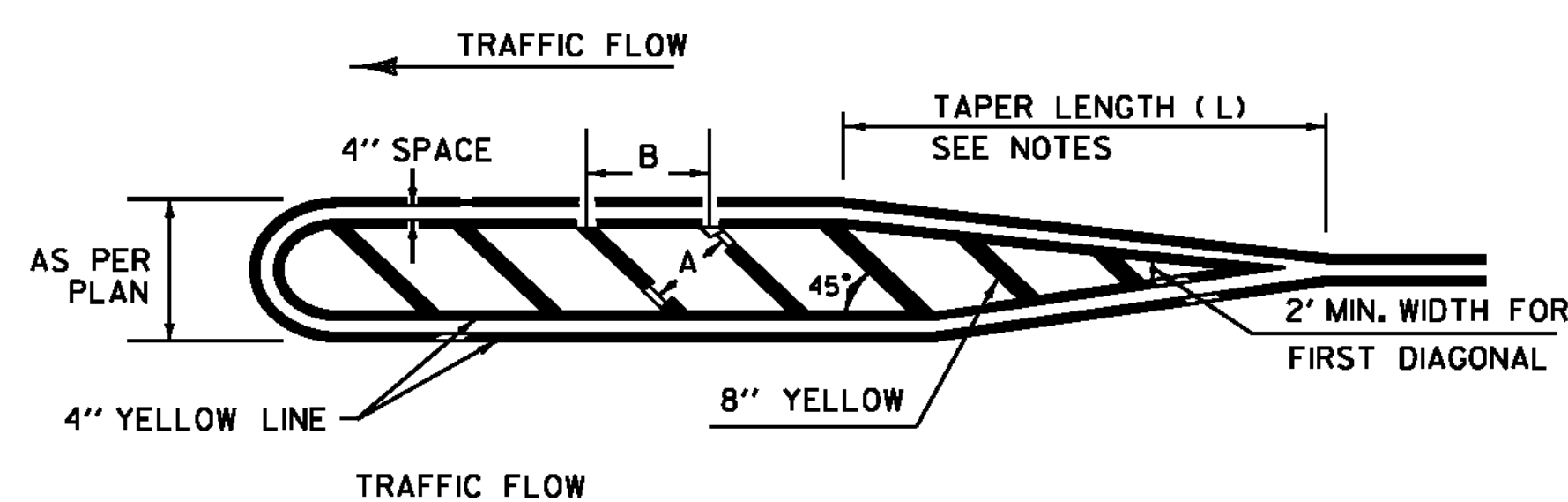

MEDIAN ISLAND DETAIL

TYPICAL MARKINGS FOR TURN LANES

NOT TO SCALE

PAVEMENT MARKING DETAILS

PAVEMENT MARKING DETAILS SHEET 3

PROJECT NAME: STATEWIDE	PLOT DATE: 12-MAR-2012
PROJECT NO.: NHG MARK (206)	DRAWN BY: KAS
DESIGN FILE NAME: I2b002.dgn	SHEET: 18 OF 20
PROJECT MANAGER: A GAMBLE	
IPARM FILE NAME: I2b002pm3.I	