

**REMOVE EXISTING SIDEWALK
(SOLID ROCK EXCAVATION)**

SITE 1 - 46.22 SY
 SITE 2 (L) - 41.50 SY
 SITE 2 (R) - 39.76 SY

**PRECAST REINFORCED
CONCRETE CURB, TYPE B**

SITE 1 - 57 LF
 SITE 2 (L) - 54 LF
 SITE 2 (R) - 54 LF

REMOVAL OF EXISTING CURB

SITE 1 - PINE STREET - 9 LF
 SITE 1 - WEST ST - 25 LF
 SITE 2 - WEST ST - 10 LF
 SITE 2 - WEST ST - 12 LF
 SITE 2 - EVELYN ST - 16 LF

**PORTLAND CEMENT CONCRETE
SIDEWALK, 5 INCH**

SITE 1 - 46.23 SY
 SITE 2 (L) - 42.42 SY
 SITE 2 (R) - 39.76 SY

**5 INCH SIDEWALK RAMP WITH
DETECTABLE WARNING SURFACE**

SITE 1 - 31 SF
 SITE 2 (L) - 30 SF
 SITE 2 (R) - 20 SF

DURABLE 24 INCH STOP BAR

SITE 2 - 22 LF

DURABLE CROSSWALK MARKING
 SITE 2 - 38 LF

REMOVAL OF EXISTING PAVEMENT MARKINGS
 SITE 2 - 331 SF

**SPECIAL PROVISION (INLET PROTECTION,
GEOTEXTILE FABRIC)**
 SITE 1 - 1 EACH
 SITE 2 - 2 EACH

**SPECIAL PROVISION (HAND-PLACED
BITUMINOUS CONCRETE MATERIAL, DRIVES)**
 SITE 1 - 4.08 SY

APPROXIMATE EDGE OF SIDEWALK

APPROXIMATE EDGE OF PAVEMENT

TO PINE STREET

WEST STREET
 CLASS 2 TOWN/HIGHWAY

TO GROVE STREET

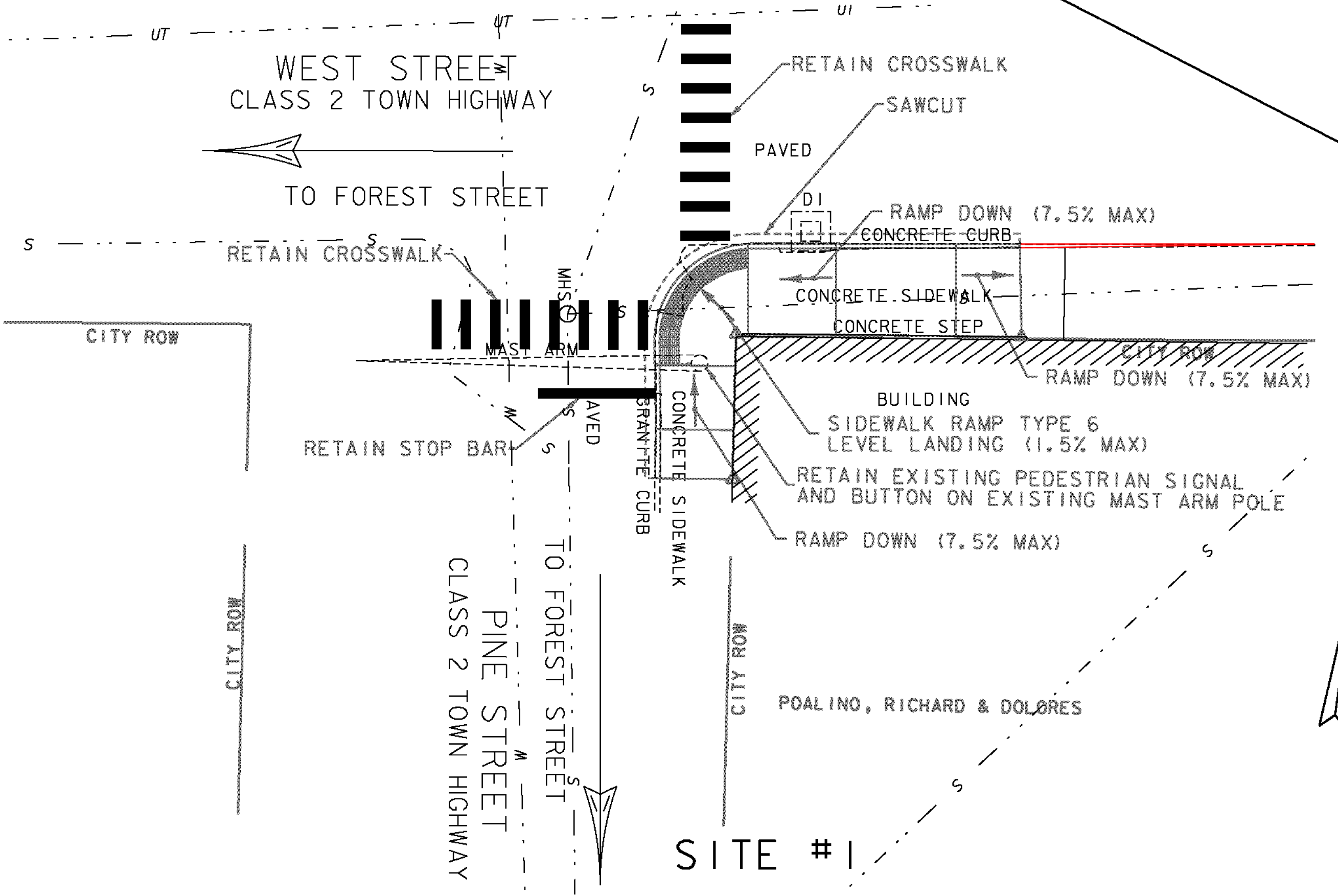
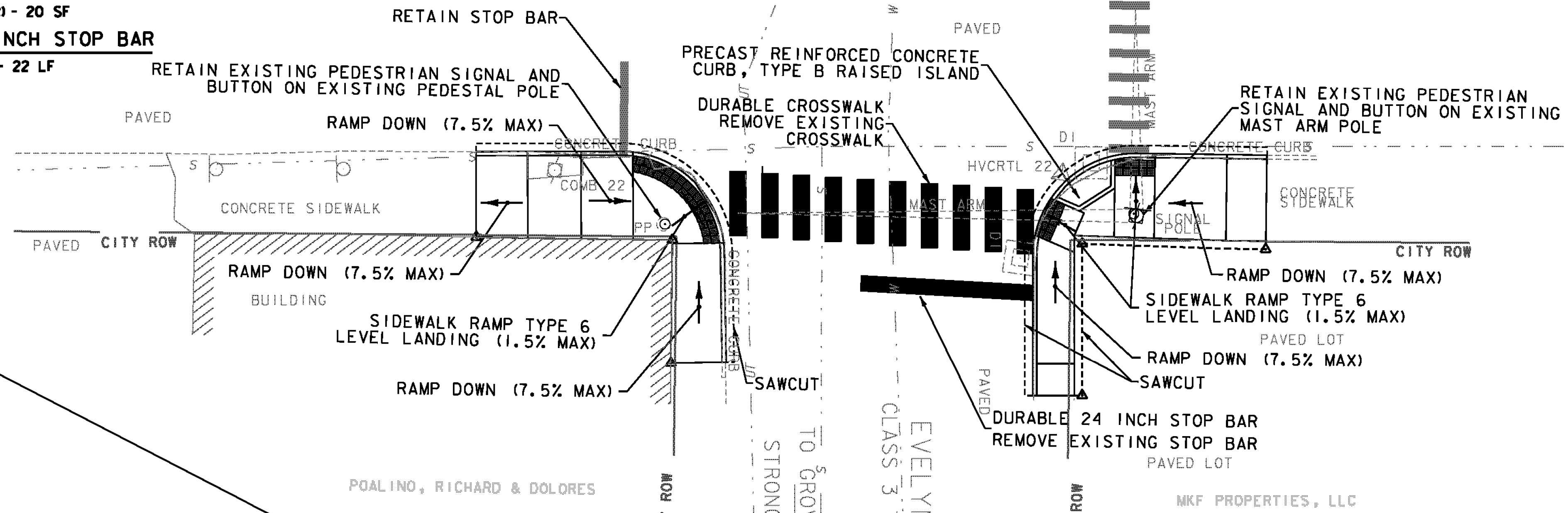

NOTE: GREEN MOUNTAIN POWER HAS TWO UNDERGROUND CONDUITS IN THE VICINITY OF THE POST OFFICE AND ADDITIONAL CUSTOMER OWNED UNDERGROUND SERVICES WITHIN THE PROJECT LIMITS. EXACT LOCATIONS ARE NOT KNOWN. THE CONTRACTOR SHALL NOTIFY DIGSAFE PRIOR TO EXCAVATION ACTIVITIES AND AVOID IMPACTS TO THESE AND OTHER FACILITIES.

RUTLAND

PROJECT NAME:	STATEWIDE	FILE NAME:	z11f116bdr_Rutland.dgn	PLOT DATE:	10/9/2013
PROJECT NUMBER:	STP SDWK(II)	PROJECT LEADER:	E. ATKINS	DRAWN BY:	N. BOSAN
		DESIGNED BY:	T. BIGELOW	CHECKED BY:	E. ATKINS
			RUTLAND ROADWAY LAYOUT SHEET		SHEET 39 OF 53

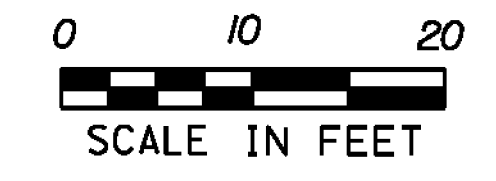

SEE LEGEND ON SHEET 3 GREEN INTERNATIONAL AFFILIATES, INC. CIVIL AND STRUCTURAL ENGINEERS