

BEGIN NH 2944 (I) U.S. ROUTE 2
SOUTH BURLINGTON STA. 120+54.24 (MM 2.283)

END NH 2944 (I) U.S. ROUTE 2
WILLISTON STA. 82+36.80 (MM 1.560)

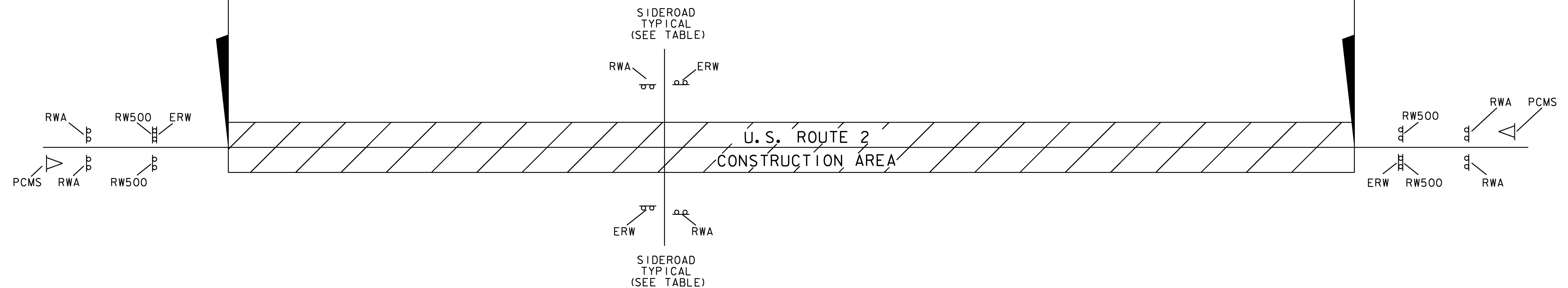

SEE VAOT STANDARDS T-10 AND T-17 FOR SIGN PLACEMENT.

LOCATION	ERW	RW500	RWA	▷
U.S. ROUTE 2				
U.S. ROUTE 2 (BEGIN PROJECT)	1	2	2	1
MILLHAM CT. (TH-49)	1		1	
CALKINS CT. (TH-183)	1		1	
VALLEY RD.	1		1	
SHUNPIKE RD. (TH-13)	1		1	
GREGORY DR. (TH-184)	1		1	
PALMER CT. (TH-185)	1		1	
INDUSTRIAL AVE. (TH-2)	1		1	
MUNSON WAY	1		1	
NORTH BROWNELL RD. (TH-8)	1		1	
SOUTH BROWNELL RD. (TH-3)	1		1	
COMMERCE ST. (TH-19)	1		1	
HARVEST LN. (TH-16)	1		1	
BLAIR PARK RD. (TH-62)	1		1	
HELENA DR. (TH-103)	1		1	
BOXWOOD ST.	1		1	
U.S. ROUTE 2 (END PROJECT)	1	2	2	1
TOTALS	17	4	19	2

LEGEND

- ERW = END ROAD WORK
- RW500 = ROAD WORK 500 FT
- RWA = ROAD WORK AHEAD
- SRWA = SIDE ROAD WORK AHEAD
- SRW500 = SIDE ROAD WORK 500 FT
- ▷ = PORTABLE CHANGEABLE MESSAGE SIGN

INTRODUCTION:

- UNLESS OTHERWISE NOTED, THE OBJECTIVE OF THIS PLAN IS TO MINIMIZE IMPACT ON THE TRAFFIC FLOW WHILE PROVIDING A SAFE PASSAGE FOR VEHICLES AND PEDESTRIANS DURING AND AFTER CONSTRUCTION WORK HOURS.
- THE FOLLOWING TRAFFIC CONTROL INFORMATION IS INTENDED TO BE A GENERAL OUTLINE FOR HOW THE WORK SHOULD PROCEED. IT IS THE CONTRACTOR'S RESPONSIBILITY TO PROVIDE SPECIFIC DETAILS TO ADDRESS SPECIFIC SITUATIONS. THIS RESPONSIBILITY INCLUDES PROVIDING A SITE SPECIFIC TRAFFIC CONTROL PLAN TO THE ENGINEER FOR ACCEPTANCE. THIS PLAN SHALL DETAIL THE USE AND PLACEMENT OF SIGNS, CHANNELING DEVICES, ARROW PANELS, FLAGGERS AND UNIFORMED TRAFFIC OFFICERS (UTO'S) TO ADDRESS LANE CLOSURES, WORK ZONE SPEED REDUCTIONS (IF NECESSARY) AND PEDESTRIAN ACCESS IN COMPLIANCE WITH THE LATEST EDITION OF THE MANUAL ON UNIFORM TRAFFIC CONTROL DEVICES (MUTCD). THE CONTRACTOR MUST ALLOW AT LEAST FOUR WEEKS FOR REVIEW AND APPROVAL OF THE COMPREHENSIVE PLAN AND 2 WEEKS FOR REVIEW AND APPROVAL OF MINOR CHANGES/DETAILS. ALL TRAFFIC CONTROL DETAILS MUST BE DESIGNED AND IMPLEMENTED IN ACCORDANCE WITH THE MUTCD AND VAOT STANDARDS T-1, T-10, T-17, T-24, T-28, T-29, T-30, T-31, T-35 AND T-36. WHERE CONFLICTS EXIST, THE MUTCD SHALL GOVERN. THE COST OF PREPARING THIS PLAN (AND MAKING CHANGES IF NECESSARY) WILL BE INCLUDED IN THE UNIT PRICE BID FOR ITEM 641.10, TRAFFIC CONTROL.

TRAFFIC CONTROL NOTES

- ALL TEMPORARY TRAFFIC CONTROL SHALL BE IN ACCORDANCE WITH THESE PROJECT PLANS, APPLICABLE VAOT STANDARD DRAWINGS, AND THE MANUAL ON UNIFORM TRAFFIC CONTROL DEVICES (MUTCD), DATED 2009, AND ITS LATEST REVISIONS, OR AS DIRECTED BY THE ENGINEER.
- SIGNS SHALL ONLY BE VISIBLE TO MOTORIST AT THE TIMES WHEN THE MESSAGE IS PERTINENT, I.E. A "FLAGGER AHEAD" SIGN SHALL ONLY BE VISIBLE TO MOTORIST WHEN THE FLAGGER IS ACTUALLY PRESENT PERFORMING THEIR DUTIES.
- A MINIMUM LANE WIDTH OF 10 FEET SHALL BE MAINTAINED. A SUPER LOAD PERMIT IS REQUIRED FOR ANY LOAD 10'-6" WIDE OR OVER 100 FEET LONG OR IN EXCESS OF 108,000 POUNDS. THEREFORE THE DEPARTMENT OF MOTOR VEHICLES SHALL BE NOTIFIED FOR SUPER LOAD ROUTING PURPOSES.
- SIGNALIZED INTERSECTIONS MUST BE CONTROLLED BY UNIFORMED TRAFFIC OFFICERS WHEN LANES ARE NOT IN NORMAL OPERATION EXCEPT DURING NIGHT TIME FLASHING OPERATION. SEE NOTE 12.
- WHEN COLD PLANED BITUMINOUS PAVEMENT IS OPEN TO TRAFFIC, A "MOTORCYCLES USE CAUTION" SIGN, AS PER VAOT STANDARDS T-17 AND T-30, SHALL BE PROVIDED.
- THE CONTRACTOR SHOULD LEAVE NO LONGITUDINAL DROP-OFFS DURING HOURS WHEN WORK IS SUSPENDED. THEREFORE, THE FULL ROADWAY WIDTH SHOULD BE COLD PLANED OR PAVED DURING THE DAILY WORK PERIOD. WHEN NECESSARY, DROP-OFF PROTECTION IN THESE AREAS SHALL CONFORM TO VAOT STANDARDS T-35 AND T-36.
- THE CONTRACTOR SHALL PROVIDE ACCESS THROUGH THE WORK ZONE AND MAINTAIN ACCESS TO ALL PROPERTIES FOR EMERGENCY VEHICLES AT ALL TIMES. ACCESS TO ALL COMMERCIAL AND MUNICIPAL PROPERTIES SHALL BE MAINTAINED DURING BUSINESS HOURS. ACCESS TO RESIDENTIAL PROPERTIES MAY BE RESTRICTED FOR A SHORT DURATION (A FEW HOURS). THIS WORK WILL BE COORDINATED WITH THE OWNER. COORDINATE MAJOR WORK ON COMMERCIAL OR MUNICIPAL ACCESSES WITH THE OWNER AT LEAST ONE WEEK PRIOR TO STARTING THE WORK. ALL ACCESSES SHALL ALSO BE KEPT FREE OF WORK AND TRAFFIC SHALL BE CONTROLLED BY UNIFORMED TRAFFIC OFFICERS OR FLAGGERS AS REQUIRED.

(CONTINUED ON NEXT SHEET)

NOT TO SCALE

PROJECT NAME:	SOUTH BURLINGTON-WILLISTON
PROJECT NUMBER:	NH 2944(I)
FILE NAME: z11d340de+alls.dgn	PLOT DATE: 2/15/2017
PROJECT LEADER: G. EDWARDS	DRAWN BY: D. DRAPER
DESIGNED BY: D. DRAPER	CHECKED BY: J. LITTLE
CONSTRUCTION APPROACH SIGNING SHEET 1	SHEET 190 OF 249

