

17+10.40 END TRANSITION  
RESUME CONCRETE REMOVAL

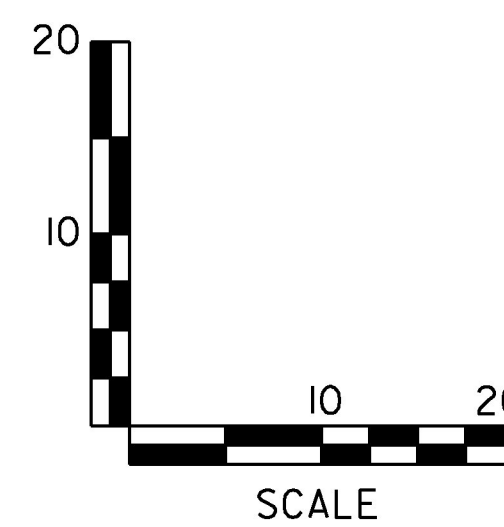
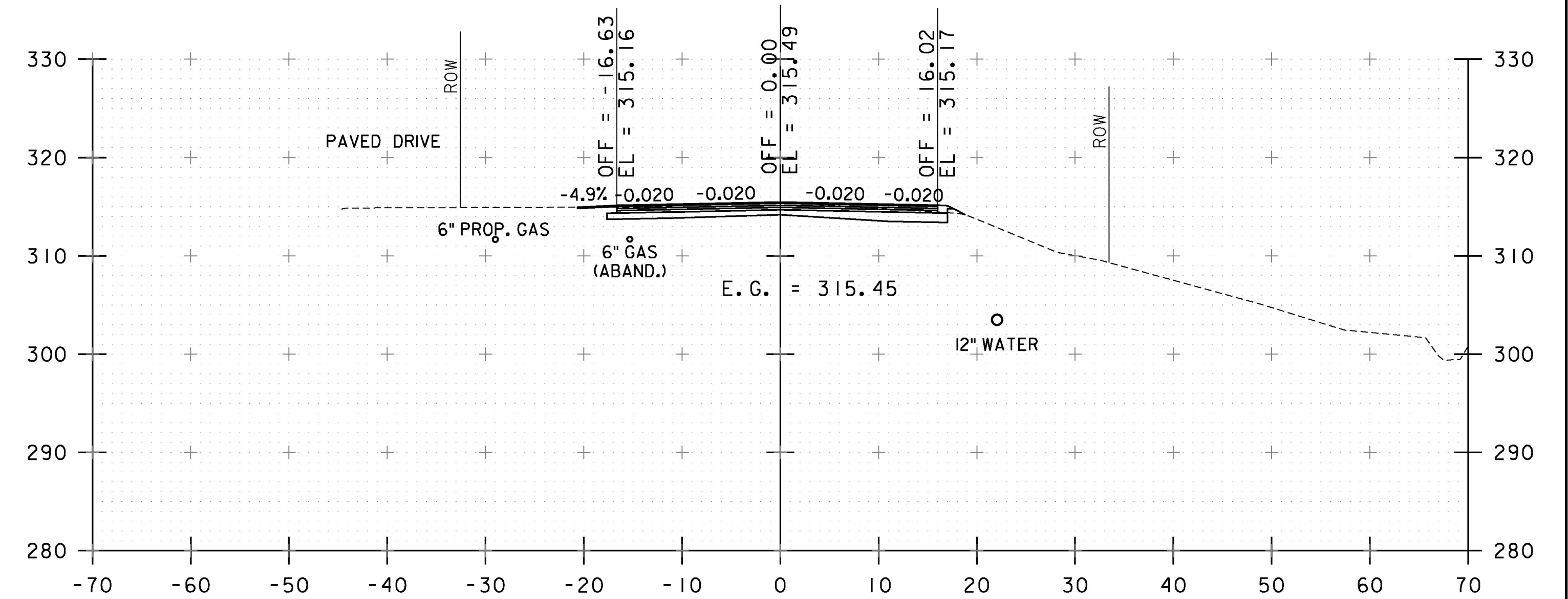
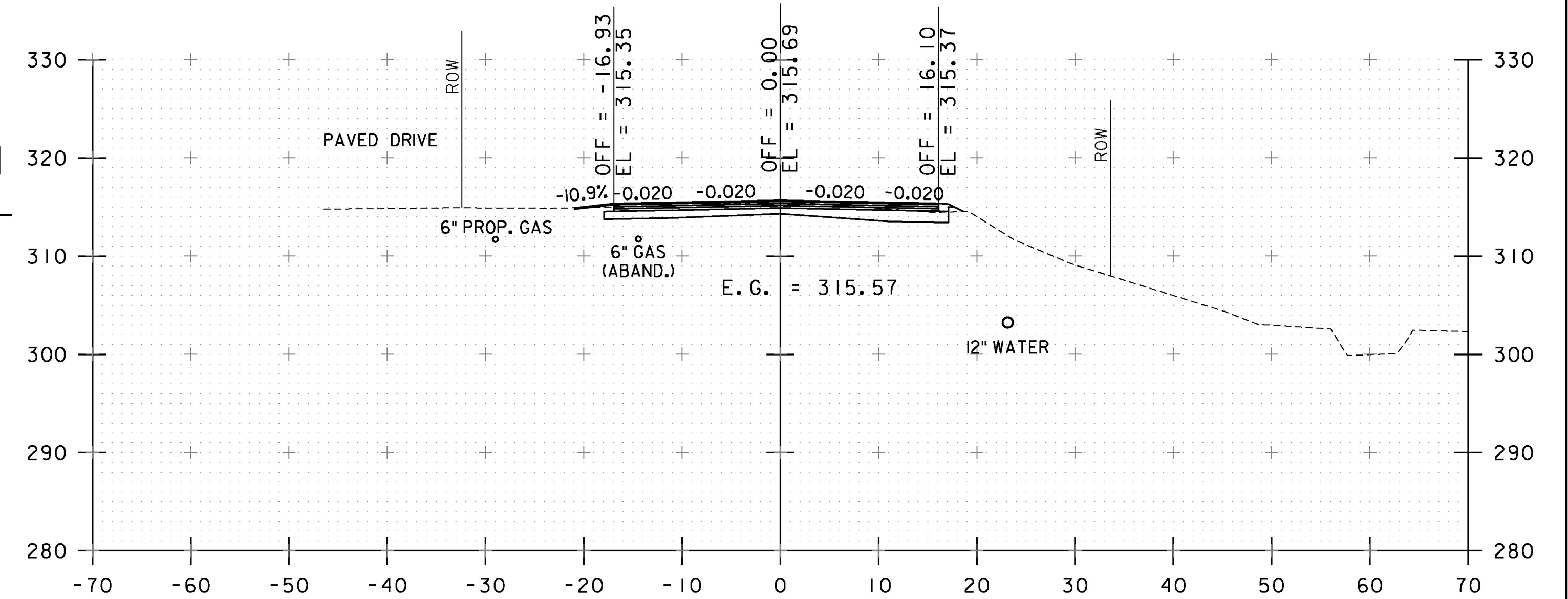
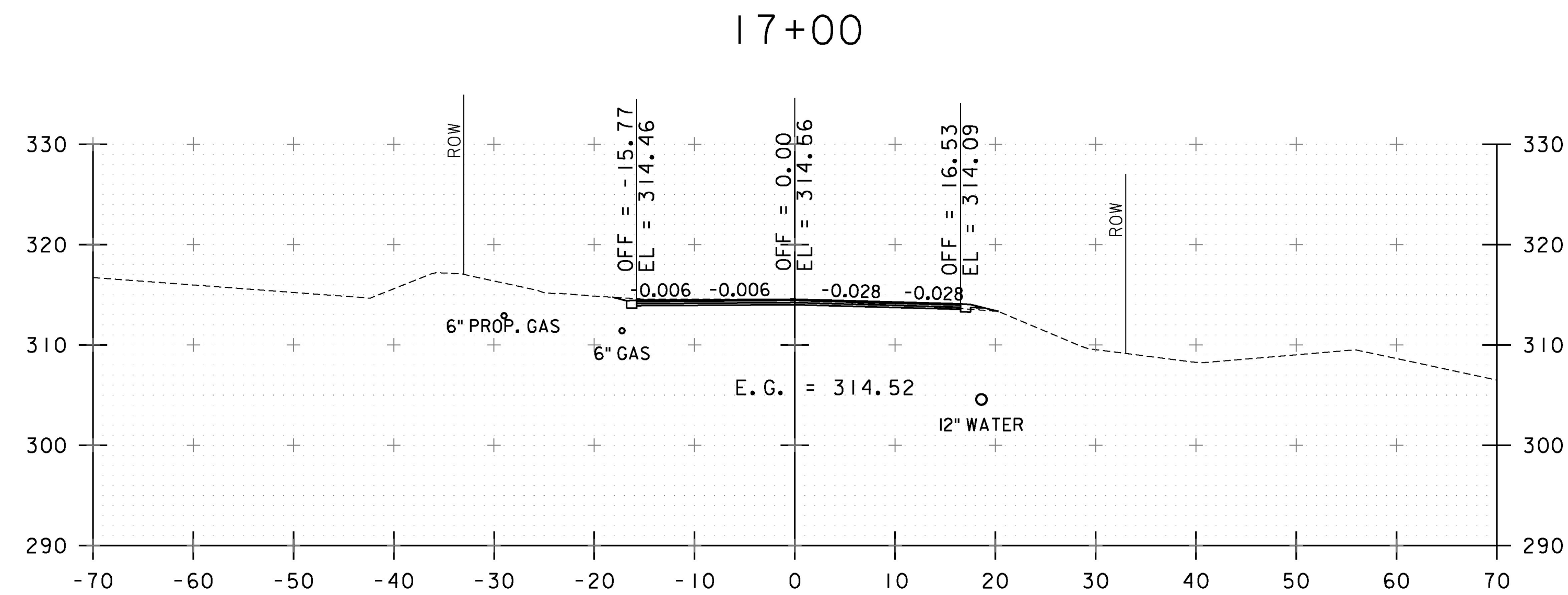
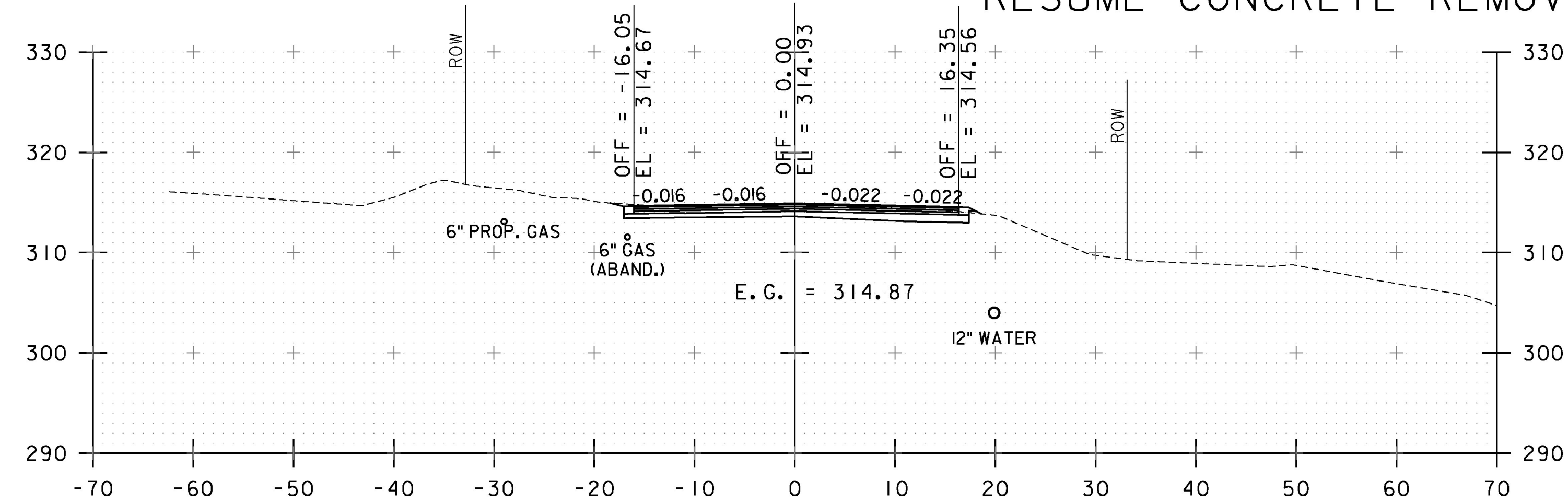

STA. W 16+75 TO STA. W 17+75

PROJECT NAME:	SOUTH BURLINGTON-WILLISTON
PROJECT NUMBER:	NH 2944(I)
FILE NAME:	zild340xsl.dgn
PROJECT LEADER:	G. EDWARDS
DESIGNED BY:	I. MAYNARD
CROSS SECTION SHEET 25	
PLOT DATE:	2/15/2017
DRAWN BY:	I. MAYNARD
CHECKED BY:	J. LITTLE
SHEET	145 OF 249