

STONE FILL, TYPE J
 STA. 21+00 TO 21+02, RT
 STA. 21+25 TO 21+75, RT
 SEE SHEET 19 AND NOTE 3 BELOW

BOX BEAM GUARDRAIL
 STA. 22+59.8 TO 23+83.6, LT

SPECIAL PROVISION (BOX BEAM GUARDRAIL W/7 FEET POSTS)
 STA. 21+36.7 TO 22+98.0, RT

REMOVAL AND DISPOSAL OF GUARDRAIL
 STA. 21+42 TO 22+94, RT
 STA. 22+61 TO 23+61, LT

DURABLE & TEMPORARY 4 INCH WHITE LINE
 (ALL LINES WILL INCLUDE EDGE LINE BREAKS AND RADII FOR SIDE ROADS)
 STA. 21+00 TO 26+00, EDGE LINE RT
 STA. 21+00 TO 21+98, EDGE LINE LT
 STA. 21+00 TO 21+09, DOTTED CL
 STA. 21+09 TO 22+09, SOLID CL (LANE LINE)
 STA. 21+98 TO 22+86, DOTTED LANE LINE LT
 STA. 21+98 TO 22+86, DOTTED LANE LINE LT
 STA. 22+44, SOLID LT (EDGELINES, MUNSON WAY)
 STA. 22+86 TO 26+00, EDGE LINE LT
 STA. 24+25 TO 26+00, BIKE LANE LINE RT
 STA. 24+25 TO 26+00, HATCH BUFFER RT

DURABLE & TEMPORARY 8 INCH YELLOW LINE
 STA. 22+75 TO 24+91, LT (DIAGONALS)
 SEE SHEET 27

DURABLE & TEMPORARY 24 INCH STOP BAR
 STA. 22+44, LT (MUNSON WAY)

DURABLE LETTER OR SYMBOL, TYPE D TAPE
 STA. 21+13, LT ARROW
 STA. 21+59, LT "ONLY"
 STA. 21+83, LT BIKE LANE ARROW
 STA. 21+95, LT BIKE LANE SYMBOL
 STA. 22+05, LT ARROW
 STA. 22+44, LT "STOP" (MUNSON WAY)
 STA. 23+19, RT BIKE LANE SYMBOL
 STA. 23+31, RT BIKE LANE ARROW

TEMPORARY LETTER OR SYMBOL, PAINT
 STA. 21+13, LT ARROW
 STA. 21+83, LT BIKE LANE SYMBOL
 STA. 21+95, LT BIKE LANE SYMBOL
 STA. 22+05, LT ARROW
 STA. 22+44, LT "STOP" (MUNSON WAY)
 STA. 23+19, RT BIKE LANE SYMBOL
 STA. 23+31, RT BIKE LANE ARROW

GRUBBING MATERIAL (6")
 STA. 21+00 TO 21+02, RT
 STA. 21+25 TO 21+75, RT
 SEE SHEET 19

REMOVING SIGNS
 AS SHOWN - 1

ERECTING SALVAGED SIGNS
 AS SHOWN - 1

SPECIAL PROVISION (ADJUST ELEVATION OF VALVE BOX)
 SEE SHEET 21

SPECIAL PROVISION (GREEN PAVEMENT MARKINGS - BICYCLE LANE)
 STA. 21+98 TO 22+85, BIKE LANE LT
 SEE SHEET 27

SPECIAL PROVISION (REPLACEMENT OF VALVE BOX)
 SEE SHEET 22

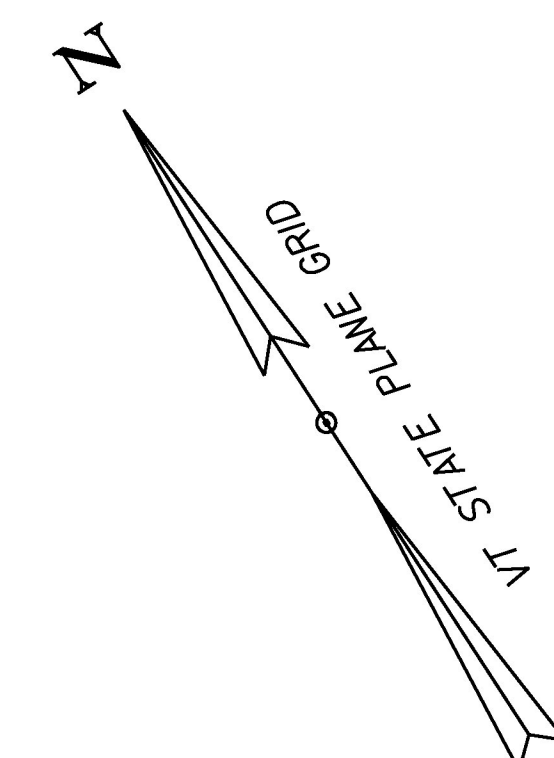

STA. 21+25, LT

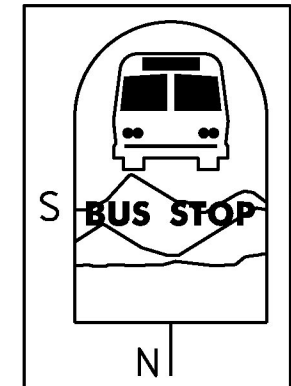

STA. 22+21, LT

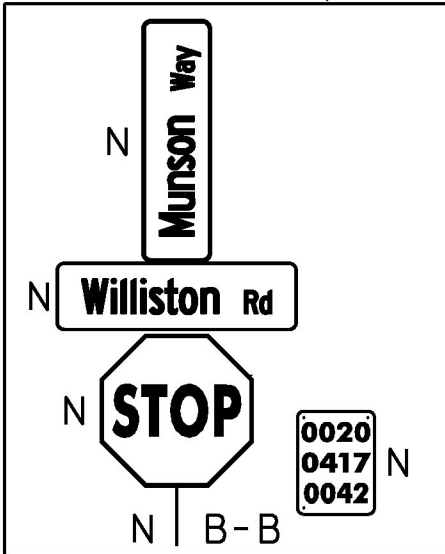

STA. 21+92, LT

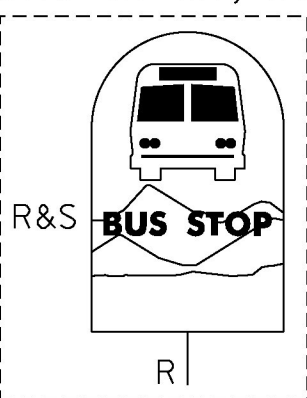

MUNSON WAY
 MM 0.411 = STA. 21+70 (FIELD MEASURED)
 MM 0.425 = STA. 22+44 (PAVED)

DURABLE & TEMPORARY 4 INCH YELLOW LINE
 (ALL LINES WILL INCLUDE CL BREAKS FOR SIDE ROADS)
 STA. 21+00 TO 22+09, DOUBLE SOLID LT
 STA. 22+44, DOUBLE SOLID LT (MUNSON WAY)
 STA. 22+65, TO 26+00, SOLID LT & RT
 STA. 22+65 TO 24+91, SOLID LT & RT

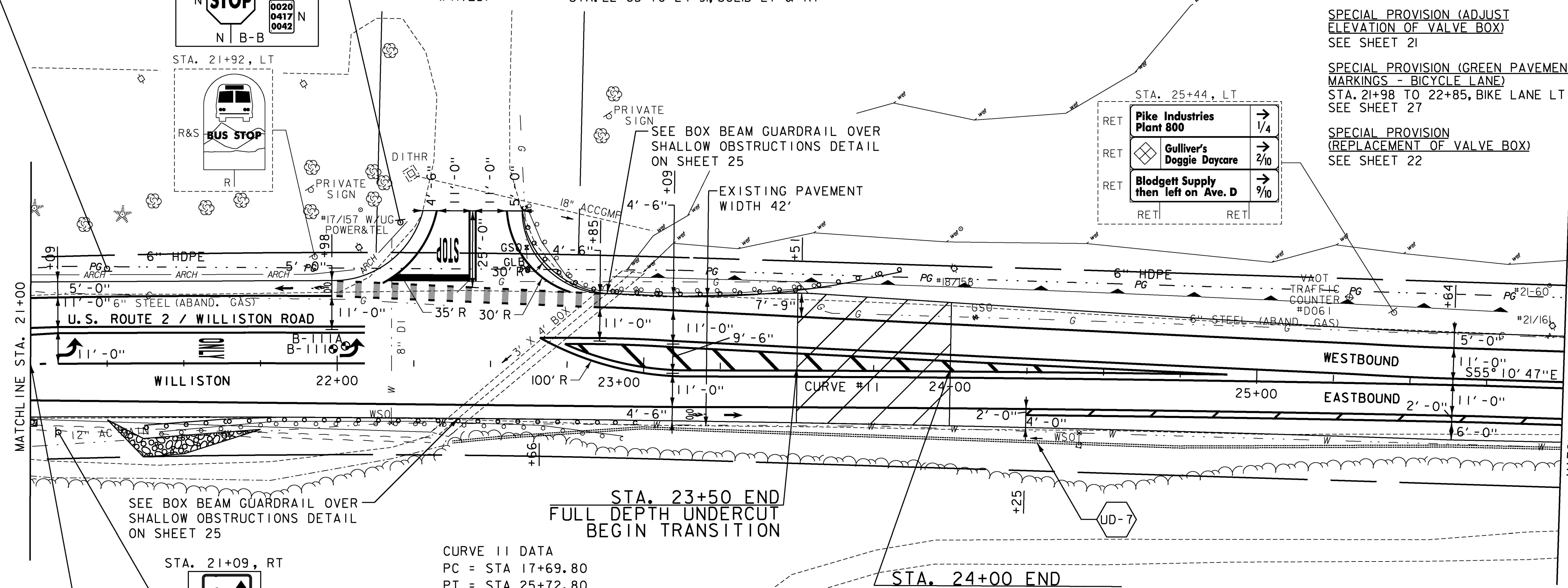
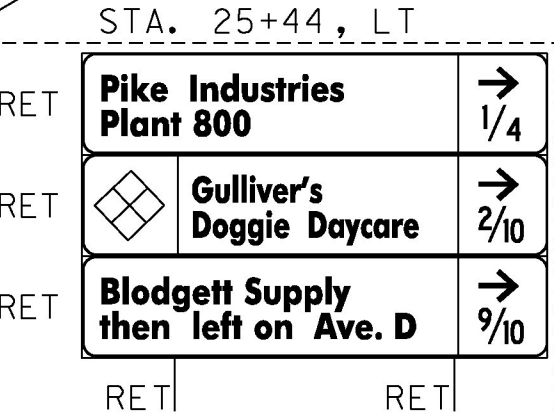

CURVE #11 DATA
 PC = STA 17+69.80
 PT = STA 25+72.80
 $\Delta = 3^{\circ}40'50.55''$ RT
 $D = 0^{\circ}27'30.12''$
 $R = 12500.00'$
 $T = 401.64'$
 $L = 803.01'$
 $E = 6.45'$
 $e = NC$

STA. 23+50 END FULL DEPTH UNDERCUT BEGIN TRANSITION

STA. 24+00 END UNDERCUT TRANSITION

UD-7 STA. 22+38 TO 26+00, RT 542 LF - 6" UNDERDRAIN
 CONSTRUCT 6 INCH UNDERDRAIN PIPE, 20 LF - 6" UNDERDRAIN CARRIER PIPE
 SEE SHEET 20 FOR DETAILS AND ASSOCIATED QUANTITIES

ENVIRONMENTALLY SENSITIVE LOCATIONS:

NO.	LIMITS	POS.	TYPE.
1.	STA. 21+00 - 22+23,	LT	ARCH
2.	STA. 22+90 - 25+81,	LT	WETLAND

SOIL BORING DATA			
BORING#	DEPTH (FT.)	PCC	COMMENTS
B-111	0.6'	YES	AUGER REFUSAL ON CONCRETE
B-111A	5.0'	YES	

- NOTES:**
- FOR LEGENDS, SEE SHEETS 3-4.
 - ALL EXISTING SIGNS NOT SHOWN ON THE PLANS SHALL BE RETAINED.
 - ALL WORK SHALL BE CONSTRUCTED WITHIN THE ROADWAY RIGHT OF WAY.

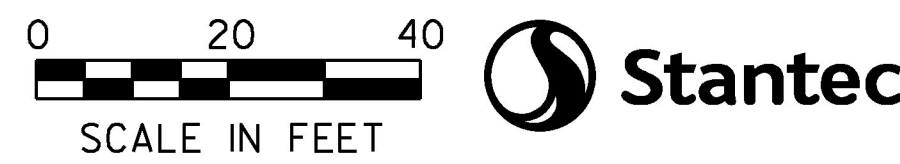

PROJECT NAME: SOUTH BURLINGTON-WILLISTON	PLOT DATE: 2/15/2017
PROJECT NUMBER: NH 2944(I)	DRAWN BY: D. DRAPER
FILE NAME: zild340bdr.dgn	CHECKED BY: J. LITTLE
PROJECT LEADER: G. EDWARDS	SHEET 60 OF 249
DESIGNED BY: D. DRAPER	LAYOUT SHEET 12