

GENERAL NOTES

CONSTRUCTION SPECIFICATIONS

1. ALL MATERIAL AND WORKMANSHIP TO BE IN ACCORDANCE WITH THE STATE OF VERMONT AGENCY OF TRANSPORTATION STANDARD SPECIFICATIONS FOR CONSTRUCTION, DATED 2011, WITH ITS LATEST REVISIONS, AND THE AASHTO LRFD BRIDGE DESIGN SPECIFICATIONS, 6TH EDITION WITH INTERIMS THROUGH 2012.

MATERIAL SPECIFICATIONS

1. ALL STRUCTURAL STEEL TO BE UNPAINTED **AASHTO A709** GRADE 50W, UNLESS NOTED.
2. MATERIAL NOTES "T2" ON DETAIL DRAWINGS SHALL BE CHARPY V-NOTCH TESTED IN ACCORDANCE WITH THE REQUIREMENTS OF VERMONT STANDARD SPECIFICATIONS SECTION 714.D1.
3. HIGH STRENGTH BOLTS SHALL BE 7/8" DIAMETER, ASTM A325 (TYPE 3), IN 15/16" DIAMETER HOLES. NUTS SHALL BE A563 (TYPE 3) GRADE C3, AND WASHERS SHALL BE F436 (TYPE 3).

BOLTS & NUTS SHALL BE ROTATIONAL CAPACITY TESTED.
DO NOT MIX BOLTS & NUTS FROM DIFFERENT CONTAINERS
UNLESS ALL BOLTS & NUTS HAVE THE SAME LOT NUMBER.

FABRICATION

1. ALL HOLES SHALL BE PUNCHED OR DRILLED FULL SIZE, UNLESS NOTED.

WELDING

1. THE CONFIGURATION OF THE WELD JOINTS AND ALL WELDING PROCEDURES SHALL BE IN ACCORDANCE WITH AASHTO/AWS D1.5-10 BRIDGE WELDING CODE; IN ADDITION TO THE PROVISIONS OF VERMONT STANDARD SPECIFICATIONS SECTION 506.10. ALL WELDING WILL BE DETAILED TO PRE-QUALIFIED JOINTS, UNLESS PROHIBITED BY THE DESIGNER.
2. WELDING OF MAIN LOAD CARRYING MEMBERS AND ATTACHMENTS SHALL BE PERFORMED USING THE AUTOMATIC SUBMERGED ARC & SHIELDED METAL ARC PROCESSES. ALL WELDS ARE CONTINUOUS, UNLESS NOTED.
3. NON-DESTRUCTIVE TESTING OF WELDS SHALL BE IN ACCORDANCE WITH THE REFERENCED SPECIFICATION.
4. SEE DETAIL "MS1" FOR THE WELD TERMINATION DETAIL.

FIELD CONNECTIONS

1. ALL FIELD CONNECTIONS SHALL BE MADE WITH 7/8" DIAMETER HIGH STRENGTH A325 (TYPE 3) BOLTS, INSTALLED PER SECTION 506.19(c). SEE SHEET E2 FOR BOLT SIZES.
2. BOLTS SHALL HAVE A HEAVY HEX HEAD, HEAVY HEX NUT, AND AT LEAST ONE HARD FLAT WASHER EACH. WASHER TO BE PLACED UNDER THE TURNED ELEMENT.
3. PIECE MARKS WILL BE LOCATED AS SHOWN ON SHEET E1.

CLEANING

1. ALL STEEL SHALL BE BLAST CLEANED IN ACCORDANCE WITH SSPC SP-10

PAINTING

1. ALL STEEL SHALL BE UNPAINTED.

AASHTO M 270
(ASTM A709)

PUNCHED HOLES ARE ACCEPTABLE IN
DIAPHRAGM AND CONNECTION PLATES

ONLY SMAWS ARE
PRE-QUALIFIED. SUBMERGED
ARC WELDS A SUBJECT TO
TESTING REQUIREMENTS OF AWS
D1.5, SECTION 5

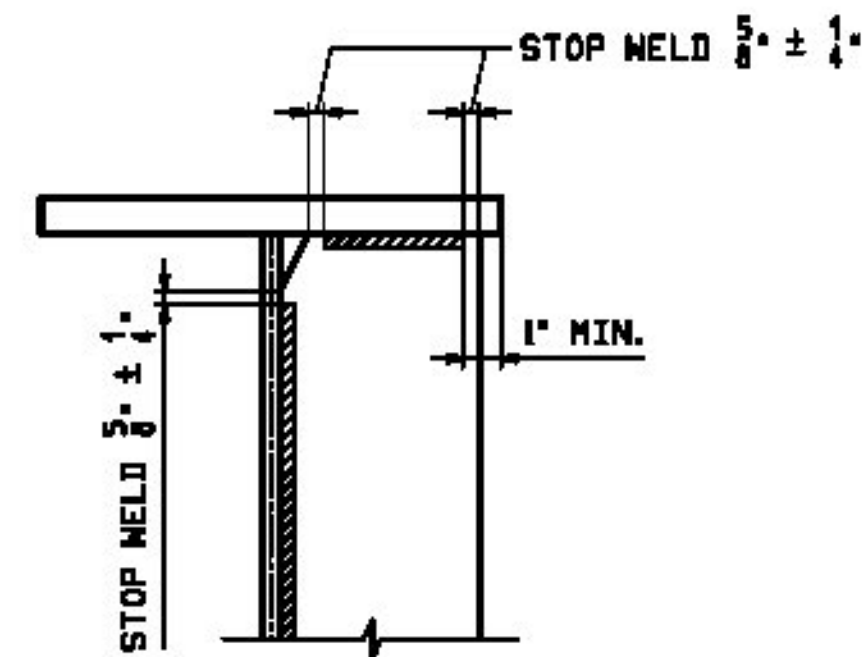

DETAIL "MS1"
STIFF. WELD TERMINATION

NOTE TO ENGINEER:
THESE NOTES ARE NOT INTENDED TO BE ALL INCLUSIVE AND COMPLIANCE WITH RELEVANT SPECIFICATIONS REMAIN UNCHANGED.

REV.	DATE	REMARKS	DWN	CHK	APVL	SHOP
0						
MATERIAL:		SURFACE PREP. & PAINT:		HOLES:		SHOP BOLTS:
DESCRIPTION: GENERAL NOTES						
CASCO BAY STEEL STRUCTURES, INC. 1 WALLACE AVE. PHONE (207) 780-6722 SOUTH PORTLAND, ME 04106 FAX (207) 780-6726						
STRUCTURE: VT RTE 131 OVER TWENTYMILE STREAM WINDSOR COUNTY VERMONT AGENCY OF TRANSPORTATION			DRAWN: EEO	DATE: 11/22		
			CHKD: EEO	DATE: 11/25		
LOCATION: CAVENDISH, VERMONT			JOB NO.	DWG NO.		
PROJ NO. ER BRF 0146(13)			541	GN1		
CUSTOMER: COLD RIVER BRIDGES, LLC				REV.		