

REHAB,
DIs, CBs OR MHS, CLASS I, II OR III
SEE SHEETS 27-28

CHANGING ELEVATION OF SEWER MANHOLES
SEE SHEET 28

CAST-IN-PLACE CONCRETE CURB, TYPE B
STA. 171+53, LT

REMOVAL OF EXISTING CURB
STA. 171+53, LT

PORTLAND CEMENT
CONCRETE SIDEWALK, 5 INCH
STA. 171+42, RT
STA. 171+53, LT

DETECTABLE WARNING SURFACE
STA. 171+42, RT
STA. 171+53, LT

ADJUST ELEVATION OF VALVE BOX
SEE SHEETS 28-29

DURABLE & TEMPORARY 4 INCH WHITE LINE
(ALL LINES WILL INCLUDE EDGE LINE BREAKS
AND RADIUS FOR SIDE ROADS)
STA. 169+00 TO 174+50, SOLID LT - RT
STA. 172+16, SOLID LT (EDGE LINES, POWERS PARK)

DURABLE & TEMPORARY 4 INCH YELLOW LINE
(ALL LINES WILL INCLUDE C BREAKS FOR SIDE ROADS & CROSSWALKS)
STA. 169+00 TO 174+50, SOLID LT & RT
STA. 171+75, DOUBLE SOLID RT (GROVE ST.)
STA. 172+16, DOUBLE SOLID LT (POWERS PARK)

DURABLE & TEMPORARY 8 INCH WHITE LINE
STA. 171+21 TO 171+33, RT (HYDRANT)
SEE SHEET 55

DURABLE & TEMPORARY 24 INCH STOP BAR
STA. 171+75, RT (GROVE ST.)
STA. 172+16, LT (POWERS PARK)

DURABLE & TEMPORARY LETTER OR SYMBOL
STA. 171+75, RT "STOP" (GROVE ST.)
STA. 172+16, LT "STOP" (POWERS PARK)

REMOVING SIGNS
AS SHOWN - 8

DURABLE CROSSWALK MARKING, TYPE A TAPE
STA. 171+42, RT TO 171+53, LT
SEE SHEET 55 (TYP.)

TEMPORARY CROSSWALK MARKING, PAINT
STA. 171+42, RT TO 171+53, LT
SEE SHEET 55 (TYP.)

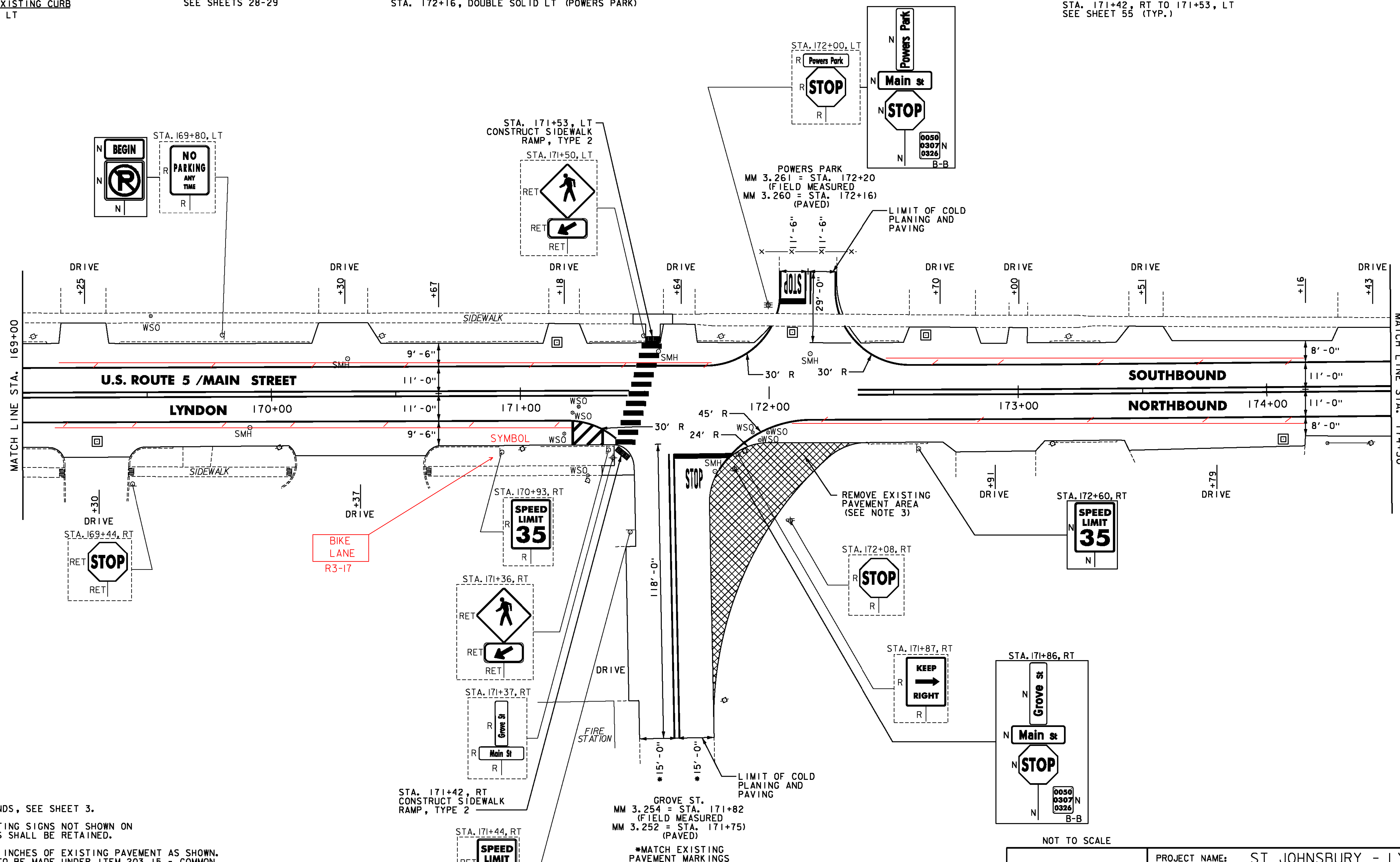

- NOTES:
- FOR LEGENDS, SEE SHEET 3.
 - ALL EXISTING SIGNS NOT SHOWN ON THE PLANS SHALL BE RETAINED.
 - REMOVE 4 INCHES OF EXISTING PAVEMENT AS SHOWN. PAYMENT TO BE MADE UNDER ITEM 203.15 - COMMON EXCAVATION. IF LESS THAN 4 INCHES OF PAVEMENT IS ENCOUNTERED, REMOVAL OF SUBBASE SHALL BE PAID UNDER ITEM 203.15 - COMMON EXCAVATION. REPLACE WITH 4 INCHES OF ITEM 651.35 - TOPSOIL, 651.15 - SEED, 651.18 - FERTILIZER, 651.20 - AGRICULTURAL LIMESTONE AND 653.20 - TEMPORARY EROSION MATTING. ESTIMATED QUANTITIES OF ALL THESE ITEMS HAVE BEEN INCLUDED FOR USE AS DIRECTED BY THE ENGINEER.

REMOVAL OF EXISTING PAVEMENT AREAS, SEE NOTE 3



NOT TO SCALE

PROJECT LAYOUT SHEET #60

| | |
|-------------------------------------|-----------------------|
| PROJECT NAME: ST JOHNSBURY - LYNDON | PLOT DATE: 5/5/2014 |
| PROJECT NUMBER: STP 2936(I) | DRAWN BY: D. DRAPER |
| FILE NAME: pllc308.dgn | CHECKED BY: J. LITTLE |
| PROJECT LEADER: G. EDWARDS | SHEET 127 OF 250 |
| DESIGNED BY: D. DRAPER | |